



October 24, 2025

CHA TUK CHAK
SM MALL OF ASIA, SHORE 1
ATTN: MR. DARRICK TEE

Dear Ma'am/Sir,

Kolin Marketing Inc., is extremely honored for your endorsement of Kolin brand and we are please to offer you with a special price/s for the following items.

A. EQUIPMENT & INSTALLATION

| QTY | U/M | MODEL / DESCRIPTION | SRP | DISCOUNTED PRICE | | AMOUNT |
|--|--------|---|-----------|------------------|-----|------------|
| 2 | UNIT/S | MODEL: KSG-IWF-30WFF-8K1M32 KOLIN WALL MOUNTED PRIMUS GOLD AIRCONDITIONER 29,500 Kj/h (3.0HP) FULL DC INVERTER W/ WIFI R-32 | 76,595.00 | 51,212.20 | PHP | 102,424.40 |
| 1 | UNIT/S | MODEL: KSG-IWF-25WFF-8K1M32 KOLIN WALL MOUNTED PRIMUS GOLD AIRCONDITIONER 25,560 Kj/h (2.5HP) FULL DC INVERTER W/ WIFI R-32 | 68,995.00 | 45,436.20 | PHP | 45,436.20 |
| TOTAL UNIT COST | | | | | PHP | 147,860.60 |
| ESTIMATED COST OF INSTALLATION (please see attached) | | | | | PHP | 80,250.00 |
| OTHERS: DELIVERY CHARGE | | | | | PHP | 600.00 |
| TOTAL ESTIMATED COST OF THE PROJECT | | | | | PHP | 228,710.60 |

TERMS OF PAYMENT:

FULL PAYMENT OF UNIT AND DELIVERY CHARGE. IF CHECK, SUBJECT FOR 3 DAYS CLEARING.

BANK DETAILS:

- * Unit/s & Delivery: Account Name - KOLIN MARKETING INC. / Account# - 011808002307 (BDO-KALAYAAN)
- * Installation: Will be provided by assigned installer.
- ** *You may settle first payment for unit/s & delivery. Installation payment can be settled directly to installer after actual works.*

WARRANTY:

FOR SPLIT TYPE : ONE (1) YEAR FREE PARTS AND LABOR, THREE YEARS (3) MAIN PCB , TEN (10) YEARS WARRANTY ON COMPRESSOR.

NOTES: PRICES ARE SUBJECT TO CHANGE WITHOUT PRIOR NOTICE.

PRICES IS VAT INCLUSIVE.

** *Cost of Installation is Package with the Unit(s), this cost cannot avail separately (cost will be based on actual works).*

We thank you for giving opportunity to offer our product and services, hoping we receive your purchase order.

If you need assistance, don't hesitate to call the under signed at 0917-807-8607 or email at kmi_asst@kolinphil.com.ph

** This quotation is based on provided floor plan only, subject for actual survey once location is available.

Very Truly Yours,

JANELLEN S. LIM
KMI-ASSISTANT

Noted By:

MART NATHANIEL R. FLORES
KMI-SUPERVISOR

Approved By:

MS. EDITHA M. FLORES
AVP - FINANCE

KMI-QUOTE-10-25-0766
JCY-24%/7K

Conforme:

SIGNATURE OVER PRINTED NAME

Kolin Marketing, Inc.
1854 Sta. Rita St., Guadalupe Nuevo, Makati City
Tel.: (632) 8852-6473
Fax: (632) 8852-2170 / (632) 8852-4792
www.kolinphil.com.ph / kolinphilippines.com



October 23, 2025
 Cha Tuk Chak c/o DARRICK TEE
 SM MOA Shore 1

| MODEL | Qty |
|---------------------|-----|
| KSG-IWF-30Wfy8K1M32 | 2 |
| KSG-IWF-25Wfy8K1M32 | 1 |

| DINING AREA | Area | 46 sqm |
|-------------|------|--------|
|-------------|------|--------|

| | | | | | |
|-------|-------------------------------|---------------------|--------|---------------|------------|
| ACU 1 | 3.0 HP Wall Mounted Inverter | KSG-IWF-30Wfy8K1M32 | | | |
| | Estimated Pipe Length = | 20 ft | | | |
| | Estimated Royal Cord Length = | 25 ft | | | |
| | Initial Charge | | | | ₱ 8,500.00 |
| | Includes: | | | | |
| | Labor | | | | |
| | 10ft Copper Tube | | | | |
| | 10ft Royal Cord | | | | |
| | Outdoor Bracket (Wall) | | | | |
| | Consumables | | | | |
| | Installation Materials | Description | Qty | Price per qty | Subtotal |
| | Copper Tube | Ø 1/4" x Ø 5/8" | 10 ft | ₱ 400.00/ft | ₱ 4,000.00 |
| | Royal Cord (comm. wire) | 2.mm2 x 4C | 15 ft | ₱ 100.00/ft | ₱ 1,500.00 |
| | Royal Cord (ACCU-Breaker) | 3.5mm x 3c | 5 ft | ₱ 60.00/ft | ₱ 300.00 |
| | Circuit Breaker waterproof | 30A / 1Ph | 1 pc/s | ₱ 1,000.00/pc | ₱ 1,000.00 |
| | Rubber Insulation | 2 1/8" x 3/4" x 6' | 3 pc/s | ₱ 350.00/pc | ₱ 1,050.00 |
| | Full thread | 3/8" x 10' | 2 pc/s | ₱ 150.00/pc | ₱ 300.00 |
| | PVC blue | 3/4" x 10' | 2 pc/s | ₱ 150.00/pc | ₱ 300.00 |
| | | | | | ₱ 8,450.00 |

| | |
|-------------------|-------------|
| Estimated Charges | ₱ 16,950.00 |
|-------------------|-------------|

| | | | | | |
|-------|-------------------------------|---------------------|--------|---------------|-------------|
| ACU 2 | 3.0 HP Wall Mounted Inverter | KSG-IWF-30Wfy8K1M32 | | | |
| | Estimated Pipe Length = | 40 ft | | | |
| | Estimated Royal Cord Length = | 45 ft | | | |
| | Initial Charge | | | | ₱ 8,500.00 |
| | Includes: | | | | |
| | Labor | | | | |
| | 10ft Copper Tube | | | | |
| | 10ft Royal Cord | | | | |
| | Outdoor Bracket (Wall) | | | | |
| | Consumables | | | | |
| | Installation Materials | Description | Qty | Price per qty | Subtotal |
| | Copper Tube | Ø 1/4" x Ø 5/8" | 30 ft | ₱ 400.00/ft | ₱ 12,000.00 |
| | Royal Cord (comm. wire) | 2.mm2 x 4C | 35 ft | ₱ 100.00/ft | ₱ 3,500.00 |
| | Royal Cord (ACCU-Breaker) | 3.5mm x 3c | 5 ft | ₱ 60.00/ft | ₱ 300.00 |
| | Circuit Breaker waterproof | 30A / 1Ph | 1 pc/s | ₱ 1,000.00/pc | ₱ 1,000.00 |
| | Rubber Insulation | 2 1/8" x 3/4" x 6' | 6 pc/s | ₱ 350.00/pc | ₱ 2,100.00 |
| | Full thread | 3/8" x 10' | 2 pc/s | ₱ 150.00/pc | ₱ 300.00 |
| | PVC blue | 3/4" x 10' | 1 pc/s | ₱ 150.00/pc | ₱ 150.00 |
| | | | | | ₱ 19,350.00 |

| | |
|-------------------|-------------|
| Estimated Charges | ₱ 27,850.00 |
|-------------------|-------------|

OFFICE/KITCHEN

Area 24 sqm

ACU 3 2.5 HP Wall Mounted Inverter**KSG-IWF-25WFY8K1M32**

Estimated Pipe Length = 56 ft

Estimated Royal Cord Length = 61 ft

Initial Charge

₱ 8,500.00

Includes:

Labor

10ft Copper Tube

10ft Royal Cord

Outdoor Bracket (Wall)

Consumables

Installation Materials

| Description | Qty | Price per qty | Subtotal |
|----------------------------|--------------------|----------------------|--------------------|
| Copper Tube | 46 ft | ₱ 350.00/ft | ₱ 16,100.00 |
| Royal Cord (comm. wire) | 51 ft | ₱ 100.00/ft | ₱ 5,100.00 |
| Royal Cord (ACCU-Breaker) | 5 ft | ₱ 60.00/ft | ₱ 300.00 |
| Circuit Breaker waterproof | 30A / 1Ph | 1 pc/s ₱ 1,000.00/pc | ₱ 1,000.00 |
| Rubber Insulation | 2 1/8" x 3/4" x 6' | 8 pc/s ₱ 350.00/pc | ₱ 2,800.00 |
| Full thread | 3/8" x 10' | 2 pc/s ₱ 150.00/pc | ₱ 300.00 |
| Metal Clamp | 3" | 10 pc/s ₱ 120.00/pc | ₱ 1,200.00 |
| PVC blue | 3/4" x 10' | 1 pc/s ₱ 150.00/pc | ₱ 150.00 |
| | | | ₱ 26,950.00 |

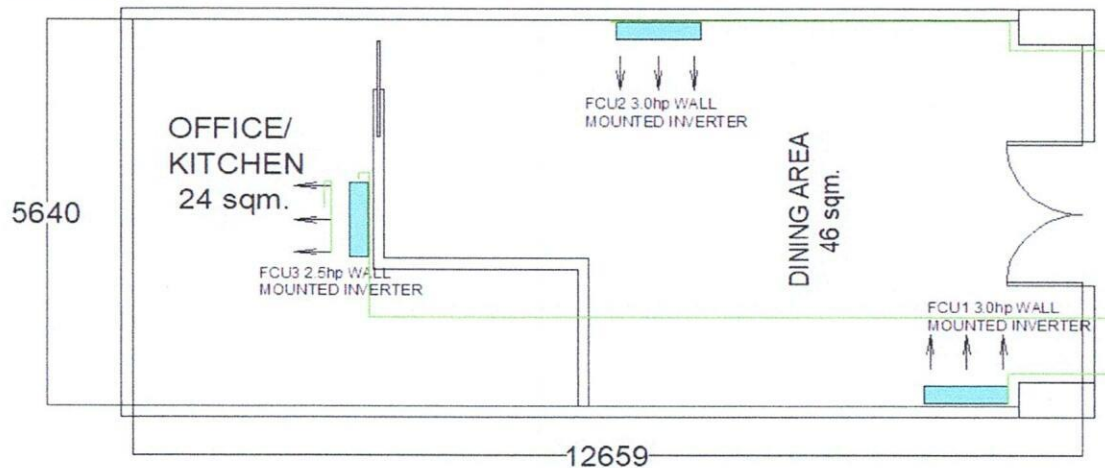
Estimated Charges**₱ 35,450.00**

Total Estimated Charges

₱ 80,250.00

Validity: This quotation is valid for a period of fifteen (15) days from the date thereof, subject to our confirmation thereafter.

Installation notes:

- 1 Location based in floor plan only. Recommendation only, not yet final, no outdoor.
- 2 AC drain line will be tapped to the nearest drain provision provided by the customer's contractor.
- 3 Need for marking and site visit before installation.
- 4 Coppertube expose inside the area.
- 5 Working days: Monday to Saturday, 8am- 5pm with parking. Need working permit.
- 6 Mechanical Plans, Permits, Electrical permits not included.
- 7 Deflectors, masonry, carpentry, chipping & plastering (finishing & restoration) are not included in the installation.
- 8 Air conditioning drain line and
Electrical power supply (feeder
- 9 **Final charges will be based on actual installation.**

Prepared by:



Jeffrey Dadios

Field Surveyor

Customer Conformance:

Signature Over Printed Name

Reviewed by:

Engr. Kenneth Zamora

Service Supervisor Shop and
Field Operation