

kolin

air conditioner

June 26, 2024

MERLY HUA BE FAMILY ASSOCIATION
904 3RD FLOOR, G. MASANGKAY ST., BRGY. 296, BINONDO MANILA
TEL#: 0956-4076325
Email: merlinagaudia@gmail.com

Dear Ma'am/Sir,

Kolin Marketing Inc., is extremely honored for your endorsement of Kolin brand and we are please to offer you with a special price/s for the following items.

A. EQUIPMENT & INSTALLATION

QTY	U/M	MODEL / DESCRIPTION	SRP	DISCOUNTED PRICE		AMOUNT
2	UNIT/S	MODEL: KLG-IF70-5G1M32 KOLIN FLOOR MOUNTED AIRCONDITIONER 61,200 Kj/h (5.0TR) FULL DC INVERTER R-32 SINGLE PHASE	171,395.00	125,688.10	PHP	251,376.20
TOTAL UNIT COST					PHP	251,376.20
ESTIMATED COST OF INSTALLATION (please see attached)					PHP	44,680.00
OTHERS: DELIVERY CHARGE					PHP	600.00
TOTAL ESTIMATED COST OF THE PROJECT					PHP	296,656.20

TERMS OF PAYMENT:

FULL PAYMENT OF UNIT AND DELIVERY CHARGE. IF CHECK, SUBJECT FOR 3 DAYS CLEARING.

WARRANTY:

FOR FLOOR MOUNTED (Inverter): ONE (1) YEAR FREE PARTS AND LABOR, THREE (3) YEARS WARRANTY ON COMPRESSOR.

NOTES: PRICES ARE SUBJECT TO CHANGE WITHOUT PRIOR NOTICE.

PRICES IS VAT INCLUSIVE.

INSTALLATION C/O AUTHORIZED SERVICE CENTER.

**** Cost of Installation is Package with the Unit(s), this cost cannot avail separately.**

We thank you for giving opportunity to offer our product and services, hoping we receive your purchase order.

If you need assistance, don't hesitate to call the under signed at 0917-807-8607 or email at kmi_asst@kolinphil.com.ph

Very Truly Yours,

JANELLEN S. LIM
KMI-ASSISTANT

Noted by:

MART NATHANIEL R. FLORES
KMI-SUPERVISOR

Approved By:

MS. EDITHA M. FLORES
AVP - FINANCE

KMI-QUOTE-06-24-0575
TYT-22%/8K

Conforme:

SIGNATURE OVER PRINTED NAME

ANNIVERSARY
EST. 1996

Kolin Marketing, Inc.

1854 Sta. Rita St., Guadalupe Nuevo, Makati City

www.kolinphil.com.ph

Tel.: (632) 8852-6473

Fax: (632) 8852-2170 / (632) 8852-4792

Bringing comfort to your home.

June 26, 2024

MERLY HUA BE FAMILY ASSOCIATION

904 3rd floor G.Masangkay St. Brgy 296 Binondo Manila

0956-4076325

merlinaquadia@gmail.com

MODEL
KLG-IF70-5G1M32

Qty
2

rev1- new location

EVENTS HALL		Area	170 sqm
--------------------	--	------	---------

ACU 1 7.0 HP Floor Standing Inverter KLG-IF70-5G1M32
Estimated Pipe Length = 30 ft
Estimated Royal Cord Length = 37 ft
Initial Charge ₱ 14,000.00

Includes:

Labor

10ft Copper Tube

10ft Royal Cord

Indoor Bracket (Floor)

Consumables

Installation Materials	Description	Qty	Price per qty	Subtotal
Copper Tube	Ø 3/8" x Ø 5/8"	20 ft	₱ 400.00/ft	₱ 8,000.00
Royal Cord (comm. wire)	2.mm2 x 4C	27 ft	₱ 100.00/ft	₱ 2,700.00
Royal Cord (ACCU-Breaker)	5.5mm x 3c	7 ft	₱ 70.00/ft	₱ 490.00
Circuit Breaker waterproof	60A / 1Ph	1 pc/s	₱ 1,000.00/pc	₱ 1,000.00
PVC blue	3/4" x 10'	1 pc/s	₱ 150.00/pc	₱ 150.00
				₱ 12,340.00

Estimated Charges	₱ 26,340.00
--------------------------	-------------

ACU 2 7.0 HP Floor Standing Inverter KLG-IF70-5G1M32
Estimated Pipe Length = 14 ft
Estimated Royal Cord Length = 21 ft
Initial Charge ₱ 14,000.00

Includes:

Labor

10ft Copper Tube

10ft Royal Cord

Indoor Bracket (Floor)

Consumables

Installation Materials	Description	Qty	Price per qty	Subtotal
Copper Tube	Ø 3/8" x Ø 5/8"	4 ft	₱ 400.00/ft	₱ 1,600.00
Royal Cord (comm. wire)	2.mm2 x 4C	11 ft	₱ 100.00/ft	₱ 1,100.00
Royal Cord (ACCU-Breaker)	5.5mm x 3c	7 ft	₱ 70.00/ft	₱ 490.00
Circuit Breaker waterproof	60A / 1Ph	1 pc/s	₱ 1,000.00/pc	₱ 1,000.00
PVC blue	3/4" x 10'	1 pc/s	₱ 150.00/pc	₱ 150.00
				₱ 4,340.00

Estimated Charges	₱ 18,340.00
--------------------------	-------------

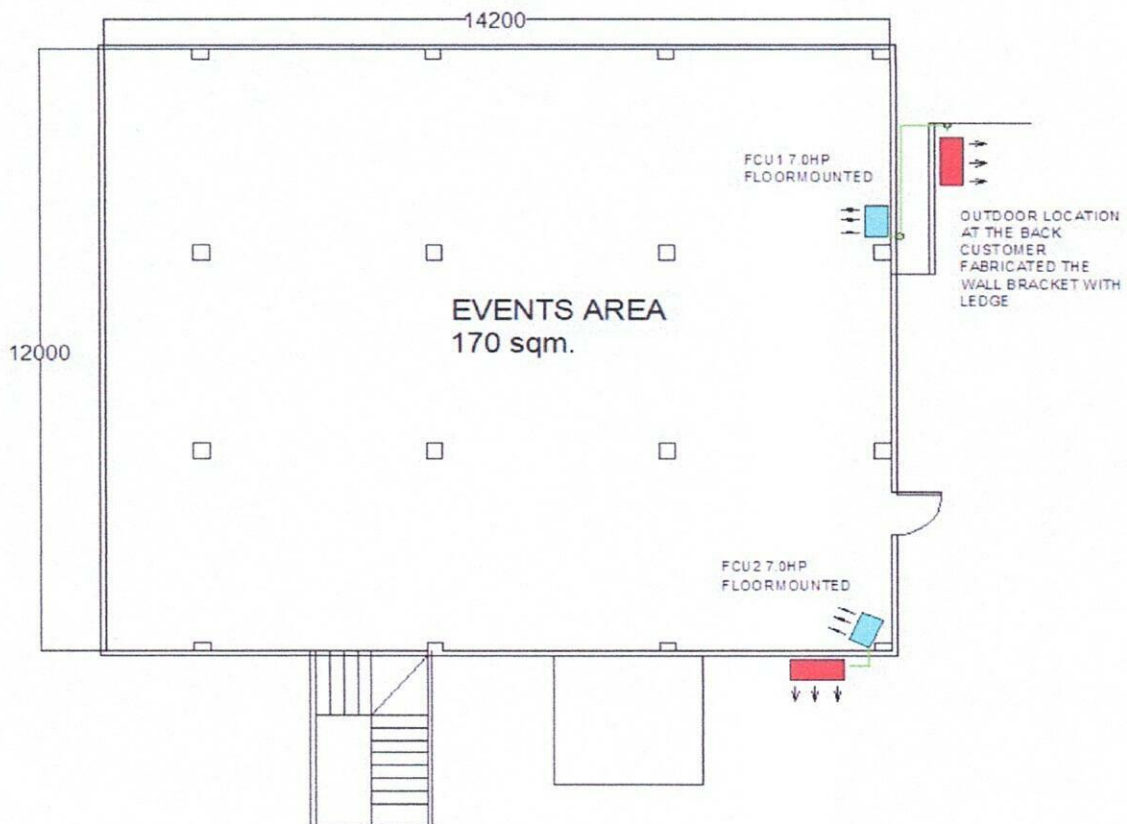

Total Estimated Charges

P 44,680.00

Validity: This quotation is valid for a period of fifteen (15) days from the date thereof, subject to our confirmation thereafter.

Installation notes:

- 1 Location of indoor and outdoor units are not yet final for confirmation.recommendation only
- 2 Customer will provide a outdoor Bracket with ledge.
- 3 Customer needs to service door/access for the outdoor location, each unit.
- 4 Working days: Monday to Saturday, 4 pax without parking Bring harness and rope.
- 5 Need for site visit for final location and units.
- 6 As per maam merlina, owner friend will donate 2 units of 2.5hp AIRCON.
- 7 Mechanical Plans, Permits, Electrical permits not included.
- 8 Deflectors, masonry, carpentry, chipping & plastering (finishing & restoration) are not included in the installation.
- 9 Air conditioning drain line and Electrical power supply (feeder line) **220v/ 60hz/ 1ph** , should be provided by customer's contractor.

Prepared by:

Jeoffrey Dadios
Field Surveyor

Customer Conformee:

Signature Over Printed Name

Reviewed by:

Engr. Kenneth Zamora
Service Supervisor Shop and
Field Operation

June 14, 2024

MERLY HUA BE FAMILY ASSOCIATION

904 3rd floor G.Masangkay St. Brgy 296 Binondo Manila

0956-4076325

merlinagawdia@gmail.com

Please be informed that the air-conditioner you intend to purchase is under capacity as compared to the following unit that we proposed:

Location	Area	Kolin's Recommendation	Customer's Choice	Remarks
Events Area	170 sqm	3 units KLG-IF70-5G1M32	2 units KLG-IF70-5G1M32	Calculated Capacity 12.8 TR, undersize by 2.8TR

Since the unit of your choice is under capacity, it is probable that you may experience the following;

1. Capacity of the unit to cool the area will take longer or it will not cool the area at all that may lead to your dissatisfaction with the cooling performance of our unit.
2. Power consumption will be higher due to frequent running of compressor for not reaching the desired temperature within the normal parameter.
3. Useful life of compressor will be shortened due to excessive running beyond the normal run cycle.

Considering the above conditions, we regret to inform you that we cannot guarantee the efficient performance of unit. **Also, One (1) year warranty for parts (compressor-1year),**
If customer adds 2 units 2.5HP air conditioning unit capacity, will grant full compressor warranty from the date of purchase.

For your guidance and information

Prepared by:

Name
Surveyor

Approved by:

Mr. Alvin de Rivera
Service Manager

Noted by:

Eng. Kenneth Zamora
Service Supervisor - Field
and Shop Operation

Customer Conforme:

Signature Over Printed Name