



June 23, 2025

MR. BRYAN DY
UNIT 8, FIREFLY ST. WESTWOOD LANE VALLE VERDE, BRGY. UGONG, PASIG CITY
TEL#: 0917-8927939

Dear Ma'am/Sir,

Kolin Marketing Inc., is extremely honored for your endorsement of Kolin brand and we are please to offer you with a special price/s for the following items.

A. EQUIPMENT & INSTALLATION

QTY	U/M	MODEL / DESCRIPTION	SRP	DISCOUNTED PRICE		AMOUNT
1	UNIT/S	MODEL: KSG-IWF-25WFF-8K1M32 KOLIN WALL MOUNTED PRIMUS GOLD AIRCONDITIONER 25,560 Kj/h (2.5HP) FULL DC INVERTER W/ WIFI R-32	68,995.00	45,436.20	PHP	45,436.20
1	UNIT/S	MODEL: KSG-IWF-20WFF-8K1M32 KOLIN WALL MOUNTED PRIMUS GOLD AIRCONDITIONER 19,000 Kj/h (2.0HP) FULL DC INVERTER W/ WIFI R-32	59,595.00	38,292.20	PHP	38,292.20
1	UNIT/S	MODEL: KSG-IWF-15WFF-8K1M32 KOLIN WALL MOUNTED PRIMUS GOLD AIRCONDITIONER 12,960 Kj/h (1.5HP) FULL DC INVERTER W/ WIFI R-32	46,595.00	28,412.20	PHP	28,412.20
TOTAL UNIT COST					PHP	112,140.60
ESTIMATED COST OF INSTALLATION (please see attached)					PHP	49,520.00
OTHERS: DELIVERY CHARGE					PHP	600.00
TOTAL ESTIMATED COST OF THE PROJECT					PHP	162,260.60

TERMS OF PAYMENT:

FULL PAYMENT OF UNIT AND DELIVERY CHARGE. IF CHECK, SUBJECT FOR 3 DAYS CLEARING.

WARRANTY:

FOR SPLIT TYPE : ONE (1) YEAR FREE PARTS AND LABOR, THREE YEARS (3) MAIN PCB , TEN (10) YEARS WARRANTY ON COMPRESSOR.

NOTES: PRICES ARE SUBJECT TO CHANGE WITHOUT PRIOR NOTICE.

PRICES IS VAT INCLUSIVE.

**** Cost of Installation is Package with the Unit(s), this cost cannot avail separately (cost will be based on actual).**

***** You may settle first payment for unit/s & delivery. Installation payment can be settled directly to installer after actual works.**

We thank you for giving opportunity to offer our product and services, hoping we receive your purchase order.

If you need assistance, don't hesitate to call the under signed at 0917-807-8607 or email at kmi_asst@kolinphil.com.ph

Very Truly Yours,

JANELLEN S. LIM
KMI-ASSISTANT

Noted by:

MART NATHANIEL R. FLORES
KMI-SUPERVISOR

Approved By:

MS. EDITHA M. FLORES
AVP - FINANCE

KMI-QUOTE-06-25-0475-rev
ADR-24%/7K

Conforme:

SIGNATURE OVER PRINTED NAME

Kolin Marketing, Inc.

1854 Sta. Rita St., Guadalupe Nuevo, Makati City

Tel.: (632) 8852-6473

Fax: (632) 8852-2170 / (632) 8852-4792

www.kolinphil.com.ph / kolinphilippines

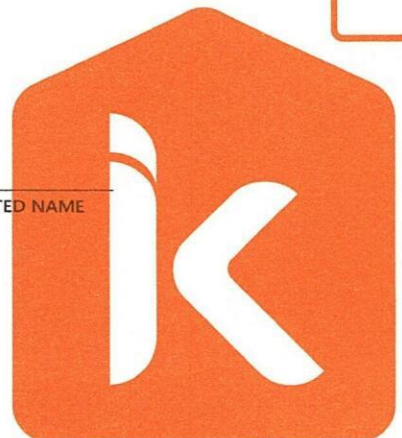

June 23, 2025

BRYAN DY

Unit 8, 15 Firefly St. Westwood Lane, Valle Verde Brgy Ugong Pasig City

0917-8927939

MODEL	Qty
KSG-IWF-25Wfy8K1M32	1
KSG-IWF-20Wfy8K1M32	1
KSG-IWF-15Wfy8K1M32	1

KITCHEN	Area	25 sqm
---------	------	--------

ACU 1 2.5 HP Wall Mounted Inverter KSG-IWF-25Wfy8K1M32

Estimated Pipe Length = 23 ft

Estimated Royal Cord Length = 28 ft

Initial Charge

₱ 8,500.00

Includes:

Labor

10ft Copper Tube

10ft Royal Cord

Outdoor Bracket (Wall)

Consumables

Installation Materials

Description	Qty	Price per qty	Subtotal
Copper Tube	13 ft	₱ 400.00/ft	₱ 5,200.00
Royal Cord (comm. wire)	18 ft	₱ 100.00/ft	₱ 1,800.00
Royal Cord (ACCU-Breaker)	5 ft	₱ 60.00/ft	₱ 300.00
Circuit Breaker waterproof	30A / 1Ph	1 pc/s ₱ 1,000.00/pc	₱ 1,000.00
Rubber Insulation	2 1/8" x 3/4" x 6"	2 pc/s ₱ 350.00/pc	₱ 700.00
Dismantle	1.5HP Wall Mounted	1 set ₱ 2,500.00/set	₱ 2,500.00
PVC blue	3/4" x 10'	2 pc/s ₱ 150.00/pc	₱ 300.00
			₱ 11,800.00

Estimated Charges

₱ 20,300.00

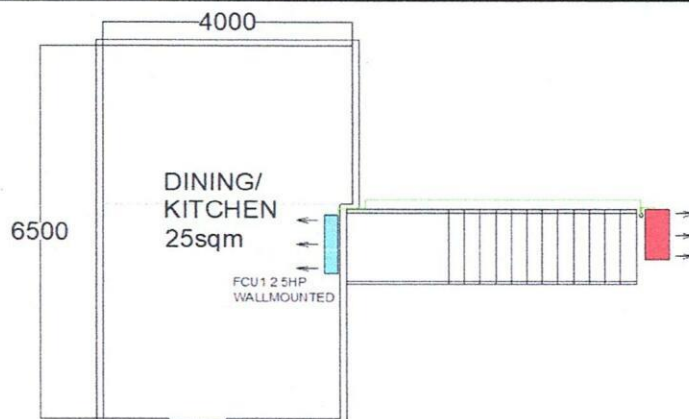

MASTER BEDROOM	Area	23 sqm
-----------------------	------	--------

ACU 2 2.0 HP Wall Mounted Inverter

KSG-IWF-20Wfy8K1M32

Estimated Pipe Length = 15 ft

Estimated Royal Cord Length = 20 ft

Initial Charge

P 7,500.00

Includes:

Labor

10ft Copper Tube

10ft Royal Cord

Outdoor Bracket (Wall)

Consumables

Installation Materials

Description	Qty	Price per qty	Subtotal
Copper Tube	5 ft	P 350.00/ft	P 1,750.00
Royal Cord (comm. wire)	10 ft	P 100.00/ft	P 1,000.00
Royal Cord (ACCU-Breaker)	5 ft	P 60.00/ft	P 300.00
Circuit Breaker waterproof	1 pc/s	P 1,000.00/pc	P 1,000.00
PVC blue	2 pc/s	P 150.00/pc	P 300.00
			P 4,350.00

Estimated Charges

P 11,850.00

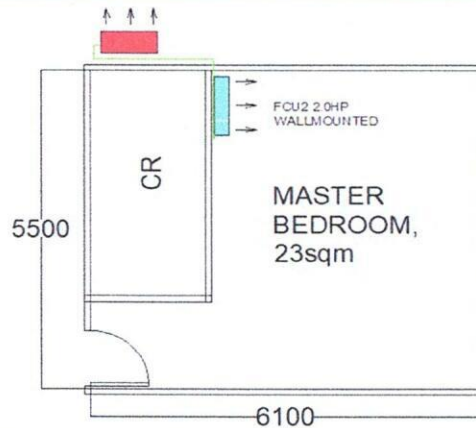

OFFICE	Area	14.8 sqm
---------------	------	----------

ACU 3 1.5 HP Wall Mounted Inverter

KSG-IWF-15Wfy8K1M32

Estimated Pipe Length = 27 ft

Estimated Royal Cord Length = 32 ft

Initial Charge

P 7,500.00

Includes:

Labor

10ft Copper Tube

10ft Royal Cord

Outdoor Bracket (Wall)

Consumables

Installation Materials

Description	Qty	Price per qty	Subtotal
Copper Tube	17 ft	P 350.00/ft	P 5,950.00
Royal Cord (comm. wire)	22 ft	P 100.00/ft	P 2,200.00
Royal Cord (ACCU-Breaker)	7 ft	P 60.00/ft	P 420.00
Circuit Breaker waterproof	1 pc/s	P 1,000.00/pc	P 1,000.00
PVC blue	2 pc/s	P 150.00/pc	P 300.00
			P 9,870.00

Estimated Charges

P 17,370.00

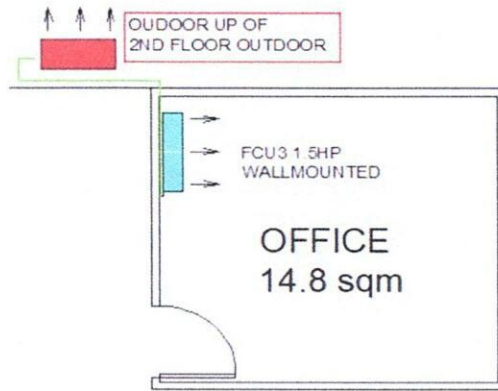

Total Estimated Charges

P 49,520.00

Validity: This quotation is valid for a period of fifteen (15) days from the date thereof, subject to our confirmation thereafter.

Installation notes:

- 1 Location of indoor and outdoor units were agreed by the customer and Kolin's surveyor.
- 2 AC drain line will be tapped to the nearest drain provision provided by the customer's contractor.
- 3 Need for site visit and markings of drainline and lay out of copper tube.
- 4 Working days: Monday to Saturday, 8am- 5pm with parking. Need working permit.
- 5 Mechanical Plans, Permits, Electrical permits not included.
- 6 Deflectors, masonry, carpentry, chipping & plastering (finishing & restoration) are not included in the installation.
- 7 Air conditioning drain line and Electrical power supply (feeder line) **220v/ 60hz/ 1ph** , should be provided by customer's contractor.
- 8 **Final charges will be based on actual installation.**

Prepared by:

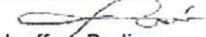
Jeffrey Dadios
 Field Surveyor

Customer Conformer:

 Signature Over Printed Name

Reviewed by:

Engr. Kenneth Zamora
 Service Supervisor Shop and
 Field Operation