



June 18, 2025

MR. MADISON DELA CRUZ
U-34LM MALATE BAYVIEW MANSION, 1781 M. ADRIATICO ST. BRGY. MALATE, MANILA CITY
TEL#: 0917-5277126

Dear Ma'am/Sir,

Kolin Marketing Inc., is extremely honored for your endorsement of Kolin brand and we are please to offer you with a special price/s for the following items.

A. EQUIPMENT & INSTALLATION

* OPTION 1 *

QTY	U/M	MODEL / DESCRIPTION	SRP	DISCOUNTED PRICE		AMOUNT
1	UNIT/S	MODEL: KSM-IW20-WCT10M1M32 KOLIN WALL MOUNTED CERTUS SERIES AIRCONDITIONER 18,990 KJ/h (2.0HP) REGULAR INVERTER R-32	41,995.00	27,916.20	PHP	27,916.20
TOTAL UNIT COST					PHP	27,916.20
ESTIMATED COST OF INSTALLATION (please see attached)					PHP	10,495.00
OTHERS: DELIVERY CHARGE					PHP	600.00
TOTAL ESTIMATED COST OF THE PROJECT					PHP	39,011.20

* OPTION 2 *

QTY	U/M	MODEL / DESCRIPTION	SRP	DISCOUNTED PRICE		AMOUNT
1	UNIT/S	MODEL: KSG-IWF-20WFF-8K1M32 KOLIN WALL MOUNTED PRIMUS GOLD AIRCONDITIONER 19,000 KJ/h (2.0HP) FULL DC INVERTER W/ WIFI R-32	59,595.00	38,292.20	PHP	38,292.20
TOTAL UNIT COST					PHP	38,292.20
ESTIMATED COST OF INSTALLATION (please see attached)					PHP	10,495.00
OTHERS: DELIVERY CHARGE					PHP	600.00
TOTAL ESTIMATED COST OF THE PROJECT					PHP	49,387.20

TERMS OF PAYMENT:

FULL PAYMENT OF UNIT AND DELIVERY CHARGE. IF CHECK, SUBJECT FOR 3 DAYS CLEARING.

WARRANTY:

FOR SPLIT TYPE : ONE (1) YEAR FREE PARTS AND LABOR, THREE YEARS (3) MAIN PCB , TEN (10) YEARS WARRANTY ON COMPRESSOR.

NOTES: PRICES ARE SUBJECT TO CHANGE WITHOUT PRIOR NOTICE.

PRICES IS VAT INCLUSIVE.

** Cost of Installation is Package with the Unit(s), this cost cannot avail separately (cost will be based on actual).

*** You may settle first payment for unit/s & delivery. Installation payment can be settled directly to installer after actual works.

We thank you for giving opportunity to offer our product and services, hoping we receive your purchase order.

If you need assistance, don't hesitate to call the under signed at 0917-807-8607 or email at kmi_asst@kolinphil.com.ph

Very Truly Yours,

JANELLEN S. LIM
KMI-ASSISTANT

Noted by:

MARTIN HANIEL B. FLORES
KMI-SUPERVISOR

Approved by:

MS. EDITHA M. FLORES
AVP - FINANCE

Conforme:

SIGNATURE OVER PRINTED NAME

KMI-QUOTE-06-25-0472
ECY-24%/4K/7K

Kolin Marketing, Inc.
1854 Sta. Rita St., Guadalupe Nuevo, Makati City
Tel.: (632) 8852-6473
Fax: (632) 8852-2170 / (632) 8852-4792
www.kolinphil.com.ph / kolinphilippines



KOLIN Philippines International Inc.
Survey Form

No 003659

Customer Name : MADISON DE LA CRUZ Date : 6-17-12
 Address : U-341M WALKER BLVD VIEW MADISON, 1781 SJR No. : 261106
XORUSTION ST. WALKER MADISON
 Establishment Type : Residential ☒ Area Surveyed : MADISON 2 BEDROOM
 Commercial ☐ Area Surveyed : _____
 Recommended Product Model : LSG-WF-20WFX-8K1M32

Cooling Capacity Computation

Floor Area : 17 sqm.
 Ceiling Height : 2.6 mtr.

note: add 20% per meter in excess of 3 meters in the initial cooling capacity computed.

Floor Area :	<u>17</u>	x	550 Btu/h	<u>9350</u> Btu/h
Ceiling Height (excess of 3 mtrs.) :		x	20%	
Window Direct Sunlight		x	20% - 50%	<u>1870</u> Btu/h
Total Cooling Capacity				<u>11,220</u> Btu/h

Add : Additional Heat Load

No. of Person	<u>2</u>	x	300 Btu/h	<u>600</u> Btu/h
No. of Ordinary Light (<40w)	<u>12</u>	x	200 Btu/h	<u>2400</u> Btu/h
No. of Special Light (>40w)		x	400 Btu/h	
No. of Refrigerator (< 6 cu.ft.)		x	400 Btu/h	
No. of Refrigerator (> 6 cu.ft.)		x	800 Btu/h	
No. of Cooking Range		x	1500 Btu/h	
No. of Laptop Computer		x	150 Btu/h	
No. of Desktop Computer <u>1</u>	<u>1</u>	x	400 Btu/h	<u>400</u> Btu/h
No. of Printer		x	500 Btu/h	
No. of Photocopier		x	1000 Btu/h	
Total Cooling Capacity				<u>3400</u> Btu/h

Recommended Cooling Capacity

14620 Btu/h

Note : Compressor warranty will be reduced to ____ yr. if air-conditioner purchased is lower than the recommended cooling capacity or pipe lay-out is beyond the maximum allowable length.

Scope of Work Agreement

- | | | |
|-----------------------------------|--|--|
| 1. Copper tube lay-out | <input checked="" type="checkbox"/> Expose | <input type="checkbox"/> Embedded |
| 2. Chipping | <input type="checkbox"/> Included | <input checked="" type="checkbox"/> Not Included |
| 3. Fabricated Bracket | <input type="checkbox"/> Yes <input type="checkbox"/> Shop | <input type="checkbox"/> Site <input checked="" type="checkbox"/> No |
| 4. Service Ledge | <input type="checkbox"/> Yes | <input checked="" type="checkbox"/> No |
| 5. Dismantling of existing Aircon | <input checked="" type="checkbox"/> Included | <input type="checkbox"/> Not Included |
| 6. Ducting | <input type="checkbox"/> Yes | <input checked="" type="checkbox"/> No |

Dimension : _____

- Plastering, carpentry and restoration works are to be done by the customer.
- Wiring of electrical supply from main panel to air-conditioning unit are to be done by the customer.
- Processing of mechanical plan, working permit, electrical permit are to be done by the customer.
- Other concern; DEMOLITION AND INSTALL OF NEW UNIT

TRIM WOOD FOR BACKING, USE EXISTING
OUTSIDE BRACKET & BRACKET, NEED PERMIT.

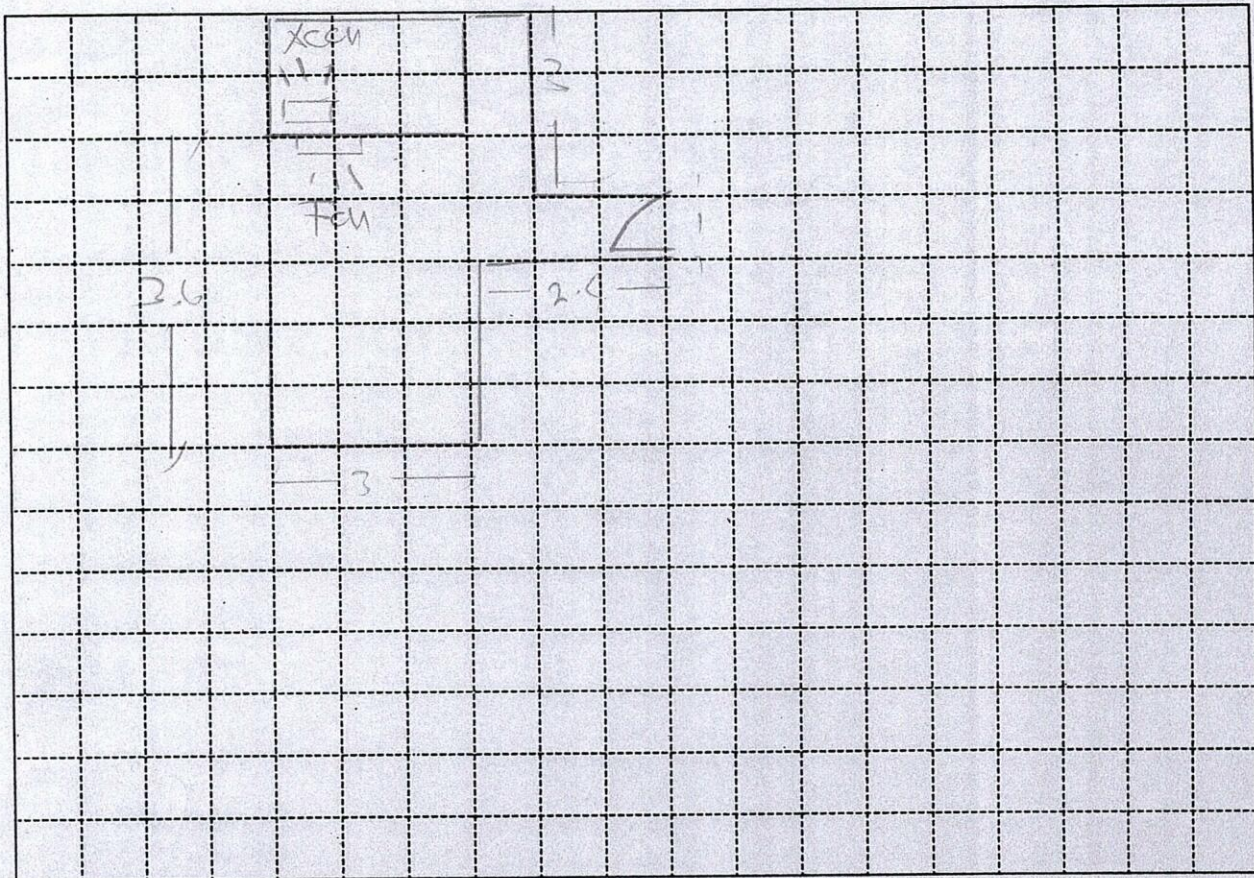

Indoor Unit Location : SAME LOCATION, LEFT OF WALL
 Outdoor Unit Location : AT THE BACK SAME LOCATION
 Pipe Length : 10 FT
 Special Note :

Installation Cost Estimate			
Material Description	Qty.	Unit Cost	Total Cost
Copper Tube (excess of 10 ft.) 2330, 2430, 2520, 3520, 4620			
Wire (Royal Cord-signal wire) (excess of 10ft.) 2.0mmx4C	7 FT	100	700
Wire (Royal Cord - Breaker to ODU) 3.5mm / 5.5mm x 3C	7 FT	60	420
Circuit Breaker 20A, 30A, 40A/1ph, 40A/3ph			
Bracket (ODU) (Imptd. / Fabricated) ; (Floor / Wall)			
Bracket (WAC) Angle Type			
PVC Pipe (drain) 1/2" , 3/4"			
PVC Pipe (electrical) 3/4" , 1"			
Drain Pump			
Drain Pump Hose WHITE 1/2" mtr.	7 FT	25	175
Chipping Works			
Dismantling Fee (existing air-conditioner) 20 HP			250
Initial Charge FEE SURVEY (400000)			670
TOTAL ESTIMATE		P	10,445

Note :

1. Initial Charge includes labor, 10ft. Copper tube, 10ft. Royal cord, Circuit breaker, Outdoor Bracket (SAC), Indoor Bracket (PAC) and Consumable materials.
2. Survey fee will be **deducted** in the installation fee.

Prepared by:

Signature Over Printed Name

Customer Conforme:

Signature Over Printed Name