



October 16, 2024

MR. MERVIN YAPSON
201 V. CRUZ ST., BRGY. STA LUCIA, SAN JUAN CITY
TEL#: 0917-5380729

Dear Ma'am/Sir,

Kolin Marketing Inc., is extremely honored for your endorsement of Kolin brand and we are please to offer you with a special price/s for the following items.

A. EQUIPMENT & INSTALLATION

** UNIT 1 - BAR

QTY	U/M	MODEL / DESCRIPTION	SRP	DISCOUNTED PRICE		AMOUNT
1	UNIT/S	MODEL: KSM-IW20-WCT10M1M32 KOLIN WALL MOUNTED CERTUS SERIES AIRCONDITIONER 18,990 Kj/h (2.0HP) REGULAR INVERTER R-32	41,995.00	28,756.10	PHP	28,756.10
TOTAL UNIT COST					PHP	28,756.10
ESTIMATED COST OF INSTALLATION (please see attached)					PHP	13,245.00
OTHERS: DELIVERY CHARGE					PHP	600.00
TOTAL ESTIMATED COST OF THE PROJECT					PHP	42,601.10

** UNIT 2 - BAR

QTY	U/M	MODEL / DESCRIPTION	SRP	DISCOUNTED PRICE		AMOUNT
1	UNIT/S	MODEL: KSM-IW20-WCT10M1M32 KOLIN WALL MOUNTED CERTUS SERIES AIRCONDITIONER 18,990 Kj/h (2.0HP) REGULAR INVERTER R-32	41,995.00	28,756.10	PHP	28,756.10
TOTAL UNIT COST					PHP	28,756.10
ESTIMATED COST OF INSTALLATION (please see attached)					PHP	10,095.00
TOTAL ESTIMATED COST OF THE PROJECT					PHP	38,851.10

TERMS OF PAYMENT:

FULL PAYMENT OF UNIT AND DELIVERY CHARGE. IF CHECK, SUBJECT FOR 3 DAYS CLEARING.

WARRANTY:

FOR SPLIT TYPE : ONE (1) YEAR FREE PARTS AND LABOR, THREE YEARS (3) MAIN PCB , TEN (10) YEARS WARRANTY ON COMPRESSOR.

NOTES: PRICES ARE SUBJECT TO CHANGE WITHOUT PRIOR NOTICE.

PRICES IS VAT INCLUSIVE.

We thank you for giving opportunity to offer our product and services, hoping we receive your purchase order.

If you need assistance, don't hesitate to call the under signed at 0917-807-8607 or email at kmi_asst@kolinphil.com.ph

** Cost of Installation is Package with the Unit(s), this cost cannot avail separately.

Very Truly Yours,

JANELLEN S. LIM
KMI ASSISTANT

Noted by:
MARTIN MANUEL E. FLORES
KMI SUPERVISOR

Approved By: 10/16/24
for. Editha M. Flores
MS. EDITHA M. FLORES
AVP - FINANCE

KMI-QUOTE-10-24-0892
REG-22%/4K

Conforme: SIGNATURE OVER PRINTED NAME

Kolin Marketing, Inc.
1854 Sta. Rita St., Guadalupe Nuevo, Makati City
Tel.: (632) 8852-6473
Fax: (632) 8852-2170 / (632) 8852-4792
www.kolinphil.com.ph / kolinphilippines

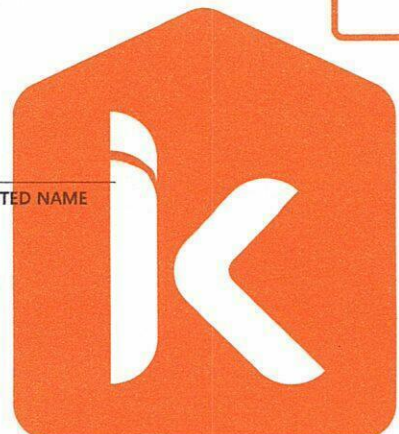

Customer Name : MERZ-VIN YAPSON Date : 10-14-20
 Address : 201 V CRUZ ST - B26Y SKNDA LUCIA SAN JUAN SJR No : 225789

Establishment Type : Residential ☒ Area Surveyed : 7342
 Commercial ☐ Area Surveyed : _____

Recommended Product Model : KSM 1W20-WCT/4m/1m32

Cooling Capacity Computation

Floor Area : 49.4 sqm.
 Ceiling Height : 3.0 mtr.

note: add 20% per meter in excess of 3 meters in the initial cooling capacity computed.

Floor Area :	<u>49.4</u>	x	550 Btu/h	<u>27170</u>	Btu/h
Ceiling Height (excess of 3 mtrs.) :	_____	x	20%	_____	Btu/h
Window Direct Sunlight	_____	x	20% - 50%	_____	Btu/h
Total Cooling Capacity				<u>27170</u>	Btu/h

Add : Additional Heat Load

No. of Person	<u>15</u>	x	300 Btu/h	<u>4500</u>	Btu/h
No. of Ordinary Light (<40w)	<u>20</u>	x	200 Btu/h	<u>4000</u>	Btu/h
No. of Special Light (>40w)	_____	x	400 Btu/h	_____	Btu/h
No. of Refrigerator (< 6 cu.ft.)	_____	x	400 Btu/h	_____	Btu/h
No. of Refrigerator (> 6 cu.ft.)	_____	x	800 Btu/h	_____	Btu/h
No. of Cooking Range	_____	x	1500 Btu/h	_____	Btu/h
No. of Laptop Computer	_____	x	150 Btu/h	_____	Btu/h
No. of Desktop Computer	_____	x	400 Btu/h	_____	Btu/h
No. of Printer	_____	x	500 Btu/h	_____	Btu/h
No. of Photocopier	_____	x	1000 Btu/h	_____	Btu/h
Total Cooling Capacity				<u>28000</u>	Btu/h

Recommended Cooling Capacity 33900 Btu/h

Note : Compressor warranty will be **reduced to** _____ yr. if air-conditioner purchased is lower than the recommended cooling capacity or pipe lay-out is beyond the maximum allowable length.

Scope of Work Agreement

- | | | |
|-----------------------------------|---|--|
| 1. Copper tube lay-out | <input checked="" type="checkbox"/> Expose | <input type="checkbox"/> Embedded |
| 2. Chipping | <input type="checkbox"/> Included | <input checked="" type="checkbox"/> Not Included |
| 3. Fabricated Bracket | <input checked="" type="checkbox"/> Yes <input type="checkbox"/> Shop | <input checked="" type="checkbox"/> Site <input type="checkbox"/> No |
| 4. Service Ledge | <input type="checkbox"/> Yes | <input checked="" type="checkbox"/> No |
| 5. Dismantling of existing Aircon | <input type="checkbox"/> Included | <input checked="" type="checkbox"/> Not Included |
| 6. Ducting | <input type="checkbox"/> Yes | <input checked="" type="checkbox"/> No |

Dimension : _____

7. Plastering, carpentry and restoration works are to be done by the customer.
 8. Wiring of electrical supply from main panel to air-conditioning unit are to be done by the customer.
 9. Processing of mechanical plan, working permit, electrical permit are to be done by the customer.
 10. Other concern: CUSTOMER NEED TO PROVIDE POWER SUPPLY AT THE OUTSIDE LOCK-UP. WITH PARKING & POX. NEED TO OPERATE 2 UNITS AT THE SAME TIME TO AVOID IMPROPER CAPACITY.

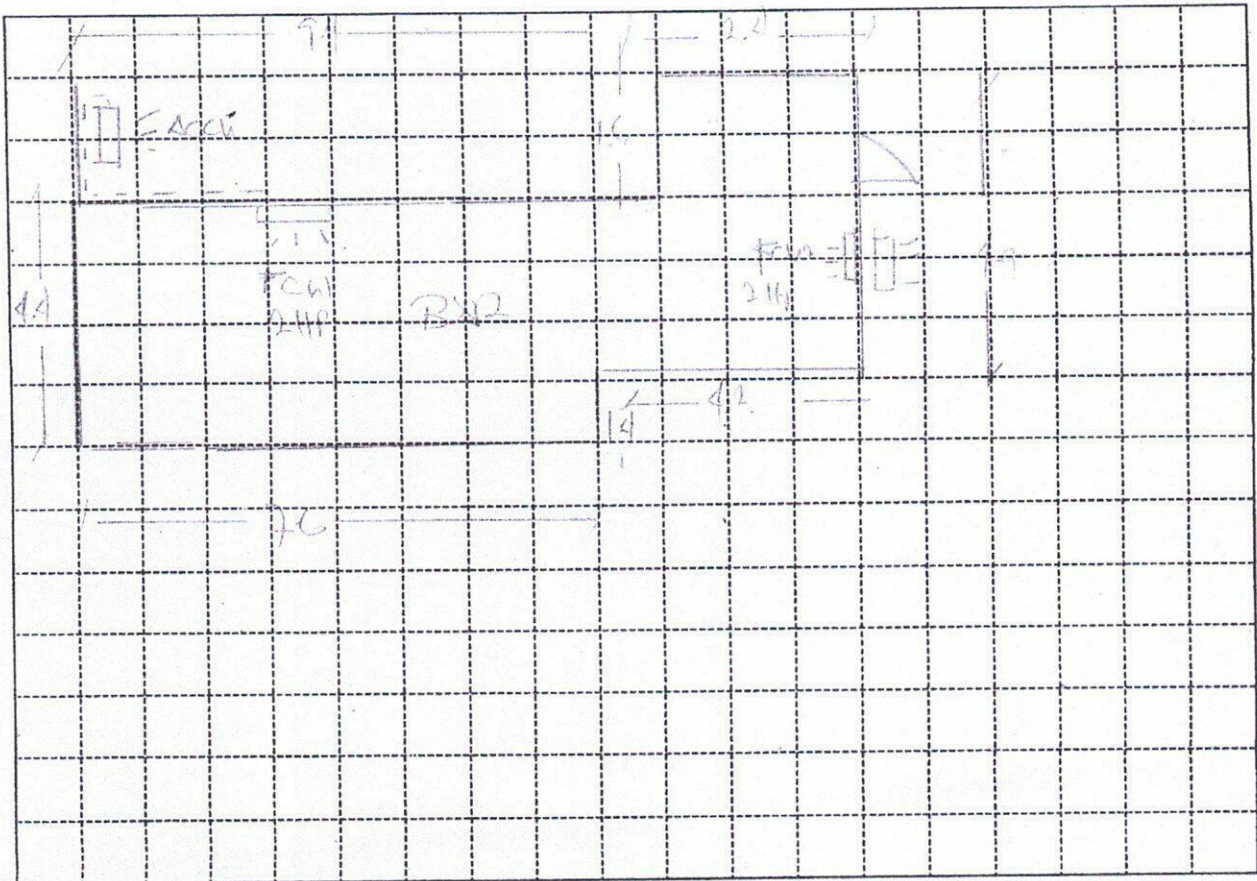

Indoor Unit Location : UP OF SLIDING DOOR CENTER
 Outdoor Unit Location : AT THE OPEN AREA UP
 Pipe Length : 17FT
 Special Note :

Installation Cost Estimate			
Material Description	Qty.	Unit Cost	Total Cost
Copper Tube (excess of 10 ft.) 2330, 2430, 2520, 3520, 4620	7FT	350	2450
Wire (Royal Cord-signal wire) (excess of 10ft.) 2.0mmx4C	14FT	100	1400
Wire (Royal Cord - Breaker to ODU) 3.5mm / 5.5mm x 3C	7FT	60	420
Circuit Breaker 20A, 30A, 40A/1ph, 40A/3ph	1	1000	1000
Bracket (ODU) (Imptd / I) ; (Floor / Wall)	1		
Bracket (WAC) Angle Type			
PVC Pipe (drain) 1/2", 3/4"	2pc	150	300
PVC Pipe (electrical) 3/4", 1"			
Drain Pump			
Drain Pump Hose (WATER)	7FT	25	175
Chipping Works mtr.			
Dismantling Fee (existing air-conditioner)			
Initial Charge			750
TOTAL ESTIMATE		P 13250-	

Note :

1. Initial Charge includes labor, 10ft. Copper tube, 10ft. Royal cord, Circuit breaker, Outdoor Bracket (SAC), Indoor Bracket (PAC) and Consumable materials.
2. Survey fee will be **deducted** in the installation fee.

Prepared by:

JEFFREY D20/05
 Signature Over Printed Name

Customer Conforme:

Miguel
 Signature Over Printed Name

KOLIN Philippines International Inc.
Survey Form *Unit 2*

No 003551

Customer Name : *MARVIN YAPSON* Date : *10-14-2011*
 Address : *201 N. CUMBER ST. BPO, STA. LUNA, SAMA* SJR No. : *725769*

Establishment Type : Residential ☒ Area Surveyed : *B2R*
 Commercial ☐ Area Surveyed : _____

Recommended Product Model : *KSM 1020-1070/1M32*

Cooling Capacity Computation

Floor Area : *49.4* sqm.
 Ceiling Height : *2* mtr.
 note: add 20% per meter in excess of 3 meters in the initial cooling capacity computed.

Floor Area :	<i>49.4</i>	x	550 Btu/h	<i>27170</i>	Btu/h
Ceiling Height (excess of 3 mtrs.) :		x	20%		Btu/h
Window Direct Sunlight		x	20% - 50%		Btu/h
Total Cooling Capacity				<i>27170</i>	Btu/h

Add : Additional Heat Load

No. of Person	<i>15</i>	x	300 Btu/h	<i>4500</i>	Btu/h
No. of Ordinary Light (<40w)	<i>20</i>	x	200 Btu/h	<i>4000</i>	Btu/h
No. of Special Light (>40w)		x	400 Btu/h		Btu/h
No. of Refrigerator (< 6 cu.ft.)		x	400 Btu/h		Btu/h
No. of Refrigerator (> 6 cu.ft.)		x	800 Btu/h		Btu/h
No. of Cooking Range		x	1500 Btu/h		Btu/h
No. of Laptop Computer		x	150 Btu/h		Btu/h
No. of Desktop Computer		x	400 Btu/h		Btu/h
No. of Printer		x	500 Btu/h		Btu/h
No. of Photocopier		x	1000 Btu/h		Btu/h
Total Cooling Capacity				<i>8500</i>	Btu/h

Recommended Cooling Capacity *8500* Btu/h

Note : Compressor warranty will be reduced to ____ yr. if air-conditioner purchased is lower than the recommended cooling capacity or pipe lay-out is beyond the maximum allowable length.

Scope of Work Agreement

- | | | |
|-----------------------------------|--|---|
| 1. Copper tube lay-out | <input checked="" type="checkbox"/> Expose | <input type="checkbox"/> Embedded |
| 2. Chipping | <input type="checkbox"/> Included | <input type="checkbox"/> Not Included |
| 3. Fabricated Bracket | <input type="checkbox"/> Yes <input type="checkbox"/> Shop | <input type="checkbox"/> Site <input type="checkbox"/> No |
| 4. Service Ledge | <input type="checkbox"/> Yes | <input checked="" type="checkbox"/> No |
| 5. Dismantling of existing Aircon | <input type="checkbox"/> Included | <input type="checkbox"/> Not Included |
| 6. Ducting | <input type="checkbox"/> Yes | <input type="checkbox"/> No |

Dimension : _____

- Plastering, carpentry and restoration works are to be done by the customer.
- Wiring of electrical supply from main panel to air-conditioning unit are to be done by the customer.
- Processing of mechanical plan, working permit, electrical permit are to be done by the customer.
- Other concern; *2nd UNIT, NEED TO OPTIMIZE 2 UNIT AT THE SAME TIME TO AVOID UNNECESSARY COSTS. CUSTOMER HOW TO PROVIDE POWER SUPPLY AT THE OUTDOOR UNIT (LO ATION)*

PLEASE SEE REFERENCE
SWITCH FORM # 3541

Indoor Unit Location : UP OF WINDOW, NEXT ACX2
 Outdoor Unit Location : AT THE BACK, UP OF EXTERIOR
 Pipe Length : 10FT
 Special Note :

Installation Cost Estimate			
Material Description	Qty.	Unit Cost	Total Cost
Copper Tube (excess of 10 ft.) 2330, 2430, 2520, 3520, 4620			
Wire (Royal Cord-signal wire) (excess of 10ft.) 2.0mmx4C	100	700	700
Wire (Royal Cord - Breaker to ODU) 3.5mm / 5.5mm x 3C	60	400	400
Circuit Breaker 20A, 30A, 40A/1ph, 40A/3ph	1	1000	1000
Bracket (ODU) (Imptd. / Fabricated) ; (Floor / Wall)			
Bracket (WAC) Angle Type			
PVC Pipe (drain) 1/2" / 3/4"	200	300	300
PVC Pipe (electrical) 3/4" , 1"			
Drain Pump			
Drain Pump Hose 1/2"	100	175	175
Chipping Works mtr.			
Dismantling Fee (existing air-conditioner)			1000
Initial Charge			
TOTAL ESTIMATE		P	10,095

Note :

- Initial Charge includes labor, 10ft. Copper tube, 10ft. Royal cord, Circuit breaker, Outdoor Bracket (SAC), Indoor Bracket (PAC) and Consumable materials.
- Survey fee will be deducted in the installation fee.

Prepared by:

JEOPHY D. DAVOS
 Signature Over Printed Name

Customer Conform:

Mariano G. G. G.
 Signature Over Printed Name