

kolin

air conditioner

August 7, 2024

MS. EVELYN CHEN

TOWER 1 UNIT 3108, MILLER AVE. COR. PACIFIC, ROYAL PACIFIC RES. BRGY. DON GALO, PARAÑAQUE CITY

TEL #: 0917-8991299

Dear Ma'am/Sir,

Kolin Marketing Inc., is extremely honored for your endorsement of Kolin brand and we are please to offer you with a special price/s for the following items.

A. EQUIPMENT & INSTALLATION

QTY	U/M	MODEL / DESCRIPTION	SRP	DISCOUNTED PRICE		AMOUNT
1	UNIT/S	MODEL: KSM-IW25-WCT10M1M32 KOLIN WALL MOUNTED CERTUS AIRCONDITIONER 23,210 Kj/h (2.5HP) REGULAR INVERTER W/ WIFI R-32	49,995.00	34,996.10	PHP	34,996.10
2	UNIT/S	MODEL: KSM-IW15-WCT10M1M32 KOLIN WALL MOUNTED CERTUS SERIES AIRCONDITIONER 12,660 Kj/h (1.5HP) REGULAR INVERTER R-32	32,995.00	21,736.10	PHP	43,472.20
TOTAL UNIT COST					PHP	78,468.30
ESTIMATED COST OF INSTALLATION (please see attached)					PHP	32,035.00
TOTAL:					PHP	110,503.30
LESS: 5% DISCOUNT ON ESTIMATED COST OF INSTALLATION					PHP	(1,601.75)
LESS: SURVEY FEE					PHP	(500.00)
TOTAL ESTIMATED COST OF THE PROJECT					PHP	108,401.55

TERMS OF PAYMENT:

FULL PAYMENT OF UNIT AND DELIVERY CHARGE. IF CHECK, SUBJECT FOR 3 DAYS CLEARING.

WARRANTY:

FOR SPLIT TYPE : ONE (1) YEAR FREE PARTS AND LABOR, THREE YEARS (3) MAIN PCB , TEN (10) YEARS WARRANTY ON COMPRESSOR.

NOTES: PRICES ARE SUBJECT TO CHANGE WITHOUT PRIOR NOTICE.

PRICES IS VAT INCLUSIVE.

**** Cost of Installation is Package with the Unit(s), this cost cannot avail separately.**

****Actual 5% discount will be deducted on the final costing of installation based on actual works.**

We thank you for giving opportunity to offer our product and services, hoping we receive your purchase order.

If you need assistance, don't hesitate to call the under signed at 0917-807-8607 or email at kmi_asst@kolinphil.com.ph

Very Truly Yours,

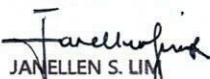
JANELLEN S. LIM
KMI-ASSISTANT

Noted by:

MART NATHANIEL R. FLORES
KMI-SUPERVISOR

Approved By:

MS. EDITHA M. FLORES
AVP - FINANCE

Conforme:

SIGNATURE OVER PRINTED NAME

EST. 1996

KMI-QUOTE-08-24-0701

REG-22%/4K

Kolin Marketing, Inc.

1854 Sta. Rita St., Guadalupe Nuevo, Makati City

www.kolinphil.com.ph

Tel.: (632) 8852-6473

Fax: (632) 8852-2170 / (632) 8852-4792

Bringing comfort to your home.

August 1, 2024

EVELYN CHEN

Tower 1 Unit 3108, Miller Ave. Cor. Pacific, Royal Pacific Res. Brgy Don Galo Paranaque City

0917-899-1299

MODEL	Qty
KSM-IW25-WCT10M1M32	1
KSM-IW15-WCT10M1M32	2

LIVING/DINING/KITCHEN		Area	35 sqm
-----------------------	--	------	--------

ACU 1 2.5 HP WALL Mounted Inverter *KSM-IW25-WCT10M1M32*
 Estimated Pipe Length = 10 ft
 Estimated Royal Cord Length = 10 ft
Initial Charge ₱ 8,500.00

Includes:

Labor

10ft Copper Tube

10ft Royal Cord

Outdoor Bracket (floor)

Consumables

Installation Materials	Description	Qty	Price per qty	Subtotal
Royal Cord (ACCU-Breaker)	3.5mm x 3c	7 ft	₱ 60.00/ft	₱ 420.00
Chipping Works	drainline and coppertu	1 mtr	₱ 500.00/mtr	₱ 500.00
Leaktest	1/4" x 1/2"	1 set	₱ 1,800.00/set	₱ 1,800.00
Drain Hose	White -1/2"	5 ft	₱ 25.00/ft	₱ 125.00
				₱ 2,845.00

Estimated Charges	₱ 11,345.00
--------------------------	--------------------

MASTER BEDROOM/ ROOM1		Area	14 sqm
-----------------------	--	------	--------

ACU 2 1.5 HP WALL Mounted Inverter *KSM-IW15-WCT10M1M32*
 Estimated Pipe Length = 10 ft
 Estimated Royal Cord Length = 10 ft
Initial Charge ₱ 7,500.00

Includes:

Labor

10ft Copper Tube

10ft Royal Cord

Outdoor Bracket (Floor)

Consumables

Installation Materials	Description	Qty	Price per qty	Subtotal
Royal Cord (ACCU-Breaker)	3.5mm x 3c	7 ft	₱ 60.00/ft	₱ 420.00
Chipping Works	drainline and coppertu	1 mtr	₱ 500.00/mtr	₱ 500.00
Leaktest	1/4" x 1/2"	1 set	₱ 1,800.00/set	₱ 1,800.00
Drain Hose	White -1/2"	5 ft	₱ 25.00/ft	₱ 125.00
				₱ 2,845.00

Estimated Charges	₱ 10,345.00
--------------------------	--------------------

GUESTROOM /ROOM 2		Area	11.4 sqm
-------------------	--	------	----------

ACU 3 1.5 HP WALL Mounted Inverter *KSM-IW15-WCT10M1M32*
 Estimated Pipe Length = 10 ft
 Estimated Royal Cord Length = 10 ft
Initial Charge ₱ 7,500.00

Includes:

Labor

10ft Copper Tube

10ft Royal Cord

Outdoor Bracket (floor)

Consumables

Installation Materials	Description	Qty	Price per qty	Subtotal
Royal Cord (ACCU-Breaker)	3.5mm x 3c	7 ft	₱ 60.00/ft	₱ 420.00
Chipping Works	drainline and coppertu	1 mtr	₱ 500.00/mtr	₱ 500.00
Leaktest	1/4" x 1/2"	1 set	₱ 1,800.00/set	₱ 1,800.00
Drain Hose	White -1/2"	5 ft	₱ 25.00/ft	₱ 125.00
				₱ 2,845.00

Estimated Charges	₱ 10,345.00
--------------------------	--------------------

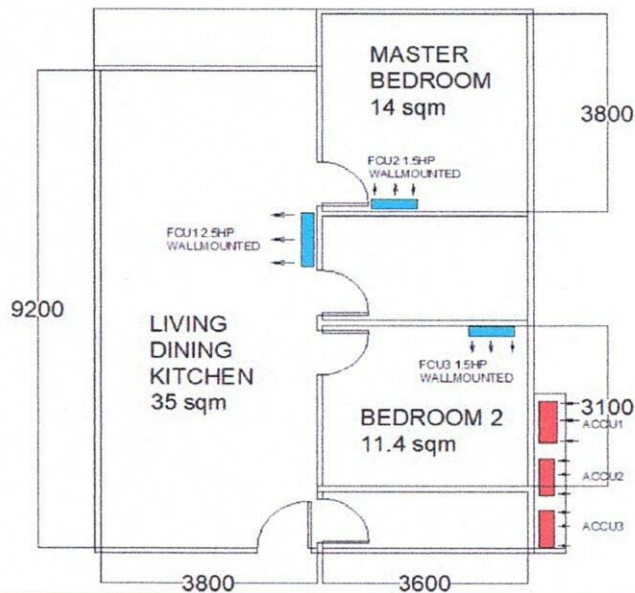

Total Estimated Charges P 32,035.00

Validity: This quotation is valid for a period of fifteen (15) days from the date thereof, subject to our confirmation thereafter.

Installation notes:

- 1 Location of indoor and outdoor units were agreed by the customer and Kolin's surveyor.
- 2 AC drain line will be tapped to the nearest drain provision provided by the customer's contractor.
- 3 **Leaktest,draintest and chip the wall for adjust of coppertube and drainline. With lay out already 1/4" x 1/2" 5 wires, All areas. And restore by customer.**
- 4 Working days: Monday to Saturday, 8am- 5pm without parking.Need working permit and entry form.
- 5 Mechanical Plans, Permits, Electrical permits not included.
- 6 Deflectors, masonry, carpentry, chipping & plastering (finishing & restoration) are not included in the installation.
- 7 Air conditioning drain line and Electrical power supply (feeder line) **220v/ 60hz/ 1ph** , should be provided by customer's contractor.
- 8 **Final charges will be based on actual installation.**

Prepared by:

Jeffrey Dadios
Field Surveyor

Customer Conformance:

Signature Over Printed Name

Reviewed by:

Engr. Kenneth Zamora
Service Supervisor Shop and
Field Operation