

kolin

air conditioner

February 1, 2024

ATTN: MS. LI ANNE SALIENTES
CONVENIENCE STORE OF SATORI RESIDENCES BY DMCI HOMES,
B1 20 FELICIANO PASCO, PASIG CITY
Tel: 0917-721-3139

Dear Ma'am/Sir,

Kolin Marketing Inc., is extremely honored for your endorsement of Kolin brand and we are please to offer you with a special price/s for the following items.

A. EQUIPMENT & INSTALLATION

QTY	U/M	MODEL / DESCRIPTION	SRP	DISCOUNTED PRICE		AMOUNT
2	UNIT/S	MODEL: KSG-IWF-30WFF-8K1M32 KOLIN WALL MOUNTED PRIMUS GOLD AIRCONDITIONER 29,500 Kj/h (3.0HP) FULL DC INVERTER W/ WIFI R-32	74,995.00	54,496.10	PHP	108,992.20
ESTIMATED COST OF INSTALLATION (please see attached)					PHP	45,750.00
OTHERS: DELIVERY CHARGE					PHP	600.00
TOTAL ESTIMATED COST OF THE PROJECT					PHP	155,342.20

TERMS OF PAYMENT:

FULL PAYMENT OF UNIT AND DELIVERY CHARGE. IF CHECK, SUBJECT FOR 3 DAYS CLEARING.

WARRANTY:

FOR SPLIT TYPE (Commercial): ONE (1) YEAR FREE PARTS AND LABOR, THREE (3) YEARS WARRANTY ON COMPRESSOR.

NOTES: PRICES ARE SUBJECT TO CHANGE WITHOUT PRIOP NOTICE.

PRICES IS VAT INCLUSIVE.

INSTALLATION C/O AUTHORIZED SERVICE CENTER.

**** Cost of Installation is Package with the Unit(s), this cost cannot avail separately.**

We thank you for giving opportunity to offer our product and services, hoping we receive your purchase order.

If you need assistance, don't hesitate to call the under signed at 0917-807-8607 or email at kmi_asst@kolinphil.com.ph

Very Truly Yours,

GLORIA TIFFANY T. ABESAMIS
KMI-ASSISTANT

Noted By:

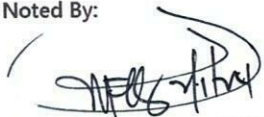
MART NATHANIEL R. FLORES
KMI-SUPERVISOR

KMI-QUOTE-02-24-0116
REG-22%/4k

Approved By:

MS. EDITHA M. FLORES
AVP - FINANCE

Conforme:

SIGNATURE OVER PRINTED NAME

Kolin Marketing, Inc.

1854 Sta. Rita St., Guadalupe Nuevo, Makati City

www.kolinphil.com.ph

Tel.: (632) 8852-6473

Fax: (632) 8852-2170 / (632) 8852-4792

Bringing comfort to your home.

February 1, 2024

LIA ANNE

SATORI RESIDENCES SANTOLAN PASIG

Contact no

Email address

MODEL	Qty
KSG-IWF-30Wfy8K1M	2

STORE	Area
	62.7 sqm

ACU 1	3.0 HP Wall Mounted Inverter	KSG-IWF-30Wfy8K1M32
	Estimated Pipe Length = 23 ft	
	Estimated Royal Cord Length = 28 ft	
	Initial Charge	P 4,700.00
	Includes:	
	Labor	
	10ft Copper Tube	
	10ft Royal Cord	
	Consumables	
	Installation Materials	
	Description	Qty Price per qty Subtotal
	Copper Tube	Ø 1/4" x Ø 5/8" 13 ft P 400.00/ft P 5,200.00
	Royal Cord (comm. wire)	2.mm2 x 4C 18 ft P 100.00/ft P 1,800.00
	Royal Cord (ACCU-Breaker)	3.5mm x 3c 5 ft P 60.00/ft P 300.00
	Circuit Breaker waterproof	30A / 1Ph 1 pc/s P 1,000.00/pc P 1,000.00
	Outdoor bracket	Fab. wall w/ledge 1 pc/s P 6,500.00/pc P 6,500.00
	Drain Hose	White -1/2" 5 ft P 25.00/ft P 125.00
		P 14,925.00

Estimated Charges	P 19,625.00
-------------------	-------------

ACU 2	3.0 HP Wall Mounted Inverter	KSG-IWF-30Wfy8K1M32
	Estimated Pipe Length = 36 ft	
	Estimated Royal Cord Length = 41 ft	
	Initial Charge	P 4,700.00
	Includes:	
	Labor	
	10ft Copper Tube	
	10ft Royal Cord	
	Consumables	
	Installation Materials	
	Description	Qty Price per qty Subtotal
	Copper Tube	Ø 1/4" x Ø 5/8" 26 ft P 400.00/ft P 10,400.00
	Royal Cord (comm. wire)	2.mm2 x 4C 31 ft P 100.00/ft P 3,100.00
	Royal Cord (ACCU-Breaker)	3.5mm x 3c 5 ft P 60.00/ft P 300.00
	Circuit Breaker waterproof	30A / 1Ph 1 pc/s P 1,000.00/pc P 1,000.00
	Outdoor bracket	Fab. wall w/ledge 1 pc/s P 6,500.00/pc P 6,500.00
	Drain Hose	White -1/2" 5 ft P 25.00/ft P 125.00
		P 21,425.00

Estimated Charges	P 26,125.00
-------------------	-------------

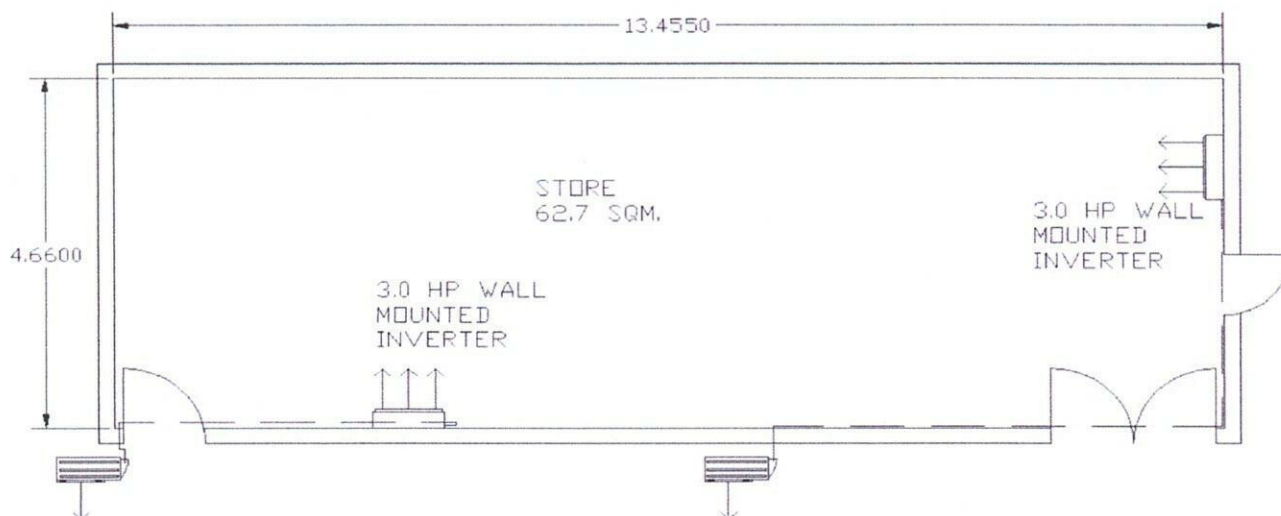

Total Estimated Charges

P 45,750.00

Validity: This quotation is valid for a period of fifteen (15) days from the date thereof, subject to our confirmation thereafter.

Installation notes:

- 1 Location of indoor and outdoor units were agreed by the customer and Kolin's surveyor.
- 2 Mechanical Plans, Permits, Electrical permits not included.
- 3 Deflectors, masonry, carpentry, chipping & plastering (finishing & restoration) are not included in the installation.
- 4 Air conditioning drain line and Electrical power supply (feeder line) **220v/ 60hz/ 1ph**, should be provided by customer's contractor.
- 5 **Final charges will be based on actual installation.**

Prepared by:

Customer Conformer:

Rodolfo dela Cruz Jr.

Field Surveyor

Signature Over Printed Name

Reviewed by:

Engr. Kenneth Zamora

Service Supervisor Shop and
Field Operation