



June 24, 2025

MS. LOURILI VICENCIO

UNIT 106 WEST TOWER, GF THE VERANDA ARCA SOUTH, NEXUS ST. COR. EAST UNION DRIVE, BRGY. WESTERN BICUTAN, TAGUIG CITY
TEL#: 0917-8202197

Dear Ma'am/Sir,

Kolin Marketing Inc., is extremely honored for your endorsement of Kolin brand and we are please to offer you with a special price/s for the following items.

A. EQUIPMENT & INSTALLATION

* OPTION 2 *

QTY	U/M	MODEL / DESCRIPTION	SRP	DISCOUNTED PRICE		AMOUNT
1	UNIT/S	MODEL: KA-200MCARINV32 KOLIN WINDOW TYPE CREO SERIES AIRCONDITIONER 19,800 Kj/h (2.0HP) FULL DC INVERTER R-32 WITH REMOTE (WxDxH) 26"x30.7"x16.8"	36,995.00	26,916.20	PHP	26,916.20
TOTAL UNIT COST					PHP	26,916.20
ESTIMATED COST OF INSTALLATION (please see attached) w/ angle bracket					PHP	1,800.00
OTHERS: DELIVERY CHARGE					PHP	600.00
TOTAL ESTIMATED COST OF THE PROJECT					PHP	29,316.20

TERMS OF PAYMENT:

FULL PAYMENT OF UNIT AND DELIVERY CHARGE. IF CHECK, SUBJECT FOR 3 DAYS CLEARING.

WARRANTY:

FOR WINDOW TYPE: ONE (1) YEAR FREE PARTS AND LABOR, THREE YEARS (3) MAIN PCB, TEN (10) YEARS WARRANTY ON COMPRESSOR.

NOTES: PRICES ARE SUBJECT TO CHANGE WITHOUT PRIOR NOTICE.

PRICES IS VAT INCLUSIVE.

**** Cost of Installation is Package with the Unit(s), this cost cannot avail separately (cost will be based on actual).**

We thank you for giving opportunity to offer our product and services, hoping we receive your purchase order.

If you need assistance, don't hesitate to call the under signed at 0917-807-8607 or email at kmi_asst@kolinphil.com.ph

**** CURRENTLY NO AVAILABLE STOCKS FOR ANGLE BRACKET.**

Very Truly Yours,

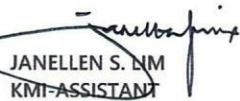
JANELLEN S. LIM
KMI-ASSISTANT

Noted by:

MARY NATHANIEL R. FLORES
KMI-SUPERVISOR

Approved By:

MS. EDITHA M. FLORES
AVP - FINANCE

KMI-QUOTE-06-25-0468-rev
REG-24%/1.2K

Conforme:

SIGNATURE OVER PRINTED NAME

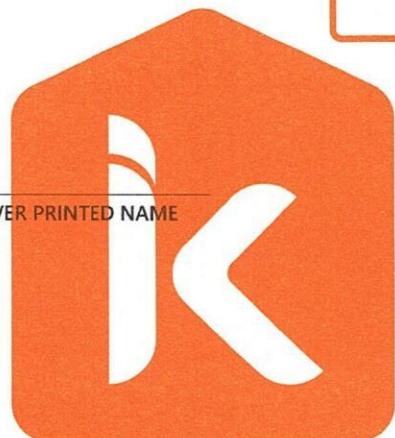

KOLIN Philippines International Inc.
Survey Form

Nº 003658

Customer Name : LOMBILI VICENTE Date : 6-16-20
 Address : UNIT 2304 WEST COAST CALDO HV. PLEX COOL SJR No. : X-0761
SALCEDO VILLAGE (ALABANG)
 Establishment Type : Residential ☒ Area Surveyed : UNIT 2304
 Commercial ☐ Area Surveyed : _____
 Recommended Product Model : KXG 200WC 1NY

Cooling Capacity Computation

Floor Area : 22.4 sqm.
 Ceiling Height : 2.7 mtr.

note: add 20% per meter in excess of 3 meters in the initial cooling capacity computed.

Floor Area :	<u>22.4</u>	x	550 Btu/h	<u>12320</u> Btu/h
Ceiling Height (excess of 3 mtrs.) :	_____	x	20%	_____ Btu/h
Window Direct Sunlight	_____	x	20% - 50%	_____ Btu/h
Total Cooling Capacity				<u>12320</u> Btu/h

Add : Additional Heat Load

No. of Person	<u>4</u>	x	300 Btu/h	<u>1200</u> Btu/h
No. of Ordinary Light (<40w)	<u>4</u>	x	200 Btu/h	<u>800</u> Btu/h
No. of Special Light (>40w)	_____	x	400 Btu/h	_____ Btu/h
No. of Refrigerator (< 6 cu.ft.)	<u>1</u>	x	400 Btu/h	<u>400</u> Btu/h
No. of Refrigerator (> 6 cu.ft.)	_____	x	800 Btu/h	_____ Btu/h
No. of Cooking Range	<u>1</u>	x	1500 Btu/h	<u>1500</u> Btu/h
No. of Laptop Computer	_____	x	150 Btu/h	_____ Btu/h
No. of Desktop Computer <u>1</u>	<u>1</u>	x	400 Btu/h	<u>400</u> Btu/h
No. of Printer	_____	x	500 Btu/h	_____ Btu/h
No. of Photocopier	_____	x	1000 Btu/h	_____ Btu/h
Total Cooling Capacity				<u>4300</u> Btu/h

Recommended Cooling Capacity

16620 Btu/h

Note : Compressor warranty will be **reduced to** _____ yr. if air-conditioner purchased is lower than the recommended cooling capacity or pipe lay-out is beyond the maximum allowable length.

Scope of Work Agreement

- | | | |
|-----------------------------------|--|---|
| 1. Copper tube lay-out | <input type="checkbox"/> Expose | <input type="checkbox"/> Embedded |
| 2. Chipping | <input type="checkbox"/> Included | <input type="checkbox"/> Not Included |
| 3. Fabricated Bracket | <input type="checkbox"/> Yes <input type="checkbox"/> Shop | <input type="checkbox"/> Site <input type="checkbox"/> No |
| 4. Service Ledge | <input type="checkbox"/> Yes | <input type="checkbox"/> No |
| 5. Dismantling of existing Aircon | <input type="checkbox"/> Included | <input type="checkbox"/> Not Included |
| 6. Ducting | <input type="checkbox"/> Yes | <input type="checkbox"/> No |

Dimension :

- Plastering, carpentry and restoration works are to be done by the customer.
- Wiring of electrical supply from main panel to air-conditioning unit are to be done by the customer.
- Processing of mechanical plan, working permit, electrical permit are to be done by the customer.
- Other concern; WINDOW TYPE

Frame Dimension: 660 mm x 430 mm

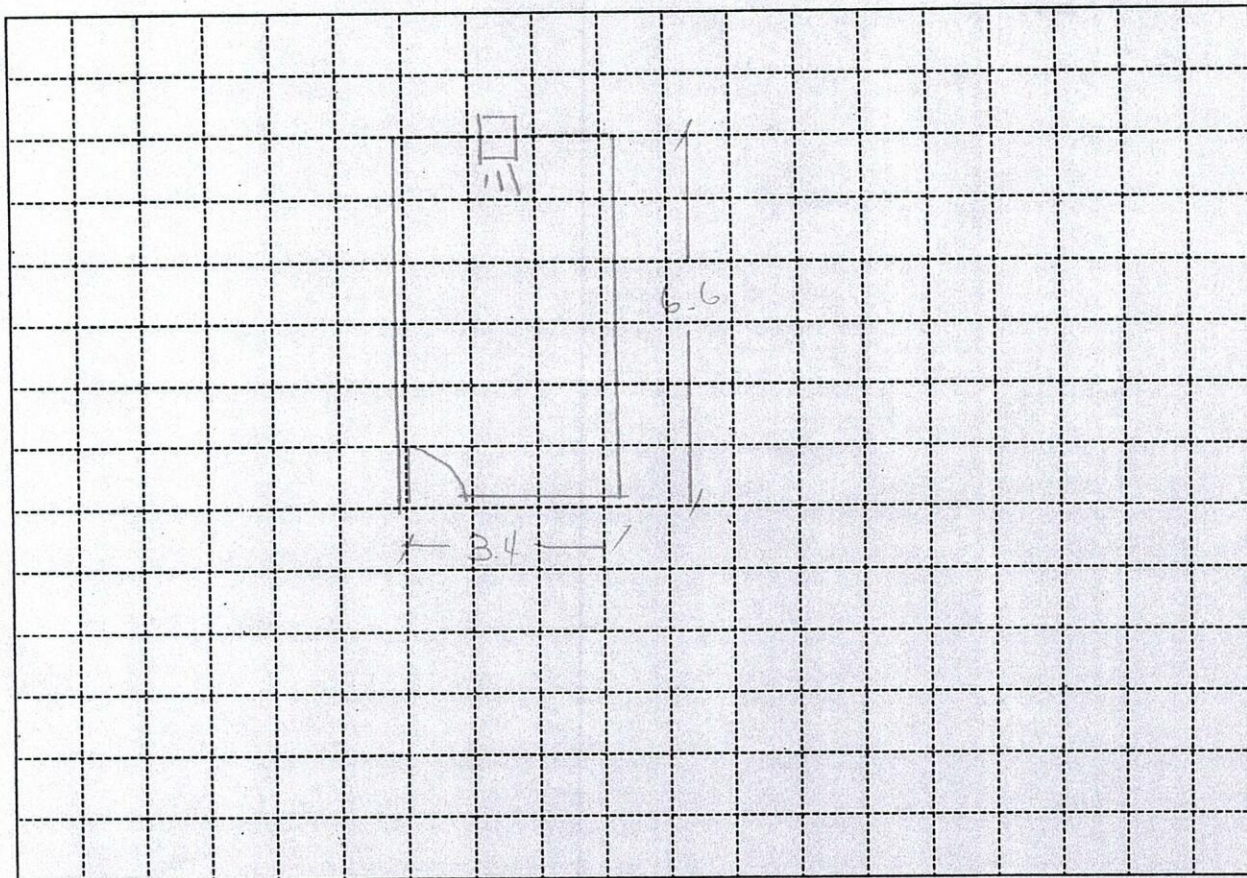

Indoor Unit Location :

Outdoor Unit Location :

Pipe Length :

Special Note :

Installation Cost Estimate

Material Description	Qty.	Unit Cost	Total Cost
Copper Tube (excess of 10 ft.) 2330, 2430, 2520, 3520, 4620			
Wire (Royal Cord-signal wire) (excess of 10ft.) 2.0mmx4C			
Wire (Royal Cord - Breaker to ODU) 3.5mm / 5.5mm x 3C			
Circuit Breaker 20A, 30A, 40A/1ph, 40A/3ph			
Bracket (ODU) (Imptd. / Fabricated) ; (Floor / Wall)			
Bracket (WAC) Angle Type	1	600	600
PVC Pipe (drain) 1/2", 3/4"			
PVC Pipe (electrical) 3/4", 1"			
Drain Pump			
Drain Pump Hose			
Chipping Works mtr.			
Dismantling Fee (existing air-conditioner)			
Initial Charge			1200
TOTAL ESTIMATE		P	1800 -

Note :

- Initial Charge includes labor, 10ft. Copper tube, 10ft. Royal cord, Circuit breaker, Outdoor Bracket (SAC), Indoor Bracket (PAC) and Consumable materials.
- Survey fee will be **deducted** in the installation fee.

Prepared by:

Customer Conforme:

Signature Over Printed Name

Signature Over Printed Name