

FEBRUARY 07, 2024

PATTS COLLEGE OF AERONAUTICS

Lambo St. San Dionisio Parañaque City

0995-365-0589

Model	Qty
KLG-SF40-WBR6H1M32	1
KSG-IWF-30Wfy8K1M32	2

OFFICE OF STUDENT AFFAIRS		Area ≈ 110 sq.m
----------------------------------	--	-----------------

ACU 1	3.0hp Wallmounted Inverter	KSG-IWF-30Wfy8K1M32					
	Estimated Pipe Length	:	69	ft			
	Estimated Royal Cord Length	:	76	ft			
	Initial Charge					P	5,500.00
	Includes:						
	Labor						
	10ft Copper Tube						
	10ft Royal Cord						
	Outdoor Bracket (wall)						
	Other Consumables						
	Additional Charges	Description	Unit	Price Per Unit		Subtotal	
	Copper Tube	3/8"x 5/8"	59 ft	P 400.00 / ft	P	23,600.00	
	Royal Cord	2.mm2 x 4C	66 ft	P 100.00 / ft	P	6,600.00	
	Royal Cord (ODU-Breaker)	3.5mm2 x 3C	7 ft	P 60.00 / ft	P	420.00	
	Rubber Insulation	2 1/8"x3/4" x 6'	10 pc(s)	P 350.00 / pc	P	3,500.00	
	Full Thread	3 meters	2 pc(s)	P 150.00 / pc	P	300.00	
	Pipe hanger	3 inches	14 pc(s)	P 120.00 / pc	P	1,680.00	
	PVC (Drainline)	3/4 " -blue	4 pc(s)	P 150.00 / pc	P	600.00	
	Drain pump	realise	1 pc(s)	P 2,750.00 / pc	P	2,750.00	
	Drain Hose	green- 1/4"	70 ft	P 10.00 / ft	P	700.00	
	Drain Hose	White -1/2"	7 ft	P 25.00 / ft	P	175.00	P 40,325.00

Estimated Charges	P 45,825.00
--------------------------	--------------------

ACU 2	4.0hp Floormounted Regular	KLG-SF40-WBR6H1M32					
	Estimated Pipe Length	:	33	ft			
	Estimated Royal Cord Length	:	80	ft			
	Initial Charge					P	12,000.00
	Includes:						
	Labor						
	10ft Copper Tube						
	10ft Royal Cord						
	Indoor Bracket(floor)						
	Other Consumables						
	Additional Charges	Description	Unit	Price Per Unit		Subtotal	
	Copper Tube	3/8"x 5/8"	23 ft	P 400.00 / ft	P	9,200.00	
	Royal Cord	2.mm2 x 4C	70 ft	P 100.00 / ft	P	7,000.00	
	Royal Cord (ODU-Breaker)	5.5mm2 x 3C	7 ft	P 70.00 / ft	P	490.00	
	Outdoor Bracket(wall)	fabricated	1 pc(s)	P 5,000.00 / pc	P	5,000.00	
	Outdoor Breaker (NEMA 3R)	30A/ 1PH	1 pc	P 1,000.00 / pc	P	1,000.00	
	PVC (Drainline)	3/4 " -blue	1 pc(s)	P 150.00 / pc	P	150.00	
	Drain Hose	White -1/2"	7 ft	P 25.00 / ft	P	175.00	P 23,015.00

Estimated Charges	P 35,015.00
--------------------------	--------------------

ACU 3 3.0hp Wallmounted Inverter **KSG-IWF-30Wfy8K1M32**
 Estimated Pipe Length : 33 ft
 Estimated Royal Cord Length : 40 ft
 Initial Charge P 5,500.00
 Includes:

Labor
 10ft Copper Tube
 10ft Royal Cord
 Outdoor Bracket (wall)
 Other Consumables

Additional Charges	Description	Unit	Price Per Unit	Subtotal
Copper Tube	3/8"x 5/8"	23 ft	P 400.00 / ft	P 9,200.00
Royal Cord	2.mm2 x 4C	30 ft	P 100.00 / ft	P 3,000.00
Royal Cord (ODU-Breaker)	3.5mm2 x 3C	7 ft	P 60.00 / ft	P 420.00
Outdoor Breaker (NEMA 3R)	30A/ 1PH	1 pc	P 1,000.00 / pc	P 1,000.00
PVC (Drainline)	3/4 " -blue	1 pc(s)	P 150.00 / pc	P 150.00
Drain Hose	White -1/2"	7 ft	P 25.00 / ft	P 175.00
				P 13,945.00

Estimated Charges P 19,445.00

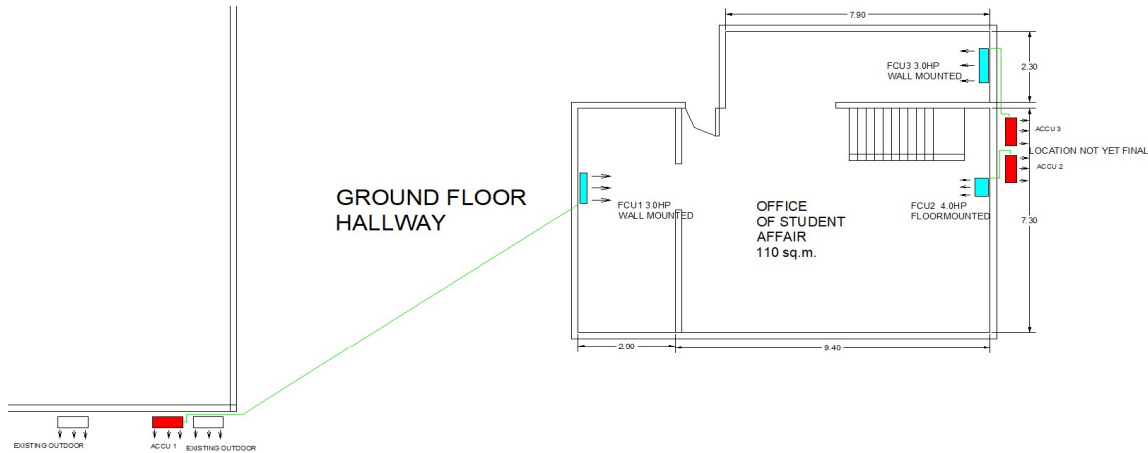

Total Estimated Charges P 100,285.00

Validity: This quotation is valid for a period of fifteen (15) days from the date thereof, subject to our confirmation thereafter.

Note:

- 1. Location of indoor and outdoor units, not yet final recommendation only.**
- AC drain line will be tapped to the nearest drain provision provided by the customer's contractor.
- 3. Need for marking and site visit before installation for manhole and copper tube lay out and location.**
- Working days: Monday to Saturday, 8am- 5pm with parking.
- Mechanical Plans, Permits, Electrical permits not included.
- Defectors, masonry, carpentry, chipping & plastering (finishing & restoration) are not included in the installation.
- Electrical power supply (feeder line) **220v/ 60hz/ 1ph** , is not included in the scope of work of Kolin.
- 8. Final charges will be based on actual installation.**

Prepared by:

Customer Conformer:

Jeffrey Dadios
 Field Surveyor

Signature Over Printed Name

Reviewed by:

Engr. Kenneth Zamora
 Service Supervisor Field and Shop Operation