



October 25, 2024

PHILIP SECOSANA
FORBESWOOD HEIGHTS TOWER 1 - UNIT 15C, RIZAL DRIVE, BGC
TEL# 0917-8178523 / 0917-3063703

Dear Ma'am/Sir,

Kolin Marketing Inc., is extremely honored for your endorsement of Kolin brand and we are please to offer you with a special price/s for the following items.

A. EQUIPMENT & INSTALLATION

QTY	U/M	MODEL / DESCRIPTION	SRP	DISCOUNTED PRICE		AMOUNT
1	UNIT/S	MODEL: KSG-IWF-10WFF-8KTM32 KOLIN WALL MOUNTED PRIMUS GOLD AIRCONDITIONER 11,484 Kj/h (1.0HP) FULL DC INVERTER W/ WIFI R-32	42,595.00	26,224.10	PHP	26,224.10
1	UNIT/S	MODEL: KSG-IWF-20WFF-8KTM32 KOLIN WALL MOUNTED PRIMUS GOLD AIRCONDITIONER 19,000 Kj/h (2.0HP) FULL DC INVERTER W/ WIFI R-32	59,595.00	39,484.10	PHP	39,484.10
TOTAL UNIT COST					PHP	65,708.20
ESTIMATED COST OF INSTALLATION (please see attached)					PHP	37,700.00
OTHERS: DELIVERY CHARGE					PHP	600.00
TOTAL ESTIMATED COST OF THE PROJECT					PHP	169,716.40

TERMS OF PAYMENT:

FULL PAYMENT OF UNIT AND DELIVERY CHARGE. IF CHECK, SUBJECT FOR 3 DAYS CLEARING.

INSTALLATION:

* Initial Charge for 1 Wall Mounted AC: P7,500.00 (1.0HP-2.0HP) / P8,500.00 (2.5HP-3.0HP)

Inclusions: Labor, Outdoor Standard Bracket, Consumables, 10ft PVC Pipes ¾, 1st 10ft. Royal Cord Wire and 1st 10ft. Copper Tube.

Exclusions: Excess of 1st 10ft. Royal Cord 100/foot, Copper Tube 350/foot (1.0hp-2.0hp), 400/foot (2.5hp-3.0hp), Circuit Breaker (Nema), Special Designed Bracket.

WARRANTY:

FOR SPLIT TYPE : ONE (1) YEAR FREE PARTS AND LABOR, THREE YEARS (3) MAIN PCB , TEN (10) YEARS WARRANTY ON COMPRESSOR.

NOTES: PRICES ARE SUBJECT TO CHANGE WITHOUT PRIOR NOTICE.

PRICES IS VAT INCLUSIVE.

We thank you for giving opportunity to offer our product and services, hoping we receive your purchase order.

If you need assistance, don't hesitate to call the under signed at 0917-807-8607 or email at kmi_asst@kolinphil.com.ph

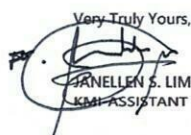
Very Truly Yours,

ANELLEN S. LIM
KMI ASSISTANT

Noted by:

MART NATHANIEL R. FLORES
KMI-SUPERVISOR

Approved By:

MS. EDITHA M. FLORES
AVP - FINANCE

KMI-QUOTE-10-24-0916
REG-22%/7K

Conforme: _____
SIGNATURE OVER PRINTED NAME

Kolin Marketing, Inc.

1854 Sta. Rita St., Guadalupe Nuevo, Makati City

Tel.: (632) 8852-6473

Fax: (632) 8852-2170 / (632) 8852-4792

 www.kolinphil.com.ph / kolinphilippines



OCTOBER 24, 2023

PHILIP SECOSANA

Unit 15C Forbeswood Heights Tower 1 Rizal Drive, Brgy Fort Bonifacio Taguig City
0917-3063703

MODEL	Qty
KSG-IWF-20WFY8K1M32	1
KSG-IWF-10WFY8K1M32	1

LIVING,DINING,KITCHEN	Area	18.5 sqm
------------------------------	------	----------

ACU 1	2.0 HP Wall Mounted Inverter	KSG-IWF-20WFY8K1M32			
	Estimated Pipe Length = 23 ft				
	Estimated Royal Cord Length = 28 ft				
	Initial Charge				₱ 7,500.00
	Includes:				
	Labor				
	10ft Copper Tube				
	10ft Royal Cord				
	Outdoor Bracket (FLOOR)				
	Consumables				
	Installation Materials	Description	Qty	Price per qty	Subtotal
	Copper Tube	Ø 1/4" x Ø 1/2"	13 ft	₱ 350.00/ft	₱ 4,550.00
	Royal Cord (comm. wire)	2.mm2 x 4C	18 ft	₱ 100.00/ft	₱ 1,800.00
	Royal Cord (ACCU-Breaker)	3.5mm x 3c	5 ft	₱ 60.00/ft	₱ 300.00
	Circuit Breaker waterproof	30A / 1Ph	1 pc/s	₱ 1,000.00/pc	₱ 1,000.00
	Dismantle	1.5HP Wall Mounted	1 set	₱ 2,500.00/set	₱ 2,500.00
	PVC blue	3/4" x 10'	2 pc/s	₱ 150.00/pc	₱ 300.00
					₱ 10,450.00

Estimated Charges	₱ 17,950.00
--------------------------	-------------

BEDROOM	Area	8 sqm
----------------	------	-------

ACU 1	1.0 HP Wall Mounted Inverter	KSG-IWF-10WFY8K1M32			
	Estimated Pipe Length = 27 ft				
	Estimated Royal Cord Length = 32 ft				
	Initial Charge				₱ 7,500.00
	Includes:				
	Labor				
	10ft Copper Tube				
	10ft Royal Cord				
	Outdoor Bracket (FLOOR)				
	Consumables				
	Installation Materials	Description	Qty	Price per qty	Subtotal
	Copper Tube	Ø 1/4" x Ø 3/8"	17 ft	₱ 350.00/ft	₱ 5,950.00
	Royal Cord (comm. wire)	2.mm2 x 4C	22 ft	₱ 100.00/ft	₱ 2,200.00
	Royal Cord (ACCU-Breaker)	3.5mm x 3c	5 ft	₱ 60.00/ft	₱ 300.00
	Circuit Breaker waterproof	20A/ 1PH	1 pc/s	₱ 1,000.00/pc	₱ 1,000.00
	Dismantle	1.0HP Wall Mounted	1 set	₱ 2,500.00/set	₱ 2,500.00
	PVC blue	3/4" x 10'	2 pc/s	₱ 150.00/pc	₱ 300.00
					₱ 12,250.00

Estimated Charges	₱ 19,750.00
--------------------------	-------------

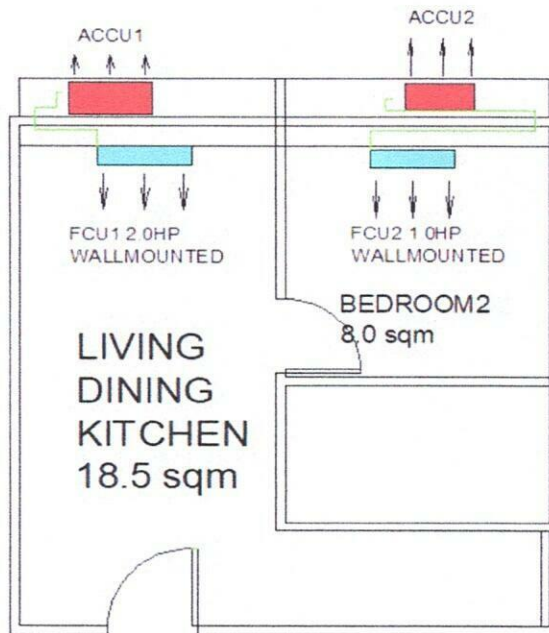

Total Estimated Charges

P 37,700.00

Validity: This quotation is valid for a period of fifteen (15) days from the date thereof, subject to our confirmation thereafter.

Installation notes:

- 1 Location of indoor and outdoor units were agreed by the customer and Kolin's surveyor.
- 2 AC drain line will be tapped to the nearest drain provision provided by the customer's contractor.
- 3 Need for Site visit for the renovation or repair of wall to fit the indoor units. Should have atleast 40-45cm from the ceiling for indoor unit. 10cm offset from the top of unit to ceiling.
- 3 Coppertube and drainline expose inside the area.
- 4 Working days: Monday to Saturday, 8am- 5pm with parking. Need working permit. 4 pax
- 5 Mechanical Plans, Permits, Electrical permits not included.
- 6 Deflectors, masonry, carpentry, chipping & plastering (finishing & restoration) are not included in the installation.
- 7 Air conditioning drain line and Electrical power supply (feeder line) **220v/ 60hz/ 1ph** , should be provided by customer's contractor.
- 8 **Final charges will be based on actual installation.**

Prepared by:

Jeffrey Dadios

Field Surveyor

Customer Conformer:

Signature Over Printed Name

Reviewed by:

Engr. Kenneth Zamora

Service Supervisor Shop and
Field Operation