

July 19, 2023
 PATTS College Of Aeronautics
 Lambo St. Brgy. San Dionisio, Paranaque City
 825-8823/825-8824, 0933-8120909

MODEL Qty
 KSM-SW25-6H1M32 1

POWERPLANT TOOL ROOM Area 26 sqm

ACU 2.5 HP Wall Mounted Regular KSM-SW25-6H1M32
 Estimated Pipe Length = 30 ft
 Estimated Royal Cord Length = 37 ft
Initial Charge ₱ 5,500.00

Includes:

Labor
 10ft Copper Tube
 10ft Royal Cord
 Outdoor Bracket (FLOOR)
 Consumables

Installation Materials	Description	Qty	Price per qty	Subtotal
Copper Tube	Ø 3/8 " x Ø 5/8"	20 ft	₱ 400.00/ft	₱ 8,000.00
Royal Cord (comm. wire)	2.mm2 x 4C	27 ft	₱ 100.00/ft	₱ 2,700.00
Royal Cord (ACCU-Breaker)	3.5mm x 3c	5 ft	₱ 60.00/ft	₱ 300.00
Circuit Breaker waterproof	30A / 1Ph	1 pc/s	₱ 1,000.00/pc	₱ 1,000.00
Rubber Insulation	2 1/8" x 3/4" x 6'	3 pc/s	₱ 350.00/pc	₱ 1,050.00
PVC blue	3/4" x 10'	2 pc/s	₱ 150.00/pc	₱ 300.00
Drain Hose	White -1/2"	5 ft	₱ 25.00/ft	₱ 125.00
				₱ 13,475.00

Total Estimated Charges **₱ 18,975.00**

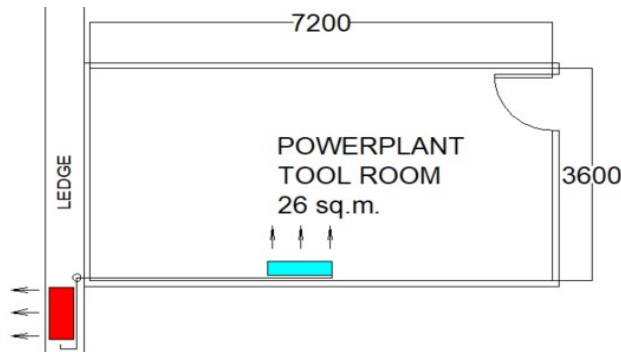

Validity: This quotation is valid for a period of fifteen (15) days from the date thereof, subject to our confirmation thereafter.

Installation notes:

- 1 Location of indoor and outdoor units were agreed by the customer and Kolin's surveyor.
- 2 Mechanical Plans, Permits, Electrical permits not included.
- 3 Deflectors, masonry, carpentry, chipping & plastering (finishing & restoration) are not included in the installation.
- 4 Air conditioning drain line and Electrical power supply (feeder line) **220v/ 60hz/ 1ph** , should be provided by customer's contractor.
- 5 **Final charges will be based on actual installation.**

Prepared by:

Customer Conformance:

Jeffrey Dadios

Field Surveyor

Signature Over Printed Name

Reviewed by:

Engr. Kenneth Zamora

Service Supervisor Shop and Field Operation