

OCTOBER 24, 2024
DINDO SADSAD
38 Ruby St. Empalico Homes, Brgy East Fairview, Quezon City
0927-7068188

MODEL	Qty
KSG-IWF-30Wfy8K1M32	1
KSG-IWF-10Wfy8K1M32	3

Customer choice

MASTER BEDROOM	Area	14.5 sqm
-----------------------	------	----------

ACU 1	1.0 HP Wall Mounted Inverter	KSG-IWF-10Wfy8K1M32			
	Estimated Pipe Length = 10 ft				
	Estimated Royal Cord Length = 15 ft				
	Initial Charge				₱ 7,500.00
	Includes:				
	Labor				
	10ft Copper Tube				
	10ft Royal Cord				
	Outdoor Bracket (Wall)				
	Consumables				
	Installation Materials	Description	Qty	Price per qty	Subtotal
	Royal Cord (comm. wire)	2.mm2 x 4C	5 ft	₱ 100.00/ft	₱ 500.00
	Royal Cord (ACCU-Breaker)	3.5mm x 3c	5 ft	₱ 60.00/ft	₱ 300.00
	Circuit Breaker waterproof	20A / 1Ph	1 pc/s	₱ 1,000.00/pc	₱ 1,000.00
	PVC blue	3/4" x 10'	1 pc/s	₱ 150.00/pc	₱ 150.00
					₱ 1,950.00

Estimated Charges	₱ 9,450.00
--------------------------	------------

BEDROOM1	Area	9.4 sqm
-----------------	------	---------

ACU 2	1.0 HP Wall Mounted Inverter	KSG-IWF-10Wfy8K1M32			
	Estimated Pipe Length = 10 ft				
	Estimated Royal Cord Length = 15 ft				
	Initial Charge				₱ 7,500.00
	Includes:				
	Labor				
	10ft Copper Tube				
	10ft Royal Cord				
	Outdoor Bracket (Wall)				
	Consumables				
	Installation Materials	Description	Qty	Price per qty	Subtotal
	Royal Cord (comm. wire)	2.mm2 x 4C	5 ft	₱ 100.00/ft	₱ 500.00
	Royal Cord (ACCU-Breaker)	3.5mm x 3c	5 ft	₱ 60.00/ft	₱ 300.00
	Circuit Breaker waterproof	20A / 1Ph	1 pc/s	₱ 1,000.00/pc	₱ 1,000.00
	PVC blue	3/4" x 10'	1 pc/s	₱ 150.00/pc	₱ 150.00
					₱ 1,950.00

Estimated Charges	₱ 9,450.00
--------------------------	------------

BEDROOM2	Area	10.8 sqm
-----------------	------	----------

ACU 3	1.0 HP Wall Mounted Inverter	KSG-IWF-10Wfy8K1M32			
	Estimated Pipe Length = 10 ft				
	Estimated Royal Cord Length = 15 ft				
	Initial Charge				₱ 7,500.00
	Includes:				
	Labor				
	10ft Copper Tube				
	10ft Royal Cord				
	Outdoor Bracket (Wall)				
	Consumables				
	Installation Materials	Description	Qty	Price per qty	Subtotal
	Royal Cord (comm. wire)	2.mm2 x 4C	5 ft	₱ 100.00/ft	₱ 500.00
	Royal Cord (ACCU-Breaker)	3.5mm x 3c	5 ft	₱ 60.00/ft	₱ 300.00
	Circuit Breaker waterproof	20A / 1Ph	1 pc/s	₱ 1,000.00/pc	₱ 1,000.00
	PVC blue	3/4" x 10'	1 pc/s	₱ 150.00/pc	₱ 150.00
					₱ 1,950.00

Estimated Charges	₱ 9,450.00
--------------------------	------------

LIVING/DINING/KITCHEN

Area 46 sqm

ACU 4 3.0 HP Wall Mounted Inverter**KSG-IWF-30WFY8K1M32**

Estimated Pipe Length = 10 ft

Estimated Royal Cord Length = 15 ft

Initial Charge

P 8,500.00

Includes:

Labor

10ft Copper Tube

10ft Royal Cord

Outdoor Bracket (Wall)

Consumables

Installation Materials

Description	Qty	Price per qty	Subtotal
Royal Cord (comm. wire)	5 ft	P 100.00/ft	P 500.00
Royal Cord (ACCU-Breaker)	5 ft	P 60.00/ft	P 300.00
Circuit Breaker waterproof	1 pc/s	P 1,000.00/pc	P 1,000.00
PVC blue	1 pc/s	P 150.00/pc	P 150.00
			P 1,950.00

Estimated Charges

P 10,450.00

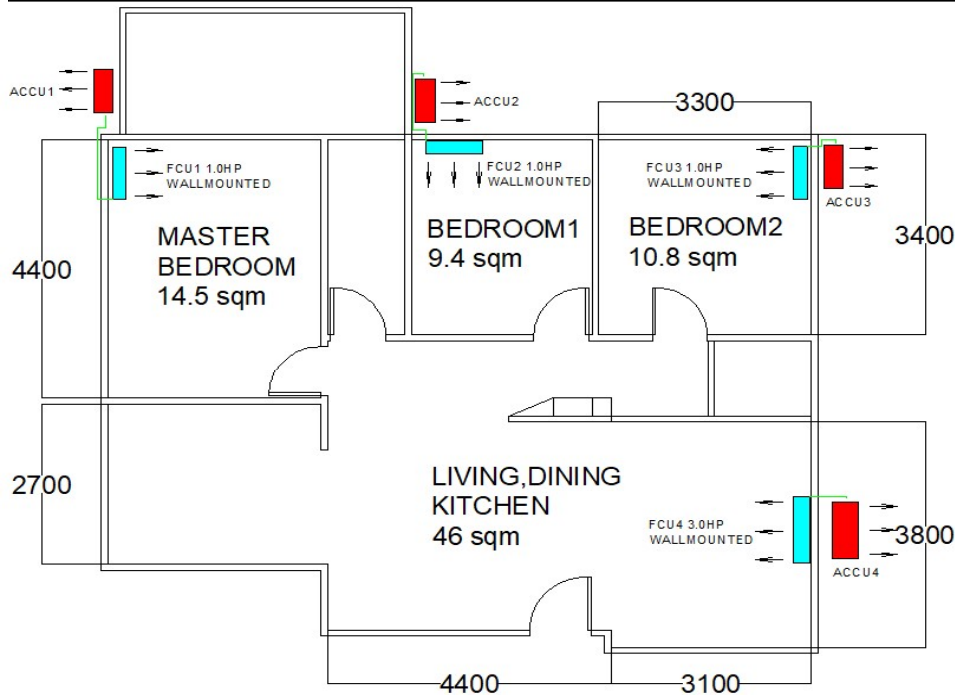
**Total Estimated Charges**

P 38,800.00

Validity: This quotation is valid for a period of fifteen (15) days from the date thereof, subject to our confirmation thereafter.

Installation notes:

- 1 Location of indoor and outdoor units were agreed by the customer and Kolin's surveyor.
- 2 AC drain line will be tapped to the nearest drain provision provided by the customer's contractor.
- 3 Coppertube and drainline expose inside the area.
- 4 Working days: Monday to Saturday, 8am- 5pm with parking.
- 5 Mechanical Plans, Permits, Electrical permits not included.
- 6 Deflectors, masonry, carpentry, chipping & plastering (finishing & restoration) are not included in the installation.
- 7 Air conditioning drain line and Electrical power supply (feeder line) **220v/ 60hz/ 1ph** , should be provided by customer's contractor.
- 8 **Final charges will be based on actual installation.**

Prepared by:

Jeffrey Dadios

Field Surveyor

Customer Conformer:

Signature Over Printed Name

Reviewed by:

Engr. Kenneth ZamoraService Supervisor Shop and
Field Operation