



March 27, 2025

MR. BENJAMIN BAUTISTA
UNIT D6, LANUZA AVE, CASA VERDE TOWNHOMES, BRGY. UGONG PASIG CITY
Email: pmgbautista@outlook.com

Dear Ma'am/Sir,

Kolin Marketing Inc., is extremely honored for your endorsement of Kolin brand and we are please to offer you with a special price/s for the following items.

A. EQUIPMENT & INSTALLATION

** OPTION 2

QTY	U/M	MODEL / DESCRIPTION	SRP	DISCOUNTED PRICE		AMOUNT
1	UNIT/S	MODEL: KLG-IF40-5G1M32 KOLIN FLOOR MOUNTED AIRCONDITIONER 37,980 Kj/h (3.0TR) FULL DC INVERTER R-32 SINGLE PHASE	113,195.00	79,028.20	PHP	79,028.20
1	UNIT/S	MODEL: KSM-IW20-WCT10M1M32 KOLIN WALL MOUNTED CERTUS SERIES AIRCONDITIONER 18,990 Kj/h (2.0HP) REGULAR INVERTER R-32	41,995.00	27,916.20	PHP	27,916.20
2	UNIT/S	MODEL: KAM-150DRC32 KOLIN WINDOW TYPE REGULAR COMPACT AIRCONDITIONER 12,660 Kj/h (1.5HP) NON-INVERTER WITH REMOTE R-32 (WxDxH) 17.7"x23"x13.6"	22,495.00	16,096.20	PHP	32,192.40
TOTAL UNIT COST					PHP	139,136.80
ESTIMATED COST OF INSTALLATION (please see attached)					PHP	55,685.00
OTHERS: DELIVERY CHARGE					PHP	600.00
TOTAL ESTIMATED COST OF THE PROJECT					PHP	195,421.80

TERMS OF PAYMENT:

FULL PAYMENT OF UNIT AND DELIVERY CHARGE. IF CHECK, SUBJECT FOR 3 DAYS CLEARING.

WARRANTY:

FOR FLOOR MOUNTED: ONE (1) YEAR FREE PARTS AND LABOR, FIVE (5) YEARS WARRANTY ON COMPRESSOR.

FOR SPLIT TYPE : ONE (1) YEAR FREE PARTS AND LABOR, THREE YEARS (3) MAIN PCB , TEN (10) YEARS WARRANTY ON COMPRESSOR.

FOR WINDOW TYPE: ONE (1) YEAR FREE PARTS AND LABOR, THREE YEARS (3) MAIN PCB, TEN (10) YEARS WARRANTY ON COMPRESSOR.

NOTES: PRICES ARE SUBJECT TO CHANGE WITHOUT PRIOR NOTICE.

PRICES IS VAT INCLUSIVE.

** Cost of Installation is Package with the Unit(s), this cost cannot avail separately (cost will be based on actual).

We thank you for giving opportunity to offer our product and services, hoping we receive your purchase order.

If you need assistance, don't hesitate to call the under signed at 0917-807-8607 or email at kmi_asst@kolinphil.com.ph

Very Truly Yours,

JANELLEN S. LIM
KMI-ASSISTANT

Noted by:
MARINATHANIE R. FLORES
KMI-SUPERVISOR

Approved By:

MS. EDITHA M. FLORES
AVP - FINANCE

Conforme:

BENJAMIN BAUTISTA
SIGNATURE OVER PRINTED NAME

KMI-QUOTE-03-25-0234
ECY-24%/7K/4K/1K

Kolin Marketing, Inc.
1854 Sta. Rita St., Guadalupe Nuevo, Makati City
Tel.: (632) 8852-6473
Fax: (632) 8852-2170 / (632) 8852-4792
www.kolinphil.com.ph / kolinphilippines

March 26, 2025

BENJAMIN BAUTISTA

Unit D6, Lanuza Ave, Casa Verde Townhomes, Brgy Ugong Pasig City

0917-8269939

pmgbautista@outlook.com

MODEL	QUANTITY
KLG-IF40-5G1M32	1
KSM-IW20-WCT10M1M32	1
KAM-150DRC32	2

OPTION 2- regular windowtype & wallmounted
GROUND FLOOR

LIVING	Area = 42 sq.m
---------------	----------------

ACU 1	4.0hp Floor mounted Inverter	KLG-IF40-5G1M32	
	Estimated Pipe Length :	33	ft
	Estimated Royal Cord Length :	40	ft
	Initial Charge		P 11,000.00

Includes:

Labor
10ft Copper Tube
10ft Royal Cord
Indoor Bracket
Other Consumables

Additional Charges	Description	Unit	Price Per Unit	Subtotal
Copper Tube	3/8"x 5/8"	23 ft	P 400.00 / ft	P 9,200.00
Royal Cord	2.mm2 x 4C	30 ft	P 100.00 / ft	P 3,000.00
Royal Cord (ODU-Breaker)	5.5mm2 x 3C	7 ft	P 70.00 / ft	P 490.00
Circuit Breaker(NEMA)	40A/ 1Ph	1 pc(s)	P 1,000.00 / pc	P 1,000.00
Outdoor Bracket(wall)	fabricated	1 pc(s)	P 5,000.00 / pc	P 5,000.00
Dismantle	4.0hp	1 pc(s)	P 3,000.00 / pc	P 3,000.00
Scaffoldings	3sets	1 pc(s)	P 1,500.00 / pc	P 1,500.00
Drain Hose	White -1/2"	7 ft	P 25.00 / ft	P 175.00
				P 23,365.00

Estimated Charges	P 34,365.00
--------------------------	--------------------

SECOND FLOOR

BEDROOM 3	Area = 16 sq.m
------------------	----------------

ACU2	1.5hp Windowtype Regular	KAM-150DRC32	
	Initial charge		P 1,200.00
	Angle Bracket		P 600.00

Estimated charges	P 1,800.00
--------------------------	-------------------

BEDROOM 2	Area = 16 sq.m
------------------	----------------

ACU3	1.5hp Windowtype Regular	KAM-150DRC32	
	Initial charge		P 1,200.00
	Angle Bracket		P 600.00

Estimated charges	P 1,800.00
--------------------------	-------------------

MASTER BEDROOM	Area = 20 sq.m
-----------------------	----------------

ACU 4	2.0hp Wallmounted Inverter	KSM-IW20-WCT10M1M32	
	Estimated Pipe Length :	27	ft
	Estimated Royal Cord Length :	34	ft
	Initial Charge		P 7,500.00

Includes:

Labor
10ft Copper Tube
10ft Royal Cord
Outdoor Bracket (wall)
Other Consumables

Additional Charges	Description	Unit	Price Per Unit	Subtotal
Copper Tube	1/4"x 1/2"	17 ft	P 350.00 / ft	P 5,950.00
Royal Cord	2.mm2 x 4C	24 ft	P 100.00 / ft	P 2,400.00
Royal Cord (ODU-Breaker)	3.5mm2 x 3C	7 ft	P 60.00 / ft	P 420.00
Circuit Breaker(NEMA)	30A/ 1Ph	1 pc(s)	P 1,000.00 / pc	P 1,000.00
PVC(Drainline)	Blue 3/4"	3 pc(s)	P 150.00 / pc	P 450.00
				P 10,220.00

Estimated Charges	P 17,720.00
--------------------------	--------------------



GROUND FLOOR

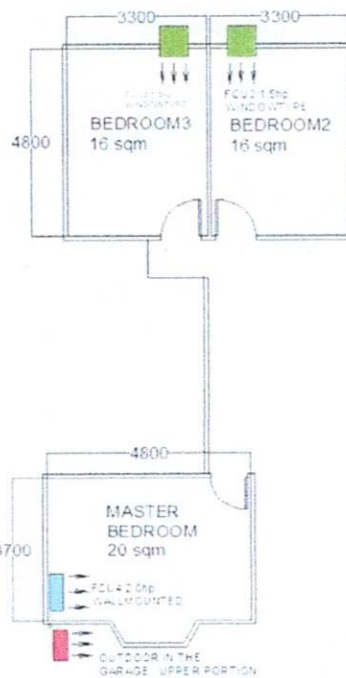

SECOND FLOOR

Total Estimated Charges

P 55,685.00

Validity: This quotation is valid for a period of fifteen (15) days from the date thereof, subject to our confirmation thereafter.

Note:

- 1 Location of indoor and outdoor units were agreed by the customer and Kolin's surveyor.
- 2 AC drain line will be tapped to the nearest drain provision provided by the customer's contractor.
- 3 Need for site visit before installation and for final location of unit for **ACU4. MASTER BEDROOM**
- 4 KAM-150DRC37 Dimension: W x D x H, = 450 X 585 x 346 mm. (17.7 x 21 x 13.6 inches)
- 5 Customer need to cover the side of windowtype if unit is smaller than existing hole.
- 6 Working days: Monday to Saturday, 8am- 5pm with parking. Need working permit.
- 7 Mechanical Plans, Permits, Electrical permits not included.
- 8 Deflectors, masonry, carpentry, chipping & plastering (finishing & restoration) are not included in the installation.
- 9 Electrical power supply (feeder line) **220v/ 60hz/ 1ph** , is not included in the scope of work of Kolin.
Transfer power Supply to new location.
- 10 Final charges will be based on actual installation.

Prepared by:

Jeffrey Dadios
Field Surveyor

Customer Conformer:

PABLO MARRON BAWATE
Signature Over Printed Name

Reviewed by:

Engr. Kenneth Zamora
Service Supervisor
Field and Shop Operation