

kolin

air conditioner

August 12, 2024

ATTN: MR. PABLO GO
1103&1104 THE CELADINE DMCI, A BONIFACIO,
BRGY. BALINGASA, Q.C.
TEL #: 0967-206-7976
Email: go3gos@yahoo.com

Dear Ma'am/Sir,

Kolin Marketing Inc., is extremely honored for your endorsement of Kolin brand and we are please to offer you with a special price/s for the following items.

A. EQUIPMENT & INSTALLATION

**Option 1 - Provision

QTY	U/M	MODEL / DESCRIPTION	SRP	DISCOUNTED PRICE		AMOUNT
1	UNIT/S	MODEL: KSM-IW20-WCT10M1M32 KOLIN WALL MOUNTED CERTUS SERIES AIRCONDITIONER 18,990 KJ/h (2.0HP) REGULAR INVERTER R-32	41,995.00	28,756.10	PHP	28,756.10
1	UNIT/S	MODEL: KAG-145WCINV KOLIN WINDOW TYPE QUAD SERIES AIRCONDITIONER 13,210 KJ/h (1.5HP) FULL DC INVERTER W/ WIFI R-32 (WxDxH) 22"x28"x15"	32,995.00	24,436.10	PHP	24,436.10
1	UNIT/S	MODEL: KAG-100WCINV KOLIN WINDOW TYPE QUAD SERIES AIRCONDITIONER 10,200 KJ/h (1.0HP) FULL DC INVERTER W/ WIFI R-32 (WxDxH) 18"x25"x14"	28,995.00	21,316.10	PHP	21,316.10
TOTAL UNIT COST					PHP	74,508.30
ESTIMATED COST OF INSTALLATION (please see attached)					PHP	30,495.00
OTHERS: DELIVERY CHARGE					PHP	600.00
TOTAL ESTIMATED COST OF THE PROJECT					PHP	105,603.30

TERMS OF PAYMENT:

FULL PAYMENT OF UNIT AND DELIVERY CHARGE. IF CHECK, SUBJECT FOR 3 DAYS CLEARING.

WARRANTY:

FOR SPLIT TYPE : ONE (1) YEAR FREE PARTS AND LABOR, THREE YEARS (3) MAIN PCB , TEN (10) YEARS WARRANTY ON COMPRESSOR.

FOR WINDOW TYPE: ONE (1) YEAR FREE PARTS AND LABOR, THREE YEARS (3) MAIN PCB, TEN (10) YEARS WARRANTY ON COMPRESSOR.

NOTES: PRICES ARE SUBJECT TO CHANGE WITHOUT PRIOR NOTICE.

PRICES IS VAT INCLUSIVE.

** Cost of Installation is Package with the Unit(s), this cost cannot avail separately.

** INSTALLATION C/O ASE

We thank you for giving opportunity to offer our product and services, hoping we receive your purchase order.

If you need assistance, don't hesitate to call the under signed at 0917-807-8607 or email at kmi_asst@kolinphil.com.ph

Very Truly Yours,

JANELLEN S. LIM
KMI-ASSISTANT

Noted by:

MART NATHANIEL R. FLORES
KMI-SUPERVISOR

Approved By:

MS. EDITHA M. FLORES
AVP - FINANCE

Conforme:

SIGNATURE OVER PRINTED NAME

KMI-QUOTE-08-24-0719
REG-22%/4K/1.3K

Kolin Marketing, Inc.

1854 Sta. Rita St., Guadalupe Nuevo, Makati City

www.kolinphil.com.ph

Tel.: (632) 8852-6473

Fax: (632) 8852-2170 / (632) 8852-4792

Bringing comfort to your home.

August 12, 2024

PABLO GO

1103 & 1104 The Celandine by DMCI, A. Bonifacio, Brgy Balingasa, Quezon City

0967-2067976

go3gos@yahoo.com

MODEL	Qty
KSM-IW20-WCT10M1M32	1
KAG-145WCINV	1
KAG-100WCINV	1

OPTION 1-PROVISION

BEDROOM 1	Area	14 sqm
------------------	------	--------

ACU 1	1.5 HP Window type Inverter	KAG-145WCINV	
	Initial Charge		₱ 1,200.00

Includes:

Labor

Consumables

Installation Materials	Description	Qty	Price per qty	Subtotal
Drain Hose	White -1/2"	7 ft	₱ 25.00/ft	₱ 175.00

Estimated Charges	₱ 1,375.00
--------------------------	------------

LIVING/DINING/KITCHEN	Area	21.8 sqm
------------------------------	------	----------

ACU 2	2.0 HP Wall Mounted Inverter	KSM-IW20-WCT10M1M32	
	Estimated Pipe Length = 43 ft		
	Estimated Royal Cord Length = 50 ft		
	Initial Charge		₱ 8,500.00

Includes:

Labor

10ft Copper Tube

10ft Royal Cord

Outdoor Bracket (floor)

Consumables

Installation Materials	Description	Qty	Price per qty	Subtotal
Copper Tube	Ø 1/4" x Ø 1/2"	33 ft	₱ 350.00/ft	₱ 11,550.00
Royal Cord (comm. wire)	2.mm2 x 4C	40 ft	₱ 100.00/ft	₱ 4,000.00
Royal Cord (ACCU-Breaker)	3.5mm x 3c	5 ft	₱ 60.00/ft	₱ 300.00
Circuit Breaker waterproof	30A/1PH	1 pc/s	₱ 1,000.00/pc	₱ 1,000.00
Rubber Insulation	2 1/8" x 3/4" x 6'	6 pc/s	₱ 350.00/pc	₱ 2,100.00
Drain Hose	White -1/2"	5 ft	₱ 25.00/ft	₱ 125.00

Estimated Charges	₱ 27,575.00
--------------------------	-------------

BEDROOM 2	Area	8 sqm
------------------	------	-------

ACU 2	1.0 HP Window type Inverter	KAG-100WCINV	
	Initial Charge		₱ 1,200.00

Includes:

Labor

Consumables

Installation Materials	Description	Qty	Price per qty	Subtotal
Drain Hose	White -1/2"	7 ft	₱ 25.00/ft	₱ 175.00

Estimated Charges	₱ 1,375.00
--------------------------	------------

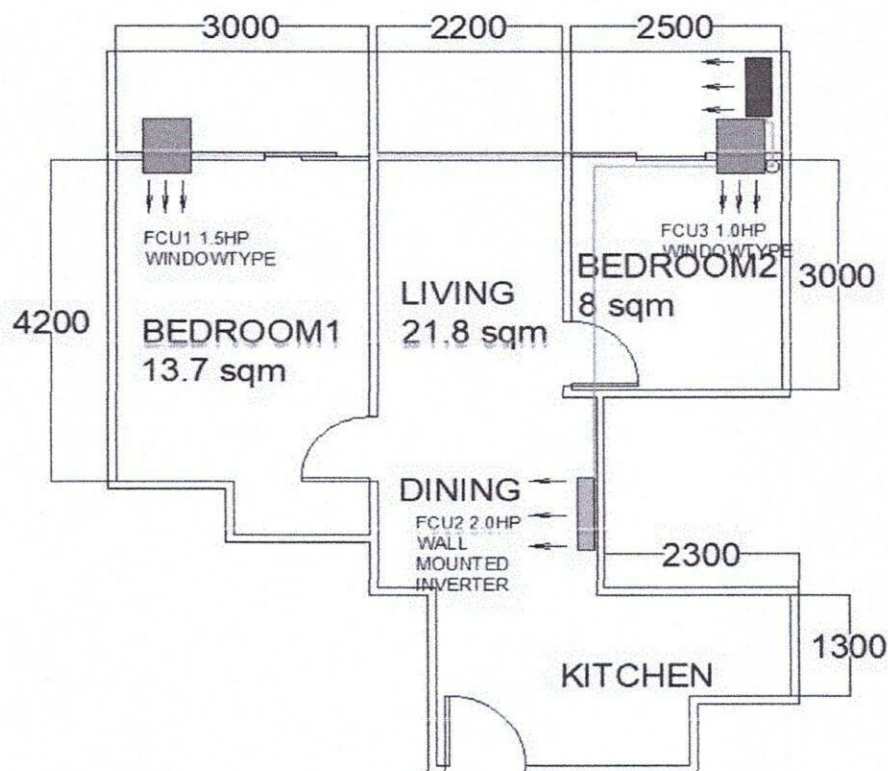

Total Estimated Charges	P 30,495.00
--------------------------------	--------------------

Validity: This quotation is valid for a period of fifteen (15) days from the date thereof, subject to our confirmation thereafter.

Installation notes:

- 1 Location of indoor and outdoor units were agreed by the customer and Kolin's surveyor.
- 2 AC drain line will be tapped to the nearest drain provision provided by the customer's contractor.
- 3 Coppertube expose inside the area.
- 4 Need carpentry works after installation for the windowtype for the enclosure of hole side and top of the units.
- 5 Working days: Monday to Saturday, 8am- 5pm without parking. Need working permit.
- 6 Mechanical Plans, Permits, Electrical permits not included.
- 7 Deflectors, masonry, carpentry, chipping & plastering (finishing & restoration) are not included in the installation.
- 8 Air conditioning drain line and Electrical power supply (feeder line) **220v/ 60hz/ 1ph**, should be provided by customer's contractor.
- 9 **Final charges will be based on actual installation.**

Prepared by:

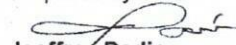
Jeffrey Dadios
 Field Surveyor

Customer Conformance:

 Signature Over Printed Name

Reviewed by:

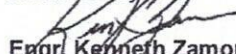
Engr. Kenneth Zamora
 Service Supervisor Shop and
 Field Operation