

kolin

air conditioner

August 2, 2024

MS. JACQUELINE ZHANG
26GH BARON TOWER, WILSON ST., BRGY. STA. LUCIA, SAN JUAN
TEL #: 0917-1690168
Email: jacqui@cocoxfifi.com

Dear Ma'am/Sir,

Kolin Marketing Inc., is extremely honored for your endorsement of Kolin brand and we are please to offer you with a special price/s for the following items.

A. EQUIPMENT & INSTALLATION

****OPTION 1**

QTY	U/M	MODEL / DESCRIPTION	SRP	DISCOUNTED PRICE		AMOUNT
1	UNIT/S	MODEL: KFS-40DAG1M-O KOLIN FLEXMATCH SERIES III AIRCONDITIONER 37,982 Kj/h (4.0HP) INVERTER OUTDOOR UNIT R-410A	108,195.00	84,392.10 ₂	PHP	84,392.10
1	UNIT/S	MODEL: KFS-25BAG1M-I KOLIN FLEXMATCH SERIES III AIRCONDITIONER 24,266 Kj/h (2.5HP) INVERTER INDOOR UNIT R-410A	22,495.00	17,546.10 ₇	PHP	17,546.10
1	UNIT/S	MODEL: KFS-15BAG1M-I KOLIN FLEXMATCH SERIES III AIRCONDITIONER 12,661 Kj/h (1.5HP) INVERTER INDOOR UNIT R-410A	13,995.00	10,916.10 ₁	PHP	10,916.10
TOTAL UNIT COST					PHP	112,854.30
ESTIMATED COST OF INSTALLATION (please see attached) <i>includes old units / other brands</i>					PHP	140,720.00
OTHERS: DELIVERY CHARGE					PHP	600.00
TOTAL ESTIMATED COST OF THE PROJECT					PHP	254,174.30

TERMS OF PAYMENT:

FULL PAYMENT OF UNIT AND DELIVERY CHARGE. IF CHECK, SUBJECT FOR 3 DAYS CLEARING.

WARRANTY:

FOR FLEXMATCH: ONE (1) YEAR FREE PARTS AND LABOR, FIVE (5) YEARS WARRANTY ON COMPRESSOR.

NOTES: PRICES ARE SUBJECT TO CHANGE WITHOUT PRIOR NOTICE.

PRICES IS VAT INCLUSIVE.

**** Cost of Installation is Package with the Unit(s), this cost cannot avail separately.**

INSTALLATION C/O AUTHORIZED SERVICE CENTER.

We thank you for giving opportunity to offer our product and services, hoping we receive your purchase order.

If you need assistance, don't hesitate to call the under signed at 0917-807-8607 or email at kmi_asst@kolinphil.com.ph

Very Truly Yours,



JANELLE S. LIM
KMI-ASSISTANT

Noted by:

MART NATHANIEL R. FLORES
KMI-SUPERVISOR

KMI-QUOTE-08-24-0684
REG-22%

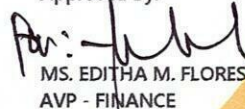
Approved By:

MS. EDITHA M. FLORES
AVP - FINANCE

Conforme:

SIGNATURE OVER PRINTED NAME

ANNIVERSARY
EST. 1996

Kolin Marketing, Inc.

1854 Sta. Rita St., Guadalupe Nuevo, Makati City

www.kolinphil.com.ph

Tel.: (632) 8852-6473

Fax: (632) 8852-2170 / (632) 8852-4792

Bringing comfort to your home.

August 1, 2024
 Jacqueline Zhang
 26GH Baron Tower, Wilson St., Brgy. Sta. Lucia, San Juan
 0717-1690168
jacqui@cocoxfifi.com

MODEL	QUANTITY
KFS-40DAG1M-O	1
KFS-25BAG1M-I	1
KFS-15BAG1M-I	1

OPTION 1-ACCU1 LOCATION

LIVING/DINING/HALLWAY

ACCU 1	4.0hp Flexmatch Inverter	KFS-40DAG1M-O					
	Initial Charge					P	8,500.00
	Includes:						
	Labor						
	10ft Copper Tube						
	10ft Royal Cord						
	Other Consumables						
	Additional Charges	Description	Unit	Price per Unit	Subtotal		
	Royal Cord (ODU-Breaker)	5.5mm2 x 3C	7 ft	P 70.00 / ft	P 490.00		
	Circuit Breaker	40amps/1Ph	1 pc(s)	P 1000.00 / pc	P 1000.00		
	Outdoor Bracket(fabricated)	floor	1 unit	P 2500.00 / unit	P 2500.00	P	3,990.00

LIVING/DINING

Area ≈ 45 sq.m

FCU1A	2.5hp Wall Mounted Inverter	KFS-25BAG1M-I					
	Estimated Pipe Length	30	ft				
	Estimated Royal Cord Length	37	ft				
	Additional Charges	Description	Unit	Price per Unit	Subtotal		
	Coppertube	3/8" x 5/8"	20 ft	P 400.00 / ft	P 8000.00		
	Royal Cord	2mm2 x 4C	27 ft	P 100.00 / ft	P 2700.00		
	Drain Hose	White -1/2"	7 ft	P 25.00 / ft	P 175.00		
	Rubber Insulation	2 1/8x 3/4x 6'	1 pc(s)	P 350.00 / pc	P 350.00		
	Full thread	3 meters	1 pc(s)	P 150.00 / pc	P 150.00		
	Pipe Hanger	3 inches	2 pc(s)	P 120.00 / pc	P 240.00		
	PVC Pipe (Drain)	3/4- blue	1 pc(s)	P 150.00 / ft	P 150.00	P	11,765.00

Estimated Charges for 1st Pair P 24,255.00

FCU1B	1.5hp Wall Mounted Inverter	KFS-10BAG1M-I					
	Labor					P	3,000.00
	Additional Charges	Description	Unit	Price per Unit	Subtotal		
	Coppertube	1/4" x 1/2"	27 ft	P 350.00 / ft	P 9450.00		
	Royal Cord	2mm2 x 4C	34 ft	P 100.00 / ft	P 3400.00		
	Drain Hose	White -1/2"	7 ft	P 25.00 / ft	P 175.00		
	Rubber Insulation	2 1/8x 3/4x 6'	2 pc(s)	P 350.00 / pc	P 700.00		
	Full thread	3 meters	1 pc(s)	P 150.00 / pc	P 150.00		
	Pipe Hanger	3 inches	3 pc(s)	P 120.00 / pc	P 360.00		
	PVC Pipe (Drain)	3/4- blue	2 pc(s)	P 150.00 / ft	P 300.00		14,535.00

Estimated Charges P 17,535.00

OLD UNITS- DISMANTLE AND INSTALL**SECONDARY ROOM/BR1/BR2****ACCU 2 3.5hp Flexmatch Inverter****KFS-35DINV-O****Initial Charge****P 7,000.00**

Includes:

Labor

Other Consumables

SECONDARY ROOM**Area ≈ 9.8 sq.m****FCU2A 1.0hp Wall Mounted Inverter****KFS-10BMINV-I**

Estimated Pipe Length : 30 ft

Estimated Royal Cord Length : 37 ft

Additional Charges	Description	Unit	Price per Unit	Subtotal
Coppertube	1/4" x 3/8"	30 ft	P 350.00 / ft	P 10500.00
Royal Cord	2mm2 x 4C	37 ft	P 100.00 / ft	P 3700.00
Drain Hose	White -1/2"	7 ft	P 25.00 / ft	P 175.00
Rubber Insulation	2 1/8x 3/4x 6'	3 pc(s)	P 350.00 / pc	P 1050.00
Full thread	3 meters	1 pc(s)	P 150.00 / pc	P 150.00
Circuit Breaker	40Amps/1Ph	1 pc(s)	P 1000.00 / pc	P 1000.00
Pipe Hanger	3 inches	4 pc(s)	P 120.00 / pc	P 480.00
Dismantle	1st pair	1 pc(s)	P 2500.00 / pc	P 2500.00
General Cleaning	1st pair	1 pc(s)	P 1500.00 / pc	P 1500.00
PVC Pipe (Drain)	3/4- blue	1 pc(s)	P 150.00 / ft	P 150.00
				21,205.00

Estimated Charges for 1st Pair**P 28,205.00****BR2****Area ≈ 7 sq.m****FCU2B 1.0hp Wall Mounted Inverter****KFS-10BMINV-I****Labor****P 2,000.00**

Additional Charges	Description	Unit	Price per Unit	Subtotal
Coppertube	1/4" x 3/8"	33 ft	P 350.00 / ft	P 11550.00
Royal Cord	2mm2 x 4C	40 ft	P 100.00 / ft	P 4000.00
Drain Hose	White -1/2"	5 ft	P 25.00 / ft	P 125.00
Rubber Insulation	2 1/8x 3/4x 6'	3 pc(s)	P 350.00 / pc	P 1050.00
Full thread	3 meters	1 pc(s)	P 150.00 / pc	P 150.00
Pipe Hanger	3 inches	4 pc(s)	P 120.00 / pc	P 480.00
Dismantle	indoor only	1 pc(s)	P 1250.00 / pc	P 1250.00
General Cleaning	indoor only	1 pc(s)	P 750.00 / pc	P 750.00
PVC Pipe (Drain)	3/4- blue	1 pc(s)	P 150.00 / ft	P 150.00
				19,505.00

Estimated Charges succeeding unit**P 21,505.00****BR1****Area ≈ 8.5 sq.m****FCU2C 1.0hp Wall Mounted Inverter****KFS-10BMINV-I****Labor****P 2,000.00**

Additional Charges	Description	Unit	Price per Unit	Subtotal
Coppertube	1/4" x 3/8"	43 ft	P 350.00 / ft	P 15050.00
Royal Cord	2mm2 x 4C	50 ft	P 100.00 / ft	P 5000.00
Drain Hose	White -1/2"	5 ft	P 25.00 / ft	P 125.00
Rubber Insulation	2 1/8x 3/4x 6'	4 pc(s)	P 350.00 / pc	P 1400.00
Full thread	3 meters	1 pc(s)	P 150.00 / pc	P 150.00
Pipe Hanger	3 inches	6 pc(s)	P 120.00 / pc	P 720.00
Dismantle	indoor only	1 pc(s)	P 1250.00 / pc	P 1250.00
General Cleaning	indoor only	1 pc(s)	P 750.00 / pc	P 750.00
PVC Pipe (Drain)	3/4- blue	1 pc(s)	P 150.00 / ft	P 150.00
				24,595.00

Estimated Charges succeeding unit**P 26,595.00**

Area ≈ 13.8 sq.m

OTHER BRAND-TCL

Estimated Royal Cord Length : 27 ft

P 7,500.00

Labor

Labor

Other Consumables

Additional Charges	Description	Unit		Price Per Unit		Subtotal		
Copper Tube	1/4"x 3/8"	20 ft	P	350.00 / ft	P	7,000.00		
Royal Cord	2.mm2 x 4C	27 ft	P	100.00 / ft	P	2,700.00		
Royal Cord (ODU-Breaker)	3.5mm2 x 3C	5 ft	P	60.00 / ft	P	300.00		
Circuit Breaker(20amp-1ph)	Nema waterproof	1 pc(s)	P	1,000.00 / pc	P	1,000.00		
Dismantle	pair	1 pc(s)	P	2,500.00 / pc	P	2,500.00		
General Cleaning	pair	1 pc(s)	P	1,500.00 / pc	P	1,500.00		
Drain Hose	White -1/2"	5 ft	P	25.00 / ft	P	125.00	P	15,125.00

P	22,625.00
---	-----------

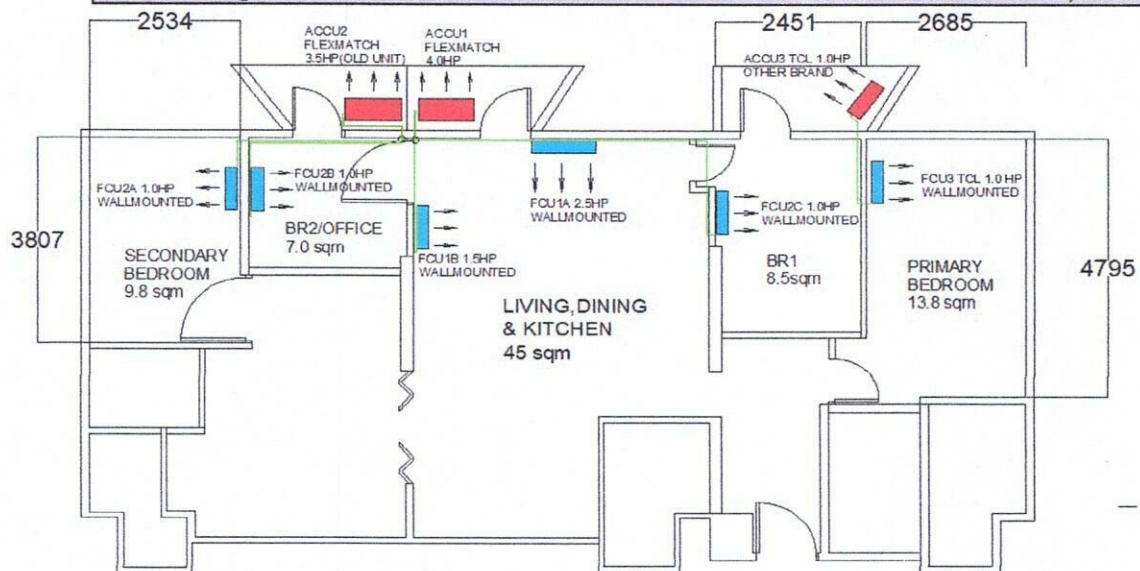

Total Estimated Charges

P 140,720.00

Validity: This quotation is valid for a period of fifteen (15) days from the date thereof, subject to our confirmation thereafter.

Note:

- 1 Location of indoor and outdoor units agree by customer and kolin surveyor.
- 2 AC drain line will be tapped to the nearest drain provision provided by the customer's contractor.
- 3 Dismantle of old units and re-install after the renovation of area. Lay out first of copper tube before the ceiling install.
- 4 LIVING/DINING AND HALLWAY Units (ACU1 & ACU2) need to operate at the same time to avoid undercapacity.
- 5 Kolin pumpdown /pull down only the units. Don't have a storage area.
- 6 Schedule for markings first for pipe layout and drain provisions.
- 7 Working days: Monday to Saturday, 8am- 5pm. parking is for confirmation, need working permit.
- 8 Mechanical Plans, Permits, Electrical permits not included.
- 9 Deflectors, masonry, carpentry, chipping & plastering (finishing & restoration) are not included in the installation.
- 10 Electrical power supply (feeder line) is not included in the scope of work of Kolin.
- 11 Final charges will be based on actual installation.

Additional Notes:

As per our policy, KOLIN team is not allowed to render service and installation of other aircon brands. But to extend our support and goodwill, we give consideration subject to the terms and conditions as stated below:

- 1 Kolin team will include the dismantling and re-installation of the TCL aircon, as well as the general cleaning prior to re installation.
- 2 KOLIN will not held liable for any damage or faulty operation that may occur during dismantling and after re installation as our team doesn't have technical expertise and no technical training for TCL aircon.

Prepared by:

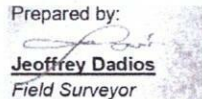
Jeffrey Dadios
Field Surveyor

Customer Conformance:

Signature Over Printed Name

Reviewed by:

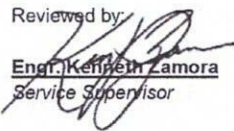
Engr. Kenneth Zamora
Service Supervisor