

# kolin

air conditioner

August 27, 2024

PDP ARCHITECTS  
ATTN: MR. IRWIN CUA  
UNIT 1410, ROSEMONT TOWER, PANAY AVE. BRGY. PAGLISAHAN, QUEZON CITY  
TEL#: 0927-7878839

Dear Ma'am/Sir,

Kolin Marketing Inc., is extremely honored for your endorsement of Kolin brand and we are please to offer you with a special price/s for the following items.

## A. EQUIPMENT & INSTALLATION

QTY	U/M	MODEL / DESCRIPTION	SRP	DISCOUNTED PRICE		AMOUNT
1	UNIT/S	MODEL: KFS-40DAG1M-O KOLIN FLEXMATCH SERIES III AIRCONDITIONER 37,982 Kj/h (4.0HP) INVERTER OUTDOOR UNIT R-410A	108,195.00	84,392.10	PHP	84,392.10
2	UNIT/S	MODEL: KFS-20BAG1M-I KOLIN FLEXMATCH SERIES III AIRCONDITIONER 18,991 Kj/h (2.0HP) INVERTER INDOOR UNIT R-410A	17,195.00	13,412.10	PHP	26,824.20
1	UNIT/S	MODEL: KSM-IW15-WCT10M1M32 KOLIN WALL MOUNTED CERTUS SERIES AIRCONDITIONER 12,660 Kj/h (1.5HP) REGULAR INVERTER R-32	32,995.00	21,736.10	PHP	21,736.10
TOTAL UNIT COST					PHP	132,952.40
ESTIMATED COST OF INSTALLATION including existing old unit (please see attached)					PHP	91,185.00
OTHERS: DELIVERY CHARGE					PHP	600.00
TOTAL ESTIMATED COST OF THE PROJECT					PHP	224,737.40

## TERMS OF PAYMENT:

FULL PAYMENT OF UNIT AND DELIVERY CHARGE. IF CHECK, SUBJECT FOR 3 DAYS CLEARING.

## WARRANTY:

FOR FLEXMATCH: ONE (1) YEAR FREE PARTS AND LABOR, FIVE (5) YEARS WARRANTY ON COMPRESSOR.

FOR SPLIT TYPE : ONE (1) YEAR FREE PARTS AND LABOR, THREE YEARS (3) MAIN PCB , TEN (10) YEARS WARRANTY ON COMPRESSOR.

## NOTES: PRICES ARE SUBJECT TO CHANGE WITHOUT PRIOR NOTICE.

PRICES IS VAT INCLUSIVE.

We thank you for giving opportunity to offer our product and services, hoping we receive your purchase order.

If you need assistance, don't hesitate to call the under signed at 0917-807-8607 or email at kmi\_asst@kolinphil.com.ph

Very Truly Yours,

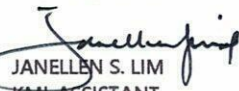
  
JANELLE S. LIM  
KMI-ASSISTANT

Noted by:

  
MART NATHANIEL R. FLORES  
KMI-SUPERVISOR

Approved By:

  
MS. EDITHA M. FLORES  
AVP - FINANCE

KMI-QUOTE-08-24-0738  
ECY-22%/4K

Conforme:

  
SIGNATURE OVER PRINTED NAME  
EST. 1996

Kolin Marketing, Inc.

1854 Sta. Rita St., Guadalupe Nuevo, Makati City

www.kolinphil.com.ph

Tel.: (632) 8852-6473

Fax: (632) 8852-2170 / (632) 8852-4792

Bringing comfort to your home.

August 27, 2024  
 IRWIN CUA/ PDP ARCHITECTS  
 Unit 1410, Rosemont Tower, Panay Ave. Brgy. Paligsahan, Quezon City  
 9277878839  
 viber#: 09277878839

MODEL	QUANTITY
KFS-40DAG1M-O	1
KFS-20BAG1M-I	2
KSM-IW15-WCT10M1M32	1
KSM-SW20-5G1M(OLD UNIT)	1

#### LIVING/DINING

<b>ACCU1</b>	<b>4.0hp Flexmatch Inverter</b>	<b>KFS-40DAG1M-O</b>				
	Initial Charge				P	8,500.00
	Includes:					
	Circuit Breaker (40A-1ph)					
	<b>Additional Charges</b>	<b>Description</b>	<b>Unit</b>	<b>Price per Unit</b>	<b>Subtotal</b>	
	Royal Cord (ODU-Breaker)	5.5mm <sup>2</sup> x 3C	7 ft	P 60.00 / ft	P	420.00
	Outdoor Bracket(fabricated)	floor	1 unit	P 2500.00 / unit	P	2500.00
					P	2,920.00

#### LIVING

						<b>Area ≈ 45 sq.m</b>
<b>FCU1A</b>	<b>2.0hp Wall Mounted Inverter</b>	<b>KFS-20BAG1M-I</b>				
	Estimated Pipe Length	46	ft			
	Estimated Royal Cord Length	51	ft			
	Includes:					
	Labor					
	10ft Copper Tube					
	10ft Royal Cord					
	Other Consumables					
	<b>Additional Charges</b>	<b>Description</b>	<b>Unit</b>	<b>Price per Unit</b>	<b>Subtotal</b>	
	Coppertube	1/4" x 1/2"	36 ft	P 350.00 / ft	P	12,600.00
	Royal Cord	2mm <sup>2</sup> x 4C	41 ft	P 100.00 / ft	P	4,100.00
	Drain Hose	White -1/2"	5 ft	P 25.00 / ft	P	125.00
	Rubber Insulation	2 1/8x 3/4x 6'	6 pc(s)	P 350.00 / pc	P	2,100.00
	Full thread	3 meters	1 pc(s)	P 150.00 / pc	P	150.00
	Pipe Hanger	3 inches	8 pc(s)	P 120.00 / pc	P	960.00
	PVC Pipe (Drain)	3/4- blue	2 pc(s)	P 150.00 / ft	P	300.00
						20,335.00
	<b>Estimated Charges for 1st Pair</b>				P	31,755.00

#### DINING

						<b>Area ≈ 16 sq.m</b>
<b>FCU1B</b>	<b>2.0hp Wall Mounted Inverter</b>	<b>KFS-20BAG1M-I</b>				
	Labor				P	3,000.00
	<b>Additional Charges</b>	<b>Description</b>	<b>Unit</b>	<b>Price per Unit</b>	<b>Subtotal</b>	
	Coppertube	1/4" x 1/2"	56 ft	P 350.00 / ft	P	19,600.00
	Royal Cord	2mm <sup>2</sup> x 4C	61 ft	P 100.00 / ft	P	6,100.00
	Drain Hose	White -1/2"	5 ft	P 25.00 / ft	P	125.00
	Rubber Insulation	2 1/8x 3/4x 6'	7 pc(s)	P 350.00 / pc	P	2,450.00
	Full thread	3 meters	1 pc(s)	P 150.00 / pc	P	150.00
	Pipe Hanger	3 inches	4 pc(s)	P 120.00 / pc	P	480.00
	PVC Pipe (Drain)	3/4- blue	2 pc(s)	P 150.00 / ft	P	300.00
						29,205.00
	<b>Estimated Charges</b>				P	32,205.00

#### MASTER BEDROOM

						<b>Area ≈ 18 sq.m</b>
<b>ACU 2</b>	<b>1.5hp Wallmounted Inverter</b>	<b>KSM-IW15-WCT10M1M32</b>				
	Estimated Pipe Length	20	ft			
	Estimated Royal Cord Length	25	ft			
	Initial Charge				P	7,500.00
	Includes:					
	Labor					
	10ft Copper Tube					
	10ft Royal Cord					
	Outdoor Bracket (wall)					
	Other Consumables					
	<b>Additional Charges</b>	<b>Description</b>	<b>Unit</b>	<b>Price Per Unit</b>	<b>Subtotal</b>	
	Copper Tube	1/4"x 1/2"	10 ft	P 350.00 / ft	P	3,500.00
	Royal Cord	2.mm2 x 4C	15 ft	P 100.00 / ft	P	1,500.00
	Royal Cord (ODU-Breaker)	3.5mm2 x 3C	5 ft	P 60.00 / ft	P	300.00
	Circuit Breaker(20amp-1ph)	Nema waterproof	1 pc(s)	P 1,000.00 / pc	P	1,000.00
	Drain Hose	White -1/2"	5 ft	P 25.00 / ft	P	125.00
						6,425.00
	<b>Estimated Charges</b>				P	13,925.00



**OFFICE ROOM**

Area  $\approx 18$  sq.m

**KSM-SW20-5G1M**

14 ft

19 ft

P 4,000.00

Labor

Other (

### Description

Unit

Price Per Unit

Subtotal

1/4"x 1/2"

14 ft

P

350.00 / ft

4

2,500.00

1 p

P

2,500.00 / pc

2

1,900.00 P      9,300.00

P	13,300.00
---	-----------

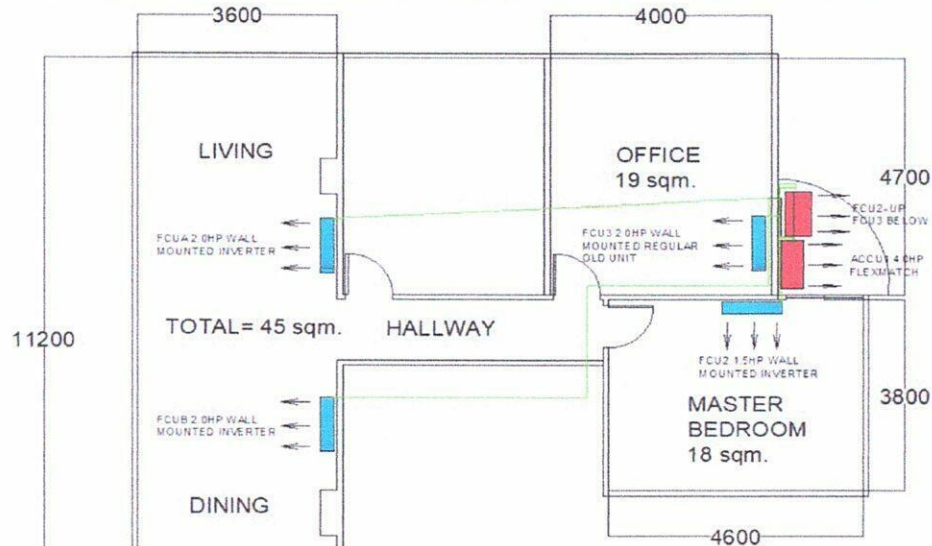

P	91,185.00
---	-----------

**Note:**

- 1 Location of indoor and outdoor units agree by customer and kolin surveyor.
- 2 AC drain line will be tapped to the nearest drain provision provided by the customer's contractor.
- 3 **ACU3, Dismantle and install, same location, just remove the cabinet.**
- 4 Schedule for markings first for pipe layout and drain provisions.
- 5 Working days: Monday to Saturday, 8am- 5pm. parking is for confirmation, need working permit.
- 6 Mechanical Plans, Permits, Electrical permits not included.
- 7 Deflectors, masonry, carpentry, chipping & plastering (finishing & restoration) are not included in the installation.
- 8 Electrical power supply (feeder line) is not included in the scope of work of Kolin.
- 9 **Final charges will be based on actual installation.**

Prepared by:

Jeffrey Dadios  
Field Surveyor

Reviewed by

Engr. Kenneth Zamora  
Service Supervisor - Field and  
Shop Operation

Customer Conformance:

Signature Over Printed Name