

kolin

air conditioner

August 27, 2024

FORT KLAN CONSTRUCTION DEVELOPMENT INC.
DPWH PANDACAN PUMPING STATION COMPOUND, JESUS BRIDGE, PANDACAN MANILA
TEL#: 0936-0514546 / 0963-3600652

Dear Ma'am/Sir,

Kolin Marketing Inc., is extremely honored for your endorsement of Kolin brand and we are please to offer you with a special price/s for the following items.

A. EQUIPMENT & INSTALLATION

** OPTION 2

QTY	U/M	MODEL / DESCRIPTION	SRP	DISCOUNTED PRICE		AMOUNT
1	UNIT/S	MODEL: KSM-IW25-WCT10M1M32 KOLIN WALL MOUNTED CERTUS AIRCONDITIONER 23,210 Kj/h (2.5HP) REGULAR INVERTER W/ WIFI R-32	49,995.00	34,996.10	PHP	34,996.10
2	UNIT/S	MODEL: KSM-IW10-WCT10M1M32 KOLIN WALL MOUNTED CERTUS SERIES AIRCONDITIONER 9,800 Kj/h (1.0HP) REGULAR INVERTER R-32	29,995.00	19,396.10	PHP	38,792.20
TOTAL UNIT COST					PHP	73,788.30
ESTIMATED COST OF INSTALLATION (please see attached)					PHP	68,800.00
OTHERS: DELIVERY CHARGE					PHP	600.00
TOTAL ESTIMATED COST OF THE PROJECT					PHP	143,188.30

TERMS OF PAYMENT:

FULL PAYMENT OF UNIT AND DELIVERY CHARGE. IF CHECK, SUBJECT FOR 3 DAYS CLEARING.

INSTALLATION:

* Initial Charge for 1 Wall Mounted AC: P7,500.00 (1.0HP-2.0HP) / P8,500.00 (2.5HP-3.0HP)

Inclusions: Labor, Outdoor Standard Bracket, Consumables, 10ft PVC Pipes ¾, 1st 10ft. Royal Cord Wire and 1st 10ft. Copper Tube.

Exclusions: Excess of 1st 10ft. Royal Cord 100/foot, Copper Tube 350/foot (1.0hp-2.0hp), 400/foot (2.5hp-3.hp), Circuit Breaker (Nema), Special Designed Brack

WARRANTY:

FOR SPLIT TYPE : ONE (1) YEAR FREE PARTS AND LABOR, THREE YEARS (3) MAIN PCB , TEN (10) YEARS WARRANTY ON COMPRESSOR.

NOTES: *** Need to sign waiver agreement due to under capacity of unit choice.

PRICES ARE SUBJECT TO CHANGE WITHOUT PRIOR NOTICE.

PRICES IS VAT INCLUSIVE.

We thank you for giving opportunity to offer our product and services, hoping we receive your purchase order.

If you need assistance, don't hesitate to call the under signed at 0917-807-8607 or email at kmi_asst@kolinphil.com.ph

Very Truly Yours,

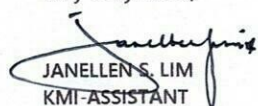
JANELLEN S. LIM
KMI-ASSISTANT

Noted by:

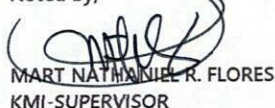
MART NATHANIEL R. FLORES
KMI-SUPERVISOR

Approved By:

MS. EDITHA M. FLORES
AVP - FINANCE

Conforme:

SIGNATURE OVER PRINTED NAME

KMI-QUOTE-08-24-0737
REG-22%/4K

Kolin Marketing, Inc.

1854 Sta. Rita St., Guadalupe Nuevo, Makati City

www.kolinphil.com.ph

Tel.: (632) 8852-6473

Fax: (632) 8852-2170 / (632) 8852-4792

Bringing comfort to your home.

AUGUST 21, 2024

Fort Klan Construction Development Inc.

DPWH Pandacan Pumping Station Compound , Jesus Bridge Pandacan Manila

0936-0514546/0963-3600652

MODEL	Qty
KSM-IW25-WCT10M1M32	1
KSM-IW10-WCT10M1M32	2

OPTION 2

SCADA ROOM1	Area	22 sqm
-------------	------	--------

ACU 1	2.5 HP Wall Mounted Inverter	KSM-IW25-WCT10M1M32			
	Estimated Pipe Length = 40 ft				
	Estimated Royal Cord Length = 45 ft				
	Initial Charge				₱ 8,500.00
	Includes:				
	Labor				
	10ft Copper Tube				
	10ft Royal Cord				
	Outdoor Bracket (Wall)				
	Consumables				
	Installation Materials	Description	Qty	Price per qty	Subtotal
	Copper Tube	Ø 1/4" x Ø 1/2"	30 ft	₱ 400.00/ft	₱ 12,000.00
	Royal Cord (comm. wire)	2.mm2 x 4C	35 ft	₱ 100.00/ft	₱ 3,500.00
	Royal Cord (ACCU-Breaker)	3.5mm x 3c	5 ft	₱ 60.00/ft	₱ 300.00
	Circuit Breaker waterproof	30A / 1Ph	1 pc/s	₱ 1,000.00/pc	₱ 1,000.00
	PVC blue	3/4" x 10'	2 pc/s	₱ 150.00/pc	₱ 300.00
					₱ 17,100.00
	Estimated Charges				₱ 25,600.00

SCADA ROOM2	Area	11 sqm
-------------	------	--------

ACU 2	1.0 HP Wall Mounted Inverter	KSM-IW10-WCT10M1M32			
	Estimated Pipe Length = 40 ft				
	Estimated Royal Cord Length = 45 ft				
	Initial Charge				₱ 7,500.00
	Includes:				
	Labor				
	10ft Copper Tube				
	10ft Royal Cord				
	Outdoor Bracket (Wall)				
	Consumables				
	Installation Materials	Description	Qty	Price per qty	Subtotal
	Copper Tube	Ø 1/4" x Ø 3/8"	30 ft	₱ 350.00/ft	₱ 10,500.00
	Royal Cord (comm. wire)	2.mm2 x 4C	35 ft	₱ 100.00/ft	₱ 3,500.00
	Royal Cord (ACCU-Breaker)	3.5mm x 3c	5 ft	₱ 60.00/ft	₱ 300.00
	Circuit Breaker waterproof	20A/ 1PH	1 pc/s	₱ 1,000.00/pc	₱ 1,000.00
	PVC blue	3/4" x 10'	2 pc/s	₱ 150.00/pc	₱ 300.00
					₱ 15,600.00
	Estimated Charges				₱ 23,100.00

QUARTERS ROOM	Area	6 sqm
---------------	------	-------

ACU 3	1.0 HP Wall Mounted Inverter	KSM-IW10-9L1M			
	Estimated Pipe Length = 30 ft	KSM-IW10-WCT10M1M32			
	Estimated Royal Cord Length = 35 ft				
	Initial Charge				₱ 7,500.00
	Includes:				
	Labor				
	10ft Copper Tube				
	10ft Royal Cord				
	Outdoor Bracket (Wall)				
	Consumables				
	Installation Materials	Description	Qty	Price per qty	Subtotal
	Copper Tube	Ø 1/4" x Ø 3/8"	20 ft	₱ 350.00/ft	₱ 7,000.00
	Royal Cord (comm. wire)	2.mm2 x 4C	25 ft	₱ 100.00/ft	₱ 2,500.00
	Royal Cord (ACCU-Breaker)	3.5mm x 3c	5 ft	₱ 60.00/ft	₱ 300.00
	Circuit Breaker waterproof	20A/ 1PH	1 pc/s	₱ 1,000.00/pc	₱ 1,000.00
	PVC blue	3/4" x 10'	2 pc/s	₱ 150.00/pc	₱ 300.00
	Scaffoldings	3sets	1 pc/s	₱ 1,500.00/pc	₱ 1,500.00
					₱ 12,600.00
	Estimated Charges				₱ 20,100.00

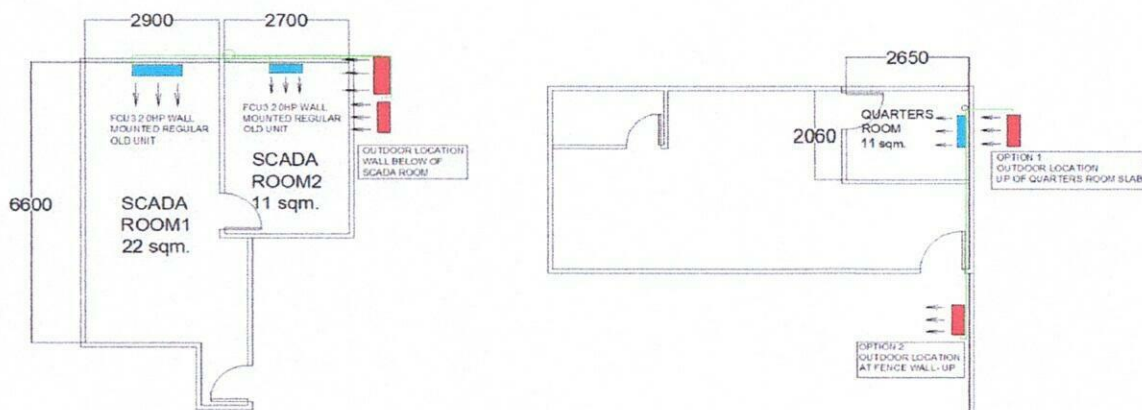

Total Estimated Charges P 68,800.00

Validity: This quotation is valid for a period of fifteen (15) days from the date thereof, subject to our confirmation thereafter.

Installation notes:

- 1 Location of indoor and outdoor units were agreed by the customer and Kolin's surveyor.
- 2 AC drain line will be tapped to the nearest drain provision provided by the customer's contractor.
- 3 Need for marking for drainline and site visit before installation.
- 4 Coppertube expose in the area.
- 5 Working days: Monday to Saturday, 8am- 5pm with parking. Need working permit. bring harness
- 6 Mechanical Plans, Permits, Electrical permits not included.
- 7 Deflectors, masonry, carpentry, chipping & plastering (finishing & restoration) are not included in the installation.
- 8 Air conditioning drain line and Electrical power supply (feeder line) **220v/ 60hz/ 1ph**, should be provided by customer's contractor.
- 9 **Final charges will be based on actual installation.**

Prepared by:

Jeffrey Dadios
Jeffrey Dadios
 Field Surveyor

Customer Conformance:

 Signature Over Printed Name

Reviewed by:

Engr. Kenneth Zamora
Engr. Kenneth Zamora
 Service Supervisor Shop and
 Field Operation