

# kolin

air conditioner

August 29, 2024

MR. ALVIN ADRADA  
UNIT 1225 TOWER 4, SHORE RESIDENCES SEASIDE BLVD. COR. SUNRISE DRIVE, MOA COMPLEX PASAY CITY  
TEL#: 0956-8148971

Dear Ma'am/Sir,

Kolin Marketing Inc., is extremely honored for your endorsement of Kolin brand and we are please to offer you with a special price/s for the following items.

## A. EQUIPMENT & INSTALLATION

QTY	U/M	MODEL / DESCRIPTION	SRP	DISCOUNTED PRICE		AMOUNT
1	UNIT/S	MODEL: KFS-20DAG1M-O KOLIN FLEXMATCH SERIES III AIRCONDITIONER 18,991 Kj/h (2.0HP) INVERTER OUTDOOR UNIT R-410A	55,195.00	43,052.10	PHP	43,052.10
2	UNIT/S	MODEL: KFS-10BAG1M-I KOLIN FLEXMATCH SERIES III AIRCONDITIONER 9,496 Kj/h (1.0HP) INVERTER INDOOR UNIT R-410A	12,295.00	9,590.10	PHP	19,180.20
TOTAL UNIT COST					PHP	62,232.30
ESTIMATED COST OF INSTALLATION (please see attached)					PHP	24,490.00
OTHERS: DELIVERY CHARGE					PHP	600.00
TOTAL ESTIMATED COST OF THE PROJECT					PHP	87,322.30

## TERMS OF PAYMENT:

FULL PAYMENT OF UNIT AND DELIVERY CHARGE. IF CHECK, SUBJECT FOR 3 DAYS CLEARING.

## WARRANTY:

FOR FLEXMATCH: ONE (1) YEAR FREE PARTS AND LABOR, FIVE (5) YEARS WARRANTY ON COMPRESSOR.

## NOTES: PRICES ARE SUBJECT TO CHANGE WITHOUT PRIOR NOTICE.

PRICES IS VAT INCLUSIVE.

\*\* Cost of Installation is Package with the Unit(s), this cost cannot avail separately.

\*\* INSTALLATION C/O ASC

We thank you for giving opportunity to offer our product and services, hoping we receive your purchase order.

If you need assistance, don't hesitate to call the under signed at 0917-807-8607 or email at kmi\_asst@kolinphil.com.ph

Very Truly Yours,

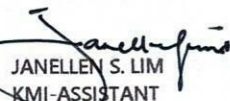
  
JANELLE S. LIM  
KMI-ASSISTANT

Noted by:

  
MART NATHANIEL R. FLORES  
KMI-SUPERVISOR

Approved By:

  
MS. EDITH M. FLORES  
AVP - FINANCE

Conforme:

SIGNATURE OVER PRINTED NAME

KMI-QUOTE-08-24-0746  
OMF-22%

Kolin Marketing, Inc.

1854 Sta. Rita St., Guadalupe Nuevo, Makati City

www.kolinphil.com.ph

Tel.: (632) 8852-6473

Fax: (632) 8852-2170 / (632) 8852-4792

Bringing comfort to your home.

August 29, 2024

Alvin Andrada

Unit 1225 Tower 4 Shore 3 Res. Seaside Blvd. Cor. Sunrise Drive, MOA Complex, Pasay City

0956-8148971

MODEL	QUANTITY
KFS-20DAG1M-O	1
KFS-10BAG1M-I	2

**OPTION 1-ACCU1 LOCATION**

**LIVING/DINING/BEDROOM**

<b>ACCU</b>	<b>2.0hp Flexmatch Inverter</b>	<b>KFS-20DAG1M-O</b>	
	Initial Charge		P 8,500.00
	Includes:		

Circuit Breaker (40A-1ph)

Additional Charges	Description	Unit	Price per Unit	Subtotal
Royal Cord (ODU-Breaker)	5.5mm2 x 3C	7 ft	P 70.00 / ft	P 490.00
Outdoor Bracket(fabricated)	floor	1 unit	P 2500.00 / unit	P 2500.00
				P 2,990.00

**LIVING/DINING**

Area ≈ 14 sq.m

<b>FCU A</b>	<b>1.0hp Wall Mounted Inverter</b>	<b>KFS-10BAG1M-I</b>
--------------	------------------------------------	----------------------

Estimated Pipe Length :	14	ft
Estimated Royal Cord Length :	19	ft

Includes:

Labor

10ft Copper Tube

10ft Royal Cord

Other Consumables

Additional Charges	Description	Unit	Price per Unit	Subtotal
Coppertube	3/8" x 1/4"	4 ft	P 350.00 / ft	P 1,400.00
Royal Cord	2mm2 x 4C	9 ft	P 100.00 / ft	P 900.00
Drain Hose	White -1/2"	5 ft	P 25.00 / ft	P 125.00
PVC Pipe (Drain)	3/4- blue	1 pc(s)	P 150.00 / ft	P 150.00
				2,575.00

<b>Estimated Charges for 1st Pair</b>	P 14,065.00
---------------------------------------	-------------

**BEDROOM**

Area ≈ 5.4 sq.m

<b>FCU B</b>	<b>1.5hp Wall Mounted Inverter</b>	<b>KFS-10BAG1M-I</b>
--------------	------------------------------------	----------------------

Labor				P 3,000.00
-------	--	--	--	------------

Additional Charges	Description	Unit	Price per Unit	Subtotal
Coppertube	1/4" x 3/8"	14 ft	P 350.00 / ft	P 4,900.00
Royal Cord	2mm2 x 4C	21 ft	P 100.00 / ft	P 2,100.00
Drain Hose	White -1/2"	5 ft	P 25.00 / ft	P 125.00
PVC Pipe (Drain)	3/4- blue	2 pc(s)	P 150.00 / ft	P 300.00
				7,425.00

<b>Estimated Charges</b>	P 10,425.00
--------------------------	-------------



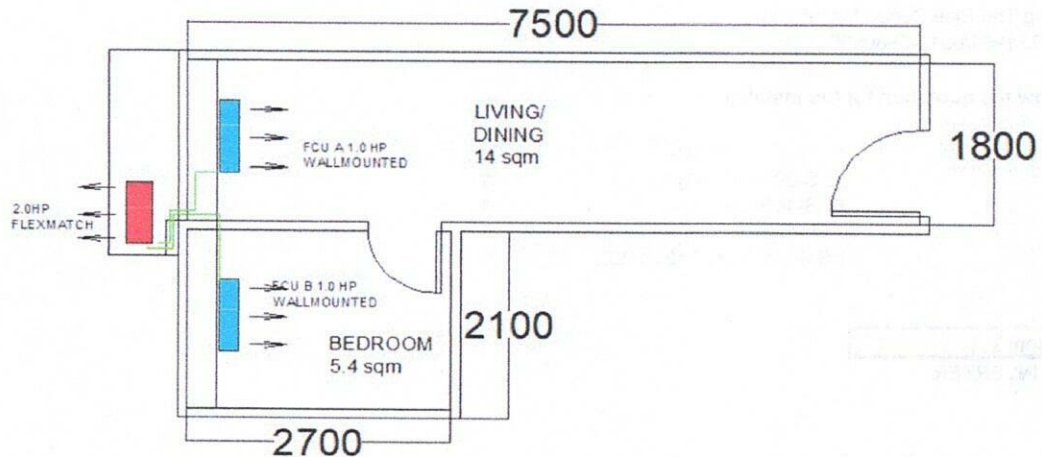

**Total Estimated Charges**

**P 24,490.00**

**Validity:** This quotation is valid for a period of fifteen (15) days from the date thereof, subject to our confirmation thereafter.

**Note:**

- 1 Location of indoor and outdoor units agree by customer and kolin surveyor.
- 2 AC drain line will be tapped to the nearest drain provision provided by the customer's contractor.
- 3 Adjust drainline by 3 inches going down.
- 4 Need to open the false beam and column for the lay out of coppertube.
- 5 Working days: Monday to Saturday, 8am- 5pm. parking is for confirmation, need working permit.
- 6 Mechanical Plans, Permits, Electrical permits not included.
- 7 Deflectors, masonry, carpentry, chipping & plastering (finishing & restoration) are not included in the installation.
- 8 Electrical power supply (feeder line) is not included in the scope of work of Kolin.
- 9 Final charges will be based on actual installation.

Prepared by:

Jeffrey Dadios  
Field Surveyor

Customer Conformer:

\_\_\_\_\_  
Signature Over Printed Name

Reviewed by:

Engr. Kenneth Zamora  
Service Supervisor - Field and  
Shop Operation