

kolin

air conditioner

August 29, 2024

MS. JELEN PRONSTROLLER
62 MONACO ST., LOYOLA GRANDVILLAS, MARIKINA CITY
TEL #: 0917-8161137

Dear Ma'am/Sir,

Kolin Marketing Inc., is extremely honored for your endorsement of Kolin brand and we are please to offer you with a special price/s for the following items.

A. EQUIPMENT & INSTALLATION

QTY	U/M	MODEL / DESCRIPTION	SRP	DISCOUNTED PRICE		AMOUNT
1	UNIT/S	MODEL: KSM-IW25-WCT10M1M32 KOLIN WALL MOUNTED CERTUS AIRCONDITIONER 23,210 Kj/h (2.5HP) REGULAR INVERTER W/ WIFI R-32	49,995.00	34,996.10	PHP	34,996.10
TOTAL UNIT COST					PHP	34,996.10
ESTIMATED COST OF INSTALLATION (please see attached)					PHP	17,595.00
OTHERS: DELIVERY CHARGE					PHP	600.00
TOTAL ESTIMATED COST OF THE PROJECT					PHP	53,191.10

TERMS OF PAYMENT:

FULL PAYMENT OF UNIT AND DELIVERY CHARGE. IF CHECK, SUBJECT FOR 3 DAYS CLEARING.

WARRANTY:

FOR SPLIT TYPE : ONE (1) YEAR FREE PARTS AND LABOR, THREE YEARS (3) MAIN PCB , TEN (10) YEARS WARRANTY ON COMPRESSOR.

NOTES: PRICES ARE SUBJECT TO CHANGE WITHOUT PRIOR NOTICE.

PRICES IS VAT INCLUSIVE.

**** Cost of Installation is Package with the Unit(s), this cost cannot avail separately.**

We thank you for giving opportunity to offer our product and services, hoping we receive your purchase order.

If you need assistance, don't hesitate to call the under signed at 0917-807-8607 or email at kmi_asst@kolinphil.com.ph

Very Truly Yours,

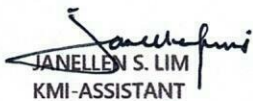
JANELLEN S. LIM
KMI-ASSISTANT

Noted by:

MART NATHANIEL R. FLORES
KMI-SUPERVISOR

Approved By:



MS. EDITHA M. FLORES
AVP - FINANCE

KMI-QUOTE-08-24-0744
ECY-22%/4K

Kolin Marketing, Inc.

1854 Sta. Rita St., Guadalupe Nuevo, Makati City
www.kolinphil.com.ph
Tel.: (632) 8852-6473
Fax: (632) 8852-2170 / (632) 8852-4792

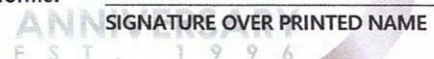
Conforme:

SIGNATURE OVER PRINTED NAME
EST. 1996

Bringing comfort to your home.

KOLIN Philippines International Inc.
Survey Form

No 003524

Customer Name : SEVEN PROSTHOWER

Address : 67 MONXCO ST. LOYO G. GRAND VILLAS MARIKINA

Date : 8-28-24

SJR No. : 219621

Establishment Type : Residential ☒
 Commercial ☐

Area Surveyed : MASTER BEDROOM

Area Surveyed : _____

Recommended Product Model : KSM-11K5-WCT10M1M32

Cooling Capacity Computation

Floor Area : 32.7 sqm.
 Ceiling Height : 2.5 mtr.

note: add 20% per meter in excess of 3 meters in the initial cooling capacity computed.

Floor Area :	<u>32.7</u>	x	550 Btu/h	<u>17985</u> Btu/h
Ceiling Height (excess of 3 mtrs.) :		x	20%	
Window Direct Sunlight		x	20% - 50%	<u>3577</u> Btu/h
Total Cooling Capacity				<u>21562</u> Btu/h

Add : Additional Heat Load

No. of Person	<u>2</u>	x	300 Btu/h	<u>600</u> Btu/h
No. of Ordinary Light (<40w)	<u>4</u>	x	200 Btu/h	<u>800</u> Btu/h
No. of Special Light (>40w)		x	400 Btu/h	
No. of Refrigerator (< 6 cu.ft.)		x	400 Btu/h	
No. of Refrigerator (> 6 cu.ft.)		x	800 Btu/h	
No. of Cooking Range		x	1500 Btu/h	
No. of Laptop Computer		x	150 Btu/h	
No. of Desktop Computer <u>1pc</u>	<u>1</u>	x	400 Btu/h	<u>400</u> Btu/h
No. of Printer		x	500 Btu/h	
No. of Photocopier		x	1000 Btu/h	
Total Cooling Capacity				<u>1860</u> Btu/h
				<u>2.5</u>
Recommended Cooling Capacity				<u>23782</u> Btu/h

Note : Compressor warranty will be reduced to ____ yr. if air-conditioner purchased is lower than the recommended cooling capacity or pipe lay-out is beyond the maximum allowable length.

Scope of Work Agreement

- | | | |
|-----------------------------------|--|--|
| 1. Copper tube lay-out | <input checked="" type="checkbox"/> Expose | <input type="checkbox"/> Embedded |
| 2. Chipping | <input type="checkbox"/> Included | <input checked="" type="checkbox"/> Not Included |
| 3. Fabricated Bracket | <input type="checkbox"/> Yes <input type="checkbox"/> Shop | <input type="checkbox"/> Site <input checked="" type="checkbox"/> No |
| 4. Service Ledge | <input type="checkbox"/> Yes | <input checked="" type="checkbox"/> No |
| 5. Dismantling of existing Aircon | <input type="checkbox"/> Included | <input checked="" type="checkbox"/> Not Included |
| 6. Ducting | <input type="checkbox"/> Yes | <input checked="" type="checkbox"/> No |

Dimension : _____

- Plastering, carpentry and restoration works are to be done by the customer.
- Wiring of electrical supply from main panel to air-conditioning unit are to be done by the customer.
- Processing of mechanical plan, working permit, electrical permit are to be done by the customer.
- Other concern: NEW LOCATION OF WIRE INDOOR AND OUTDOOR. CUSTOMER NEEDS TO TRANSFER POWER SUPPLY TO NEW LOCATION OF OUTDOOR - MAKE X HOLE GOING TO EXTERIOR, WALK IN CLOSET, AND GOING OUTSIDE WITH DRAINPIPE.

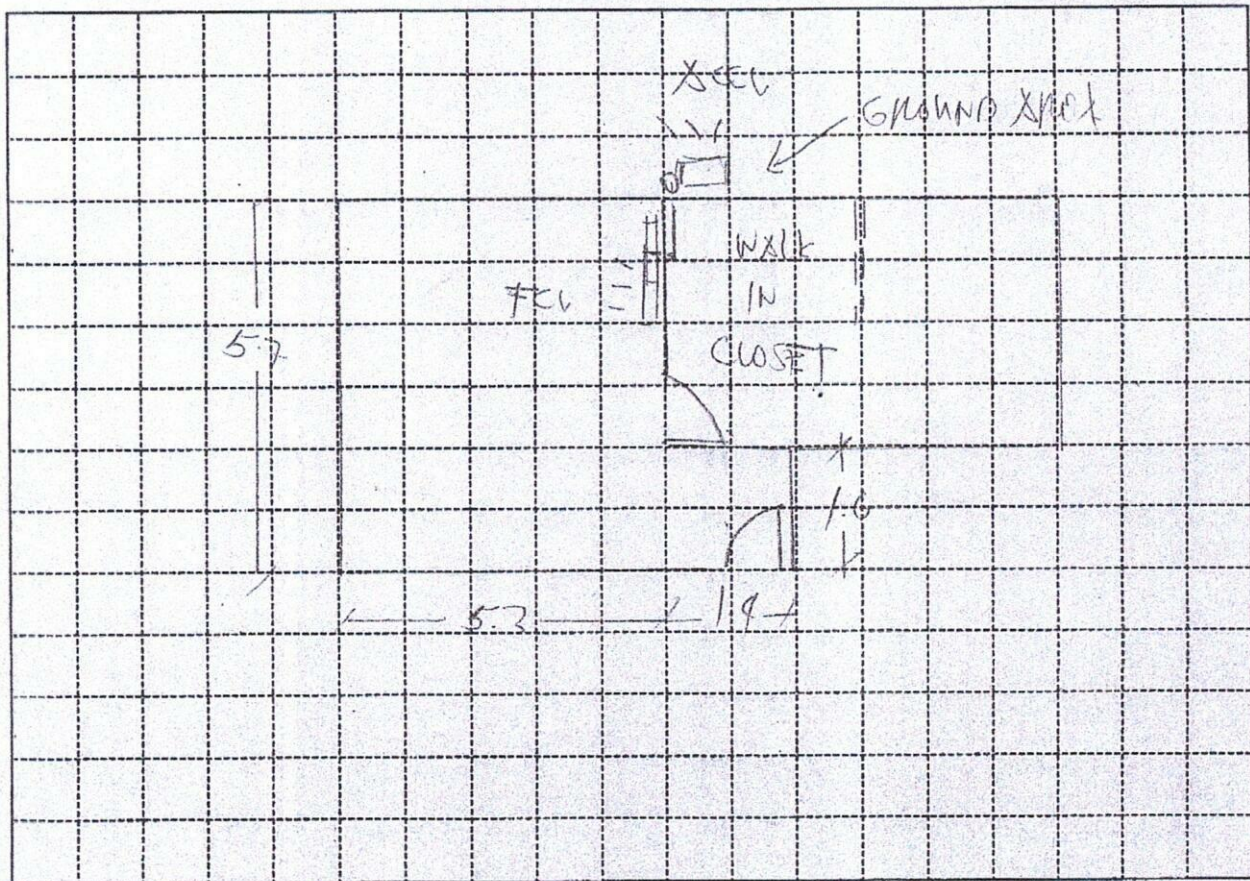

Indoor Unit Location : RIGHT OF XPEX, WALK OF WALK IN CLOSET CENTER
 Outdoor Unit Location : AT THE WALK OUTSIDE OF LIVING
 Pipe Length : 23 FT / 7 METERS
 Special Note : _____

Installation Cost Estimate				
Material Description	Qty.	Unit Cost	Total Cost	
Copper Tube (excess of 10 ft.)	2330, 2430, 2520, 3520, 4620	13 FT	400	5200
Wire (Royal Cord-signal wire) (excess of 10ft.)	2.0mmx4C	20 FT	100	2000
Wire (Royal Cord - Breaker to ODU)	3.5mm / 5.5mm x 3C	7 FT	60	420
Circuit Breaker	20A, 30A, 40A/1ph, 40A/3ph	1	1000	1000
Bracket (ODU)	(Imptd. / Fabricated) ; (Floor / Wall)			
Bracket (WAC)	Angle Type			
PVC Pipe (drain)	1/2", 3/4"	2	150	300
PVC Pipe (electrical)	3/4", 1"			
Drain Pump				
Drain Pump Hose	WHITE 1/2"	7 FT	25	175
Chipping Works	mtr.			
Dismantling Fee (existing air-conditioner)				
Initial Charge				8000
TOTAL ESTIMATE			P	17,575-

Note :

1. Initial Charge includes labor, 10ft. Copper tube, 10ft. Royal cord, Circuit breaker, Outdoor Bracket (SAC), Indoor Bracket (PAC) and Consumable materials.
2. Survey fee will be deducted in the installation fee.

Prepared by:

JEFFREY DAVIS
 Signature Over Printed Name

Customer Conforms:

JEFFREY DAVIS
 Signature Over Printed Name