



December 9, 2024

STATE CENTER
UNIT 1414, 333 JUAN LUNA ST., BINONDO MANILA
TEL#: 0908-9526124

Dear Ma'am/Sir,

Kolin Marketing Inc., is extremely honored for your endorsement of Kolin brand and we are please to offer you with a special price/s for the following items.

A. EQUIPMENT & INSTALLATION

QTY	U/M	MODEL / DESCRIPTION	SRP	DISCOUNTED PRICE		AMOUNT
1	UNIT/S	MODEL: KSG-IWF-30WFY-8K1M32 KOLIN WALL MOUNTED PRIMUS GOLD AIRCONDITIONER 29,500 Kj/h (3.0HP) FULL DC INVERTER W/ WIFI R-32	76,595.00	52,744.10	PHP	52,744.10
TOTAL UNIT COST					PHP	52,744.10
ESTIMATED COST OF INSTALLATION (please see attachments)					PHP	19,100.00
OTHERS: DELIVERY CHARGE					PHP	600.00
TOTAL ESTIMATED COST OF THE PROJECT					PHP	72,444.10

TERMS OF PAYMENT:

FULL PAYMENT OF UNIT AND DELIVERY CHARGE. IF CHECK, SUBJECT FOR 3 DAYS CLEARING.

WARRANTY:

FOR SPLIT TYPE : ONE (1) YEAR FREE PARTS AND LABOR, THREE YEARS (3) MAIN PCB , TEN (10) YEARS WARRANTY ON COMPRESSOR.

NOTES: *** Need to sign waiver agreement due to under capacity of unit choice.

PRICES ARE SUBJECT TO CHANGE WITHOUT PRIOR NOTICE.

PRICES IS VAT INCLUSIVE.

* Cost of Installation is Package with the Unit(s), this cost cannot avail separately

** You may pay first for the unit costs, payment for installation to be paid after the actual works.

*** Final overall installation cost will be based on actual.

We thank you for giving opportunity to offer our product and services, hoping we receive your purchase order.

If you need assistance, don't hesitate to call the under signed at 0917-807-8607 or email at kmi_asst@kolinphil.com.ph

Very Truly Yours,

JANELLEN S. LIM
KMI-ASSISTANT

Noted by:

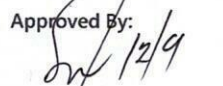
MART NATHANIEL R. FLORES
KMI-SUPERVISOR

Approved By:

MS. EDITHA M. FLORES
AVP - FINANCE

KMI-QUOTE-12-24-1000
REG-22%/7K

Conforme: _____
SIGNATURE OVER PRINTED NAME



DECEMBER 05, 2024

STATE CENTER

State Center Bldg. Unit 1414, 333 Juan Luna St. Binondo, Manila

0908-9526124

MODEL
KSG-IWF-30WFF-8K1M32

QUANTITY
1

Revision 1
UNIT 1414

AREA 1 Area ≈ 35 sq.m

ACU 3.0hp Floor mounted Inverter KSG-IWF-30WFF-8K1M32
Estimated Pipe Length : 27 ft
Estimated Royal Cord Length : 32 ft
Initial Charge P 8,500.00
Includes:
Labor
10ft Copper Tube
10ft Royal Cord
Outdoor Bracket
Other Consumables

Additional Charges	Description	Unit	Price Per Unit	Subtotal
Copper Tube	3/8" x 5/8"	17 ft	P 400.00 / ft	P 6,800.00
Royal Cord	2.5mm2 x 4C	22 ft	P 100.00 / ft	P 2,200.00
Royal Cord (ODU-Breaker)	3.5mm2 x 3C	5 ft	P 60.00 / ft	P 300.00
Circuit Breaker(NEMA)	30A/ 1Ph	1 pc(s)	P 1,000.00 / pc	P 1,000.00
PVC (Drainline)	blue- 3/4"	2 pc(s)	P 150.00 / pc	P 300.00
				P 10,600.00

Total Estimated Charges P 19,100.00

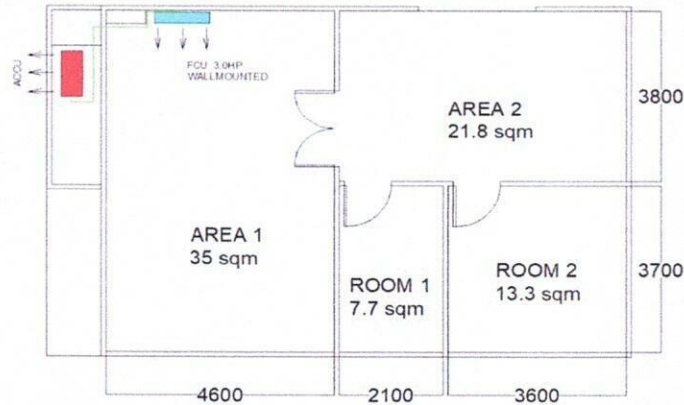

Validity: This quotation is valid for a period of fifteen (15) days from the date thereof, subject to our confirmation thereafter.

Note:

- 1 Location of indoor and outdoor units were agreed by the customer and Kolin's surveyor.
- 2 AC drain line will be tapped to the nearest drain provision provided by the customer's contractor.
- 3 Coppertube and drainline expose in the area.
- 4 Working days: Monday to Saturday, 8am- 5pm without parking. Need working permit. 4 pax
- 5 Need waiver due to undercapacity.
- 6 Mechanical Plans, Permits, Electrical permits not included.
- 7 Deflectors, masonry, carpentry, chipping & plastering (finishing & restoration) are not included in the installation.
- 8 Electrical power supply (feeder line) **220v/ 60hz/ 1ph** , is not included in the scope of work of Kolin.
- 9 **Final charges will be based on actual installation.**

Prepared by:

Jeffrey Dadios
Field Surveyor

Customer Conformer:

Signature Over Printed Name

Reviewed by:

Engr. Kenneth Zamora
Service Supervisor
Field and Shop Operation

DECEMBER 05, 2024

STATE CENTER

State Center Bldg. Unit 1414, 333 Juan Luna St. Binondo, Manila

[0908-9526124](tel:0908-9526124)

Please be informed that the air-conditioner you intend to purchase is under capacity as compared to the following unit that we proposed:

Location	Area	Kolin's Recommendation	Customer's Choice	Remarks
AREA 1- OFFICE	35 sqm	KLG-IF40-5G1M32	KSG-IWF-30WFFY-8K1M32	Calculated 3.4hp, under by 0.4hp

Since the unit of your choice is under capacity, it is probable that you may experience the following;

1. Capacity of the unit to cool the area will take longer or it will not cool the area at all that may lead to your dissatisfaction with the cooling performance of our unit.
2. Power consumption will be higher due to frequent running of compressor for not reaching the desired temperature within the normal parameter.
3. Useful life of compressor will be shortened due to excessive running beyond the normal run cycle.

Considering the above conditions, we regret to inform you that we cannot guarantee the efficient performance of unit. **Also, One (1) year warranty for parts (compressor-10year).**

For your guidance and information

Prepared by:

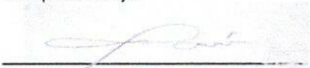

Jeffrey Dadios
Surveyor

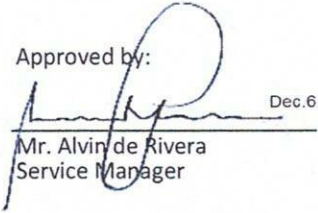
Approved by:

Mr. Alvin de Rivera
Service Manager

Dec.6,2024

Noted by:

Engr. Kenneth Zamora
Service Supervisor
Field and Shop Operation

Customer Conforme:

Signature Over Printed Name