

July 26, 2024

MR. CHRISTIAN CHING  
2248 SIMEON DE JESUS, SAN RAFAEL VILLAGE, BALUT TONDO, MANILA  
TEL#: 0977-4585052

Dear Ma'am/Sir,

Kolin Marketing Inc., is extremely honored for your endorsement of Kolin brand and we are please to offer you with a special price/s for the following items.

A. EQUIPMENT & INSTALLATION

QTY	U/M	MODEL / DESCRIPTION	SRP	DISCOUNTED PRICE		AMOUNT
1	UNIT/S	MODEL: KSM-IW20-WCT10M1M32 KOLIN WALL MOUNTED CERTUS SERIES AIRCONDITIONER 18,990 Kj/h (2.0HP) REGULAR INVERTER R-32	41,995.00	28,756.10	PHP	28,756.10
TOTAL UNIT COST					PHP	28,756.10
ESTIMATED COST OF INSTALLATION (please see attached)					PHP	10,945.00
OTHERS: DELIVERY CHARGE					PHP	600.00
TOTAL ESTIMATED COST OF THE PROJECT					PHP	40,301.10

TERMS OF PAYMENT:

FULL PAYMENT OF UNIT AND DELIVERY CHARGE. IF CHECK, SUBJECT FOR 3 DAYS CLEARING.

WARRANTY:

FOR SPLIT TYPE : ONE (1) YEAR FREE PARTS AND LABOR, THREE YEARS (3) MAIN PCB , TEN (10) YEARS WARRANTY ON COMPRESSOR.

NOTES: PRICES ARE SUBJECT TO CHANGE WITHOUT PRIOR NOTICE.

PRICES IS VAT INCLUSIVE.

**\*\* Cost of Installation is Package with the Unit(s), this cost cannot avail separately.**

We thank you for giving opportunity to offer our product and services, hoping we receive your purchase order.

If you need assistance, don't hesitate to call the under signed at 0917-807-8607 or email at kmi\_asst@kolinphil.com.ph

Very Truly Yours,

  
JANELLEN S. LIM  
KMI-ASSISTANT

Noted by:

  
MART NATHANIEL R. FLORES  
KMI-SUPERVISOR

Approved By:

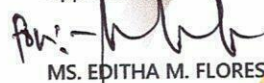
  
MS. EDITHA M. FLORES  
AVP - FINANCE

Conforme:

SIGNATURE OVER PRINTED NAME

KMI-QUOTE-07-24-0669  
ECY-22%/4K

Kolin Marketing, Inc.

1854 Sta. Rita St., Guadalupe Nuevo, Makati City

www.kolinphil.com.ph

Tel.: (632) 8852-6473

Fax: (632) 8852-2170 / (632) 8852-4792

Bringing comfort to your home.



**KOLIN Philippines International Inc.**  
**Survey Form**

**Nº 003502**

Customer Name : CHRISTIAN CHING Date : 7.22.24  
 Address : 1177 SIMON DE JESUS ST. / SUMIT TOWN SJR No. : 219160  
 Establishment Type : Residential ☒ Area Surveyed : Bedroom  
 Commercial ☐ Area Surveyed : \_\_\_\_\_  
 Recommended Product Model : KSM-1W20-WCTOP1m37

**Cooling Capacity Computation**

Floor Area : 24 sqm.  
 Ceiling Height : 2.7 mtr.

note: add 20% per meter in excess of 3 meters in the initial cooling capacity computed.

Floor Area :	<u>24</u>	x	550 Btu/h	<u>13200</u> Btu/h
Ceiling Height (excess of 3 mtrs.) :		x	20%	
Window Direct Sunlight		x	20% - 50%	
Total Cooling Capacity				<u>13200</u> Btu/h

**Add : Additional Heat Load**

No. of Person	<u>4</u>	x	300 Btu/h	<u>1200</u> Btu/h
No. of Ordinary Light (<40w)	<u>6</u>	x	200 Btu/h	<u>1200</u> Btu/h
No. of Special Light (>40w)		x	400 Btu/h	
No. of Refrigerator (< 6 cu.ft.)		x	400 Btu/h	
No. of Refrigerator (> 6 cu.ft.)		x	800 Btu/h	
No. of Cooking Range		x	1500 Btu/h	
No. of Laptop Computer		x	150 Btu/h	
No. of Desktop Computer <u>1</u>		x	400 Btu/h	<u>400</u> Btu/h
No. of Printer		x	500 Btu/h	
No. of Photocopier		x	1000 Btu/h	
Total Cooling Capacity				<u>17800</u> Btu/h

**Recommended Cooling Capacity**

16000 Btu/h

**Note :** Compressor warranty will be **reduced to** \_\_\_\_ yr. if air-conditioner purchased is lower than the recommended cooling capacity or pipe lay-out is beyond the maximum allowable length.

**Scope of Work Agreement**

- |                                   |  |  |
|-----------------------------------|--|--|
| 1. Copper tube lay-out            | <input checked="" type="checkbox"/> Expose                 | <input type="checkbox"/> Embedded                                    |
| 2. Chipping                       | <input type="checkbox"/> Included                          | <input checked="" type="checkbox"/> Not Included                     |
| 3. Fabricated Bracket             | <input type="checkbox"/> Yes <input type="checkbox"/> Shop | <input type="checkbox"/> Site <input checked="" type="checkbox"/> No |
| 4. Service Ledge                  | <input type="checkbox"/> Yes                               | <input checked="" type="checkbox"/> No                               |
| 5. Dismantling of existing Aircon | <input type="checkbox"/> Included                          | <input checked="" type="checkbox"/> Not Included                     |
| 6. Ducting                        | <input type="checkbox"/> Yes                               | <input checked="" type="checkbox"/> No                               |

Dimension : \_\_\_\_\_

7. Plastering, carpentry and restoration works are to be done by the customer.  
 8. Wiring of electrical supply from main panel to air-conditioning unit are to be done by the customer.  
 9. Processing of mechanical plan, working permit, electrical permit are to be done by the customer.  
 10. Other concern; CUSTOMER WILL OPEN THE CONCRETE FOR THE  
ACCESS OF OUTDOOR  
CUSTOMER PROVIDE POWER SUPPLY TO OUTDOOR  
BLUETOOTH.



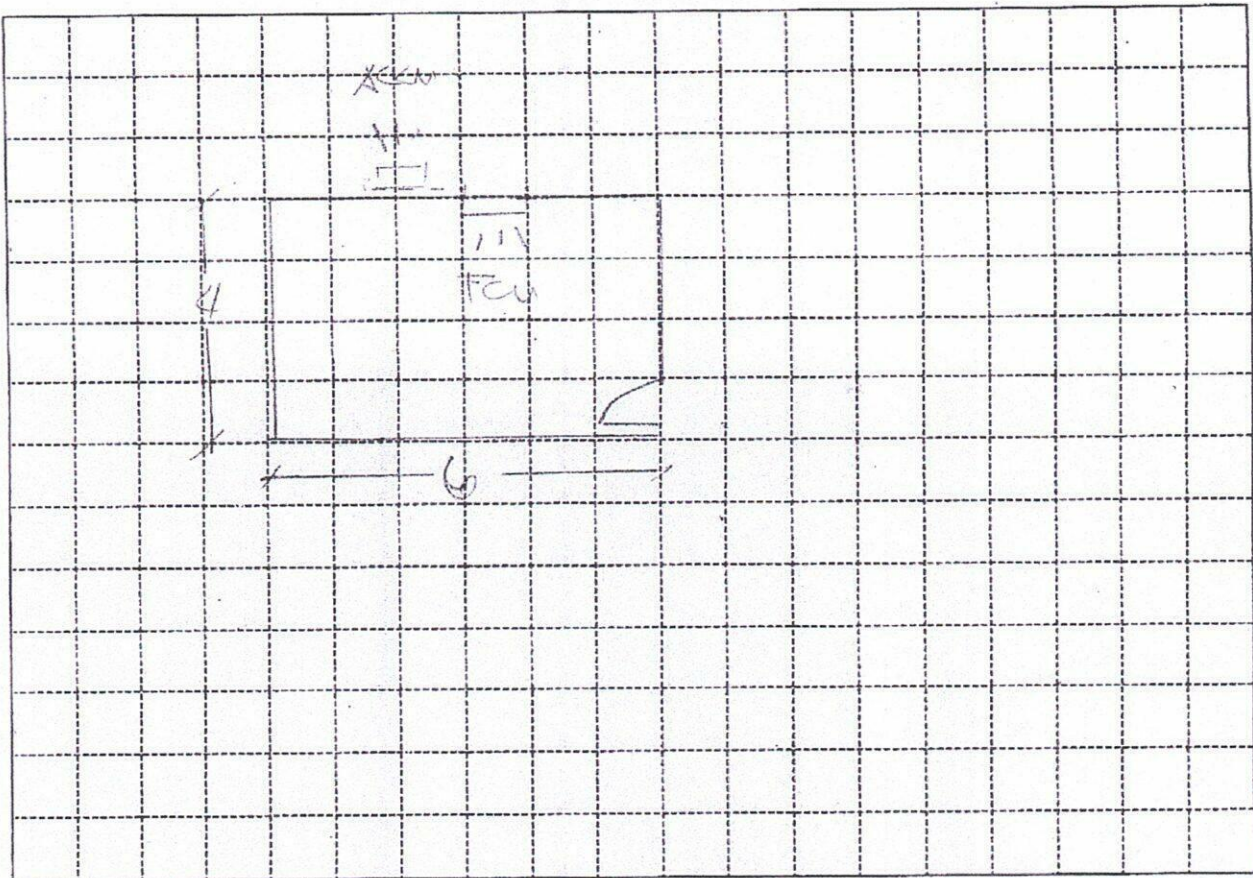

Indoor Unit Location : UP OF WINDOW  
 Outdoor Unit Location : LEFT SIDE OF WINDOW, W  
 Pipe Length : 10 FT  
 Special Note :

Installation Cost Estimate			
Material Description	Qty.	Unit Cost	Total Cost
Copper Tube (excess of 10 ft.) 2330, 2430, 2520, 3520, 4620			
Wire (Royal Cord-signal wire) (excess of 10ft.) 2.0mmx4C	1 FT	700	700
Wire (Royal Cord - Breaker to ODU) 3.5mm / 5.5mm x 3C	1 FT	60	60
Circuit Breaker 20A, 30A, 40A/1ph, 40A/3ph	1	1000	1000
Bracket (ODU) (Imptd. / Fabricated) : (Floor / Wall)			
Bracket (WAC) Angle Type			
PVC Pipe (drain) 1/2", 3/4"	1	150	150
PVC Pipe (electrical) 3/4", 1"			
Drain Pump			
Drain Pump Hose WHITE 7/8"	1 FT	15	15
Chipping Works mtr.			
Dismantling Fee (existing air-conditioner)			8500
Initial Charge			
TOTAL ESTIMATE		P 10,945	

## Note :

1. Initial Charge includes labor, 10ft. Copper tube, 10ft. Royal cord, Circuit breaker, Outdoor Bracket (SAC), Indoor Bracket (PAC) and Consumable materials.
2. Survey fee will be **deducted** in the installation fee.

Prepared by:

JEFFREY D. O. / OS  
 Signature Over Printed Name

Customer Conforms:

Signature Over Printed Name