

kolin

air conditioner

June 24, 2024

LUX ET SAL CORPORATION
DOMUSCHOLA INTERNATIONAL SCHOOL
13 JOSE CRUZ ST., BRGY. UGONG, PASIG CITY
TEL#: 0956-5106372/0922-8313293

Dear Ma'am/Sir,

Kolin Marketing Inc., is extremely honored for your endorsement of Kolin brand and we are please to offer you with a special price/s for the following items.

A. EQUIPMENT & INSTALLATION

**** ROOM 302**

QTY	U/M	MODEL / DESCRIPTION	SRP	DISCOUNTED PRICE		AMOUNT
2	UNIT/S	MODEL: KSG-IWF-25WFY-8K1M32 KOLIN WALL MOUNTED PRIMUS GOLD AIRCONDITIONER 25,560 Kj/h (2.5HP) FULL DC INVERTER W/ WIFI R-32	67,695.00	48,802.10	PHP	97,604.20
TOTAL UNIT COST					PHP	97,604.20
ESTIMATED COST OF INSTALLATION (please see attached)					PHP	63,100.00
OTHERS: DELIVERY CHARGE					PHP	600.00
TOTAL ESTIMATED COST OF THE PROJECT					PHP	161,304.20

TERMS OF PAYMENT:

FULL PAYMENT OF UNIT AND DELIVERY CHARGE. IF CHECK, SUBJECT FOR 3 DAYS CLEARING.

WARRANTY:

FOR SPLIT TYPE : ONE (1) YEAR FREE PARTS AND LABOR, THREE YEARS (3) MAIN PCB , TEN (10) YEARS WARRANTY ON COMPRESSOR.

NOTES: PRICES ARE SUBJECT TO CHANGE WITHOUT PRIOR NOTICE.

PRICES IS VAT INCLUSIVE.

INSTALLATION C/O AUTHORIZED SERVICE CENTER.

**** Cost of Installation is Package with the Unit(s), this cost cannot avail separately.**

**** NO AVAILABLE STOCK FOR KSG-IWF-25WFY-8K1M32.**

We thank you for giving opportunity to offer our product and services, hoping we receive your purchase order.

If you need assistance, don't hesitate to call the under signed at 0917-807-8607 or email at kmi_asst@kolinphil.com.ph

Very Truly Yours,

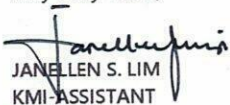
JANELLE S. LIM
KMI-ASSISTANT

Noted by:

MART NATHANIEL R. FLORES
KMI-SUPERVISOR

Approved By:

MS. EDITHA M. FLORES
AVP - FINANCE

Conforme:

SIGNATURE OVER PRINTED NAME

KMI-QUOTE-06-24-0567
REG-22%/4K

Kolin Marketing, Inc.

1854 Sta. Rita St., Guadalupe Nuevo, Makati City

www.kolinphil.com.ph

Tel.: (632) 8852-6473

Fax: (632) 8852-2170 / (632) 8852-4792

Bringing comfort to your home.

JUNE 21, 2024

LUX ET SAL CORPORATION(Domuschola International School)

13 Jose Cruz St., Brgy Ugong, Pasig City

0956-5106372/ 0922-8313293

winfred.libatique@domuschola.edu.ph

MODEL Qty
KSG-IWF-25WFY8K1M32 2

ROOM 302 Area 58 sqm

ACU 1 2.5 HP Wall Mounted Inverter		KSG-IWF-25WFY8K1M32		
Estimated Pipe Length	= 37 ft			
Estimated Royal Cord Length	= 42 ft			
Initial Charge				P 5,500.00
Includes:				
Labor				
10ft Copper Tube				
10ft Royal Cord				
Outdoor Bracket (Wall)				
Consumables				
Installation Materials	Description	Qty	Price per qty	Subtotal
Copper Tube	Ø 1/4" x Ø 5/8"	27 ft	P 400.00/ft	P 10,800.00
Royal Cord (comm. wire)	2.mm2 x 4C	32 ft	P 100.00/ft	P 3,200.00
Royal Cord (ACCU-Breaker)	3.5mm x 3c	5 ft	P 60.00/ft	P 300.00
Rubber Insulation	2 1/8" x 3/4" x 6'	6 pc/s	P 350.00/pc	P 2,100.00
Circuit Breaker waterproof	30A / 1Ph	1 pc/s	P 1,000.00/pc	P 1,000.00
Dismantle	2.5HP Wall Mounted	1 set	P 2,500.00/set	P 2,500.00
Leaktest		1 set	P 1,800.00/set	P 1,800.00
				P 21,700.00

Estimated Charges **P 27,200.00**

ACU 2 2.5 HP Wall Mounted Inverter		KSG-IWF-25WFY8K1M32		
Estimated Pipe Length	= 50 ft			
Estimated Royal Cord Length	= 55 ft			
Initial Charge				P 5,500.00
Includes:				
Labor				
10ft Copper Tube				
10ft Royal Cord				
Outdoor Bracket (Wall)				
Consumables				
Installation Materials	Description	Qty	Price per qty	Subtotal
Copper Tube	Ø 1/4" x Ø 5/8"	40 ft	P 400.00/ft	P 16,000.00
Royal Cord (comm. wire)	2.mm2 x 4C	45 ft	P 100.00/ft	P 4,500.00
Royal Cord (ACCU-Breaker)	3.5mm x 3c	5 ft	P 60.00/ft	P 300.00
Rubber Insulation	2 1/8" x 3/4" x 6'	8 pc/s	P 350.00/pc	P 2,800.00
Circuit Breaker waterproof	30A / 1Ph	1 pc/s	P 1,000.00/pc	P 1,000.00
Dismantle	2.5HP Wall Mounted	1 set	P 2,500.00/set	P 2,500.00
Leaktest		1 set	P 1,800.00/set	P 1,800.00
Scaffoldings	4sets	1 set	P 1,500.00/set	P 1,500.00
				P 30,400.00

Estimated Charges **P 35,900.00**

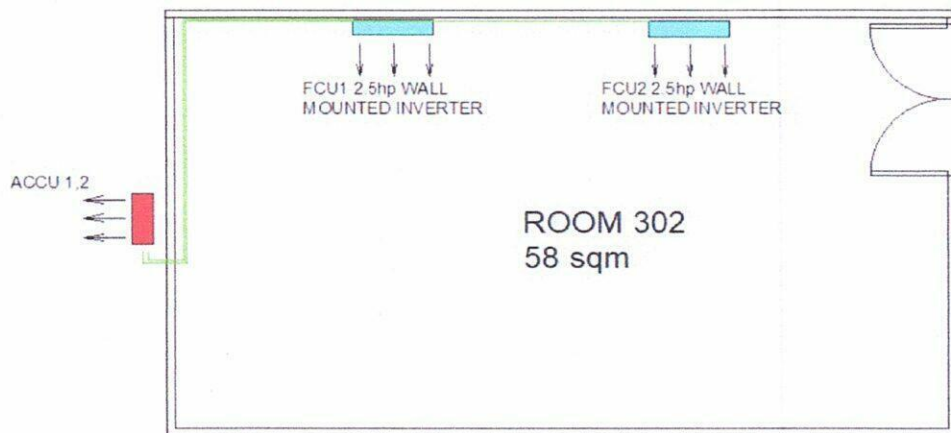

Total Estimated Charges

P 63,100.00

Validity: This quotation is valid for a period of fifteen (15) days from the date thereof, subject to our confirmation thereafter.

Installation notes:

- 1 Location of indoor and outdoor units were agreed by the customer and Kolin's surveyor.
- 2 Mechanical Plans, Permits, Electrical permits not included.
- 3 Bring harness and rope on the date of installation, for double check if copper tube is still serviceable for the new units.
- 4 Upon approval of installation, dismantle units and leaktesting of existing copper tube using nitrogen pressure, if pressure drop requires to lay out new copper tube.
- 5 **Need 4 pax. And Scaffoldings.target date JULY 12, 2024.**
- 6 Deflectors, masonry, carpentry, chipping & plastering (finishing & restoration) are not included in the installation.
- 7 Air conditioning drain line and Electrical power supply (feeder line) **220v/ 60hz/ 1ph** , should be provided by customer's contractor.
- 8 **Final charges will be based on actual installation.**

Prepared by:

Jeffrey Dadios
Field Surveyor

Customer Conformance:

Signature Over Printed Name

Reviewed by:

Engr. Kenneth Zamora
Service Supervisor Shop and
Field Operation