



November 13, 2024

MR. JONATHAN GO
540 WACK WACK RD., WACK WACK VILLAGE, BRGY. WACK-WACK MANDALUYONG CITY
TEL#: 0947-8936851

Dear Ma'am/Sir,

Kolin Marketing Inc., is extremely honored for your endorsement of Kolin brand and we are please to offer you with a special price/s for the following items.

A. EQUIPMENT & INSTALLATION

**** FOR BEDROOM 2**

QTY	U/M	MODEL / DESCRIPTION	SRP	DISCOUNTED PRICE		AMOUNT
1	UNIT/S	MODEL: KSM-IW25-WCT10M1M32 KOLIN WALL MOUNTED CERTUS AIRCONDITIONER 23,210 Kj/h (2.5HP) REGULAR INVERTER W/ WIFI R-32	49,995.00	34,996.10	PHP	34,996.10
TOTAL UNIT COST					PHP	34,996.10
ESTIMATED COST OF INSTALLATION <i>w/ old unit for Elena Room (please see attached) *</i>					PHP	32,990.00
TOTAL ESTIMATED COST OF THE PROJECT					PHP	67,986.10

TERMS OF PAYMENT:

FULL PAYMENT OF UNIT AND DELIVERY CHARGE. IF CHECK, SUBJECT FOR 3 DAYS CLEARING.

WARRANTY:

FOR SPLIT TYPE : ONE (1) YEAR FREE PARTS AND LABOR, THREE YEARS (3) MAIN PCB , TEN (10) YEARS WARRANTY ON COMPRESSOR.

NOTES: PRICES ARE SUBJECT TO CHANGE WITHOUT PRIOR NOTICE.

PRICES IS VAT INCLUSIVE.

We thank you for giving opportunity to offer our product and services, hoping we receive your purchase order.

If you need assistance, don't hesitate to call the under signed at 0917-807-8607 or email at kmi_asst@kolinphil.com.ph

Very Truly Yours,

JANELLEN S. LIM
KMI-ASSISTANT

Noted by:

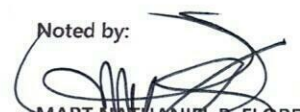
MART NATHANIEL R. FLORES
KMI-SUPERVISOR

Approved By:

MS. EDITHA M. FLORES
AVP - FINANCE

KMI-QUOTE-11-24-0957
REG-22%/4K

Conforme:

SIGNATURE OVER PRINTED NAME

Kolin Marketing, Inc.
1854 Sta. Rita St., Guadalupe Nuevo, Makati City
Tel.: (632) 8852-6473
Fax: (632) 8852-2170 / (632) 8852-4792
www.kolinphil.com.ph / kolinphilippines



KOLIN Philippines International Inc.
Survey Form

No 003550

Customer Name : JONATHAN GO Date : 11-6-2011
 Address : 410 WAGE WAGE - RUSTEN WAGE WAGE VILLAGE SJR No. : 126460
 Establishment Type : Residential ☒ Area Surveyed : BED ROOM 2
 Commercial ☐ Area Surveyed : _____
 Recommended Product Model : 1.5M 18X-WCTOM1103

Cooling Capacity Computation

Floor Area : 32 sqm.
 Ceiling Height : 2.6 mtr.

note: add 20% per meter in excess of 3 meters in the initial cooling capacity computed.

Floor Area :	<u>32</u>	x	550 Btu/h	<u>17,600</u> Btu/h
Ceiling Height (excess of 3 mtrs.) :		x	20%	
Window Direct Sunlight		x	20% - 50%	<u>3520</u> Btu/h
Total Cooling Capacity				<u>21,120</u> Btu/h

Add : Additional Heat Load

No. of Person	<u>2</u>	x	300 Btu/h	<u>600</u> Btu/h
No. of Ordinary Light (<40w)	<u>4</u>	x	200 Btu/h	<u>800</u> Btu/h
No. of Special Light (>40w)		x	400 Btu/h	
No. of Refrigerator (< 6 cu.ft.)		x	400 Btu/h	
No. of Refrigerator (> 6 cu.ft.)		x	800 Btu/h	
No. of Cooking Range		x	1500 Btu/h	
No. of Laptop Computer		x	150 Btu/h	
No. of Desktop Computer		x	400 Btu/h	
No. of Printer		x	500 Btu/h	
No. of Photocopier		x	1000 Btu/h	
Total Cooling Capacity				<u>1900</u> Btu/h

Recommended Cooling Capacity

2.5
21,120 Btu/h

Note : Compressor warranty will be reduced to ____ yr. if air-conditioner purchased is lower than the recommended cooling capacity or pipe lay-out is beyond the maximum allowable length.

Scope of Work Agreement

- | | | |
|-----------------------------------|--|--|
| 1. Copper tube lay-out | <input type="checkbox"/> Expose | <input type="checkbox"/> Embedded |
| 2. Chipping | <input type="checkbox"/> Included | <input checked="" type="checkbox"/> Not Included |
| 3. Fabricated Bracket | <input type="checkbox"/> Yes <input type="checkbox"/> Shop | <input type="checkbox"/> Site <input checked="" type="checkbox"/> No |
| 4. Service Ledge | <input type="checkbox"/> Yes | <input checked="" type="checkbox"/> No |
| 5. Dismantling of existing Aircon | <input type="checkbox"/> Included | <input type="checkbox"/> Not Included |
| 6. Ducting | <input type="checkbox"/> Yes | <input type="checkbox"/> No |

Dimension :

- Plastering, carpentry and restoration works are to be done by the customer.
- Wiring of electrical supply from main panel to air-conditioning unit are to be done by the customer.
- Processing of mechanical plan, working permit, electrical permit are to be done by the customer.
- Other concern;

CUSTOMER WILL PROVIDE TOWER SUPPLY AT THE
UNIT'S BELONGING - EXPOSE COIL/PIPE IN THE
SPACE ABOVE ROOF AIR DUCTS.

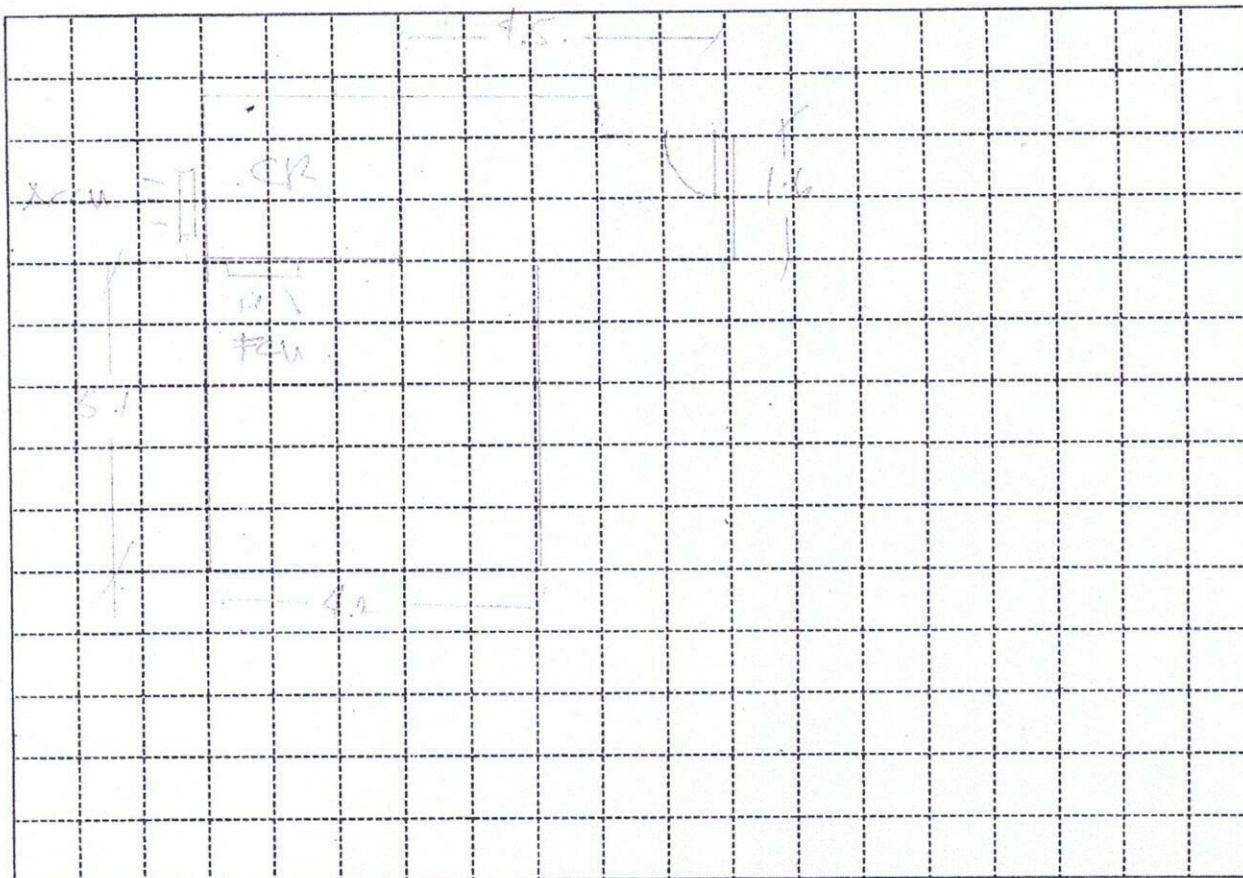

Indoor Unit Location : LEFT OF XAC, WALL OF CR

Outdoor Unit Location : AT THE WALL OF CR.

Pipe Length : 10 FT

Special Note : _____

Installation Cost Estimate

Material Description	Qty.	Unit Cost	Total Cost
Copper Tube (excess of 10 ft.) 2330, 2430, 2520, 3520, 4620			
Wire (Royal Cord-signal wire) (excess of 10ft.) 2.0mmx4C	7FT	100	700
Wire (Royal Cord - Breaker to ODU) 3.5mm / 5.5mm x 3C	10FT	80	800
Circuit Breaker 20A, 30A, 40A/1ph, 40A/3ph	1	700	700
Bracket (ODU) (Imptd. / Fabricated) ; (Floor / Wall)			
Bracket (WAC) Angle Type			
PVC Pipe (drain) 1/2" , 3/4"	30m	150	450
PVC Pipe (electrical) 3/4" , 1"			
Drain Pump			
Drain Pump Hose	7FT	20	140
Chipping Works mtr.			
Dismantling Fee (existing air-conditioner)			
Initial Charge			8500
TOTAL ESTIMATE		P 11,240	

Note :

1. Initial Charge includes labor, 10ft. Copper tube, 10ft. Royal cord, Circuit breaker, Outdoor Bracket (SAC), Indoor Bracket (PAC) and Consumable materials.
2. Survey fee will be **deducted** in the installation fee.

Prepared by:

Customer Conforms:

Signature Over Printed Name

Signature Over Printed Name

KOLIN Philippines International Inc.
Survey Form

No 003549

Customer Name : JOHN L. HERNANDEZ Date : 11-06-24
 Address : 570 N. 1st St. 2nd Fl. Bldg. 2nd Fl. Bldg. 2nd Fl. Bldg. SJR No. : 22846
 Establishment Type : Residential ☒ Area Surveyed : FLUX ROOM
 Commercial ☐ Area Surveyed : _____
 Recommended Product Model : KSR 24MB/10V (OLD UNIT)

Cooling Capacity Computation

Floor Area : 27.3 sqm.
 Ceiling Height : 2.7 mtr.

note: add 20% per meter in excess of 3 meters in the initial cooling capacity computed.

Floor Area :	<u>27.3</u>	x	550 Btu/h	<u>14,995</u> Btu/h
Ceiling Height (excess of 3 mtrs.) :		x	20%	
Window Direct Sunlight		x	20% - 50%	<u>2,000</u> Btu/h
Total Cooling Capacity				<u>16,995</u> Btu/h

Add : Additional Heat Load

No. of Person	<u>2</u>	x	300 Btu/h	<u>600</u> Btu/h
No. of Ordinary Light (<40w)	<u>6</u>	x	200 Btu/h	<u>1,200</u> Btu/h
No. of Special Light (>40w)		x	400 Btu/h	
No. of Refrigerator (< 6 cu.ft.)		x	400 Btu/h	
No. of Refrigerator (> 6 cu.ft.)		x	800 Btu/h	
No. of Cooking Range		x	1500 Btu/h	
No. of Laptop Computer		x	150 Btu/h	
No. of Desktop Computer		x	400 Btu/h	
No. of Printer		x	500 Btu/h	
No. of Photocopier		x	1000 Btu/h	
Total Cooling Capacity				<u>18,800</u> Btu/h

Recommended Cooling Capacity

18,800 Btu/h

Note : Compressor warranty will be reduced to ____ yr. if air-conditioner purchased is lower than the recommended cooling capacity or pipe lay-out is beyond the maximum allowable length.

Scope of Work Agreement

- | | | |
|-----------------------------------|--|---|
| 1. Copper tube lay-out | <input checked="" type="checkbox"/> Expose | <input type="checkbox"/> Embedded |
| 2. Chipping | <input type="checkbox"/> Included | <input checked="" type="checkbox"/> Not Included |
| 3. Fabricated Bracket | <input type="checkbox"/> Yes <input type="checkbox"/> Shop | <input type="checkbox"/> Site <input type="checkbox"/> No |
| 4. Service Ledge | <input type="checkbox"/> Yes | <input checked="" type="checkbox"/> No |
| 5. Dismantling of existing Aircon | <input type="checkbox"/> Included | <input type="checkbox"/> Not Included |
| 6. Ducting | <input type="checkbox"/> Yes | <input type="checkbox"/> No |

Dimension :

- Plastering, carpentry and restoration works are to be done by the customer.
- Wiring of electrical supply from main panel to air-conditioning unit are to be done by the customer.
- Processing of mechanical plan, working permit, electrical permit are to be done by the customer.
- Other concern;

CUSTOMER (WILL) NEED TO OPEN THE WALL FOR THE (24-24) OF COPPER TUBE (XIN) IN THE CUSTOMER NEEDS TO PROVIDE TOWER UNIT AT THE OUTSIDE TOWER UNIT.

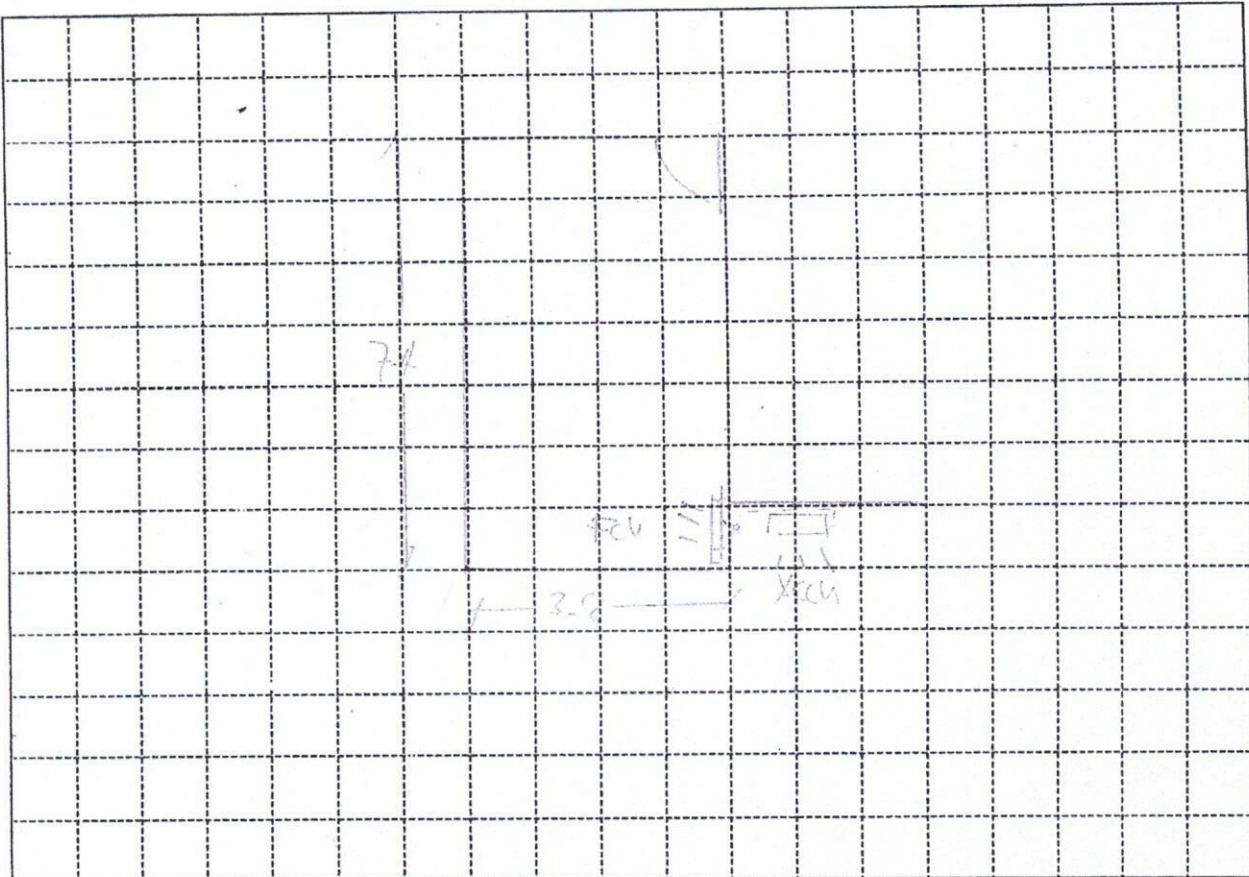

Indoor Unit Location : RIGHT CORNER OF XBOX
 Outdoor Unit Location : AT THE BACK, LEVEL OF EXISTING
 Pipe Length : 8 METERS
 Special Note :

Installation Cost Estimate			
Material Description	Qty.	Unit Cost	Total Cost
Copper Tube (excess of 10 ft.) 2330, 2430, 2520, 3520, 4620	17 FT	400	10,800
Wire (Royal Cord-signal wire) (excess of 10ft.) 2.0mmx4C	34 FT	100	3,400
Wire (Royal Cord - Breaker to ODU) 3.5mm / 5.5mm x 3C	7 FT	60	420
Circuit Breaker 20A, 30A, 40A/1ph, 40A/3ph	1	1000	1,000
Bracket (ODU) (Imptd. / Fabricated) ; (Floor / Wall)	1	1650	1,650
Bracket (WAC) Angle Type			
PVC Pipe (drain) 1/2", 3/4"	2 PCC	150	300
PVC Pipe (electrical) 3/4", 1"			
Drain Pump			
Drain Pump Hose 1/2"	1 FT	12	12
Chipping Works mtr.			
Dismantling Fee (existing air-conditioner)			
Initial Charge			5000
TOTAL ESTIMATE		P 21,745 -	

Note :

- Initial Charge includes labor, 10ft. Copper tube, 10ft. Royal cord, Circuit breaker, Outdoor Bracket (SAC), Indoor Bracket (PAC) and Consumable materials.
- Survey fee will be **deducted** in the installation fee.

Prepared by:

Signature Over Printed Name

Customer Conforms:

Signature Over Printed Name