



November 19, 2024

STATE CENTER
UNIT 1414, 333 JUAN LUNA ST., BINONDO MANILA
TEL#: 0908-9526124

Dear Ma'am/Sir,

Kolin Marketing Inc., is extremely honored for your endorsement of Kolin brand and we are please to offer you with a special price/s for the following items.

A. EQUIPMENT & INSTALLATION

| QTY | U/M | MODEL / DESCRIPTION | SRP | DISCOUNTED PRICE | | AMOUNT |
|--|--------|--|------------|------------------|-----|------------|
| 2 | UNIT/S | MODEL: KLG-IF40-5G1M32 KOLIN FLOOR MOUNTED AIRCONDITIONER 37,980 Kj/h (3.0TR) FULL DC INVERTER R-32 SINGLE PHASE | 113,195.00 | 81,292.10 | PHP | 162,584.20 |
| TOTAL UNIT COST | | | | | PHP | 162,584.20 |
| ESTIMATED COST OF INSTALLATION (please see attached) | | | | | PHP | 37,030.00 |
| OTHERS: DELIVERY CHARGE | | | | | PHP | 600.00 |
| TOTAL UNIT COST | | | | | PHP | 200,214.20 |

TERMS OF PAYMENT:

FULL PAYMENT OF UNIT AND DELIVERY CHARGE. IF CHECK, SUBJECT FOR 3 DAYS CLEARING.

WARRANTY:

FOR FLOOR MOUNTED: ONE (1) YEAR FREE PARTS AND LABOR, FIVE (5) YEARS WARRANTY ON COMPRESSOR.

NOTES: PRICES ARE SUBJECT TO CHANGE WITHOUT PRIOR NOTICE.

PRICES IS VAT INCLUSIVE.

**** Cost of Installation is Package with the Unit(s), this cost cannot avail separately (cost will be based on actual).**

We thank you for giving opportunity to offer our product and services, hoping we receive your purchase order.

If you need assistance, don't hesitate to call the under signed at 0917-807-8607 or email at kmi_asst@kolinphil.com.ph

Very Truly Yours,

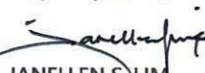
JANELLE S. LIM
KMI-ASSISTANT

Noted by:

MART NATHANIEL R. FLORES
KMI-SUPERVISOR

Approved By:

 11/19/24
MS. EDITHA M. FLORES
AVP - FINANCE

KMI-QUOTE-11-24-0964-rev
ECY-22%/7K

Conforme:

SIGNATURE OVER PRINTED NAME

Kolin Marketing, Inc.

1854 Sta. Rita St., Guadalupe Nuevo, Makati City

Tel.: (632) 8852-6473

Fax: (632) 8852-2170 / (632) 8852-4792

 www.kolinphil.com.ph / kolinphilippines



STATE CENTER

State Center Bldg. Unit 1414, 333 Juan Luna St. Binondo, Manila

0908-9526124

| Model | Qty |
|-----------------|-----|
| KLG-IF40-5G1M32 | 2 |

OPTION 2

UNIT 1414

| | |
|-----------|------------------------|
| OPEN AREA | Area \approx 44 sq.m |
|-----------|------------------------|

ACU 2 4.0hp Wallmounted Inverter *KLG-IF40-5G1M32*

Estimated Pipe Length : 17 ft

Estimated Royal Cord Length : 24 ft

| | | |
|----------------|---|-----------|
| Initial Charge | P | 11,000.00 |
|----------------|---|-----------|

Includes:

Labor

10ft Copper Tube

10ft Royal Cord

Indoor Bracket

Other Consumables

| Additional Charges | Description | Unit | | Price Per Unit | | Subtotal | |
|--------------------------|-------------|---------|---|----------------|---|----------|------------|
| Copper Tube | 3/8"x 5/8" | 7 ft | P | 400.00 / ft | P | 2,800.00 | |
| Royal Cord | 2.mm2 x 4C | 14 ft | P | 100.00 / ft | P | 1,400.00 | |
| Royal Cord (ODU-Breaker) | 5.0mm2 x 3C | 7 ft | P | 70.00 / ft | P | 490.00 | |
| Circuit Breaker(NEMA) | 40A/ 1Ph | 1 pc(s) | P | 1,000.00 / pc | P | 1,000.00 | |
| Outdoor Bracket(Wall) | Galvanised | 1 pc(s) | P | 1,650.00 / pc | P | 1,650.00 | |
| Drain Hose | White -1/2" | 7 ft | P | 25.00 / ft | P | 175.00 | P 7,515.00 |

| | |
|-------------------|-------------|
| Estimated Charges | P 18,515.00 |
|-------------------|-------------|

| | |
|---------------|--------------------------|
| ROOM1 & ROOM2 | Area \approx 36.4 sq.m |
|---------------|--------------------------|

ACU 2 4.0hp Wallmounted Inverter KLG-IF40-5G1M32

Estimated Pipe Length : 17 ft

Estimated Royal Cord Length : 24 ft

| | | |
|----------------|---|-----------|
| Initial Charge | P | 11,000.00 |
|----------------|---|-----------|

Includes:

Labor

10ft Copper Tube

10ft Royal Cord

Indoor Bracket

Other Consumables

| Additional Charges | Description | Unit | | Price Per Unit | | Subtotal | |
|--------------------------|-------------|---------|---|----------------|---|----------|------------|
| Copper Tube | 3/8"x 5/8" | 7 ft | P | 400.00 / ft | P | 2,800.00 | |
| Royal Cord | 2.mm2 x 4C | 14 ft | P | 100.00 / ft | P | 1,400.00 | |
| Royal Cord (ODU-Breaker) | 5.0mm2 x 3C | 7 ft | P | 70.00 / ft | P | 490.00 | |
| Circuit Breaker(NEMA) | 40A/ 1Ph | 1 pc(s) | P | 1,000.00 / pc | P | 1,000.00 | |
| Outdoor Bracket(Wall) | Galvanised | 1 pc(s) | P | 1,650.00 / pc | P | 1,650.00 | |
| Drain Hose | White -1/2" | 7 ft | P | 25.00 / ft | P | 175.00 | P 7,515.00 |

| | |
|-------------------|-------------|
| Estimated Charges | P 18,515.00 |
|-------------------|-------------|

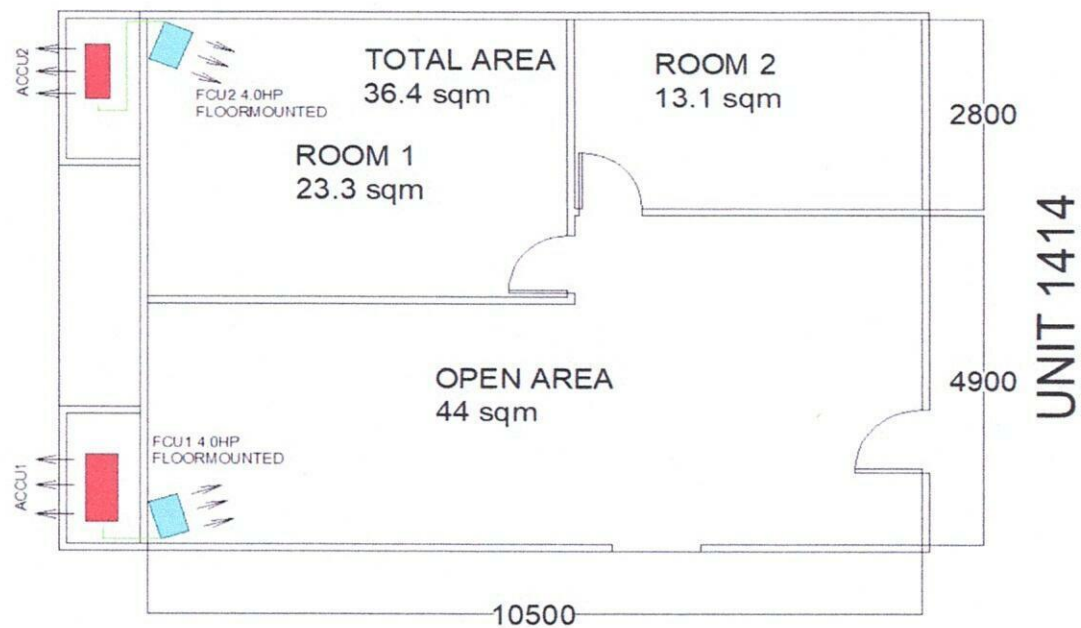

Total Estimated Charges

P 37,030.00

Validity: This quotation is valid for a period of fifteen (15) days from the date thereof, subject to our confirmation thereafter.

Note:

- 1 Location of indoor and outdoor units were agreed by the customer and Kolin's surveyor.
- 2 AC drain line will be tapped to the nearest drain provision provided by the customer's contractor.
- 3 Need for site visit before installation.
- 4 Customer put a exhaust fan inlet and outlet to room2.**
- 5 Working days: Monday to Saturday, 8am- 5pm without parking.
- 6 Mechanical Plans, Permits, Electrical permits not included.
- 7 Deflectors, masonry, carpentry, chipping & plastering (finishing & restoration) are not included in the installation.
- 8 Electrical power supply (feeder line) **220v/ 60hz/ 1ph** , is not included in the scope of work of Kolin.
- 9 Final charges will be based on actual installation.**

Prepared by:

Jeoffrey Dadios
Field Surveyor

Customer Conformance:

Signature Over Printed Name

Reviewed by:

Engr. Kenneth Zamora
Service Supervisor
Field and Shop Operation