



October 15, 2024

ATTY. MAMSIE QUIMOSING
COMMERCIAL PROPERTY BUILDER
UNIT 117, TOWER 3, VIREO CONDOMINIUM TOWERS, ARCA SOUTH, WESTERN BICUTAN TAGUIG CITY
TEL#: 0917-5221199

Dear Ma'am/Sir,

Kolin Marketing Inc., is extremely honored for your endorsement of Kolin brand and we are please to offer you with a special price/s for the following items.

A. EQUIPMENT & INSTALLATION

QTY	U/M	MODEL / DESCRIPTION	SRP	DISCOUNTED PRICE		AMOUNT
1	UNIT/S	MODEL: KSG-IWF-20WFF-8K1M32 KOLIN WALL MOUNTED PRIMUS GOLD AIRCONDITIONER 19,000 Kj/h (2.0HP) FULL DC INVERTER W/ WIFI R-32	59,595.00	42,484.10	PHP	42,484.10
1	UNIT/S	MODEL: KSG-IWF-10WFF-8K1M32 KOLIN WALL MOUNTED PRIMUS GOLD AIRCONDITIONER 11,484 Kj/h (1.0HP) FULL DC INVERTER W/ WIFI R-32	42,595.00	29,224.10	PHP	29,224.10
TOTAL UNIT COST					PHP	71,708.20
ESTIMATED COST OF INSTALLATION w/ installation of old unit (please see attached)					PHP	36,400.00
OTHERS: DELIVERY CHARGE					PHP	600.00
TOTAL ESTIMATED COST OF THE PROJECT					PHP	108,708.20

TERMS OF PAYMENT:

FULL PAYMENT OF UNIT AND DELIVERY CHARGE. IF CHECK, SUBJECT FOR 3 DAYS CLEARING.

WARRANTY:

FOR SPLIT TYPE : ONE (1) YEAR FREE PARTS AND LABOR, THREE YEARS (3) MAIN PCB , TEN (10) YEARS WARRANTY ON COMPRESSOR.

NOTES: PRICES ARE SUBJECT TO CHANGE WITHOUT PRIOR NOTICE.

PRICES IS VAT INCLUSIVE.

**** Cost of Installation is Package with the Unit(s), this cost cannot avail separately.**

**** INSTALLATION C/O ASP (cost will be based on actual)**

We thank you for giving opportunity to offer our product and services, hoping we receive your purchase order.

If you need assistance, don't hesitate to call the under signed at 0917-807-8607 or email at kmi_asst@kolinphil.com.ph

Very Truly Yours,

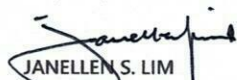
JANELLE S. LIM
KMI-ASSISTANT

Noted by:

MART NATHANIEL R. FLORES
KMI-SUPERVISOR

Approved By:

MS. EDITHA M. FLORES
AVP - FINANCE

KMI-QUOTE-10-24-0865
REG-22%/4K/1.3K

Conforme:

SIGNATURE OVER PRINTED NAME

Kolin Marketing, Inc.

1854 Sta. Rita St., Guadalupe Nuevo, Makati City

Tel.: (632) 8852-6473

Fax: (632) 8852-2170 / (632) 8852-4792

 www.kolinphil.com.ph / kolinphilippines.com



OCTOBER 12, 2024

ATTY MAMSIE QULMOSING/ Commercial Property Builders

Unit 117 , Tower 3, Vireo Condominium Towers, Arca South, Western Bicutan Taguig City

0917-5221199

MODEL	Qty
KSG-IWF-20Wfy8K1M32	1
KSG-IWF-10Wfy8K1M32	1

REV1

LIVING/DINNG/KITCHEN	Area	21 sqm
----------------------	------	--------

ACU 1	2.0 HP Wall Mounted Inverter	KSG-IWF-20Wfy8K1M32
	Estimated Pipe Length = 27 ft	
	Estimated Royal Cord Length = 32 ft	
	Initial Charge	₱ 3,700.00
	Includes:	Less outdoor bracket inclusion
	Labor	
	10ft Copper Tube	
	10ft Royal Cord	
	Consumables	
Installation Materials	Description	Qty Price per qty Subtotal
Copper Tube	Ø 1/4" x Ø 1/2"	17 ft ₱ 350.00/ft ₱ 5,950.00
Royal Cord (comm. wire)	2.mm2 x 4C	22 ft ₱ 100.00/ft ₱ 2,200.00
Royal Cord (ACCU-Breaker)	3.5mm x 3c	5 ft ₱ 60.00/ft ₱ 300.00
Circuit Breaker waterproof	30A / 1Ph	1 pc/s ₱ 1,000.00/pc ₱ 1,000.00
Outdoor bracket	Fabricated floor	1 pc/s ₱ 2,500.00/pc ₱ 2,500.00
PVC blue	3/4" x 10'	2 pc/s ₱ 150.00/pc ₱ 300.00
		₱ 12,250.00

Estimated Charges	₱ 15,950.00
--------------------------	--------------------

BEDROOM	Area	11 sqm
---------	------	--------

ACU 2	1.0 HP Wall Mounted Inverter	KSG-IWF-10Wfy8K1M32
	Estimated Pipe Length = 37 ft	
	Estimated Royal Cord Length = 42 ft	
	Initial Charge	₱ 3,700.00
	Includes:	Less outdoor bracket inclusion
	Labor	
	10ft Copper Tube	
	10ft Royal Cord	
	Consumables	
Installation Materials	Description	Qty Price per qty Subtotal
Copper Tube	Ø 1/4" x Ø 3/8"	27 ft ₱ 350.00/ft ₱ 9,450.00
Royal Cord (comm. wire)	2.mm2 x 4C	32 ft ₱ 100.00/ft ₱ 3,200.00
Royal Cord (ACCU-Breaker)	3.5mm x 3c	5 ft ₱ 60.00/ft ₱ 300.00
Circuit Breaker waterproof	30A / 1Ph	1 pc/s ₱ 1,000.00/pc ₱ 1,000.00
Outdoor bracket	Fabricated floor	1 pc/s ₱ 2,500.00/pc ₱ 2,500.00
PVC blue	3/4" x 10'	2 pc/s ₱ 150.00/pc ₱ 300.00
		₱ 16,750.00

Estimated Charges	₱ 20,450.00
--------------------------	--------------------

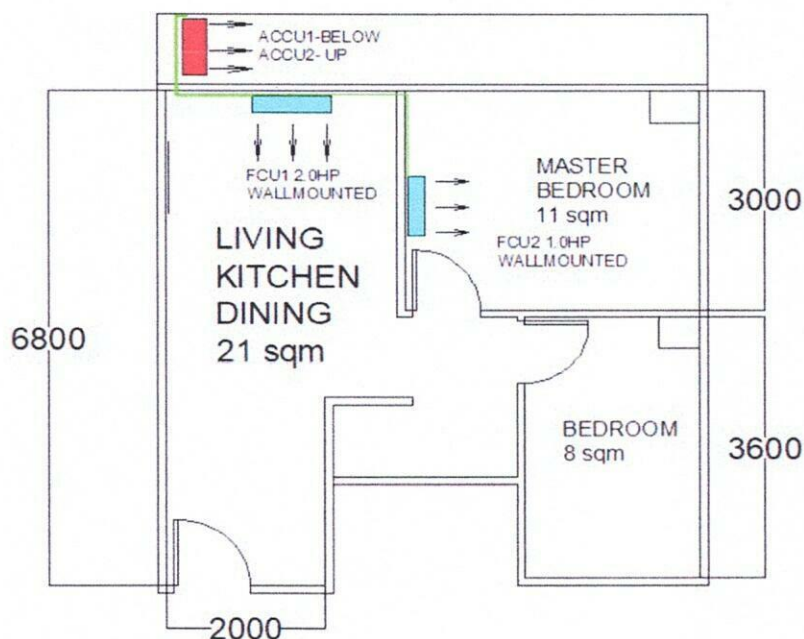

Total Estimated Charges

P 36,400.00

Validity: This quotation is valid for a period of fifteen (15) days from the date thereof, subject to our confirmation thereafter.

Installation notes:

- 1 Location of indoor and outdoor units recommendation only not yet final.
- 2 AC drain line will be tapped to the nearest drain provision provided by the customer's contractor.
- 4 Schedule for markings first for pipe layout and drain provisions. Copper tube and drainline expose in the area.
- 5 Working days: Monday to Saturday, 8am- 5pm. Without parking, need working permit.
- 6 Mechanical Plans, Permits, Electrical permits not included.
- 7 Deflectors, masonry, carpentry, chipping & plastering (finishing & restoration) are not included in the installation.
- 8 Electrical power supply (feeder line) is not included in the scope of work of Kolin.
- 9 **Final charges will be based on actual installation.**

Prepared by:

Jeffrey Dadios
Field Surveyor

Customer Conformer:

Signature Over Printed Name

Reviewed by:

Engr. Kenneth Zamora
Service Supervisor Shop and
Field Operation