



October 28, 2024

MR. MARC MANALASTAS
UNIT ARN-12Q, THE ARTON BY ROCKWELL NORTH TOWER, AURORA BLVD, BRGY. LOYOLA HEIGHTS QUEZON CITY
TEL#: 0917-5186272

Dear Ma'am/Sir,

Kolin Marketing Inc., is extremely honored for your endorsement of Kolin brand and we are please to offer you with a special price/s for the following items.

A. EQUIPMENT & INSTALLATION

QTY	U/M	MODEL / DESCRIPTION	SRP	DISCOUNTED PRICE		AMOUNT
1	UNIT/S	MODEL: KFS-20DAG1M-O KOLIN FLEXMATCH SERIES III AIRCONDITIONER 18,991 Kj/h (2.0HP) INVERTER OUTDOOR UNIT R-410A	55,195.00	43,052.10	PHP	43,052.10
2	UNIT/S	MODEL: KFS-10BAG1M-I KOLIN FLEXMATCH SERIES III AIRCONDITIONER 9,496 Kj/h (1.0HP) INVERTER INDOOR UNIT R-410A	12,295.00	9,590.10	PHP	19,180.20
1	UNIT/S	MODEL: KSG-IWF-25WFF-8K1M32 KOLIN WALL MOUNTED PRIMUS GOLD AIRCONDITIONER 25,560 Kj/h (2.5HP) FULL DC INVERTER W/ WIFI R-32	68,995.00	46,816.10	PHP	46,816.10
TOTAL UNIT COST					PHP	109,048.40
ESTIMATED COST OF INSTALLATION w/ dismantling of existing unit (please see attached)					PHP	36,915.00
OTHERS: DELIVERY CHARGE					PHP	600.00
TOTAL ESTIMATED COST OF THE PROJECT					PHP	146,563.40

TERMS OF PAYMENT:

FULL PAYMENT OF UNIT AND DELIVERY CHARGE. IF CHECK, SUBJECT FOR 3 DAYS CLEARING.

WARRANTY:

FOR FLEXMATCH: ONE (1) YEAR FREE PARTS AND LABOR, FIVE (5) YEARS WARRANTY ON COMPRESSOR.

FOR SPLIT TYPE : ONE (1) YEAR FREE PARTS AND LABOR, THREE YEARS (3) MAIN PCB , TEN (10) YEARS WARRANTY ON COMPRESSOR.

NOTES: PRICES ARE SUBJECT TO CHANGE WITHOUT PRIOR NOTICE.

PRICES IS VAT INCLUSIVE.

**** Cost of Installation is Package with the Unit(s), this cost cannot avail separately.**

**** INSTALLATION C/O ASP (cost will be based on actual)**

We thank you for giving opportunity to offer our product and services, hoping we receive your purchase order.

If you need assistance, don't hesitate to call the under signed at 0917-807-8607 or email at kmi_asst@kolinphil.com.ph

**** CURRENTLY NO AVAILABLE STOCK FOR KFS-20DAG1M- O. WE'RE STILL WAITING FOR NOTICE OF POSSIBLE RESTOCK.**

Very Truly Yours,

JANELLEN S. LIM
KMI-ASSISTANT

Noted by:
MART NATHANIEL R. FLORES
KMI-SUPERVISOR

Approved By:
MS. EDITHA M. FLORES
AVP - FINANCE

KMI-QUOTE-10-24-0924
REG-22%/7K

Conforme: _____
SIGNATURE OVER PRINTED NAME



OCTOBER 26, 2024
MARC MANALASTAS

Unit ARN-12Q The Arton by Rockwell North Tower, Aurora Blvd, Brgy Loyola Hgts Quezon City

0917-5186272

MODEL	QUANTITY
KFS-20DAG1M-O	1
KFS-10BAG1M-I	2
KSG-IWF-25WFFY-8K1M32	1

MASTER BEDROOM/ ROOM1

ACCU 1	2.0hp Flexmatch Inverter	KFS-20DAG1M-O			
	Initial Charge			P	8,500.00
	Includes:				
	Circuit Breaker (30A-1ph)				

Additional Charges	Description	Unit	Price per Unit	Subtotal
Royal Cord (ODU-Breaker)	5.5mm ² x 3C	14 ft	P 50.00 / ft	P 700.00
Outdoor Bracket(fabricated)	floor	1 unit	P 2500.00 / unit	P 2500.00
				P 3,200.00

Estimated Charges	P 11,700.00
--------------------------	--------------------

MASTER BEDROOM

Area ≈ 14 sq.m

FCU A	1.0hp Wall Mounted Inverter	KFS-10BAG1M-I
	Estimated Pipe Length	10 ft
	Estimated Royal Cord Length	10 ft
	Includes:	
	Labor	
	10ft Copper Tube	
	10ft Royal Cord	
	Other Consumables	

Additional Charges	Description	Unit	Price per Unit	Subtotal
Drain Hose	White -1/2"	7 ft	P 25.00 / ft	P 175.00
Leak test	1/4" x 3/8"	1 pc(s)	P 1,800.00 / pc	P 1,800.00

Estimated Charges	P 1,975.00
--------------------------	-------------------

Estimated Charges for 1st Pair	P 13,675.00
---------------------------------------	--------------------

ROOM1

Area ≈ 9.2 sq.m

FCU B	1.0hp Wall Mounted Inverter	KFS-10BAG1M-I
	Labor	
	Additional Charges	
	Coppertube	1/4" x 3/8"
	Royal Cord	2mm ² x 4C
	Leak test	1/4" x 3/8"
	Drain Hose	White -1/2"

Estimated Charges	P 8,375.00
--------------------------	-------------------

LIVING/DINING/KITCHEN

Area ≈ 31 sq.m

ACU 2	2.5hp Wallmounted Inverter	KSG-IWF-25WFFY8K1M32
	Estimated Pipe Length	13 ft
	Estimated Royal Cord Length	18 ft
	Initial Charge	
	Includes:	
	Labor	
	10ft Copper Tube	
	10ft Royal Cord	
	Other Consumables	

Additional Charges	Description	Unit	Price Per Unit	Subtotal
Copper Tube	1/4"x 3/8"	3 ft	P 350.00 / ft	P 1,050.00
Royal Cord	2.mm2 x 4C	8 ft	P 100.00 / ft	P 800.00
Royal Cord (ODU-Breaker)	3.5mm2 x 3C	14 ft	P 60.00 / ft	P 840.00
Outdoor Bracket (floor)	fabricated	1 pc(s)	P 2,500.00 / pc	P 2,500.00
Leak test	3/8" x 5/8"	1 pc(s)	P 1,800.00 / pc	P 1,800.00
Drain Hose	White -1/2"	7 ft	P 25.00 / ft	P 175.00
				P 7,165.00

Estimated Charges	P 14,865.00
--------------------------	--------------------

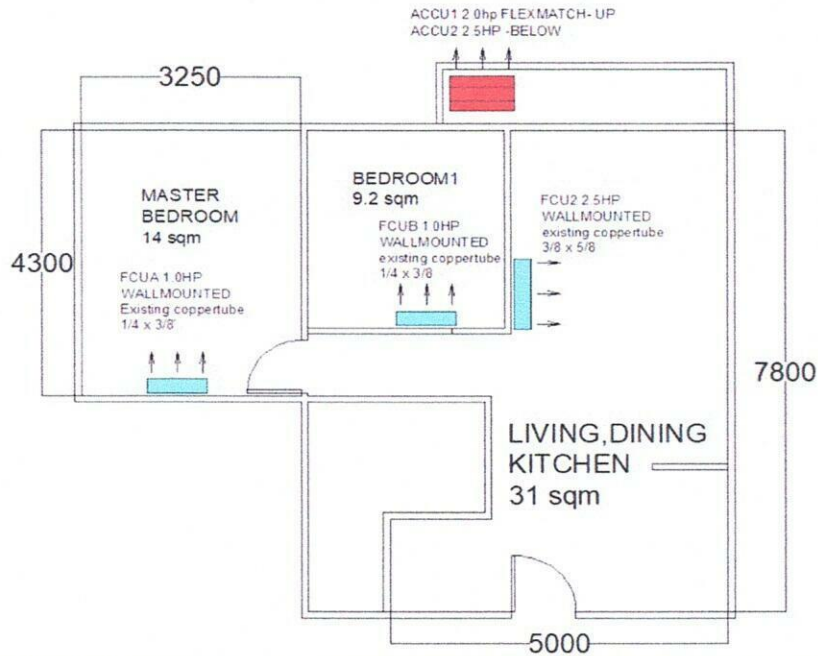

Total Estimated Charges

P 36,915.00

Validity: This quotation is valid for a period of fifteen (15) days from the date thereof, subject to our confirmation thereafter.

Note:

- 1 Location of indoor and outdoor units agree by customer and kolin surveyor.
- 2 AC drain line will be tapped to the nearest drain provision provided by the customer's contractor.
- 3 **Use existing coppertube of FCU A and FCU B, 1/4 X 3/8. FCU2 3/8 X 5/8**
- 4 Perform leaktest and draintest before installation of units.
- 5 Outdoor Bracket fabricated in shop, bring to site, 2 layer of outdoor Bracket.
- 6 Working days: Monday to Saturday, 8am- 5pm. parking is for confirmation, need working permit.
- 7 Mechanical Plans, Permits, Electrical permits not included.
- 8 Deflectors, masonry, carpentry, chipping & plastering (finishing & restoration) are not included in the installation.
- 9 Electrical power supply (feeder line) is not included in the scope of work of Kolin.
- 10 **Final charges will be based on actual installation.**

Prepared by:

Customer Conformer:

Jeffrey Dadios
Field Surveyor

Signature Over Printed Name

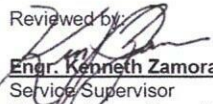
Reviewed by:

Engr. Kenneth Zamora
Service Supervisor
Field and Shop Operation