



October 9, 2024

ATTY. PETER SUCHIANCO  
512 TALISAY ST. BRGY. AYALA ALABANG, MUNTINLUPA CITY  
TEL#: 0966-624999 / 0922-814271

Dear Ma'am/Sir,

Kolin Marketing Inc., is extremely honored for your endorsement of Kolin brand and we are please to offer you with a special price/s for the following items.

A. EQUIPMENT & INSTALLATION

QTY	U/M	MODEL / DESCRIPTION	SRP	DISCOUNTED PRICE		AMOUNT
1	UNIT/S	MODEL: KSM-IW25-WCT10M1M32 KOLIN WALL MOUNTED CERTUS AIRCONDITIONER 23,210 Kj/h (2.5HP) REGULAR INVERTER W/ WIFI R-32	49,995.00	34,996.10	PHP	34,996.10
TOTAL UNIT COST					PHP	34,996.10
ESTIMATED COST OF INSTALLATION w/ installation of old unit (please see attached)					PHP	30,290.00
OTHERS: DELIVERY CHARGE					PHP	600.00
TOTAL ESTIMATED COST OF THE PROJECT					PHP	65,886.10

TERMS OF PAYMENT:

FULL PAYMENT OF UNIT AND DELIVERY CHARGE. IF CHECK, SUBJECT FOR 3 DAYS CLEARING.

WARRANTY:

FOR SPLIT TYPE : ONE (1) YEAR FREE PARTS AND LABOR, THREE YEARS (3) MAIN PCB , TEN (10) YEARS WARRANTY ON COMPRESSOR.

NOTES: PRICES ARE SUBJECT TO CHANGE WITHOUT PRIOR NOTICE.

PRICES IS VAT INCLUSIVE.

We thank you for giving opportunity to offer our product and services, hoping we receive your purchase order.

If you need assistance, don't hesitate to call the under signed at 0917-807-8607 or email at kmi\_asst@kolinphil.com.ph

Very Truly Yours,

JANELLEN S. LIM  
KMI-ASSISTANT

Noted by:

MARTIN HANIEL R. FLORES  
KMI-SUPERVISOR

Approved By:

MS. EDITHA M. FLORES  
AVP - FINANCE

KMI-QUOTE-10-24-0863  
REG-22%/4K

Conforme:

SIGNATURE OVER PRINTED NAME

Kolin Marketing, Inc.

1854 Sta. Rita St., Guadalupe Nuevo, Makati City

Tel.: (632) 8852-6473

Fax: (632) 8852-2170 / (632) 8852-4792

www.kolinphil.com.ph / kolinphilippines

October 9, 2024  
 ATTY . PETER SUCHIANGCO  
 512 Talisay St. Brgy Ayala Alabang, Muntinlupa City  
 0966-624999/ 0922-814271

MODEL Qty  
 KSM-IW25-WCT10M1M32 1

**DINING AREA** Area 26 sqm

ACU 1	3.0 HP Wall Mounted Regular	KSG-30B1M- OLD UNITS			
30	Estimated Pipe Length = 3 ft				
	Initial Charge				₱ 4,000.00
	Includes:				Installation
	Labor				old unit
	Consumables				
	Installation Materials	Description	Qty	Price per qty	Subtotal
	Copper Tube	3/8" X 5/8"	3 ft	₱ 400.00/ft	₱ 1,200.00
	Royal Cord (ACCU-Breaker)	3.5mm x 3C	7 ft	₱ 60.00/ft	₱ 420.00
	Circuit Breaker waterproof	30A/ 1ph	1 pc/s	₱ 1,000.00/pc	₱ 1,000.00
	Leaktest	3/8" X 5/8"	1 pc/s	₱ 1,800.00/pc	₱ 1,800.00
	Dismantle	2.5hp	1 pc/s	₱ 2,500.00/pc	₱ 2,500.00
	TRANSPORTATION	3.0HP	1 pc/s	₱ 1,500.00/pc	₱ 1,500.00
	Outdoor Bracket	Galvanise-large	1 pc/s	₱ 1,650.00/pc	₱ 1,650.00
					₱ 10,070.00

Estimated Charges ₱ 14,070.00

**MASTER BEDROOM** Area 29 sqm

ACU 2	2.5HP Wall Mounted Inverter	KSM-IW25-WCT10M1M32			
	Estimated Pipe Length = 17 ft				
	Estimated Royal Cord Length = 22 ft				
	Initial Charge				₱ 8,500.00
	Includes:				
	Labor				
	10ft Copper Tube				
	10ft Royal Cord				
	Outdoor Bracket (Wall)				
	Consumables				
	Installation Materials	Description	Qty	Price per qty	Subtotal
	Copper Tube	1/4" x 1/2"	7 ft	₱ 350.00/ft	₱ 2,450.00
	Royal Cord (comm. wire)	2.mm2 x 4C	12 ft	₱ 100.00/ft	₱ 1,200.00
	Royal Cord (ACCU-Breaker)	3.5mm x 3C	7 ft	₱ 60.00/ft	₱ 420.00
	Circuit Breaker waterproof	30A/1PH	1 pc/s	₱ 1,000.00/pc	₱ 1,000.00
	PVC blue	3/4" x 10'	1 pc/s	₱ 150.00/pc	₱ 150.00
	Dismantle	2.0hp	1 pc/s	₱ 2,500.00/pc	₱ 2,500.00
					₱ 7,720.00

Estimated Charges ₱ 16,220.00

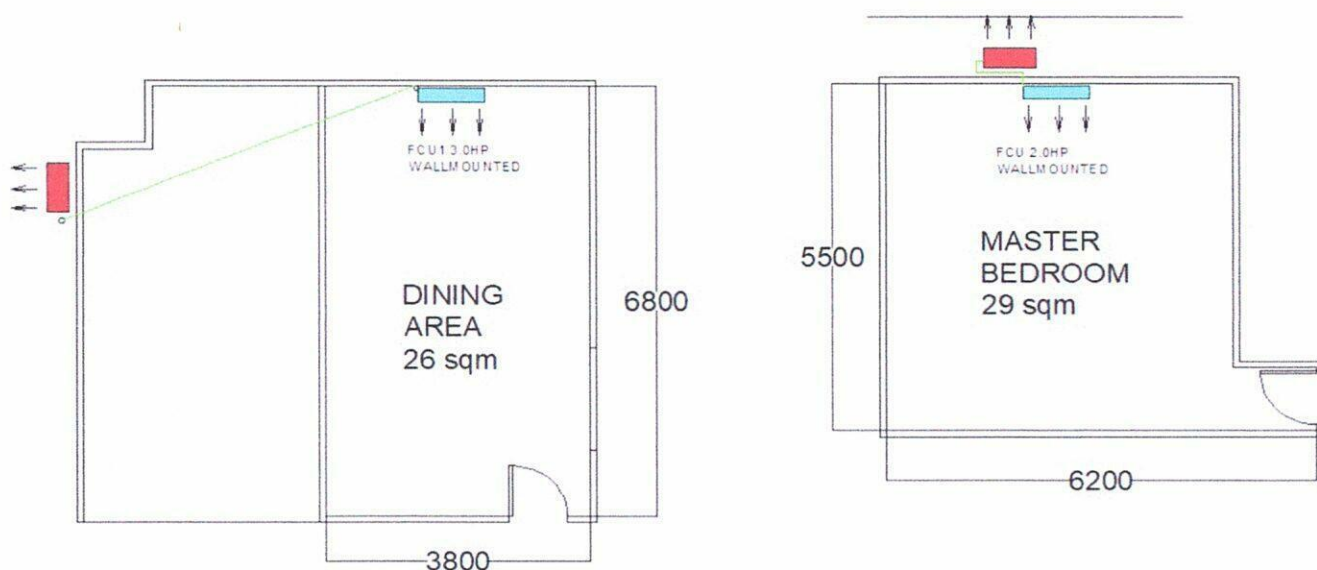

**Total Estimated Charges**

**P 30,290.00**

**Validity:** This quotation is valid for a period of fifteen (15) days from the date thereof, subject to our confirmation thereafter.

**Installation notes:**

- 1 Location of indoor and outdoor units were agreed by the customer and Kolin's surveyor.
- 2 AC drain line will be tapped to the nearest drain provision provided by the customer's contractor.
- 3 **ACU1 FROM 119 Aquarius St, Cinco Hermanos, Marikina City**
- 4 **Leaktest first of coppertube ACU1 3/8" X 5/8", IF SERVICEABLE.**
- 5 Working days: Monday to Saturday, 8am- 5pm with parking. Need working permit.
- 6 Mechanical Plans, Permits, Electrical permits not included.
- 7 Deflectors, masonry, carpentry, chipping & plastering (finishing & restoration) are not included in the installation.
- 8 Air conditioning drain line and Electrical power supply (feeder line) **220v/ 60hz/ 1ph** , should be provided by customer's contractor.
- 9 **Final charges will be based on actual installation.**

Prepared by:

**Jeoffrey Dadios**

Field Surveyor

Customer Conformance:

Signature Over Printed Name

Reviewed by:

**Engr. Kenneth Zamora**

Service Supervisor Shop and  
Field Operation