



October 8, 2024

DR. VICTOR JOSEPH YAMAT
UNIT 3804 TOWER 3 PIONEER HIGHLANDS, PIONEER COR. MADISON ST. BRGY. ILAYA, MANDALUYONG CITY
TEL#: 0917-5399589
Email: victorjoseph.yamat@pmi.com

Dear Ma'am/Sir,

Kolin Marketing Inc., is extremely honored for your endorsement of Kolin brand and we are please to offer you with a special price/s for the following items.

A. EQUIPMENT & INSTALLATION

**** OPTION 1 (KOLIN RECOMMENDATION)**

QTY	U/M	MODEL / DESCRIPTION	SRP	DISCOUNTED PRICE		AMOUNT
1	UNIT/S	MODEL: KSG-IWF-30WFY-8KIM32 KOLIN WALL MOUNTED PRIMUS GOLD AIRCONDITIONER 29,500 KJ/h (3.0HP) FULL DC INVERTER W/ WIFI R-32	76,595.00	55,744.10	PHP	55,744.10
1	UNIT/S	MODEL: KAG-145WCINV KOLIN WINDOW TYPE QUAD SERIES AIRCONDITIONER 13,210 KJ/h (1.5HP) FULL DC INVERTER W/ WIFI R-32 (WxDxH) 22"x28"x15"	32,995.00	24,436.10	PHP	24,436.10
TOTAL UNIT COST					PHP	80,180.20
ESTIMATED COST OF INSTALLATION (please see attached)					PHP	16,670.00
OTHERS: DELIVERY CHARGE					PHP	600.00
TOTAL ESTIMATED COST OF THE PROJECT					PHP	97,450.20

**** OPTION 2 (CUSTOMER'S CHOICE)**

QTY	U/M	MODEL / DESCRIPTION	SRP	DISCOUNTED PRICE		AMOUNT
1	UNIT/S	MODEL: KSG-IWF-25WFY-8KIM32 KOLIN WALL MOUNTED PRIMUS GOLD AIRCONDITIONER 25,560 KJ/h (2.5HP) FULL DC INVERTER W/ WIFI R-32	68,995.00	49,816.10	PHP	49,816.10
1	UNIT/S	MODEL: KAG-100WCINV KOLIN WINDOW TYPE QUAD SERIES AIRCONDITIONER 10,200 KJ/h (1.0HP) FULL DC INVERTER W/ WIFI R-32 (WxDxH) 18"x25"x14"	28,995.00	21,316.10	PHP	21,316.10
TOTAL UNIT COST					PHP	71,132.20
ESTIMATED COST OF INSTALLATION (please see attached)					PHP	16,670.00
OTHERS: DELIVERY CHARGE					PHP	600.00
TOTAL ESTIMATED COST OF THE PROJECT					PHP	88,402.20

TERMS OF PAYMENT:

FULL PAYMENT OF UNIT AND DELIVERY CHARGE. IF CHECK, SUBJECT FOR 3 DAYS CLEARING.

WARRANTY:

FOR SPLIT TYPE : ONE (1) YEAR FREE PARTS AND LABOR, THREE YEARS (3) MAIN PCB , TEN (10) YEARS WARRANTY ON COMPRESSOR.
FOR WINDOW TYPE: ONE (1) YEAR FREE PARTS AND LABOR, THREE YEARS (3) MAIN PCB, TEN (10) YEARS WARRANTY ON COMPRESSOR.

NOTES: ***** Need to sign waiver agreement due to under capacity of unit choice.**

PRICES ARE SUBJECT TO CHANGE WITHOUT PRIOR NOTICE.

PRICES IS VAT INCLUSIVE.

**** Cost of Installation is Package with the Unit(s), this cost cannot avail separately.**

**** INSTALLATION C/O ASP**

We thank you for giving opportunity to offer our product and services, hoping we receive your purchase order.

If you need assistance, don't hesitate to call the under signed at 0917-807-8607 or email at kmi_asst@kolinphil.com.ph

Very Truly Yours,

JANELLEN SALIM
KMI-ASSISTANT

Noted by:

MARTIN MANUEL R. FLORES
KMI-SUPERVISOR

Approved By:

MS. EDITHA M. FLORES
AVP - FINANCE

Conforme:

SIGNATURE OVER PRINTED NAME

KMI-QUOTE-10-24-0859
REG-22%/4K/1.3K

Kolin Marketing, Inc.

1854 Sta. Rita St., Guadalupe Nuevo, Makati City

Tel.: (632) 8852-6473

Fax: (632) 8852-2170 / (632) 8852-4792

www.kolinphil.com.ph / kolinphilippines



OCTOBER 07, 2024

DR. VICTOR JOSEPH YAMAT

Unit 3804 Tower 3 pioneer Highlands, Pioneer Cor Madison St. Brgy. Ilaya. Mandaluyong City

0917-5399589

victorjoseph.yamat@pmi.com

OPTION 1
(KOLIN RECOMMENDATION)

Model	Qty
KSG-IWF-30Wfy-8K1M32	1
KAG-145WCINV	1

RECOMMENDATION

LIVING/DINING/KITCHEN			Area ≈ 39 sq.m
------------------------------	--	--	----------------

ACU 1	3.0hp Wallmounted Inverter	KSG-IWF-30Wfy-8K1M32	
	Estimated Pipe Length :	20	ft
	Estimated Royal Cord Length :	27	ft
	Initial Charge		P 5,500.00

Includes:

Labor
10ft Copper Tube
10ft Royal Cord
Outdoor Bracket (Floor)
Other Consumables

Additional Charges	Description	Unit	Price Per Unit	Subtotal
Copper Tube	1/4"x 5/8"	10 ft	P 400.00 / ft	P 4,000.00
Royal Cord	2.mm2 x 4C	17 ft	P 100.00 / ft	P 1,700.00
Royal Cord (ODU-Breaker)	3.5mm2 x 3C	7 ft	P 60.00 / ft	P 420.00
Circuit Breaker(NEMA)	30A/ 1Ph	1 pc(s)	P 1,000.00 / pc	P 1,000.00
Rubber Insulation	2 1/8"x3/4" x 6'	1 pc(s)	P 350.00 / pc	P 350.00
Dismantle	2.5hp	1 pc(s)	P 2,500.00 / pc	P 2,500.00
				P 9,970.00

Estimated Charges	P 15,470.00
-------------------	-------------

BEDROOM			Area ≈ 15 sq.m
----------------	--	--	----------------

ACU2	1.5hp Windowtype Inverter	KAG-145WCINV	
	Initial charge		P 1,200.00

Estimated charges	P 1,200.00
-------------------	------------

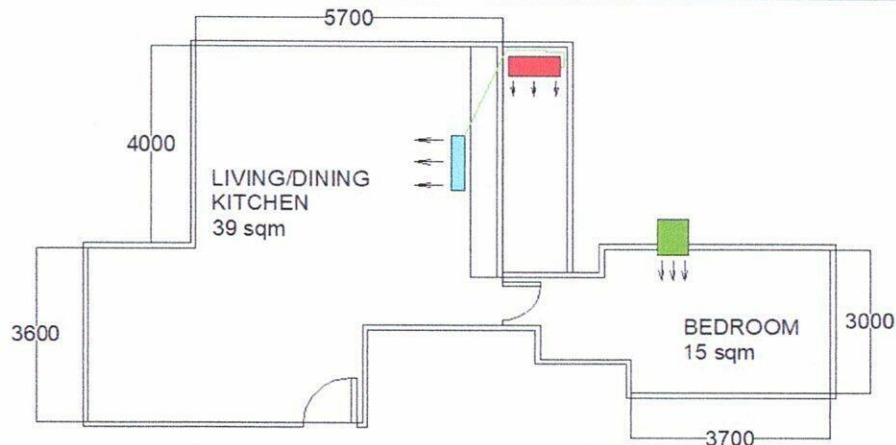

Validity: This quotation is valid for a period of fifteen (15) days from the date thereof, subject to our confirmation thereafter.

Note:

- 1 Location of indoor and outdoor units were agreed by the customer and Kolin's surveyor.
- 2 AC drain line will be tapped to the nearest drain provision provided by the customer's contractor.
- 3 Customer need to provide plywood 3/4 inch, for the backing of unit. (ACU1) need some manholes for the lay out of copper tube.
- 4 KAG-145WCINV Dimension: W x D x H, = 560 X 708 x 375 mm. (22 x 28 x 15 inches)
- 5 Working days: Monday to Saturday, 8am- 5pm with parking. Need permit without parking.
- 6 Mechanical Plans, Permits, Electrical permits not included.
- 7 Deflectors, masonry, carpentry, chipping & plastering (finishing & restoration) are not included in the installation.
- 8 Electrical power supply (feeder line) 220v/ 60hz/ 1ph, is not included in the scope of work of Kolin.
- 9 Final charges will be based on actual installation.

Prepared by:

Jeoffrey Dadios

Field Surveyor

Customer Conformer:

Signature Over Printed Name

Reviewed by:

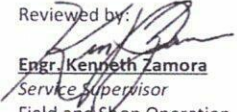
Engr. Kenneth Zamora

Service Supervisor

Field and Shop Operation

OCTOBER 07, 2024

DR. VICTOR JOSEPH YAMAT

Unit 3804 Tower 3 pioneer Highlands, Pioneer Cor Madison St. Brgy. Ilaya. Mandaluyong City

0917-5399589

victorjoseph.yamat@pmi.com

OPTION 2
(CUSTOMER'S CHOICE)

Model	Qty
KSG-IWF-25Wfy-8K1M32	1
KAG-100WCINV	1

RECOMMENDATION

LIVING/DINING/KITCHEN			Area ≈ 39 sq.m
------------------------------	--	--	----------------

ACU 1	3.0hp Wallmounted Inverter	KSG-IWF-25Wfy-8K1M32	
	Estimated Pipe Length :	20	ft
	Estimated Royal Cord Length :	27	ft
	Initial Charge		P 5,500.00

Includes:

Labor
10ft Copper Tube
10ft Royal Cord
Outdoor Bracket (Floor)
Other Consumables

Additional Charges	Description	Unit	Price Per Unit	Subtotal
Copper Tube	1/4"x 5/8"	10 ft	P 400.00 / ft	P 4,000.00
Royal Cord	2.mm2 x 4C	17 ft	P 100.00 / ft	P 1,700.00
Royal Cord (ODU-Breaker)	3.5mm2 x 3C	7 ft	P 60.00 / ft	P 420.00
Circuit Breaker(NEMA)	30A/ 1Ph	1 pc(s)	P 1,000.00 / pc	P 1,000.00
Rubber Insulation	2 1/8"x3/4" x 6'	1 pc(s)	P 350.00 / pc	P 350.00
Dismantle	2.5hp	1 pc(s)	P 2,500.00 / pc	P 2,500.00
				P 9,970.00

Estimated Charges	P 15,470.00
-------------------	-------------

BEDROOM			Area ≈ 15 sq.m
----------------	--	--	----------------

ACU2	1.5hp Windowtype Inverter	KAG-100WCINV	
	Initial charge		P 1,200.00

Estimated charges	P 1,200.00
-------------------	------------

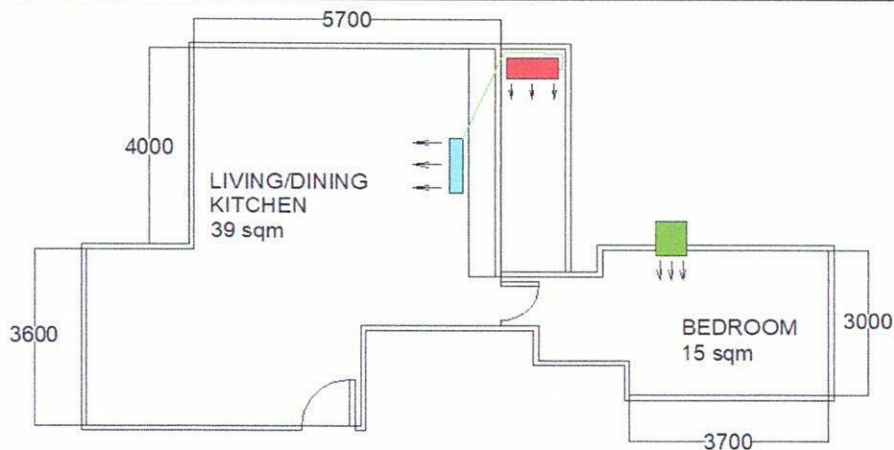

Validity: This quotation is valid for a period of fifteen (15) days from the date thereof, subject to our confirmation thereafter.

Note:

- 1 Location of indoor and outdoor units were agreed by the customer and Kolin's surveyor.
- 2 AC drain line will be tapped to the nearest drain provision provided by the customer's contractor.
- 3 Customer need to provide plywood 3/4 inch, for the backing of unit. (ACU1) need some manholes for the lay out of copper tube.
- 4 KAG-145WCINV Dimension: W x D x H, = 560 X 708 x 375 mm. (22 x 28 x 15 inches)
- 5 Working days: Monday to Saturday, 8am- 5pm with parking. Need permit without parking.
- 6 Mechanical Plans, Permits, Electrical permits not included.
- 7 Deflectors, masonry, carpentry, chipping & plastering (finishing & restoration) are not included in the installation.
- 8 Electrical power supply (feeder line) 220v/ 60hz/ 1ph, is not included in the scope of work of Kolin.
- 9 Final charges will be based on actual installation.

Prepared by:

Jeffrey Dadios

Field Surveyor

Customer Conformer:

Signature Over Printed Name

Reviewed by:

Engr. Kenneth Zamora

Service Supervisor

Field and Shop Operation

OCTOBER 07, 2024

DR. VICTOR JOSEPH YAMAT

Unit 3804 Tower 3 Pioneer Highlands, Pioneer Cor Madison St. Brgy. Ilaya. Mandaluyong City

0917-5399589

victorjoseph.yamat@pmi.com

Please be informed that the air-conditioner you intend to purchase is under capacity as compared to the following unit that we proposed:

Location	Area	Kolin's Recommendation	Customer's Choice	Remarks
LIVING / DINING / KITCHEN	39 sqm	KSG-IWF-30WFY8K1M32	KSG-IWF-25WFY8K1M32	Calculated 3.0hp, under by 0.5hp
BEDROOM	15 sqm	KAG-145WCINV	KAG-100WCINV	Calculated 1.1hp, under by 0.1hp

Since the unit of your choice is under capacity, it is probable that you may experience the following;

1. Capacity of the unit to cool the area will take longer or it will not cool the area at all that may lead to your dissatisfaction with the cooling performance of our unit.
2. Power consumption will be higher due to frequent running of compressor for not reaching the desired temperature within the normal parameter.
3. Useful life of compressor will be shortened due to excessive running beyond the normal run cycle.

Considering the above conditions, we regret to inform you that we cannot guarantee the efficient performance of unit. **Also, One (1) year warranty for parts (compressor-10year).**

For your guidance and information

Prepared by:

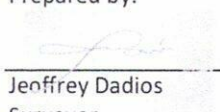

Jeffrey Dadios
Surveyor

Approved by:

Mr. Alvin de Rivera
Service Manager

Oct.8,2024

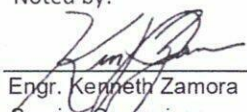
Noted by:

Engr. Kenneth Zamora
Service Supervisor
Field and Shop Operation

Customer Conformance:

Signature Over Printed Name