



October 8, 2024

MR. STEVE ROMASATA  
UNIT 3002 PARK TRIANGLE RES. 32nd ST. COR. 11th AVE. BRGY. FORT BONIFACIO, TAGUIG CITY  
TEL#: 0917-5326738 / 0917-7001574  
Email: ruliboro@gmail.com

Dear Ma'am/Sir,

Kolin Marketing Inc., is extremely honored for your endorsement of Kolin brand and we are please to offer you with a special price/s for the following items.

A. EQUIPMENT & INSTALLATION

QTY	U/M	MODEL / DESCRIPTION	SRP	DISCOUNTED PRICE		AMOUNT
1	UNIT/S	MODEL: KSM-IW25-WCT10M1M32 KOLIN WALL MOUNTED CERTUS AIRCONDITIONER 23,210 Kj/h (2.5HP) REGULAR INVERTER W/ WIFI R-32	49,995.00	34,996.10	PHP	34,996.10
1	UNIT/S	MODEL: KSM-IW20-WCT10M1M32 KOLIN WALL MOUNTED CERTUS SERIES AIRCONDITIONER 18,990 Kj/h (2.0HP) REGULAR INVERTER R-32	41,995.00	28,756.10	PHP	28,756.10
2	UNIT/S	MODEL: KSM-IW10-WCT10M1M32 KOLIN WALL MOUNTED CERTUS SERIES AIRCONDITIONER 9,800 Kj/h (1.0HP) REGULAR INVERTER R-32	29,995.00	19,396.10	PHP	38,792.20
TOTAL UNIT COST					PHP	102,544.40
ESTIMATED COST OF INSTALLATION (please see attached)					PHP	45,200.00
OTHERS: DELIVERY CHARGE					PHP	600.00
TOTAL ESTIMATED COST OF THE PROJECT					PHP	148,344.40

TERMS OF PAYMENT:

FULL PAYMENT OF UNIT AND DELIVERY CHARGE. IF CHECK, SUBJECT FOR 3 DAYS CLEARING.

WARRANTY:

FOR SPLIT TYPE : ONE (1) YEAR FREE PARTS AND LABOR, THREE YEARS (3) MAIN PCB , TEN (10) YEARS WARRANTY ON COMPRESSOR.

NOTES: \*\*\* Need to sign waiver agreement due to under capacity of unit choice.

PRICES ARE SUBJECT TO CHANGE WITHOUT PRIOR NOTICE.

PRICES IS VAT INCLUSIVE.

We thank you for giving opportunity to offer our product and services, hoping we receive your purchase order.

If you need assistance, don't hesitate to call the under signed at 0917-807-8607 or email at kmi\_asst@kolinphil.com.ph

Very Truly Yours,

JANELLEN S. LIM  
KMI-ASSISTANT

Noted by:  
MARTIN HANUEL R. FLORES  
KMI-SUPERVISOR

Approved By:  
MS. EDITHA M. FLORES  
AVP - FINANCE

KMI-QUOTE-10-24-0862  
REG-22%/4K

Conforme: \_\_\_\_\_  
SIGNATURE OVER PRINTED NAME

Kolin Marketing, Inc.  
1854 Sta. Rita St., Guadalupe Nuevo, Makati City  
Tel.: (632) 8852-6473  
Fax: (632) 8852-2170 / (632) 8852-4792  
www.kolinphil.com.ph / kolinphilippines

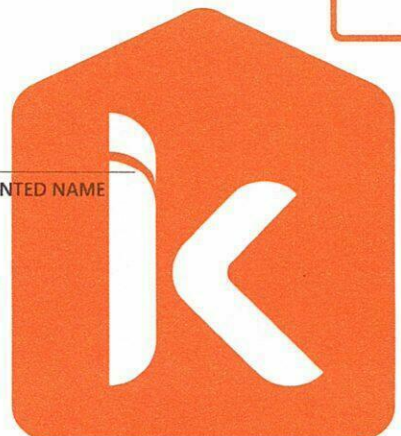

OCTOBER 07, 2024  
 STEVE ROMASANTA  
 Unit 3002 Park Triangle Res. 32nd St. Cor 11th Ave. Brgy Fort Bonifacio, Taguig City  
 0917 532 6738  
[ruliboro@gmail.com](mailto:ruliboro@gmail.com) / viber 0917-7001574

MODEL	Qty
KSM-IW25-WCT10M1M32	1
KSM-IW20-WCT10M1M32	1
KSM-IW10-WCT10M1M32	2

REV1 -CERTUS

LIVING/DINING/KITCHEN	Area	47 sqm
-----------------------	------	--------

ACU 1 2.5HP Wall Mounted inverter *KSM-IW25-WCT0M1M32*  
 Estimated Pipe Length = 10 ft  
 Estimated Royal Cord Length = 10 ft  
**Initial Charge** ₱ 7,500.00

Includes:

Labor  
 10ft Copper Tube  
 10ft Royal Cord  
 Outdoor Bracket (Floor)  
 Consumables

Installation Materials	Description	Qty	Price per qty	Subtotal
Royal Cord (ACCU-Breaker)	3.5mm x 3C	5 ft	₱ 60.00/ft	₱ 300.00
Leaktest	1/4" x 1/2"	1 set	₱ 1,800.00/set	₱ 1,800.00
Circuit Breaker waterproof	20hp /1ph	1 pc/s	₱ 1,000.00/pc	₱ 1,000.00
				<b>₱ 3,100.00</b>

<b>Estimated Charges</b>	<b>₱ 10,600.00</b>
--------------------------	--------------------

BEDROOM1	Area	10 sqm
----------	------	--------

ACU 2 1.0HP Wall Mounted inverter *KSM-IW10-WCT10M1M32*  
 Estimated Pipe Length = 10 ft  
 Estimated Royal Cord Length = 10 ft  
**Initial Charge** ₱ 7,500.00

Includes:

Labor  
 10ft Copper Tube  
 10ft Royal Cord  
 Outdoor Bracket (Floor)  
 Consumables

Installation Materials	Description	Qty	Price per qty	Subtotal
Royal Cord (ACCU-Breaker)	3.5mm x 3C	5 ft	₱ 60.00/ft	₱ 300.00
Circuit Breaker waterproof	20hp /1ph	1 pc/s	₱ 1,000.00/pc	₱ 1,000.00
Leaktest	1/4" x 3/8"	1 set	₱ 1,800.00/set	₱ 1,800.00
				<b>₱ 3,100.00</b>

<b>Estimated Charges</b>	<b>₱ 10,600.00</b>
--------------------------	--------------------

<b>BEDROOM2</b>	<b>Area 12 sqm</b>
-----------------	--------------------

**ACU 3 1.0 HP Wall Mounted Inverter** **KSG-IWF-10Wfy8K1M32**  
 Estimated Pipe Length = 10 ft  
 Estimated Royal Cord Length = 10 ft  
**Initial Charge** P 7,500.00

Includes:

- Labor
- 10ft Copper Tube
- 10ft Royal Cord
- Outdoor Bracket (Floor)
- Consumables

Installation Materials	Description	Qty	Price per qty	Subtotal
Royal Cord (ACCU-Breaker)	3.5mm x 3c	5 ft	P 60.00/ft	P 300.00
Circuit Breaker waterproof	20hp /1ph	1 pc/s	P 1,000.00/pc	P 1,000.00
Leaktest	1/4" x 3/8"	1 set	P 1,800.00/set	P 1,800.00
Outdoor bracket	Fabricated floor	1 pc/s	P 2,500.00/pc	P 2,500.00
PVC blue	3/4" x 10'	2 pc/s	P 150.00/pc	P 300.00
				P 5,900.00

<b>Estimated Charges</b>	<b>P 13,400.00</b>
--------------------------	--------------------

<b>MASTER BEDROOM</b>	<b>Area 20 sqm</b>
-----------------------	--------------------

**ACU 4 2.0 HP Wall Mounted Inverter** **KSG-IWF-20Wfy8K1M32**  
 Estimated Pipe Length = 10 ft  
 Estimated Royal Cord Length = 10 ft  
**Initial Charge** P 7,500.00

Includes:

- Labor
- 10ft Copper Tube
- 10ft Royal Cord
- Outdoor Bracket (Floor)
- Consumables

Installation Materials	Description	Qty	Price per qty	Subtotal
Royal Cord (ACCU-Breaker)	3.5mm x 3c	5 ft	P 60.00/ft	P 300.00
Circuit Breaker waterproof	30hp /1ph	1 pc/s	P 1,000.00/pc	P 1,000.00
Leaktest	1/4" x 1/2"	1 set	P 1,800.00/set	P 1,800.00
				P 3,100.00

<b>Estimated Charges</b>	<b>P 10,600.00</b>
--------------------------	--------------------

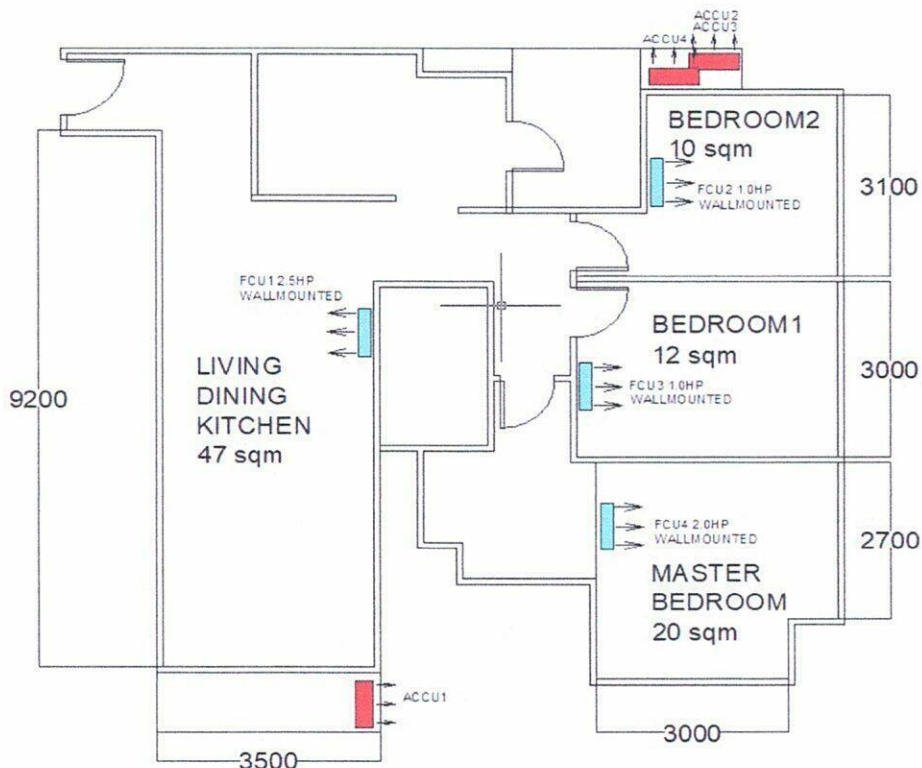



Total Estimated Charges

P 45,200.00

Validity: This quotation is valid for a period of fifteen (15) days from the date thereof, subject to our confirmation thereafter.

**Installation notes:**

- 1 Location of indoor and outdoor units were agreed by the customer and Kolin's surveyor.
- 2 AC drain line will be tapped to the nearest drain provision provided by the customer's contractor.
- 3 Upon approval schedule pressure leaktest of existing coppertube, if pressure drops, recommends to lay out new copper tube.
- 4 Bring the fabricated bracket for bedroom1. fabricated from shop.
- 5 BEDROOM 2 drainline need to adjust lower to 4 inches.
- 6 Working days: Monday to Saturday, 8am- 5pm with parking.Need working permit.
- 7 Mechanical Plans, Permits, Electrical permits not included.
- 8 Deflectors, masonry, carpentry, chipping & plastering (finishing & restoration) are not included in the installation.
- 9 Air conditioning drain line and Electrical power supply (feeder line) **220v/ 60hz/ 1ph** , should be provided by customer's contractor.
- 10 **Final charges will be based on actual installation.**

Prepared by:

  
**Jeffrey Dadios**  
Field Surveyor

Customer Conformance:

\_\_\_\_\_  
Signature Over Printed Name

Reviewed by:

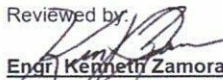
  
**Engr. Kenneth Zamora**  
Service Supervisor Shop and  
Field Operation

October 7, 2024

STEVE ROMASANTA

Unit 3002 Park Triangle Res. 32nd St. Cor 11th Ave. Brgy Fort Bonifacio, Taguig City

0917 532 6738

ruliboro@gmail.com / viber 0917-7001574

Please be informed that the air-conditioner you intend to purchase is under capacity as compared to the following unit that we proposed:

Location	Area	Kolin's Recommendation	Customer's Choice	Remarks
LIVING/DINING	47 sqm	KSM-IW20-WCT10M1M32 2 UNITS	KSM-IW25-WCT10M1M32	Calculated 3.6hp under by 1.1hp

Since the unit of your choice is under capacity, it is probable that you may experience the following;

1. Capacity of the unit to cool the area will take longer or it will not cool the area at all that may lead to your dissatisfaction with the cooling performance of our unit.
2. Power consumption will be higher due to frequent running of compressor for not reaching the desired temperature within the normal parameter.
3. Useful life of compressor will be shortened due to excessive running beyond the normal run cycle.

Considering the above conditions, we regret to inform you that we cannot guarantee the efficient performance of unit. **Also, One (1) year warranty for parts (compressor wty - VOID).**

For your guidance and information

Prepared by:

Jeoffrey Dadios  
Surveyor

Approved by:

Mr. Alvin de Rivera  
Service Manager

Noted by:

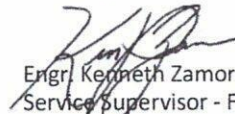
  
Engr. Kenneth Zamora  
Service Supervisor - Field  
and Shop Operation

Customer Conforms:

Signature Over Printed Name