



September 23, 2024

MR. STEVE ROMASANTA
UNIT 3002 PARK TRIANGLE RES. 32ND ST. COR. 11TH AVE., BRGY. FORT BONIFACIO, TAGUIG CITY
TEL#: 0917-7001574
Email: ruliboro@gmail.com

Dear Ma'am/Sir,

Kolin Marketing Inc., is extremely honored for your endorsement of Kolin brand and we are please to offer you with a special price/s for the following items.

A. EQUIPMENT & INSTALLATION

QTY	U/M	MODEL / DESCRIPTION	SRP	DISCOUNTED PRICE		AMOUNT
3	UNIT/S	MODEL: KSM-IW20-WCT10M1M32 KOLIN WALL MOUNTED CERTUS SERIES AIRCONDITIONER 18,990 Kj/h (2.0HP) REGULAR INVERTER R-32	41,995.00	28,756.10	PHP	86,268.30
2	UNIT/S	MODEL: KSM-IW10-WCT10M1M32 KOLIN WALL MOUNTED CERTUS SERIES AIRCONDITIONER 9,800 Kj/h (1.0HP) REGULAR INVERTER R-32	29,995.00	19,396.10	PHP	38,792.20
TOTAL UNIT COST					PHP	125,060.50
ESTIMATED COST OF INSTALLATION (please see attached)					PHP	56,425.00
OTHERS: DELIVERY CHARGE					PHP	600.00
TOTAL ESTIMATED COST OF THE PROJECT					PHP	182,085.50

TERMS OF PAYMENT:

FULL PAYMENT OF UNIT AND DELIVERY CHARGE. IF CHECK, SUBJECT FOR 3 DAYS CLEARING.

WARRANTY:

FOR SPLIT TYPE : ONE (1) YEAR FREE PARTS AND LABOR, THREE YEARS (3) MAIN PCB , TEN (10) YEARS WARRANTY ON COMPRESSOR.

NOTES: PRICES ARE SUBJECT TO CHANGE WITHOUT PRIOR NOTICE.

PRICES IS VAT INCLUSIVE.

**** Cost of Installation is Package with the Unit(s), this cost cannot avail separately.**

We thank you for giving opportunity to offer our product and services, hoping we receive your purchase order.

If you need assistance, don't hesitate to call the under signed at 0917-807-8607 or email at kmi_asst@kolinphil.com.ph

Very Truly Yours,

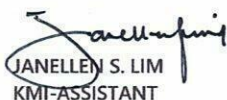
JANELLEN S. LIM
KMI-ASSISTANT

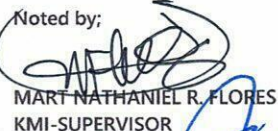
Noted by:

MART NATHANIEL R. FLORES
KMI-SUPERVISOR

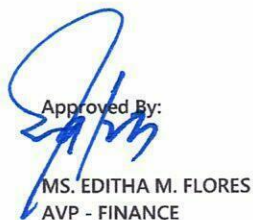
KMI-QUOTE-09-24-0824
REG-22%/4K

Approved By:
MS. EDITHA M. FLORES
AVP - FINANCE

Conforme:

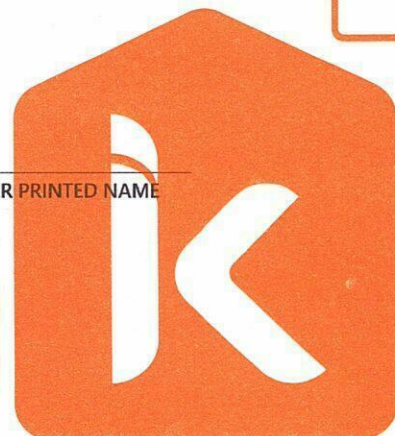
SIGNATURE OVER PRINTED NAME



SEPTEMBER 23, 2024
 STEVE ROMASANTA
 Unit 3002 Park Triangle Res. 32nd St. Cor 11th Ave. Brgy Fort Bonifacio, Taguig City
 0917 532 6738
ruliboro@gmail.com / [viber 0917-7001574](tel:0917-7001574)

MODEL	Qty
KSM-IW20-WCT10M1M32	3
KSM-IW10-WCT10M1M32	2

CERTUS

LIVING/DINING/KITCHEN	Area	47 sqm
-----------------------	------	--------

ACU 1	2.0HP Wall Mounted inverter	KSM-IW20-WCT10M1M32
	Estimated Pipe Length = 10 ft	
	Estimated Royal Cord Length = 10 ft	
	Initial Charge	P 7,500.00
	Includes:	
	Labor	
	10ft Copper Tube	
	10ft Royal Cord	
	Outdoor Bracket (Floor)	
	Consumables	
	Installation Materials	Description Qty Price per qty Subtotal
	Royal Cord (ACCU-Breaker)	3.5mm x 3C 5 ft P 60.00/ft P 300.00
	Leaktest	1/4" x 1/2" 1 set P 1,800.00/set P 1,800.00
	Circuit Breaker waterproof	20hp /1ph 1 pc/s P 1,000.00/pc P 1,000.00
	Drain Hose	White -1/2" 5 ft P 25.00/ft P 125.00
		P 3,225.00
	Estimated Charges	P 10,725.00

ACU 2	2.0HP Wall Mounted inverter	KSM-IW20-WCT10M1M32
	Estimated Pipe Length = 10 ft	
	Estimated Royal Cord Length = 10 ft	
	Initial Charge	P 7,500.00
	Includes:	
	Labor	
	10ft Copper Tube	
	10ft Royal Cord	
	Outdoor Bracket (Floor)	
	Consumables	
	Installation Materials	Description Qty Price per qty Subtotal
	Royal Cord (ACCU-Breaker)	3.5mm x 3C 5 ft P 60.00/ft P 300.00
	Leaktest	1/4" x 1/2" 1 set P 1,800.00/set P 1,800.00
	Circuit Breaker waterproof	20hp /1ph 1 pc/s P 1,000.00/pc P 1,000.00
	Drain Hose	White -1/2" 5 ft P 25.00/ft P 125.00
		P 3,225.00
	Estimated Charges	P 10,725.00

BEDROOM1	Area	10 sqm
ACU 3	1.0HP Wall Mounted inverter	KSM-IW10-WCT10M1M32
	Estimated Pipe Length = 10 ft	
	Estimated Royal Cord Length = 10 ft	
	Initial Charge	P 7,500.00
	Includes:	
	Labor	
	10ft Copper Tube	
	10ft Royal Cord	
	Outdoor Bracket (Floor)	
	Consumables	
	Installation Materials	Description Qty Price per qty Subtotal
	Royal Cord (ACCU-Breaker)	3.5mm x 3C 5 ft P 60.00/ft P 300.00
	Circuit Breaker waterproof	20hp /1ph 1 pc/s P 1,000.00/pc P 1,000.00
	Leaktest	1/4" x 3/8" 1 set P 1,800.00/set P 1,800.00
	Drain Hose	White -1/2" 5 ft P 25.00/ft P 125.00
		P 3,225.00
	Estimated Charges	P 10,725.00

BEDROOM2	Area 12 sqm
-----------------	----------------

ACU 4 1.0 HP Wall Mounted Inverter **KSG-IWF-10Wfy8K1M32**

Estimated Pipe Length = 10 ft

Estimated Royal Cord Length = 10 ft

Initial Charge

P 7,500.00

Includes:

Labor

10ft Copper Tube

10ft Royal Cord

Outdoor Bracket (Floor)

Consumables

Installation Materials	Description	Qty	Price per qty	Subtotal
Royal Cord (ACCU-Breaker)	3.5mm x 3c	5 ft	P 60.00/ft	P 300.00
Circuit Breaker waterproof	20hp /1ph	1 pc/s	P 1,000.00/pc	P 1,000.00
Leaktest	1/4" x 3/8"	1 set	P 1,800.00/set	P 1,800.00
Outdoor bracket	Fabricated floor	1 pc/s	P 2,500.00/pc	P 2,500.00
PVC blue	3/4" x 10'	2 pc/s	P 150.00/pc	P 300.00
Drain Hose	White -1/2"	5 ft	P 25.00/ft	P 125.00

P 6,025.00

Estimated Charges

P 13,525.00

MASTER BEDROOM	Area 20 sqm
-----------------------	----------------

ACU 5 2.0 HP Wall Mounted Inverter **KSG-IWF-20Wfy8K1M32**

Estimated Pipe Length = 10 ft

Estimated Royal Cord Length = 10 ft

Initial Charge

P 7,500.00

Includes:

Labor

10ft Copper Tube

10ft Royal Cord

Outdoor Bracket (Floor)

Consumables

Installation Materials	Description	Qty	Price per qty	Subtotal
Royal Cord (ACCU-Breaker)	3.5mm x 3c	5 ft	P 60.00/ft	P 300.00
Circuit Breaker waterproof	30hp /1ph	1 pc/s	P 1,000.00/pc	P 1,000.00
Leaktest	1/4" x 1/2"	1 set	P 1,800.00/set	P 1,800.00
Drain Hose	White -1/2"	5 ft	P 25.00/ft	P 125.00

P 3,225.00

Estimated Charges

P 10,725.00

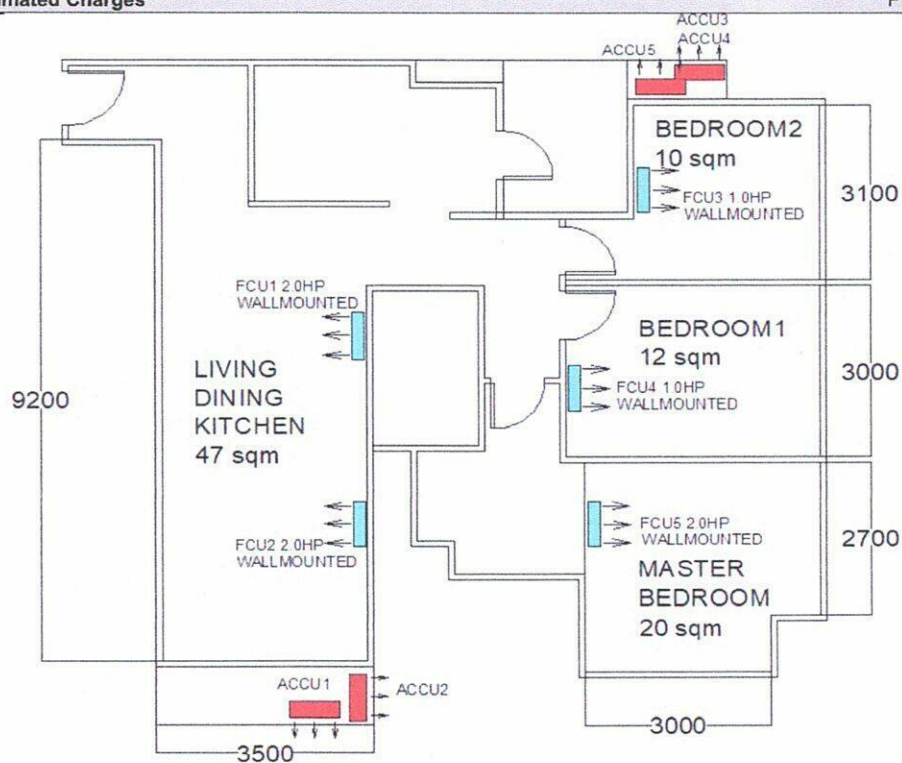

Validity: This quotation is valid for a period of fifteen (15) days from the date thereof, subject to our confirmation thereafter.

Installation notes:

- 1 Location of indoor and outdoor units were agreed by the customer and Kolin's surveyor.
- 2 AC drain line will be tapped to the nearest drain provision provided by the customer's contractor.
- 3 Leaktest first the existing coppertube, if pressure drops recommends to replace new copper tube lay out.
- 4 Bring the fabricated bracket for bedroom1. fabricated from shop.
- 5 BEDROOM 2 drainline need to adjust lower to 4 inches.
- 6 Working days: Monday to Saturday, 8am- 5pm with parking. Need working permit.
- 7 Mechanical Plans, Permits, Electrical permits not included.
- 8 Deflectors, masonry, carpentry, chipping & plastering (finishing & restoration) are not included in the installation.
- 9 Air conditioning drain line and Electrical power supply (feeder line) **220v/ 60hz/ 1ph**, should be provided by customer's contractor.
- 10 **Final charges will be based on actual installation.**

Prepared by:

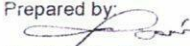
Jeffrey Dadios
Field Surveyor

Customer Conformance:

Signature Over Printed Name

Reviewed by:

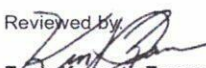
Engr. Kenneth Zamora
Service Supervisor Shop and
Field Operation