



April 14, 2025

TOMITA INDUSTRIAL & MACHINERY, INC.
#22 5/F TOYOMA GROUP CENTER, TIMOG AVE. BRGY. LAGING HANDA, QUEZON CITY
TEL#: 0923-0825868 / 0917-7205336

Dear Ma'am/Sir,

Kolin Marketing Inc., is extremely honored for your endorsement of Kolin brand and we are please to offer you with a special price/s for the following items.

A. EQUIPMENT & INSTALLATION

QTY	U/M	MODEL / DESCRIPTION	SRP	DISCOUNTED PRICE		AMOUNT
1	UNIT/S	MODEL: KLG-IF40-5G1M32 KOLIN FLOOR MOUNTED AIRCONDITIONER 37,980 Kj/h (3.0TR) FULL DC INVERTER R-32 SINGLE PHASE	113,195.00	79,028.20	PHP	79,028.20
TOTAL UNIT COST					PHP	79,028.20
ESTIMATED COST OF INSTALLATION (please see attached)					PHP	32,795.00
OTHERS: DELIVERY CHARGE					PHP	600.00
TOTAL ESTIMATED COST OF THE PROJECT					PHP	112,423.20

TERMS OF PAYMENT:

FULL PAYMENT OF UNIT AND DELIVERY CHARGE. IF CHECK, SUBJECT FOR 3 DAYS CLEARING.

WARRANTY:

FOR FLOOR MOUNTED: ONE (1) YEAR FREE PARTS AND LABOR, FIVE (5) YEARS WARRANTY ON COMPRESSOR.

NOTES: PRICES ARE SUBJECT TO CHANGE WITHOUT PRIOR NOTICE.

PRICES IS VAT INCLUSIVE.

**** Cost of Installation is Package with the Unit(s), this cost cannot avail separately (cost will be based on actual).**

We thank you for giving opportunity to offer our product and services, hoping we receive your purchase order.

If you need assistance, don't hesitate to call the under signed at 0917-807-8607 or email at kmi_asst@kolinphil.com.ph

Very Truly Yours,

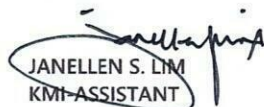

JANELLEN S. LIM
KMI-ASSISTANT

Noted by: 
MART NATHANIEL R. FLORES
KMI-SUPERVISOR

Approved By: 
MS. EDITHA M. FLORES
AVP - FINANCE

KMI-QUOTE-04-25-0281
ECY-24%/7K

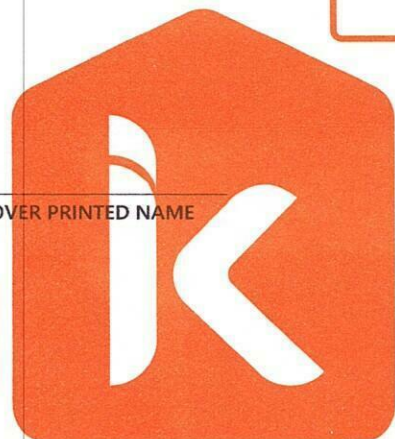
Conforme: _____
SIGNATURE OVER PRINTED NAME



KOLIN Philippines International Inc.
Survey Form

No 003623

Customer Name: TOMMY INDUSTRIAL Date: 4-12-78
 Address: 15 S/F ROYAL'S, GROUND FLOOR, TITAN, B/E SJR No.: 744844
 Establishment Type: Residential ☐ Area Surveyed: ACCOMPTING ROOM
 Commercial ☒ Area Surveyed: ACCOMPTING ROOM
 Recommended Product Model: KLG-1F40-(61/2)

Cooling Capacity Computation

Floor Area: 30 sqm.
 Ceiling Height: 2.7 mtr.

note: add 20% per meter in excess of 3 meters in the initial cooling capacity computed.

Floor Area:	<u>30</u>	x	550 Btu/h	<u>16500</u> Btu/h
Ceiling Height (excess of 3 mtrs.):		x	20%	
Window Direct Sunlight		x	20% - 50%	<u>8250</u> Btu/h
Total Cooling Capacity				<u>24750</u> Btu/h

Add : Additional Heat Load

No. of Person	<u>7</u>	x	300 Btu/h	<u>2100</u> Btu/h
No. of Ordinary Light (<40w)	<u>12</u>	x	200 Btu/h	<u>2400</u> Btu/h
No. of Special Light (>40w)		x	400 Btu/h	
No. of Refrigerator (< 6 cu.ft.)		x	400 Btu/h	
No. of Refrigerator (> 6 cu.ft.)		x	800 Btu/h	
No. of Cooking Range		x	1500 Btu/h	
No. of Laptop Computer		x	150 Btu/h	
No. of Desktop Computer	<u>4</u>	x	400 Btu/h	<u>1600</u> Btu/h
No. of Printer	<u>1</u>	x	500 Btu/h	<u>500</u> Btu/h
No. of Photocopier		x	1000 Btu/h	
Total Cooling Capacity				<u>6600</u> Btu/h

Recommended Cooling Capacity

3.5
31350 Btu/h

Note : Compressor warranty will be reduced to ____ yr. if air-conditioner purchased is lower than the recommended cooling capacity or pipe lay-out is beyond the maximum allowable length.

Scope of Work Agreement

- | | | |
|-----------------------------------|---|---|
| 1. Copper tube lay-out | <input checked="" type="checkbox"/> Expose | <input type="checkbox"/> Embedded |
| 2. Chipping | <input type="checkbox"/> Included | <input checked="" type="checkbox"/> Not Included |
| 3. Fabricated Bracket | <input checked="" type="checkbox"/> Yes <input type="checkbox"/> Shop | <input type="checkbox"/> Site <input type="checkbox"/> No |
| 4. Service Ledge | <input type="checkbox"/> Yes | <input checked="" type="checkbox"/> No |
| 5. Dismantling of existing Aircon | <input checked="" type="checkbox"/> Included | <input type="checkbox"/> Not Included |
| 6. Ducting | <input type="checkbox"/> Yes | <input checked="" type="checkbox"/> No |

Dimension :

- Plastering, carpentry and restoration works are to be done by the customer.
- Wiring of electrical supply from main panel to air-conditioning unit are to be done by the customer.
- Processing of mechanical plan, working permit, electrical permit are to be done by the customer.
- Other concern:

DISMANTLE AND REPLACE COMPRESSOR.
ADD COND AND POWER SUPPLY.
INDOOR UNIT: 14 INCHES HIGH, SAME
OF EXISTING. 3.125" O.D. - 1/2" TYPICAL
CUSTOMER PROVIDE POWER SOURCE.
EXISTING SPLITTING: 3/8" X 1/8" - 4 1/2" X 1/2"

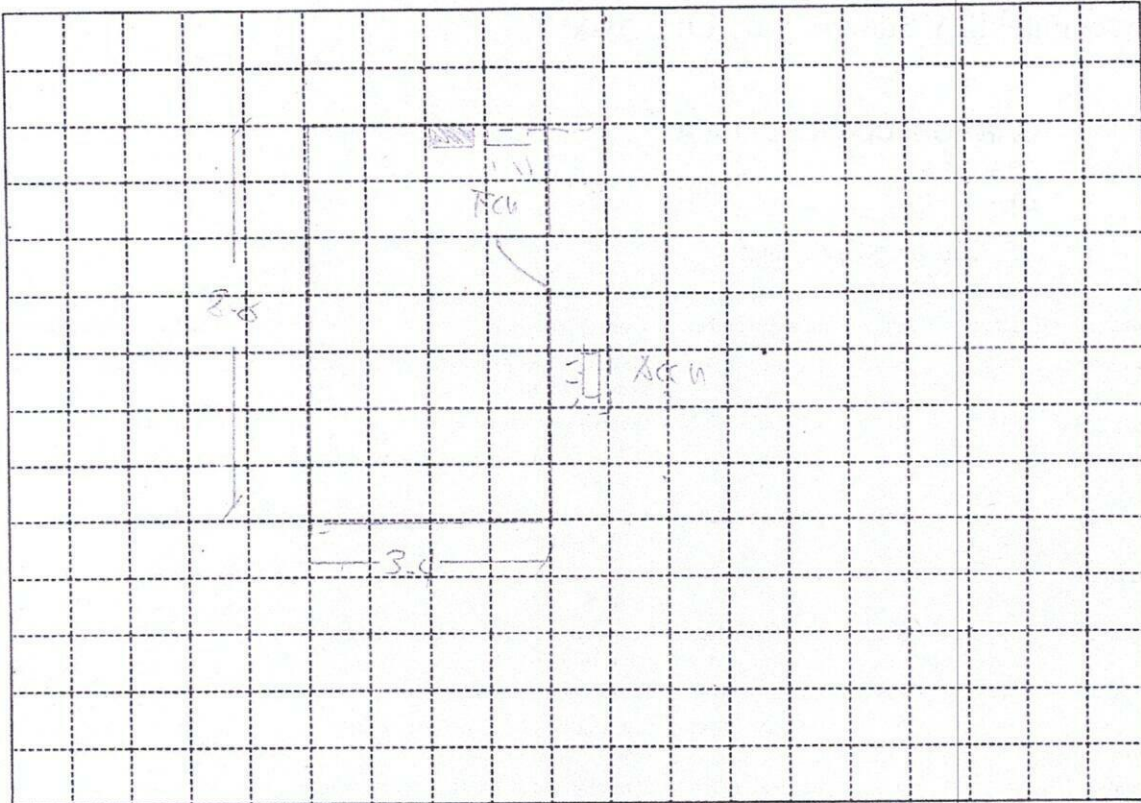

Indoor Unit Location : RIGHT SIDE OF COLUMN, SAME LOCATION
 Outdoor Unit Location : DOF OFC, SAME LOCATION -
 Pipe Length : 40 FT
 Special Note : _____

Installation Cost Estimate			
Material Description	Qty.	Unit Cost	Total Cost
Copper Tube (excess of 10 ft.) 2330, 2430, 2520, 3520, 4620	30 FT	400	12000
Wire (Royal Cord-signal wire) (excess of 10ft.) 2.0mmx4C	30 FT	700	21000
Wire (Royal Cord - Breaker to ODU) 3.5mm / 5.5mm x 3C	7 FT	60	420
Circuit Breaker 20A, 30A, 40A/1ph, 40A/3ph	1	1000	1000
Bracket (ODU) (Imptd. / Fabricated); (Floor / Wall)			1500
Bracket (WAC) Angle Type			
PVC Pipe (drain) 1/2", 3/4"			
PVC Pipe (electrical) 3/4", 1"			
Drain Pump			
Drain Pump Hose WHITE 1/2"	3 FT	45	135
Chipping Works mtr.			
Dismantling Fee (existing air-conditioner) 3 FT / FLOOR	1	3000	3000
Initial Charge			1000
TOTAL ESTIMATE		P	32,755

Note :

1. Initial Charge includes labor, 10ft. Copper tube, 10ft. Royal cord, Circuit breaker, Outdoor Bracket (SAC), Indoor Bracket (PAC) and Consumable materials.
2. Survey fee will be **deducted** in the installation fee.

Prepared by :

YECATHIA DBOIO
 Signature Over Printed Name

Customer Conforme:

RAGUEL BKEN 4/12/25
 Signature Over Printed Name