



April 8, 2025

LOPA COMPOUND DEVELOPMENT / HOUSE #4 RAPA
LOPA FARM MARILAQUE HIWAY, SITIO MAYAGAY, BRGY. SAMPALOC TANAY RIZAL
Email: mereyes@foro.ph

Dear Ma'am/Sir,

Kolin Marketing Inc., is extremely honored for your endorsement of Kolin brand and we are please to offer you with a special price/s for the following items.

A. EQUIPMENT & INSTALLATION

QTY	U/M	MODEL / DESCRIPTION	SRP	DISCOUNTED PRICE		AMOUNT
1	UNIT/S	MODEL: KSG-IWF-30WFF-8K1M32 KOLIN WALL MOUNTED PRIMUS GOLD AIRCONDITIONER 29,500 Kj/h (3.0HP) FULL DC INVERTER W/ WIFI R-32	76,595.00	51,212.20	PHP	51,212.20
1	UNIT/S	MODEL: KAG-200WCINV KOLIN WINDOW TYPE QUAD SERIES AIRCONDITIONER 19,080 Kj/h (2.0HP) FULL DC INVERTER W/ WIFI R-32 (WxDxH) 26"x28"x17"	43,595.00	31,332.20	PHP	31,332.20
3	UNIT/S	MODEL: KAG-145WCINV KOLIN WINDOW TYPE QUAD SERIES AIRCONDITIONER 13,210 Kj/h (1.5HP) FULL DC INVERTER W/ WIFI R-32 (WxDxH) 22"x28"x15"	32,995.00	23,776.20	PHP	71,328.60
TOTAL UNIT COST					PHP	153,873.00
ESTIMATED COST OF INSTALLATION (please see attached)					PHP	42,430.00
OTHERS: DELIVERY CHARGE					PHP	600.00
TOTAL ESTIMATED COST OF THE PROJECT					PHP	196,903.00

TERMS OF PAYMENT:

FULL PAYMENT OF UNIT AND DELIVERY CHARGE. IF CHECK, SUBJECT FOR 3 DAYS CLEARING.

WARRANTY:

FOR SPLIT TYPE : ONE (1) YEAR FREE PARTS AND LABOR, THREE YEARS (3) MAIN PCB , TEN (10) YEARS WARRANTY ON COMPRESSOR.

FOR WINDOW TYPE: ONE (1) YEAR FREE PARTS AND LABOR, THREE YEARS (3) MAIN PCB, TEN (10) YEARS WARRANTY ON COMPRESSOR.

NOTES: PRICES ARE SUBJECT TO CHANGE WITHOUT PRIOR NOTICE.

PRICES IS VAT INCLUSIVE.

**** Cost of Installation is Package with the Unit(s), this cost cannot avail separately (cost will be based on actual).**

We thank you for giving opportunity to offer our product and services, hoping we receive your purchase order.

If you need assistance, don't hesitate to call the under signed at 0917-807-8607 or email at kmi_asst@kolinphil.com.ph

**** SUBJECT FOR ACTUAL SITE VISIT / OCULAR ****

Very Truly Yours,

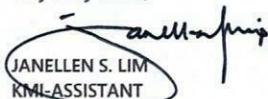
JANELLEN S. LIM
KMI-ASSISTANT

Noted by:

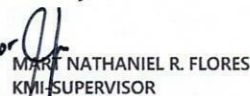
MARK NATHANIEL R. FLORES
KMI-SUPERVISOR

Approved By:



MS. EDITHA M. FLORES
AVP - FINANCE

KMI-QUOTE-04-25-0267
DCG-24%/7K/1.8K/1.3K

Conforme:

SIGNATURE OVER PRINTED NAME

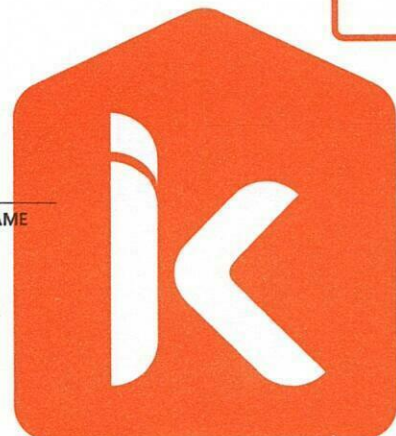
Kolin Marketing, Inc.
1854 Sta. Rita St., Guadalupe Nuevo, Makati City
Tel.: (632) 8852-6473
Fax: (632) 8852-2170 / (632) 8852-4792
 www.kolinphil.com.ph / kolinphilippines



APRIL 08, 2025

LOPA COMPOUND DEVELOPMENT/ HOUSE #4/ RAPA

Lopa Farm Marilague Hiway Sitio Mayagay, Brgy Sampaloc Tanay Rizal

MODEL	QUANTITY
KSG-IWF-30Wfy8K1M32	1
KAG-200WCINV	1
KAG-145WCINV	3

GROUND FLOOR

FOYER/LIVING AREA Area ≈ 29 sq.m

ACU 1	3.0hp Wall mounted Inverter	KSG-IWF-30Wfy8K1M32					
	Estimated Pipe Length :	50	ft				
	Estimated Royal Cord Length :	55	ft				
	Initial Charge					P	8,500.00
	Includes:						
	Labor						
	10ft Copper Tube						
	10ft Royal Cord						
	Outdoor Bracket						
	Other Consumables						
	Additional Charges	Description	Unit	Price Per Unit		Subtotal	
	Copper Tube	1/4"x 5/8"	40 ft	P 400.00 / ft	P	16,000.00	
	Royal Cord	2.mm2 x 4C	45 ft	P 100.00 / ft	P	4,500.00	
	Royal Cord (ODU-Breaker)	3.5mm2 x 3C	5 ft	P 60.00 / ft	P	300.00	
	Circuit Breaker(NEMA)	30A/ 1Ph	1 pc(s)	P 1,000.00 / pc	P	1,000.00	
	PVC(Drainline)	Blue 3/4"	2 pc(s)	P 150.00 / pc	P	300.00	
	Rubber Insulation	2 1/8"x3/4" x 6'	8 pc(s)	P 350.00 / pc	P	2,800.00	
	Full Thread	3 meters	1 pc(s)	P 150.00 / pc	P	150.00	
	Pipe hanger	3 inches	14 pc(s)	P 120.00 / pc	P	1,680.00	P 26,730.00

Estimated Charges	P 35,230.00
--------------------------	--------------------

MASTER BEDROOM Area ≈ 23.4 sq.m

ACU2	2.0hp Windowtype Inverter	KAG-200WCINV					
	Initial charge					P	1,200.00
	Angle Bracket					P	600.00
	Estimated charges					P	1,800.00

BEDROOM 2 Area ≈ 14 sq.m

ACU3	1.5hp Windowtype Inverter	KAG-145WCINV					
	Initial charge					P	1,200.00
	Angle Bracket					P	600.00
	Estimated charges					P	1,800.00

BEDROOM 1 Area ≈ 14 sq.m

ACU4	1.5hp Windowtype Inverter	KAG-145WCINV					
	Initial charge					P	1,200.00
	Angle Bracket					P	600.00
	Estimated charges					P	1,800.00

STUDIO			Area ≈ 13 sq.m
ACU5	1.5hp Windowtype Inverter	KAG-145WCINV	
Initial charge		P	1,200.00
Angle Bracket		P	600.00
Estimated charges			P 1,800.00

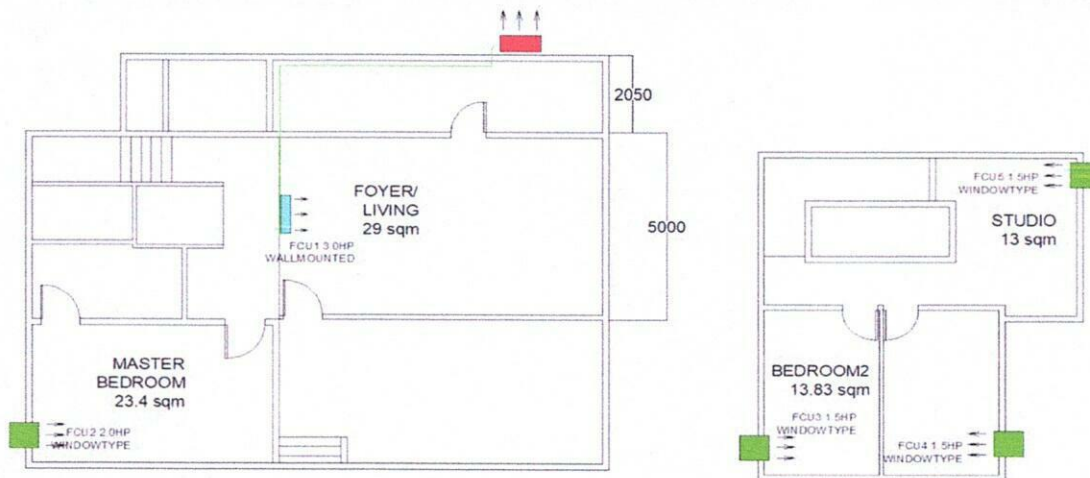

Total Estimated Charges			P 42,430.00
--------------------------------	--	--	--------------------

Validity: This quotation is valid for a period of fifteen (15) days from the date thereof, subject to our confirmation thereafter.

Note:

- 1 Location of indoor and outdoor units base in floor plan.
- 2 AC drain line will be tapped to the nearest drain provision provided by the customer's contractor.
- 3 Need for site visit before installation and for final location of units.
- 4 Customer need to cover the side of windowtype if unit is smaller than existing hole.
- 5 **Need waiver if FOYER and DINING is open area.**
- 6 KAG-145WCINV Dimension: W x D x H, = 560 X 708 x 375 mm. (22 x 28 x 15 inches)
- 7 KAG-200WCINV Dimension: W x D x H, = 660 X 700 x 428 mm. (26 x 31 x 17 inches)
- 8 Working days: Monday to Saturday, 8am- 5pm with parking. Need working permit.
- 9 Mechanical Plans, Permits, Electrical permits not included.
- 10 Deflectors, masonry, carpentry, chipping & plastering (finishing & restoration) are not included in the installation.
- 11 Electrical power supply (feeder line) **220v/ 60hz/ 1ph**, is not included in the scope of work of Kolin.
- 12 **Final charges will be based on actual installation.**

Prepared by:

Jeffrey Dadios
Field Surveyor

Reviewed by:

Engr. Kenneth Zamora
Service Supervisor
Field and Shop Operation

Customer Conformance:

Signature Over Printed Name