



February 24, 2025

D.I.P DEVELOPMENT INC.
UNIT 4016 AMINA TOWER, ALLEGRA GARDEN PLACE, PASIG BLVD., PASIG CITY
TEL#: 0920-9560805

Dear Ma'am/Sir,

Kolin Marketing Inc., is extremely honored for your endorsement of Kolin brand and we are please to offer you with a special price/s for the following items.

A. EQUIPMENT & INSTALLATION

**** OPTION 2 ****

QTY	U/M	MODEL / DESCRIPTION	SRP	DISCOUNTED PRICE		AMOUNT
1	UNIT/S	MODEL: KVM-40VAH1M-O KOLIN VERSAMATCH SERIES AIRCONDITIONER 37,980 kJ/h (4.0HP) OUTDOOR UNIT INVERTER R32	79,995.00	60,796.20	PHP	60,796.20
2	UNIT/S	MODEL: KVM-10IWAH-I KOLIN VERSAMATCH SERIES AIRCONDITIONER INVERTER 9,495 kJ/h (1.0HP) WALL MOUNTED INDOOR UNIT R32	10,995.00	8,356.20	PHP	16,712.40
1	UNIT/S	MODEL: KVM-20IWAH-I KOLIN VERSAMATCH SERIES AIRCONDITIONER INVERTER 18,990 kJ/h (2.0HP) WALL MOUNTED INDOOR UNIT R32	15,995.00	12,156.20	PHP	12,156.20
TOTAL UNIT COST					PHP	89,664.80
ESTIMATED COST OF INSTALLATION (please see attached)					PHP	67,200.00
OTHERS: DELIVERY CHARGE					PHP	600.00
TOTAL ESTIMATED COST OF THE PROJECT					PHP	157,464.80

TERMS OF PAYMENT:

FULL PAYMENT OF UNIT AND DELIVERY CHARGE. IF CHECK, SUBJECT FOR 3 DAYS CLEARING.

WARRANTY:

FOR VERSAMATCH: ONE (1) YEAR FREE PARTS AND LABOR, FIVE (5) YEARS WARRANTY ON COMPRESSOR.

NOTES: PRICES ARE SUBJECT TO CHANGE WITHOUT PRIOR NOTICE.

PRICES IS VAT INCLUSIVE.

**** Cost of Installation is Package with the Unit(s), this cost cannot avail separately (cost will be based on actual).**

We thank you for giving opportunity to offer our product and services, hoping we receive your purchase order.

If you need assistance, don't hesitate to call the under signed at 0917-807-8607 or email at kmi_asst@kolinphil.com.ph

Very Truly Yours,

JANELLEN S. LIM
KMI-ASSISTANT

Noted by:

MART NATHANIEL A. FLORES
KMI-SUPERVISOR

Approved By:

MS. EDITHA M. FLORES
AVP - FINANCE

KMI-QUOTE-02-25-0101-rev
REG-24%

Conforme:

SIGNATURE OVER PRINTED NAME

Kolin Marketing, Inc.

1854 Sta. Rita St., Guadalupe Nuevo, Makati City
Tel.: (632) 8852-6473

Fax: (632) 8852-2170 / (632) 8852-4792

 www.kolinphil.com.ph / kolinphilippines



February 24, 2025

D.I.P Development Inc.

Unit 4016 Amina Tower, Allegra Garden Place, Pasig Blvd , Pasig City

0920-9560805

MODEL	QUANTITY
KVM-40VAH1M-O	1
KVM-10IWAH-I	2
KVM-20IWAH-I	1

OPTION 2- recommendation

NURSERY/ BEDROOM/LIVING

ACCU 5.0hp Versamatch Inverter KVM-40AH1M-O

Additional Charges	Description	Unit	Price per Unit	Subtotal
Royal Cord (ODU-Breaker)	3.5mm ² x 3C	5 ft	P 60.00 / ft	P 300.00
Circuit Breaker(NEMA)	40A/ 1Ph	1 pc(s)	P 1000.00 / pc	P 1000.00
Outdoor Bracket(fabricated)	floor	1 unit	P 2500.00 / unit	P 2500.00
				P 3,800.00

Estimated Charges P 3,800.00

NURSERY

Area ≈ 4 sq.m

FCU A 1.0hp Wall Mounted Inverter KVM-10IWAH-I

Estimated Pipe Length : 30 ft
Estimated Royal Cord Length : 35 ft

Labor P 8,500.00

Includes:

Labor
10ft Copper Tube
10ft Royal Cord
Other Consumables

Additional Charges	Description	Unit	Price per Unit	Subtotal
Coppertube	1/4" x 3/8"	20 ft	P 350.00 / ft	P 7,000.00
Royal Cord	2mm ² x 4C	25 ft	P 100.00 / ft	P 2,500.00
Drain Hose	White -1/2"	5 ft	P 25.00 / ft	P 125.00
				P 9,625.00

Estimated Charges for 1st Pair P 18,125.00

BEDROOM

Area ≈ 10 sq.m

FCU B 1.0hp Wall Mounted Inverter KVM-10IWAH-I

Estimated Pipe Length : 37 ft
Estimated Royal Cord Length : 42 ft

Includes:

Labor
10ft Copper Tube
10ft Royal Cord
Other Consumables

Additional Charges	Description	Unit	Price per Unit	Subtotal
Coppertube	1/4" x 3/8"	27 ft	P 350.00 / ft	P 9450.00
Royal Cord	2mm ² x 4C	32 ft	P 100.00 / ft	P 3200.00
Drain Hose	White -1/2"	5 ft	P 25.00 / ft	P 125.00
				P 12,775.00

Estimated Charges for 2nd Unit P 21,275.00

LIVING/DINING/KITCHEN

Area ≈ 25 sq.m

FCU C 2.5hp Wall Mounted Inverter KVM-20IWAH-I

Estimated Pipe Length : 40 ft

Estimated Royal Cord Length : 45 ft

Includes:

Labor

P 8,500.00

10ft Copper Tube

10ft Royal Cord

Other Consumables

Additional Charges	Description	Unit	Price per Unit	Subtotal
Coppertube	1/4" x 5/8"	30 ft	P 400.00 / ft	P 12,000.00
Royal Cord	2mm ² x 4C	35 ft	P 100.00 / ft	P 3,500.00
Drain Hose	White -1/2"	5 ft	P 25.00 / ft	P 125.00
				P 15,500.00

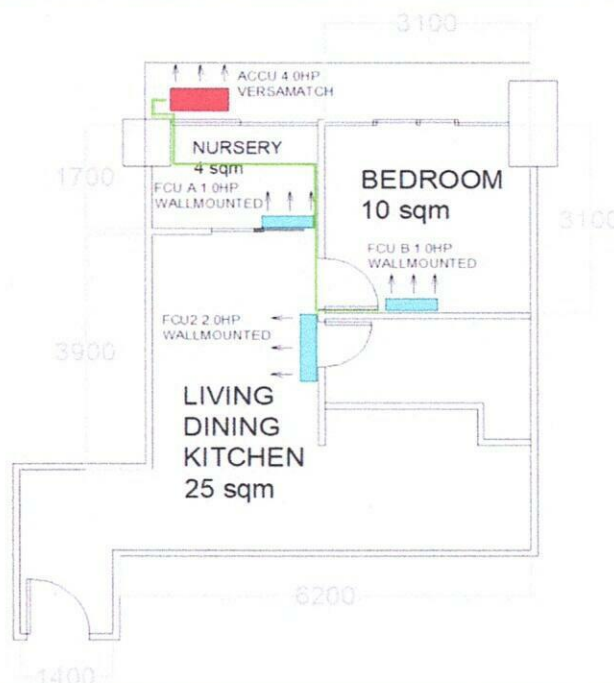
Estimated Charges for 3rd Unit**P 24,000.00****Total Estimated Charges****P 67,200.00**

Validity: This quotation is valid for a period of fifteen (15) days from the date thereof, subject to our confirmation thereafter.

Note:

- 1 Location of indoor and outdoor units agree by customer and kolin surveyor. Unit recommendation for verification of admin
- 2 AC drain line will be tapped to the nearest drain provision provided by the customer's contractor.
- 3 Outdoor Bracket fabricated at shop bring to site. Floor with second layer for ACCU1.
- 4 Schedule for markings first for pipe layout and use drain clean out to fit the unit.
- 5 Expose coppertube in the area, Customer will cover the coppertube after installation.
- 6 Working days: Monday to Saturday, 8am - 5pm. Without parking, need working permit.
- 7 Mechanical Plans, Permits, Electrical permits not included.
- 8 Deflectors, masonry, carpentry, chipping & plastering (finishing & restoration) are not included in the installation.
- 9 Electrical power supply (feeder line) is not included in the scope of work of Kolin.
- 10 Final charges will be based on actual installation.

Prepared by:

Jeffrey Dadios

Field Surveyor

Customer Conformance:

Signature Over Printed Name

Reviewed by:

Engr. Kenneth Zamora

Service Supervisor

Field and Shop Operation