



March 27, 2025

MR. BENJAMIN BAUTISTA  
UNIT D6, LANUZA AVE, CASA VERDE TOWNHOMES, BRGY. UGONG PASIG CITY  
Email: pmgbautista@outlook.com

Dear Ma'am/Sir,

Kolin Marketing Inc., is extremely honored for your endorsement of Kolin brand and we are please to offer you with a special price/s for the following items.

A. EQUIPMENT & INSTALLATION

**\*\* OPTION 2**

QTY	U/M	MODEL / DESCRIPTION	SRP	DISCOUNTED PRICE		AMOUNT
1	UNIT/S	MODEL: KLG-IF40-5G1M32 KOLIN FLOOR MOUNTED AIRCONDITIONER 37,980 Kj/h (3.0TR) FULL DC INVERTER R-32 SINGLE PHASE	113,195.00	79,028.20	PHP	79,028.20
1	UNIT/S	MODEL: KSM-IW20-WCT10M1M32 KOLIN WALL MOUNTED CERTUS SERIES AIRCONDITIONER 18,990 Kj/h (2.0HP) REGULAR INVERTER R-32	41,995.00	27,916.20	PHP	27,916.20
2	UNIT/S	MODEL: KAM-150DRC32 KOLIN WINDOW TYPE REGULAR COMPACT AIRCONDITIONER 12,660 Kj/h (1.5HP) NON-INVERTER WITH REMOTE R-32 (WxDxH) 17.7"x23"x13.6"	22,495.00	16,096.20	PHP	32,192.40
TOTAL UNIT COST					PHP	139,136.80
ESTIMATED COST OF INSTALLATION (please see attached)					PHP	55,685.00
OTHERS: DELIVERY CHARGE					PHP	600.00
TOTAL ESTIMATED COST OF THE PROJECT					PHP	195,421.80

TERMS OF PAYMENT:

FULL PAYMENT OF UNIT AND DELIVERY CHARGE. IF CHECK, SUBJECT FOR 3 DAYS CLEARING.

WARRANTY:

FOR FLOOR MOUNTED: ONE (1) YEAR FREE PARTS AND LABOR, FIVE (5) YEARS WARRANTY ON COMPRESSOR.

FOR SPLIT TYPE : ONE (1) YEAR FREE PARTS AND LABOR, THREE YEARS (3) MAIN PCB , TEN (10) YEARS WARRANTY ON COMPRESSOR.

FOR WINDOW TYPE: ONE (1) YEAR FREE PARTS AND LABOR, THREE YEARS (3) MAIN PCB, TEN (10) YEARS WARRANTY ON COMPRESSOR.

NOTES: PRICES ARE SUBJECT TO CHANGE WITHOUT PRIOR NOTICE.

PRICES IS VAT INCLUSIVE.

**\*\* Cost of Installation is Package with the Unit(s), this cost cannot avail separately (cost will be based on actual).**

We thank you for giving opportunity to offer our product and services, hoping we receive your purchase order.

If you need assistance, don't hesitate to call the under signed at 0917-807-8607 or email at kmi\_asst@kolinphil.com.ph

Very Truly Yours,

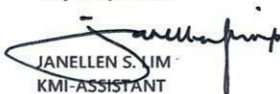
  
JANELLEN S. JIM  
KMI-ASSISTANT

Noted by:  
  
MARLYNETHA M. FLORES  
KMI-SUPERVISOR

Approved By:  
  
MS. EDITHA M. FLORES  
AVP - FINANCE

KMI-QUOTE-03-25-0234  
ECY-24%/7K/4K/1K

Conforme: \_\_\_\_\_  
SIGNATURE OVER PRINTED NAME



Kolin Marketing, Inc.  
1854 Sta. Rita St., Guadalupe Nuevo, Makati City  
Tel.: (632) 8852-6473  
Fax: (632) 8852-2170 / (632) 8852-4792  
 www.kolinphil.com.ph / kolinphilippines

March 26, 2025

**BENJAMIN BAUTISTA**

Unit D6, Lanuza Ave, Casa Verde Townhomes, Brgy Ugong Pasig City

0917-8269939

[pmgbautista@outlook.com](mailto:pmgbautista@outlook.com)

MODEL	QUANTITY
KLG-IF40-5G1M32	1
KSM-IW20-WCT10M1M32	1
KAM-150DRC32	2

OPTION 2- regular windowtype & wallmounted

GROUND FLOOR

<b>LIVING</b>	Area ≈ 42 sq.m
---------------	----------------

<b>ACU 1</b>	<b>4.0hp Floor mounted Inverter</b>	<b>KLG-IF40-5G1M32</b>	
	Estimated Pipe Length :	33	ft
	Estimated Royal Cord Length :	40	ft
	Initial Charge		P 11,000.00

Includes:

Labor

10ft Copper Tube

10ft Royal Cord

Indoor Bracket

Other Consumables

Additional Charges	Description	Unit	Price Per Unit	Subtotal
Copper Tube	3/8"x 5/8"	23 ft	P 400.00 / ft	P 9,200.00
Royal Cord	2.mm2 x 4C	30 ft	P 100.00 / ft	P 3,000.00
Royal Cord (ODU-Breaker)	5.5mm2 x 3C	7 ft	P 70.00 / ft	P 490.00
Circuit Breaker(NEMA)	40A/ 1Ph	1 pc(s)	P 1,000.00 / pc	P 1,000.00
Outdoor Bracket(wall)	fabricated	1 pc(s)	P 5,000.00 / pc	P 5,000.00
Dismantle	4.0hp	1 pc(s)	P 3,000.00 / pc	P 3,000.00
Scaffoldings	3sets	1 pc(s)	P 1,500.00 / pc	P 1,500.00
Drain Hose	White -1/2"	7 ft	P 25.00 / ft	P 175.00
				P 23,365.00

<b>Estimated Charges</b>	<b>P 34,365.00</b>
--------------------------	--------------------

SECOND FLOOR

<b>BEDROOM 3</b>	Area ≈ 16 sq.m
------------------	----------------

<b>ACU2</b>	<b>1.5hp Windowtype Regular</b>	<b>KAM-150DRC32</b>	
	Initial charge		P 1,200.00
	Angle Bracket		P 600.00

<b>Estimated charges</b>	<b>P 1,800.00</b>
--------------------------	-------------------

<b>BEDROOM 2</b>	Area ≈ 16 sq.m
------------------	----------------

<b>ACU3</b>	<b>1.5hp Windowtype Regular</b>	<b>KAM-150DRC32</b>	
	Initial charge		P 1,200.00
	Angle Bracket		P 600.00

<b>Estimated charges</b>	<b>P 1,800.00</b>
--------------------------	-------------------

<b>MASTER BEDROOM</b>	Area ≈ 20 sq.m
-----------------------	----------------

<b>ACU 4</b>	<b>2.0hp Wallmounted Inverter</b>	<b>KSM-IW20-WCT10M1M32</b>	
	Estimated Pipe Length :	27	ft
	Estimated Royal Cord Length :	34	ft
	Initial Charge		P 7,500.00

Includes:

Labor

10ft Copper Tube

10ft Royal Cord

Outdoor Bracket (wall)

Other Consumables

Additional Charges	Description	Unit	Price Per Unit	Subtotal
Copper Tube	1/4"x 1/2"	17 ft	P 350.00 / ft	P 5,950.00
Royal Cord	2.mm2 x 4C	24 ft	P 100.00 / ft	P 2,400.00
Royal Cord (ODU-Breaker)	3.5mm2 x 3C	7 ft	P 60.00 / ft	P 420.00
Circuit Breaker(NEMA)	30A/ 1Ph	1 pc(s)	P 1,000.00 / pc	P 1,000.00
PVC(Drainline)	Blue 3/4"	3 pc(s)	P 150.00 / pc	P 450.00
				P 10,220.00

<b>Estimated Charges</b>	<b>P 17,720.00</b>
--------------------------	--------------------



GROUND FLOOR

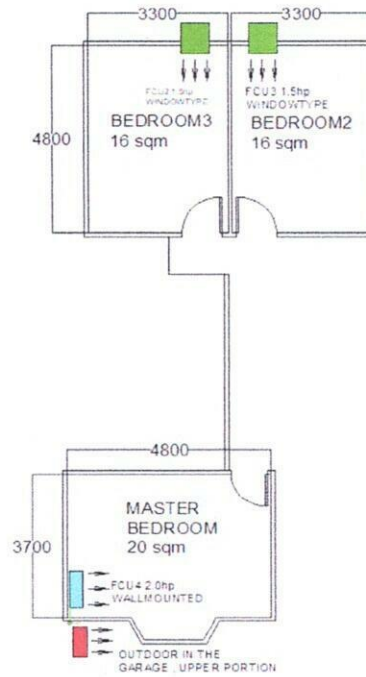

SECOND FLOOR

Total Estimated Charges

P 55,685.00

Validity: This quotation is valid for a period of fifteen (15) days from the date thereof, subject to our confirmation thereafter.

**Note:**

- 1 Location of indoor and outdoor units were agreed by the customer and Kolin's surveyor.
- 2 AC drain line will be tapped to the nearest drain provision provided by the customer's contractor.
- 3 Need for site visit before installation and for final location of unit for **ACU4. MASTER BEDROOM**
- 4 KAM-150DRC37 Dimension: W x D x H, = 450 X 585 x 346 mm. (17.7 x 21 x 13.6 inches)
- 5 Customer need to cover the side of windowtype if unit is smaller than existing hole.
- 6 Working days: Monday to Saturday, 8am- 5pm with parking. Need working permit.
- 7 Mechanical Plans, Permits, Electrical permits not included.
- 8 Deflectors, masonry, carpentry, chipping & plastering (finishing & restoration) are not included in the installation.
- 9 Electrical power supply (feeder line) **220v/ 60hz/ 1ph** , is not included in the scope of work of Kolin.
- Transfer power Supply to new location.**
- 10 Final charges will be based on actual installation.

Prepared by:

**Jeffrey Dadios**  
Field Surveyor

Customer Conformer:

Signature Over Printed Name

Reviewed by:

**Engr. Kenneth Zamora**  
Service Supervisor  
Field and Shop Operation