



May 9, 2025

MR. JOHN CHRISTOPHER CHONGSON  
24 ROOSEVELT ST., GREENHILLS WEST, BRGY. GREENHILLS SAN JUAN CITY  
TEL#: 0921-9616539

Dear Ma'am/Sir,

Kolin Marketing Inc., is extremely honored for your endorsement of Kolin brand and we are please to offer you with a special price/s for the following items.

A. EQUIPMENT & INSTALLATION

QTY	U/M	MODEL / DESCRIPTION	SRP	DISCOUNTED PRICE		AMOUNT
2	UNIT/S	MODEL: KLM-IS40-AA1M32 KOLIN CEILING CASSETTE AIRCONDITIONER 37,980 Kj/h (3.0TR) DC INVERTER R-32 SINGLE PHASE	119,995.00	91,196.20	PHP	182,392.40
TOTAL UNIT COST					PHP	182,392.40
ESTIMATED COST OF INSTALLATION (please see attached)					PHP	101,480.00
OTHERS: DELIVERY CHARGE					PHP	600.00
TOTAL ESTIMATED COST OF THE PROJECT					PHP	284,472.40

TERMS OF PAYMENT:

FULL PAYMENT OF UNIT AND DELIVERY CHARGE. IF CHECK, SUBJECT FOR 3 DAYS CLEARING.

WARRANTY:

FOR CEILING CASSETTE (Inverter): ONE (1) YEAR FREE PARTS AND LABOR, FIVE (5) YEARS WARRANTY ON COMPRESSOR.

NOTES: PRICES ARE SUBJECT TO CHANGE WITHOUT PRIOR NOTICE.

PRICES IS VAT INCLUSIVE.

**\*\* Cost of Installation is Package with the Unit(s), this cost cannot avail separately (cost will be based on actual works).**

We thank you for giving opportunity to offer our product and services, hoping we receive your purchase order.

If you need assistance, don't hesitate to call the under signed at 0917-807-8607 or email at [kmi\\_asst@kolinphil.com.ph](mailto:kmi_asst@kolinphil.com.ph)

Very Truly Yours,

JANELLEN S. NM  
KMI-ASSISTANT

Noted by:

MART NATHANIEL R. FLORES  
KMI-SUPERVISOR

Approved By:

MS. EDITHA M. FLORES  
AVP - FINANCE

KMI-QUOTE-05-25-0370  
REG-24%

Conforme:

SIGNATURE OVER PRINTED NAME

Kolin Marketing, Inc.  
1854 Sta. Rita St., Guadalupe Nuevo, Makati City  
Tel.: (632) 8852-6473  
Fax: (632) 8852-2170 / (632) 8852-4792  
[www.kolinphil.com.ph](http://www.kolinphil.com.ph) / [kolinphilippines](http://kolinphilippines)



MAY 08, 2025

JOHN CHRISTOPHER CHONGSON

24 Roosevelt St. Greenhills West, Brgy Greenhills, San Juan City

0921-9616-539

MODEL	QUANTITY
KLM-IS40-AA1M32-I	2

LIVING AREA	Area ≈ 120 sq.m
-------------	-----------------

ACU 1 4.0hp Ceiling Cassette Inverter KLM-IS40-AA1M32-I

Estimated Pipe Length : 70 ft

Estimated Royal Cord Length : 77 ft

Initial Charge P 12,000.00

Includes:

Labor

10ft Copper Tube

10ft Royal Cord

Other Consumables

Additional Charges	Description	Unit	Price Per Unit	Subtotal
Copper Tube	3/8"x 5/8"	60 ft	P 400.00 / ft	P 24,000.00
Royal Cord	2.mm2 x 4C	67 ft	P 100.00 / ft	P 6,700.00
Royal Cord (ODU-Breaker)	5.5mm2 x 3C	7 ft	P 70.00 / ft	P 490.00
Circuit Breaker(NEMA)	40A/ 1Ph	1 pc(s)	P 1,000.00 / pc	P 1,000.00
Rubber Insulation	2 1/8"x3/4" x 6'	9 pc(s)	P 350.00 / pc	P 3,150.00
Dismantle	4hp Ceiling	1 set	P 3,500.00 / pc	P 3,500.00
Indoor Bracket	fabricated	1 pc(s)	P 1,500.00 / pc	P 1,500.00
Outdoor Bracket(modify)	fabricated	1 pc(s)	P 1,500.00 / pc	P 1,500.00
Drain Hose	White -1/2"	7 ft	P 25.00 / ft	P 175.00
				P 42,015.00

Estimated Charges	P 54,015.00
-------------------	-------------

ACU 2 4.0hp Ceiling Cassette Inverter KLM-IS40-AA1M32-I

Estimated Pipe Length : 56 ft

Estimated Royal Cord Length : 63 ft

Initial Charge P 12,000.00

Includes:

Labor

10ft Copper Tube

10ft Royal Cord

Other Consumables

Additional Charges	Description	Unit	Price Per Unit	Subtotal
Copper Tube	3/8"x 5/8"	46 ft	P 400.00 / ft	P 18,400.00
Royal Cord	2.mm2 x 4C	53 ft	P 100.00 / ft	P 5,300.00
Royal Cord (ODU-Breaker)	5.5mm2 x 3C	7 ft	P 70.00 / ft	P 490.00
Circuit Breaker(NEMA)	40A/ 1Ph	1 pc(s)	P 1,000.00 / pc	P 1,000.00
Rubber Insulation	2 1/8"x3/4" x 6'	6 pc(s)	P 350.00 / pc	P 2,100.00
Indoor Bracket	fabricated	1 pc(s)	P 1,500.00 / pc	P 1,500.00
Outdoor Bracket(modify)	fabricated	1 pc(s)	P 1,500.00 / pc	P 1,500.00
Dismantle	4hp Ceiling	1 set	P 3,500.00 / pc	P 3,500.00
Scaffoldings	4sets	1 set	P 1,500.00 / pc	P 1,500.00
Drain Hose	White -1/2"	7 ft	P 25.00 / ft	P 175.00
				P 35,465.00

Estimated Charges	P 47,465.00
-------------------	-------------

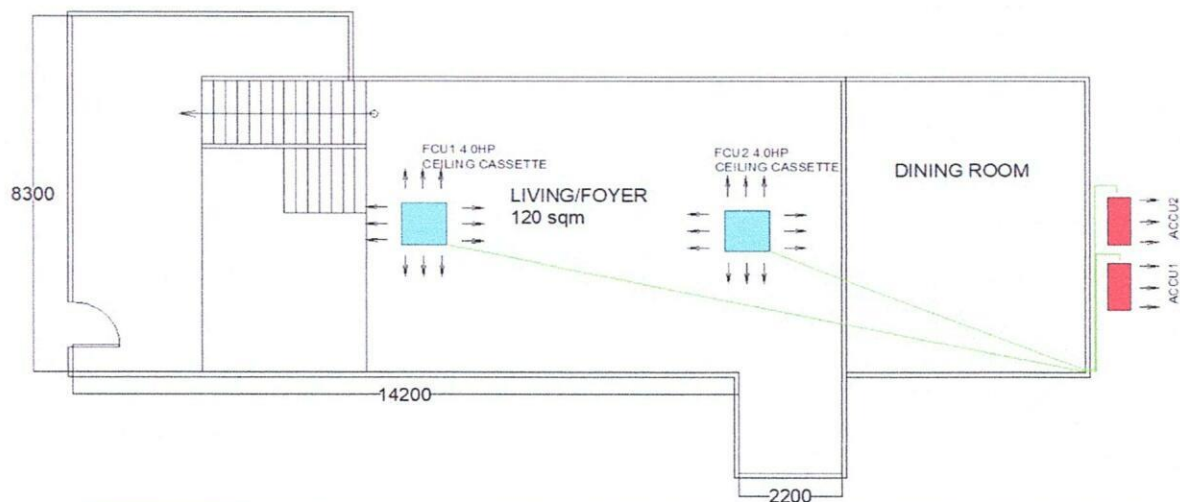

**Validity:** This quotation is valid for a period of fifteen (15) days from the date thereof, subject to our confirmation thereafter.

**Note:**

- 1 Location of indoor and outdoor are not yet final for approval of customer. Recommendation only
- 2 AC drain line will be tapped to the nearest drain provision provided by the customer's contractor.
- 3 Need for marking and site visit before installation for final location.
- 4 Copper tube going inside the ceiling. need carpentry works for indoor location to fit the new units.
- 5 Working days: Monday to Saturday, 8am- 5pm with parking. Need working permit.
- 6 Mechanical Plans, Permits, Electrical permits not included.
- 7 Deflectors, masonry, carpentry, chipping & plastering (finishing & restoration) are not included in the installation.
- 8 Electrical power supply (feeder line) **220v/ 60hz/ 1ph** is not included in the scope of work of Kolin.
- 9 Final charges will be based on actual installation.

Prepared by:

Jeffrey Dadios

Field Surveyor

Customer Conformer:

Signature Over Printed Name

Reviewed by:

Engr. Kenneth Zamora

Service Supervisor  
Field and Shop Operation