



October 14, 2025

MR. BIT SANTOS  
10 ROXAS ST., XAVIERVILLE 3 SUBD., BRGY. LOYOLA HEIGHTS, QUEZON CITY  
TEL#: 0917-5790719

Dear Ma'am/Sir,

Kolin Marketing Inc., is extremely honored for your endorsement of Kolin brand and we are please to offer you with a special price/s for the following items.

A. EQUIPMENT & INSTALLATION

\* OPTION 1 \*

QTY	U/M	MODEL / DESCRIPTION	SRP	DISCOUNTED PRICE		AMOUNT
2	UNIT/S	MODEL: KSG-IWF-25WFF-8K1M32 KOLIN WALL MOUNTED PRIMUS GOLD AIRCONDITIONER 25,560 Kj/h (2.5HP) FULL DC INVERTER W/ WIFI R-32	68,995.00	45,436.20	PHP	90,872.40
2	UNIT/S	MODEL: KSG-IWF-20WFF-8K1M32 KOLIN WALL MOUNTED PRIMUS GOLD AIRCONDITIONER 19,000 Kj/h (2.0HP) FULL DC INVERTER W/ WIFI R-32	59,595.00	38,292.20	PHP	76,584.40
1	UNIT/S	MODEL: KAG-200WCINV KOLIN WINDOW TYPE QUAD SERIES AIRCONDITIONER 19,080 Kj/h (2.0HP) FULL DC INVERTER W/ WIFI R-32 (WxDxH) 26"x28"x17"	43,595.00	31,332.20	PHP	31,332.20
2	UNIT/S	MODEL: KAG-145WCINV KOLIN WINDOW TYPE QUAD SERIES AIRCONDITIONER 13,210 Kj/h (1.5HP) FULL DC INVERTER W/ WIFI R-32 (WxDxH) 22"x28"x15"	32,995.00	23,776.20	PHP	47,552.40
1	UNIT/S	MODEL: KAG-100WCINV KOLIN WINDOW TYPE QUAD SERIES AIRCONDITIONER 10,200 Kj/h (1.0HP) FULL DC INVERTER W/ WIFI R-32 (WxDxH) 18"x25"x14"	28,995.00	20,736.20	PHP	20,736.20
TOTAL UNIT COST					PHP	267,077.60
ESTIMATED COST OF INSTALLATION (please see attached)					PHP	62,910.00
OTHERS: DELIVERY CHARGE					PHP	600.00
TOTAL ESTIMATED COST OF THE PROJECT					PHP	330,587.60

TERMS OF PAYMENT:

FULL PAYMENT OF UNIT AND DELIVERY CHARGE. IF CHECK, SUBJECT FOR 3 DAYS CLEARING.

WARRANTY:

FOR SPLIT TYPE: ONE (1) YEAR FREE PARTS AND LABOR, THREE YEARS (3) MAIN PCB, TEN (10) YEARS WARRANTY ON COMPRESSOR.  
FOR WINDOW TYPE: ONE (1) YEAR FREE PARTS AND LABOR, THREE YEARS (3) MAIN PCB, TEN (10) YEARS WARRANTY ON COMPRESSOR.

NOTES: PRICES ARE SUBJECT TO CHANGE WITHOUT PRIOR NOTICE.

PRICES IS VAT INCLUSIVE.

\*\* Cost of Installation is Package with the Unit(s), this cost cannot avail separately (cost will be based on actual works).

\*\*\* You may settle first payment for unit/s & delivery. Installation payment can be settled directly to installer after actual works.

We thank you for giving opportunity to offer our product and services, hoping we receive your purchase order.

If you need assistance, don't hesitate to call the under signed at 0917-807-8607 or email at kmi\_asst@kolinphil.com.ph

Very Truly Yours,

JANELLEN S. LIM  
KMI-ASSISTANT

Noted By:  
MARY ANN DANIEL R. FLORES  
KMI-SUPERVISOR

Approved By:  
MS. EDITHA M. FLORES  
AVP - FINANCE

KMI-QUOTE-10-25-0744  
REG-24%/7K/1.8K/1.3K

Conforme: \_\_\_\_\_  
SIGNATURE OVER PRINTED NAME

Kolin Marketing, Inc.  
1854 Sta. Rita St., Guadalupe Nuevo, Makati City  
Tel.: (632) 8852-6473  
Fax: (632) 8852-2170 / (632) 8852-4792  
www.kolinphil.com.ph / kolinphilippines



October 14, 2025  
 BIT SANTOS  
 10 Roxas St. Xavierville 3 Subd. Brgy Loyola Heights, Quezon City  
 0917-5790719

MODEL	Qty
KSG-IWF-25WFY8K1M32	2
KSG-IWF-20WFY8K1M32	2
KAG-200WCINV	1
KAG-145WCINV	2
KAG-100WCINV	1

OPTION 1  
**GROUND FLOOR**

<b>GUESTROOM</b>	Area	11 sqm
------------------	------	--------

ACU 1 1.0 HP Window type Inverter *KAG-100WCINV*  
 Initial Charge ₱ 1,200.00

Includes:

Labor

Consumables

Installation Materials	Description	Qty	Price per qty	Subtotal
Window type bracket		1 pc/s	₱ 600.00/pc	₱ 600.00
Drain Hose	White -1/2"	7 ft	₱ 25.00/ft	₱ 175.00
				<u>₱ 775.00</u>

<b>Estimated Charges</b>	<b>₱ 1,975.00</b>
--------------------------	-------------------

<b>DINING AREA</b>	Area	23 sqm
--------------------	------	--------

ACU 2 2.5 HP Wall Mounted Inverter *KSG-IWF-25WFY8K1M32*  
 Estimated Pipe Length = 30 ft  
 Estimated Royal Cord Length = 35 ft  
 Initial Charge ₱ 8,500.00

Includes:

Labor

10ft Copper Tube

10ft Royal Cord

Outdoor Bracket (Wall)

Consumables

Installation Materials	Description	Qty	Price per qty	Subtotal
Royal Cord (comm. wire)	2.mm2 x 4C	25 ft	₱ 100.00/ft	₱ 2,500.00
Royal Cord (ACCU-Breaker)	3.5mm x 3c	5 ft	₱ 60.00/ft	₱ 300.00
Circuit Breaker waterproof	30A / 1Ph	1 pc/s	₱ 1,000.00/pc	₱ 1,000.00
Rubber Insulation	2 1/8" x 3/4" x 6'	2 pc/s	₱ 350.00/pc	₱ 700.00
Full thread	3/8" x 10'	2 pc/s	₱ 150.00/pc	₱ 300.00
Metal Clamp	3"	4 pc/s	₱ 120.00/pc	₱ 480.00
PVC blue	3/4" x 10'	2 pc/s	₱ 150.00/pc	₱ 300.00
				<u>₱ 5,580.00</u>

<b>Estimated Charges</b>	<b>₱ 14,080.00</b>
--------------------------	--------------------





**OFFICE/FAMILY ROOM**

Area 36 sqm

**ACU 6 2.0 HP Wall Mounted Inverter****KSG-IWF-20Wfy8K1M32**

Estimated Pipe Length = 14 ft

Estimated Royal Cord Length = 19 ft

**Initial Charge**

₱ 7,500.00

Includes:

Labor

10ft Copper Tube

10ft Royal Cord

Outdoor Bracket (Wall)

Consumables

**Installation Materials**

	Description	Qty	Price per qty	Subtotal
Copper Tube	Ø 1/4" x Ø 1/2"	4 ft	₱ 350.00/ft	₱ 1,400.00
Royal Cord (comm. wire)	2.mm2 x 4C	9 ft	₱ 100.00/ft	₱ 900.00
Royal Cord (ACCU-Breaker)	3.5mm x 3c	5 ft	₱ 60.00/ft	₱ 300.00
Circuit Breaker waterproof	30A / 1Ph	1 pc/s	₱ 1,000.00/pc	₱ 1,000.00
PVC blue	3/4" x 10'	3 pc/s	₱ 150.00/pc	₱ 450.00
				<u>₱ 4,050.00</u>

**Estimated Charges**

₱ 11,550.00

**ACU 7 2.0 HP Wall Mounted Inverter****KSG-IWF-20Wfy8K1M32**

Estimated Pipe Length = 20 ft

Estimated Royal Cord Length = 27 ft

**Initial Charge**

₱ 7,500.00

Includes:

Labor

10ft Copper Tube

10ft Royal Cord

Outdoor Bracket (Wall)

Consumables

**Installation Materials**

	Description	Qty	Price per qty	Subtotal
Royal Cord (comm. wire)	2.mm2 x 4C	17 ft	₱ 100.00/ft	₱ 1,700.00
Royal Cord (ACCU-Breaker)	3.5mm x 3c	5 ft	₱ 60.00/ft	₱ 300.00
Circuit Breaker waterproof	30A / 1Ph	1 pc/s	₱ 1,000.00/pc	₱ 1,000.00
PVC blue	3/4" x 10'	2 pc/s	₱ 150.00/pc	₱ 300.00
				<u>₱ 3,300.00</u>

**Estimated Charges**

₱ 10,800.00

<b>MASTER BEDROOM</b>				Area	21.6 sqm
ACU 8	2.0 HP Window type Inverter	<b>KAG-200WCINV</b>			
	Initial Charge				₱ 1,200.00
	Includes:				
	Labor				
	Consumables				
	<b>Installation Materials</b>	<b>Description</b>	<b>Qty</b>	<b>Price per qty</b>	<b>Subtotal</b>
	Window type bracket		1 pc/s	₱ 600.00/pc	₱ 600.00
	Drain Hose	White -1/2"	7 ft	₱ 25.00/ft	₱ 175.00
<b>Estimated Charges</b>					₱ 1,975.00
<b>Total Estimated Charges</b>					₱ 62,910.00

**Validity:** This quotation is valid for a period of fifteen (15) days from the date thereof, subject to our confirmation thereafter.

**Installation notes:**

- 1 Location based in floor plan. Recommendation not yet final.
- 2 AC drain line will be tapped to the nearest drain provision provided by the customer's contractor.
- 3 Need for markings of each units and site visit before installation.need to open the ceiling.
- 4 KAG-100WCINV Dimension: W x D x H, = 450 X 640 x 350 mm. (18 x 25 x 14 inches)
- 5 KAG-145WCINV Dimension: W x D x H, = 560 X 708 x 375 mm. (22 x 28 x 15 inches)
- 6 KAG-200WCINV Dimension: W x D x H, = 660 X 700 x 428 mm. (26 x 28 x 17 inches)
- 7 Working days: Monday to Saturday, 8am- 5pm with parking.Need working permit.
- 8 Mechanical Plans, Permits, Electrical permits not included.
- 9 Deflectors, masonry, carpentry, chipping & plastering (finishing & restoration) are not included in the installation.
- 10 Air conditioning drain line and Electrical power supply (feeder line) **220v/ 60hz/ 1ph** , should be provided by customer's contractor.
- 11 **Final charges will be based on actual installation.**

Prepared by:

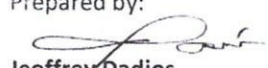
  
**Jeffrey Dadios**

Field Surveyor

Customer Conformance:

\_\_\_\_\_  
Signature Over Printed Name

Reviewed by:

  
**Engr. Kenneth Zamora**

Service Supervisor Shop and  
Field Operation

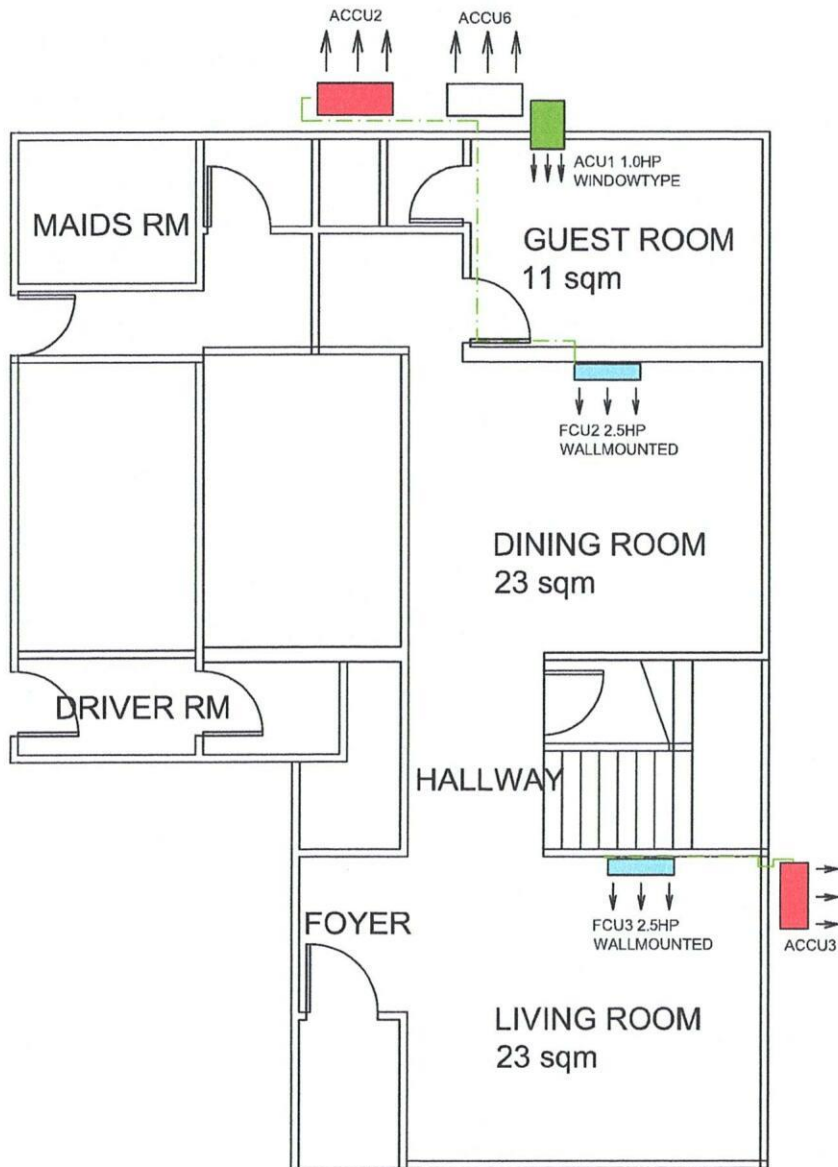

GROUND FLOOR

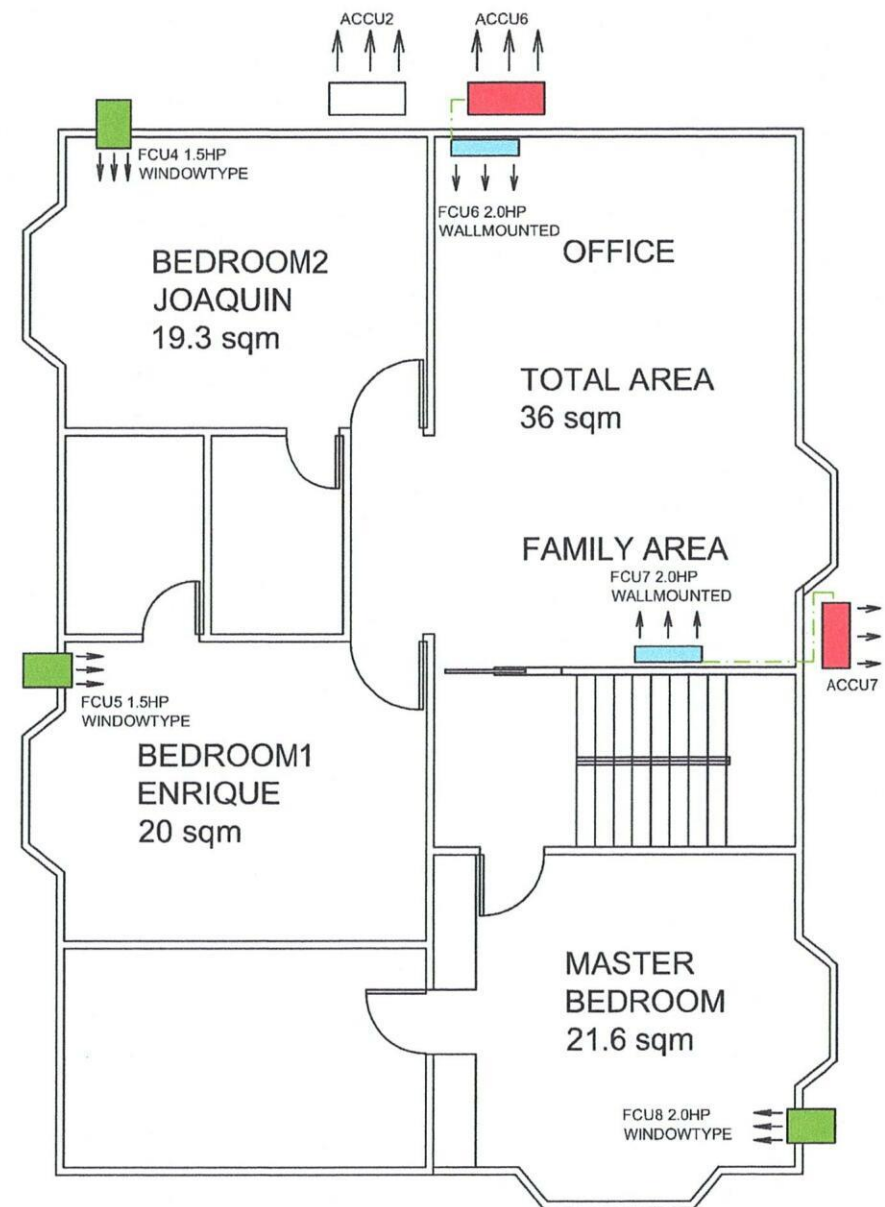

SECOND FLOOR