



April 10, 2025

LOPA COMPOUND DEVELOPMENT / HOUSE #3 TINAY
LOPA FARM MARILAQUE HIWAY, SITIO MAYAGAY, BRGY. SAMPALOC TANAY RIZAL
Email: mereyes@foro.ph

Dear Ma'am/Sir,

Kolin Marketing Inc., is extremely honored for your endorsement of Kolin brand and we are please to offer you with a special price/s for the following items.

A. EQUIPMENT & INSTALLATION

QTY	U/M	MODEL / DESCRIPTION	SRP	DISCOUNTED PRICE		AMOUNT
1	UNIT/S	MODEL: KSG-IWF-30WY-8K1M32 KOLIN WALL MOUNTED PRIMUS GOLD AIRCONDITIONER 29,500 Kj/h (3.0HP) FULL DC INVERTER W/ WIFI R-32	76,595.00	51,212.20	PHP	51,212.20
1	UNIT/S	MODEL: KA-200MCARINV32 KOLIN WINDOW TYPE CREO SERIES AIRCONDITIONER 19,800 Kj/h (2.0HP) FULL DC INVERTER R-32 WITH REMOTE (WxDxH) 26"x30.7"x16.8"	36,995.00	26,916.20	PHP	26,916.20
1	UNIT/S	MODEL: KA-150MCARINV32 KOLIN WINDOW TYPE CREO SERIES AIRCONDITIONER 12,800 Kj/h (1.5HP) FULL DC INVERTER R-32 WITH REMOTE (WxDxH) 17.7"x26.6"x13.8"	27,995.00	20,276.20	PHP	20,276.20
TOTAL UNIT COST					PHP	98,404.60
ESTIMATED COST OF INSTALLATION (please see attached)					PHP	32,210.00
OTHERS: DELIVERY CHARGE					PHP	600.00
TOTAL ESTIMATED COST OF THE PROJECT					PHP	131,214.60

TERMS OF PAYMENT:

FULL PAYMENT OF UNIT AND DELIVERY CHARGE. IF CHECK, SUBJECT FOR 3 DAYS CLEARING.

WARRANTY:

FOR SPLIT TYPE : ONE (1) YEAR FREE PARTS AND LABOR, THREE YEARS (3) MAIN PCB , TEN (10) YEARS WARRANTY ON COMPRESSOR.

FOR WINDOW TYPE: ONE (1) YEAR FREE PARTS AND LABOR, THREE YEARS (3) MAIN PCB, TEN (10) YEARS WARRANTY ON COMPRESSOR.

NOTES: PRICES ARE SUBJECT TO CHANGE WITHOUT PRIOR NOTICE.

PRICES IS VAT INCLUSIVE.

**** Cost of Installation is Package with the Unit(s), this cost cannot avail separately (cost will be based on actual).**

We thank you for giving opportunity to offer our product and services, hoping we receive your purchase order.

If you need assistance, don't hesitate to call the under signed at 0917-807-8607 or email at kmi_asst@kolinphil.com.ph

**** SUBJECT FOR ACTUAL SITE VISIT / OCULAR ****

Very Truly Yours,

JANELLEN S. LIM
KMI-ASSISTANT

Noted by:

MART NATHANIEL R. FLORES
KMI-SUPERVISOR

Approved By:

MS. EDITHA M. FLORES
AVP - FINANCE

KMI-QUOTE-04-25-0266-rev
DCG-24%/7K/1.2K/1K

Conforme: _____
SIGNATURE OVER PRINTED NAME



APRIL 08, 2025

LOPA COMPOUND DEVELOPMENT/ HOUSE #3 TINAY

Lopa Farm Marilaque Hiway Sitio Mayagay, Brgy Sampaloc Tanay Rizal

MODEL	QUANTITY
KSG-IWF-30Wfy8K1M32	1
KAG-200WCINV	1 / KA-200MCARINV32 - CREO
KAG-145WCINV	1 / KA-150MCARINV32 - CREO

GROUND FLOOR

FOYER/LIVING AREA	Area ≈ 27 sq.m
--------------------------	----------------

ACU 1	3.0hp Wall mounted Inverter	KSG-IWF-30Wfy8K1M32
	Estimated Pipe Length :	40 ft
	Estimated Royal Cord Length :	45 ft
	Initial Charge	P 8,500.00

Includes:

- Labor
- 10ft Copper Tube
- 10ft Royal Cord
- Outdoor Bracket
- Other Consumables

Additional Charges	Description	Unit	Price Per Unit	Subtotal
Copper Tube	1/4"x 5/8"	30 ft	P 400.00 / ft	P 12,000.00
Royal Cord	2.mm2 x 4C	35 ft	P 100.00 / ft	P 3,500.00
Royal Cord (ODU-Breaker)	3.5mm2 x 3C	5 ft	P 60.00 / ft	P 300.00
Circuit Breaker(NEMA)	30A/ 1Ph	1 pc(s)	P 1,000.00 / pc	P 1,000.00
PVC(Drainline)	Blue 3/4"	3 pc(s)	P 150.00 / pc	P 450.00
Rubber Insulation	2 1/8"x3/4" x 6'	5 pc(s)	P 350.00 / pc	P 1,750.00
Full Thread	3 meters	1 pc(s)	P 150.00 / pc	P 150.00
Pipe hanger	3 inches	8 pc(s)	P 120.00 / pc	P 960.00
				P 20,110.00

Estimated Charges	P 28,610.00
--------------------------	--------------------

BEDROOM1	Area ≈ 14 sq.m
-----------------	----------------

ACU2	1.5hp Windowtype Inverter	KAG-145WCINV
	Initial charge	P 1,200.00
	Angle Bracket	P 600.00

Estimated charges	P 1,800.00
--------------------------	-------------------

MASTER BEDROOM	Area ≈ 22.2 sq.m
-----------------------	------------------

ACU3	2.0hp Windowtype Inverter	KAG-200WCINV
	Initial charge	P 1,200.00
	Angle Bracket	P 600.00

Estimated charges	P 1,800.00
--------------------------	-------------------

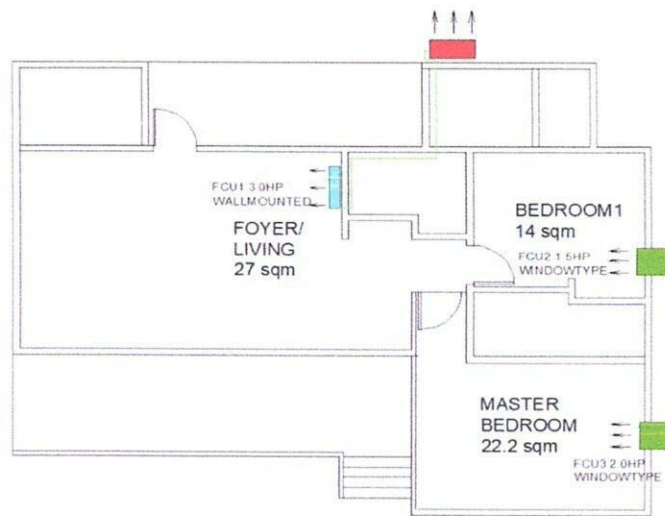

Total Estimated Charges

P 32,210.00

Validity: This quotation is valid for a period of fifteen (15) days from the date thereof, subject to our confirmation thereafter.

Note:

- 1 Location of indoor and outdoor units base in floor plan.
- 2 AC drain line will be tapped to the nearest drain provision provided by the customer's contractor.
- 3 Need for site visit before installation and for final location of units.
- 4 Customer need to cover the side of windowtype if unit is smaller than existing hole.
- 5 Need waiver if foyer and dining is open.
- 6 KAG-145WCINV Dimension: W x D x H, = 560 X 708 x 375 mm. (22 x 28 x 15 inches)
- 7 KAG-200WCINV Dimension: W x D x H, = 660 X 700 x 428 mm. (26 x 31 x 17 inches)
- 8 Working days: Monday to Saturday, 8am- 5pm with parking. Need working permit.
- 9 Mechanical Plans, Permits, Electrical permits not included.
- 10 Deflectors, masonry, carpentry, chipping & plastering (finishing & restoration) are not included in the installation.
- 11 Electrical power supply (feeder line) **220v/ 60hz/ 1ph**, is not included in the scope of work of Kolin.
- 12 Final charges will be based on actual installation.

for CREO pls refer to 1st page.

Prepared by:

Jeffrey Dadios
Field Surveyor

Customer Conformance:

Signature Over Printed Name

Reviewed by:

Engr. Kenneth Zamora
Service Supervisor
Field and Shop Operation