



April 10, 2025

LOPA COMPOUND DEVELOPMENT / HOUSE #6 JOEL  
LOPA FARM MARILAQUE HIWAY, SITIO MAYAGAY, BRGY. SAMPALOC TANAY RIZAL  
Email: mereyes@foro.ph

Dear Ma'am/Sir,

Kolin Marketing Inc., is extremely honored for your endorsement of Kolin brand and we are please to offer you with a special price/s for the following items.

A. EQUIPMENT & INSTALLATION

QTY	U/M	MODEL / DESCRIPTION	SRP	DISCOUNTED PRICE		AMOUNT
1	UNIT/S	MODEL: KSG-IWF-30WFF-8K1M32 KOLIN WALL MOUNTED PRIMUS GOLD AIRCONDITIONER 29,500 Kj/h (3.0HP) FULL DC INVERTER W/ WIFI R-32	76,595.00	51,212.20	PHP	51,212.20
1	UNIT/S	MODEL: KA-200MCARINV32 KOLIN WINDOW TYPE CREO SERIES AIRCONDITIONER 19,800 Kj/h (2.0HP) FULL DC INVERTER R-32 WITH REMOTE (WxDxH) 26"x30.7"x16.8"	36,995.00	26,916.20	PHP	26,916.20
2	UNIT/S	MODEL: KA-150MCARINV32 KOLIN WINDOW TYPE CREO SERIES AIRCONDITIONER 12,800 Kj/h (1.5HP) FULL DC INVERTER R-32 WITH REMOTE (WxDxH) 17.7"x26.6"x13.8"	27,995.00	20,276.20	PHP	40,552.40
TOTAL UNIT COST					PHP	118,680.80
ESTIMATED COST OF INSTALLATION (please see attached)					PHP	28,270.00
OTHERS: DELIVERY CHARGE					PHP	600.00
TOTAL ESTIMATED COST OF THE PROJECT					PHP	147,550.80

TERMS OF PAYMENT:

FULL PAYMENT OF UNIT AND DELIVERY CHARGE. IF CHECK, SUBJECT FOR 3 DAYS CLEARING.

WARRANTY:

FOR SPLIT TYPE : ONE (1) YEAR FREE PARTS AND LABOR, THREE YEARS (3) MAIN PCB , TEN (10) YEARS WARRANTY ON COMPRESSOR.  
FOR WINDOW TYPE: ONE (1) YEAR FREE PARTS AND LABOR, THREE YEARS (3) MAIN PCB, TEN (10) YEARS WARRANTY ON COMPRESSOR.

NOTES: PRICES ARE SUBJECT TO CHANGE WITHOUT PRIOR NOTICE.

PRICES IS VAT INCLUSIVE.

**\*\* Cost of Installation is Package with the Unit(s), this cost cannot avail separately (cost will be based on actual).**

We thank you for giving opportunity to offer our product and services, hoping we receive your purchase order.

If you need assistance, don't hesitate to call the under signed at 0917-807-8607 or email at kmi\_asst@kolinphil.com.ph

**\*\* SUBJECT FOR ACTUAL SITE VISIT / OCULAR \*\***

Very Truly Yours,

JANELLEN S. LIM  
KMI-ASSISTANT

Noted by;

MARTIN DANIEL R. FLORES  
KMI-SUPERVISOR

Approved By:

MS. EDITHA M. FLORES  
AVP - FINANCE

KMI-QUOTE-04-25-0269-rev  
DCG-24%/7K/1.2K/1K

Conforme:

SIGNATURE OVER PRINTED NAME

Kolin Marketing, Inc.  
1854 Sta. Rita St., Guadalupe Nuevo, Makati City  
Tel.: (632) 8852-6473  
Fax: (632) 8852-2170 / (632) 8852-4792  
www.kolinphil.com.ph / kolinphilippines



APRIL 08, 2025

LOPA COMPOUND DEVELOPMENT/ HOUSE #6 JOEL

Lopa Farm Marilaque Hiway Sitio Mayagay, Brgy Sampaloc Tanay Rizal

MODEL	QUANTITY
KSG-IWF-30WY8K1M32	1
KAG-200WCINV	1 / KA-200MCARINV32 - CREO
KAG-145WCINV	2 / KA-150MCARINV32 - CREO

GROUND FLOOR

<b>FOYER/LIVING AREA</b>	Area ≈ 28 sq.m
--------------------------	----------------

<b>ACU 1</b>	<b>3.0hp Wall mounted Inverter</b>	<b>KSG-IWF-30WY8K1M32</b>	
	Estimated Pipe Length :	30	ft
	Estimated Royal Cord Length :	35	ft
	Initial Charge		P 8,500.00

Includes:

Labor  
10ft Copper Tube  
10ft Royal Cord  
Outdoor Bracket  
Other Consumables

Additional Charges	Description	Unit	Price Per Unit	Subtotal
Copper Tube	1/4"x 5/8"	20 ft	P 400.00 / ft	P 8,000.00
Royal Cord	2.mm2 x 4C	25 ft	P 100.00 / ft	P 2,500.00
Royal Cord (ODU-Breaker)	3.5mm2 x 3C	5 ft	P 60.00 / ft	P 300.00
Circuit Breaker(NEMA)	30A/ 1Ph	1 pc(s)	P 1,000.00 / pc	P 1,000.00
PVC(Drainline)	Blue 3/4"	2 pc(s)	P 150.00 / pc	P 300.00
Rubber Insulation	2 1/8"x3/4" x 6'	4 pc(s)	P 350.00 / pc	P 1,400.00
Full Thread	3 meters	1 pc(s)	P 150.00 / pc	P 150.00
Pipe hanger	3 inches	6 pc(s)	P 120.00 / pc	P 720.00
				P 14,370.00

<b>Estimated Charges</b>	<b>P 22,870.00</b>
--------------------------	--------------------

<b>MASTER BEDROOM</b>	Area ≈ 23.4 sq.m
-----------------------	------------------

<b>ACU2</b>	<b>2.0hp Windowtype Inverter</b>	<b>KAG-200WCINV</b>	
	Initial charge		P 1,200.00
	Angle Bracket		P 600.00

<b>Estimated charges</b>	<b>P 1,800.00</b>
--------------------------	-------------------

<b>BEDROOM 2</b>	Area ≈ 14 sq.m
------------------	----------------

<b>ACU3</b>	<b>1.5hp Windowtype Inverter</b>	<b>KAG-145WCINV</b>	
	Initial charge		P 1,200.00
	Angle Bracket		P 600.00

<b>Estimated charges</b>	<b>P 1,800.00</b>
--------------------------	-------------------

<b>BEDROOM 1</b>	Area ≈ 14 sq.m
------------------	----------------

<b>ACU4</b>	<b>1.5hp Windowtype Inverter</b>	<b>KAG-145WCINV</b>	
	Initial charge		P 1,200.00
	Angle Bracket		P 600.00

<b>Estimated charges</b>	<b>P 1,800.00</b>
--------------------------	-------------------

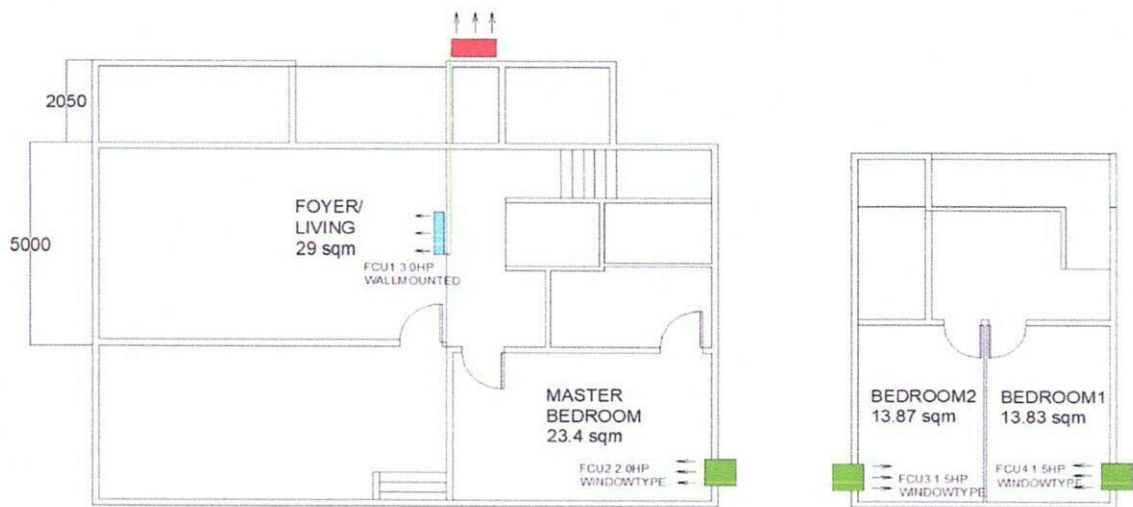

**Total Estimated Charges**

**P 28,270.00**

**Validity:** This quotation is valid for a period of fifteen (15) days from the date thereof, subject to our confirmation thereafter.

**Note:**

- 1 Location of indoor and outdoor units base in floor plan.
- 2 AC drain line will be tapped to the nearest drain provision provided by the customer's contractor.
- 3 Need for site visit before installation and for final location of units.
- 4 Customer need to cover the side of windowtype if unit is smaller than existing hole.
- 5 Need waiver if Foyer and Dining area is open.
- 6 KAG-145WCINV Dimension: W x D x H, = 560 X 708 x 375 mm. (22 x 28 x 15 inches)
- 7 KAG-200WCINV Dimension: W x D x H, = 660 X 700 x 428 mm. (26 x 31 x 17 inches)
- 8 Working days: Monday to Saturday, 8am- 5pm with parking. Need working permit.
- 9 Mechanical Plans, Permits, Electrical permits not included.
- 10 Deflectors, masonry, carpentry, chipping & plastering (finishing & restoration) are not included in the installation.
- 11 Electrical power supply (feeder line) **220v/ 60hz/ 1ph**, is not included in the scope of work of Kolin.
- 12 Final charges will be based on actual installation.

**for CREO  
pls refer to 1st page.**

Prepared by:

**Jeffrey Dadios**  
Field Surveyor

Customer Conformer:

Signature Over Printed Name

Reviewed by:

**Engr. Kenneth Zamora**  
Service Supervisor  
Field and Shop Operation