



April 14, 2025

FURUSATO SHOWROOM
ATTN: MR. JONATHAN SO
UNIT 103 HEART TOWER, SAN AGUSTIN ST. SALCEDO VILLAGE, VALERO MAKATI CITY
TEL#: 0917-6350304

Dear Ma'am/Sir,

Kolin Marketing Inc., is extremely honored for your endorsement of Kolin brand and we are please to offer you with a special price/s for the following items.

A. EQUIPMENT & INSTALLATION

QTY	U/M	MODEL / DESCRIPTION	SRP	DISCOUNTED PRICE		AMOUNT
1	UNIT/S	MODEL: KSG-IWF-25WFF-8K1M32 KOLIN WALL MOUNTED PRIMUS GOLD AIRCONDITIONER 25,560 Kj/h (2.5HP) FULL DC INVERTER W/ WIFI R-32	68,995.00	45,436.20	PHP	45,436.20
2	UNIT/S	MODEL: KSG-IWF-20WFF-8K1M32 KOLIN WALL MOUNTED PRIMUS GOLD AIRCONDITIONER 19,000 Kj/h (2.0HP) FULL DC INVERTER W/ WIFI R-32	59,595.00	38,292.20	PHP	76,584.40
TOTAL UNIT COST					PHP	122,020.60
ESTIMATED COST OF INSTALLATION (please see attached)					PHP	88,690.00
OTHERS: DELIVERY CHARGE					PHP	600.00
TOTAL ESTIMATED COST OF THE PROJECT					PHP	211,310.60

TERMS OF PAYMENT:

FULL PAYMENT OF UNIT AND DELIVERY CHARGE. IF CHECK, SUBJECT FOR 3 DAYS CLEARING.

WARRANTY:

FOR SPLIT TYPE : ONE (1) YEAR FREE PARTS AND LABOR, THREE YEARS (3) MAIN PCB , TEN (10) YEARS WARRANTY ON COMPRESSOR.

NOTES: PRICES ARE SUBJECT TO CHANGE WITHOUT PRIOR NOTICE.

PRICES IS VAT INCLUSIVE.

**** Cost of Installation is Package with the Unit(s), this cost cannot avail separately (cost will be based on actual).**

We thank you for giving opportunity to offer our product and services, hoping we receive your purchase order.

If you need assistance, don't hesitate to call the under signed at 0917-807-8607 or email at kmi_asst@kolinphil.com.ph

Very Truly Yours,

JANELLEN S. LIM
KMI-ASSISTANT

Noted by:

MART NATHANIEL R. FLORES
KMI-SUPERVISOR

Approved By:

MS. EDITHA M. FLORES
AVP - FINANCE

KMI-QUOTE-04-25-0280
ADR-24%/7K

Conforme:

SIGNATURE OVER PRINTED NAME

Kolin Marketing, Inc.
1854 Sta. Rita St., Guadalupe Nuevo, Makati City
Tel.: (632) 8852-6473
Fax: (632) 8852-2170 / (632) 8852-4792
www.kolinphil.com.ph / kolinphilippines



April 12, 2025
Jonathan So
Unin 103 Heart Tower, San Agustin St. Salcedo Village Valero Makati City
0917-6350304

MODEL	Qty
KSG-IWF-25Wfy8K1M32	1
KSG-IWF-20Wfy8K1M32	2

CONFERENCE ROOM		Area	17.7 sqm
-----------------	--	------	----------

ACU 1	2.0 HP Wall Mounted Inverter	KSG-IWF-20Wfy8K1M32			
	Estimated Pipe Length =	43 ft			
	Estimated Royal Cord Length =	48 ft			
	Initial Charge				₱ 7,500.00
	Includes:				
	Labor				
	10ft Copper Tube				
	10ft Royal Cord				
	Outdoor Bracket (Floor)				
	Consumables				
	Installation Materials	Description	Qty	Price per qty	Subtotal
	Copper Tube	Ø 1/4" x Ø 1/2"	33 ft	₱ 350.00/ft	₱ 11,550.00
	Royal Cord (comm. wire)	2.mm2 x 4C	38 ft	₱ 100.00/ft	₱ 3,800.00
	Royal Cord (ACCU-Breaker)	3.5mm x 3c	5 ft	₱ 60.00/ft	₱ 300.00
	Circuit Breaker waterproof	30A / 1Ph	1 pc/s	₱ 1,000.00/pc	₱ 1,000.00
	Rubber Insulation	2 1/8" x 3/4" x 6'	5 pc/s	₱ 350.00/pc	₱ 1,750.00
	Full thread	3/8" x 10'	2 pc/s	₱ 150.00/pc	₱ 300.00
	Metal Clamp	3"	8 pc/s	₱ 120.00/pc	₱ 960.00
	PVC blue	3/4" x 10'	3 pc/s	₱ 150.00/pc	₱ 450.00
	Drain pump		1 pc/s	₱ 2,750.00/pc	₱ 2,750.00
	Drain pump hose		20 ft	₱ 10.00/ft	₱ 200.00
					₱ 23,060.00

Estimated Charges	₱ 30,560.00
--------------------------	-------------

MAIN SHOWROOM		Area	29.5 sqm
---------------	--	------	----------

ACU 2	2.5 HP Wall Mounted Inverter	KSG-IWF-25Wfy8K1M32			
	Estimated Pipe Length =	37 ft			
	Estimated Royal Cord Length =	42 ft			
	Initial Charge				₱ 8,500.00
	Includes:				
	Labor				
	10ft Copper Tube				
	10ft Royal Cord				
	Outdoor Bracket (Wall)				
	Consumables				
	Installation Materials	Description	Qty	Price per qty	Subtotal
	Copper Tube	Ø 1/4" x Ø 5/8"	27 ft	₱ 350.00/ft	₱ 9,450.00
	Royal Cord (comm. wire)	2.mm2 x 4C	32 ft	₱ 100.00/ft	₱ 3,200.00
	Royal Cord (ACCU-Breaker)	3.5mm x 3c	5 ft	₱ 60.00/ft	₱ 300.00
	Circuit Breaker waterproof	30A / 1Ph	1 pc/s	₱ 1,000.00/pc	₱ 1,000.00
	Rubber Insulation	2 1/8" x 3/4" x 6'	2 pc/s	₱ 350.00/pc	₱ 700.00
	Full thread	3/8" x 10'	1 pc/s	₱ 150.00/pc	₱ 150.00
	Metal Clamp	3"	4 pc/s	₱ 120.00/pc	₱ 480.00
	PVC blue	3/4" x 10'	2 pc/s	₱ 150.00/pc	₱ 300.00
					₱ 15,580.00

Estimated Charges	₱ 24,080.00
--------------------------	-------------

OFFICE

Area 18 sqm

ACU 3 2.0 HP Wall Mounted Inverter**KSG-IWF-20Wfy8K1M32**

Estimated Pipe Length = 56 ft

Estimated Royal Cord Length = 61 ft

Initial Charge

₱ 7,500.00

Includes:

Labor

10ft Copper Tube

10ft Royal Cord

Outdoor Bracket (Wall)

Consumables

Installation Materials

Description	Qty	Price per qty	Subtotal
Copper Tube	46 ft	₱ 350.00/ft	₱ 16,100.00
Royal Cord (comm. wire)	51 ft	₱ 100.00/ft	₱ 5,100.00
Royal Cord (ACCU-Breaker)	5 ft	₱ 60.00/ft	₱ 300.00
Circuit Breaker waterproof	30A / 1Ph	1 pc/s ₱ 1,000.00/pc	₱ 1,000.00
Rubber Insulation	2 1/8" x 3/4" x 6'	6 pc/s ₱ 350.00/pc	₱ 2,100.00
Full thread	3/8" x 10'	2 pc/s ₱ 150.00/pc	₱ 300.00
Metal Clamp	3"	10 pc/s ₱ 120.00/pc	₱ 1,200.00
PVC blue	3/4" x 10'	3 pc/s ₱ 150.00/pc	₱ 450.00
			₱ 26,550.00

Estimated Charges

₱ 34,050.00

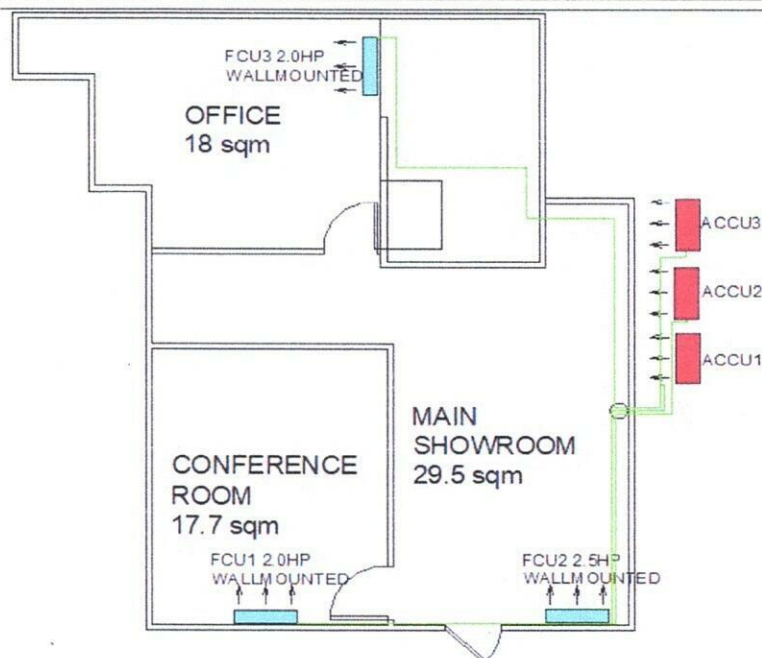

Validity: This quotation is valid for a period of fifteen (15) days from the date thereof, subject to our confirmation thereafter.

Installation notes:

- 1 Location based in floor plan only.
- 2 AC drain line will be tapped to the nearest drain provision provided by the customer's contractor.
- 3 Need for site visit before installation, for final location.
- 4 Coppertube expose inside the area.
- 5 Working days: Monday to Saturday, 8am- 5pm with parking. Need working permit.
- 6 Mechanical Plans, Permits, Electrical permits not included.
- 7 Deflectors, masonry, carpentry, chipping & plastering (finishing & restoration) are not included in the installation.
- 8 Air conditioning drain line and Electrical power supply (feeder line) **220v/ 60hz/ 1ph**, should be provided by customer's contractor.
- 9 **Final charges will be based on actual installation.**

Prepared by:

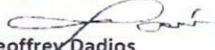
Jeffrey Dadios
Field Surveyor

Customer Conformance:

Signature Over Printed Name

Reviewed by:

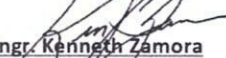
Engr. Kenneth Zamora
Service Supervisor Shop and Field
Operation