



April 14, 2025

MR. EDMOND SY  
#28 STO. TOMAS ST., BRGY. DON MANUEL, QUEZON CITY  
TEL#: 0917-8871681

Dear Ma'am/Sir,

Kolin Marketing Inc., is extremely honored for your endorsement of Kolin brand and we are please to offer you with a special price/s for the following items.

A. EQUIPMENT & INSTALLATION

QTY	U/M	MODEL / DESCRIPTION	SRP	DISCOUNTED PRICE		AMOUNT
1	UNIT/S	MODEL: KLM-IS60-AA1M32 KOLIN CEILING CASSETTE AIRCONDITIONER 55,503 Kj/h (5.0TR) DC INVERTER R-32 SINGLE PHASE	154,995.00	117,796.20	PHP	117,796.20
1	UNIT/S	MODEL: KLM-SF70-4F1M410 KOLIN FLOOR MOUNTED AIRCONDITIONER 56,970 Kj/h (5.0TR) NON-INVERTER R-410A SINGLE PHASE	110,995.00	81,356.20	PHP	81,356.20
1	UNIT/S	MODEL: KLM-IS40-AA1M32 KOLIN CEILING CASSETTE AIRCONDITIONER 37,980 Kj/h (3.0TR) DC INVERTER R-32 SINGLE PHASE	119,995.00	91,196.20	PHP	91,196.20
1	UNIT/S	MODEL: KLG-IF40-5G1M32 KOLIN FLOOR MOUNTED AIRCONDITIONER 37,980 Kj/h (3.0TR) FULL DC INVERTER R-32 SINGLE PHASE	113,195.00	79,028.20	PHP	79,028.20
2	UNIT/S	MODEL: KSG-IWF-30WVF-8K1M32 KOLIN WALL MOUNTED PRIMUS GOLD AIRCONDITIONER 29,500 Kj/h (3.0HP) FULL DC INVERTER W/ WIFI R-32	76,595.00	51,212.20	PHP	102,424.40
TOTAL UNIT COST						471,801.20
ESTIMATED COST OF INSTALLATION (please see attached)						197,575.00
TOTAL ESTIMATED COST OF THE PROJECT						669,376.20

TERMS OF PAYMENT:

FULL PAYMENT OF UNIT AND DELIVERY CHARGE. IF CHECK, SUBJECT FOR 3 DAYS CLEARING.

WARRANTY:

FOR SPLIT TYPE : ONE (1) YEAR FREE PARTS AND LABOR, THREE YEARS (3) MAIN PCB , TEN (10) YEARS WARRANTY ON COMPRESSOR.

FOR FLOOR MOUNTED: ONE (1) YEAR FREE PARTS AND LABOR, FIVE (5) YEARS WARRANTY ON COMPRESSOR.

FOR CEILING CASSETTE (Inverter): ONE (1) YEAR FREE PARTS AND LABOR, FIVE (5) YEARS WARRANTY ON COMPRESSOR.

NOTES: PRICES ARE SUBJECT TO CHANGE WITHOUT PRIOR NOTICE.

PRICES IS VAT INCLUSIVE.

**\*\* Cost of Installation is Package with the Unit(s), this cost cannot avail separately.**

We thank you for giving opportunity to offer our product and services, hoping we receive your purchase order.

If you need assistance, don't hesitate to call the under signed at 0917-807-8607 or email at kmi\_asst@kolinphil.com.ph

**\*\* NO AVAILABLE STOCK FOR KLM-SF70-4F1M410.**

Very Truly Yours,

JANELLEN S. LIM  
KMI-ASSISTANT

Noted by:  
MART NATHANIEL B. FLORES  
KMI-SUPERVISOR

Approved By:

MS. EDITHA M. FLORES  
AVP - FINANCE

KMI-QUOTE-04-25-0285  
REG-24%/3K/7K

Conforme:

SIGNATURE OVER PRINTED NAME

Kolin Marketing, Inc.  
1854 Sta. Rita St., Guadalupe Nuevo, Makati City  
Tel.: (632) 8852-6473  
Fax: (632) 8852-2170 / (632) 8852-4792  
www.kolinphil.com.ph / kolinphilippines



APRIL 12, 2025

EDMOND SY

#28 Sto. Tomas St. Brgy, Don Manuel, Quezon City

0917-8871681

MODEL	QUANTITY
KLM-IS60-AA1M32-I	1
KLM-SF70-4F1M410	1
KLM-IS40-AA1M32-I	1
KLG-IF40-5G1M32	1
KSG-IWF-30Wfy-8K1M32	2

OPTION 1-mixed

GROUND FLOOR

<b>OFFICE 1</b>	Area ≈ 41.5 sq.m
-----------------	------------------

<b>ACU 1</b>	<b>4.0hp Floor mounted Inverter</b>	<b>KLG-IF40-5G1M32</b>						
	Estimated Pipe Length :	20	ft					
	Estimated Royal Cord Length :	27	ft					
	Initial Charge						P	11,000.00
	Includes:							
	Labor							
	10ft Copper Tube							
	10ft Royal Cord							
	Indoor Bracket							
	Other Consumables							
	<b>Additional Charges</b>	<b>Description</b>	<b>Unit</b>	<b>Price Per Unit</b>		<b>Subtotal</b>		
	Copper Tube	3/8"x 5/8"	10 ft	P 400.00 / ft	P	4,000.00		
	Royal Cord	2.mm2 x 4C	17 ft	P 100.00 / ft	P	1,700.00		
	Royal Cord (ODU-Breaker)	5.5mm2 x 3C	5 ft	P 70.00 / ft	P	350.00		
	Circuit Breaker(NEMA)	40A/ 1Ph	1 pc(s)	P 1,000.00 / pc	P	1,000.00		
	Outdoor Bracket(wall)	Fabricated	1 pc(s)	P 5,000.00 / pc	P	5,000.00		
	Drain Hose	White -1/2"	7 ft	P 25.00 / ft	P	175.00	P	12,225.00
	<b>Estimated Charges</b>						P	23,225.00

SECOND FLOOR

<b>OFFICE 2 &amp; 3</b>	Area ≈ 57.4 sq.m
-------------------------	------------------

<b>ACU 2</b>	<b>3.0hp Wallmounted Inverter</b>	<b>KSG-IWF-30Wfy-8K1M32</b>						
	Estimated Pipe Length :	46	ft					
	Estimated Royal Cord Length :	51	ft					
	Initial Charge						P	7,700.00
	Includes:							
	Labor							less outdoor
	10ft Copper Tube							bracket
	10ft Royal Cord							
	Other Consumables							
	<b>Additional Charges</b>	<b>Description</b>	<b>Unit</b>	<b>Price Per Unit</b>		<b>Subtotal</b>		
	Copper Tube	3/8"x 5/8"	36 ft	P 400.00 / ft	P	14,400.00		
	Royal Cord	2.mm2 x 4C	41 ft	P 100.00 / ft	P	4,100.00		
	Royal Cord (ODU-Breaker)	3.5mm2 x 3C	5 ft	P 70.00 / ft	P	350.00		
	Circuit Breaker(NEMA)	30A/ 1Ph	1 pc(s)	P 1,000.00 / pc	P	1,000.00		
	Rubber Insulation	2 1/8"x3/4" x 6'	5 pc(s)	P 350.00 / pc	P	1,750.00		
	Full Thread	3 meters	2 pc(s)	P 150.00 / pc	P	300.00		
	Pipe hanger	3 inches	8 pc(s)	P 120.00 / pc	P	960.00		
	Outdoor Bracket(Wall w/ledge)	fabricated	1 pc(s)	P 6,500.00 / pc	P	6,500.00		
	Drain Hose	White -1/2"	5 ft	P 25.00 / ft	P	125.00	P	29,485.00
	<b>Estimated Charges</b>						P	37,185.00



<b>ACU 3 3.0hp Wallmounted Inverter</b>		<b>KSG-IWF-30Wfy-8K1M32</b>			
Estimated Pipe Length	:	27	ft		
Estimated Royal Cord Length	:	32	ft		
Initial Charge				P	7,700.00
Includes:					
Labor					less outdoor
10ft Copper Tube					bracket
10ft Royal Cord					
Other Consumables					
<b>Additional Charges</b>	<b>Description</b>	<b>Unit</b>	<b>Price Per Unit</b>	<b>Subtotal</b>	
Copper Tube	3/8"x 5/8"	17 ft	P 400.00 / ft	P 6,800.00	
Royal Cord	2.mm2 x 4C	22 ft	P 100.00 / ft	P 2,200.00	
Royal Cord (ODU-Breaker)	3.5mm2 x 3C	5 ft	P 70.00 / ft	P 350.00	
Circuit Breaker(NEMA)	30A/ 1Ph	1 pc(s)	P 1,000.00 / pc	P 1,000.00	
Outdoor Bracket(wall w/ledge)	fabricated	1 pc(s)	P 6,500.00 / pc	P 6,500.00	
Drain Hose	White -1/2"	5 ft	P 25.00 / ft	P 125.00	P 16,975.00
<b>Estimated Charges</b>				<b>P</b>	<b>24,675.00</b>

### THIRD FLOOR

<b>SHOWROOM</b>				Area ≈ 58.2 sq.m	
<b>ACU 4 7.0hp Floor mounted Regular</b>		<b>KLM-SF70-4F1M410</b>			
Estimated Pipe Length	:	10	ft		
Estimated Royal Cord Length	:	17	ft		
Initial Charge				P	14,000.00
Includes:					
Labor					
10ft Copper Tube					
10ft Royal Cord					
Indoor Bracket					
Other Consumables					
<b>Additional Charges</b>	<b>Description</b>	<b>Unit</b>	<b>Price Per Unit</b>	<b>Subtotal</b>	
Royal Cord	2.mm2 x 4C	7 ft	P 100.00 / ft	P 700.00	
Royal Cord (ODU-Breaker)	5.5mm2 x 3C	7 ft	P 70.00 / ft	P 490.00	
Circuit Breaker(NEMA)	60A/ 1Ph	1 pc(s)	P 1,000.00 / pc	P 1,000.00	
Outdoor Bracket(wall w/ledge)	fabricated	1 pc(s)	P 6,500.00 / pc	P 6,500.00	
Drain Hose	White -1/2"	7 ft	P 25.00 / ft	P 175.00	P 8,865.00
<b>Estimated Charges</b>				<b>P</b>	<b>22,865.00</b>

<b>TRAINING ROOM</b>				Area ≈ 95.3 sq.m	
<b>ACU 5 6.0hp Ceiling Cassette Inverter</b>		<b>KLM-IS60-AA1M32</b>			
Estimated Pipe Length	:	60	ft		
Estimated Royal Cord Length	:	67	ft		
Initial Charge				P	15,000.00
Includes:					
Labor					
10ft Copper Tube					
10ft Royal Cord					
Other Consumables					
<b>Additional Charges</b>	<b>Description</b>	<b>Unit</b>	<b>Price Per Unit</b>	<b>Subtotal</b>	
Copper Tube	3/8"x 5/8"	50 ft	P 400.00 / ft	P 20,000.00	
Royal Cord	2.mm2 x 4C	57 ft	P 100.00 / ft	P 5,700.00	
Royal Cord (ODU-Breaker)	5.5mm2 x 3C	5 ft	P 70.00 / ft	P 350.00	
Circuit Breaker(NEMA)	60A/ 1Ph	1 pc(s)	P 1,000.00 / pc	P 1,000.00	
Outdoor Bracket(wall w/ledge)	fabricated	1 pc(s)	P 6,500.00 / pc	P 6,500.00	
Indoor Bracket	fabricated	1 pc(s)	P 1,500.00 / pc	P 1,500.00	
Rubber Insulation	2 1/8"x3/4" x 6'	8 pc(s)	P 350.00 / pc	P 2,800.00	
Rubber Insulation	1 1/8"x3/4" x 6'	8 pc(s)	P 150.00 / pc	P 1,200.00	
Full Thread	3 meters	5 pc(s)	P 150.00 / pc	P 750.00	
Pipe hanger	3 inches	12 pc(s)	P 120.00 / pc	P 1,440.00	
PVC (Drainline)	1 inch- blue	4 pc(s)	P 200.00 / pc	P 800.00	P 42,040.00
<b>Estimated Charges</b>				<b>P</b>	<b>57,040.00</b>

**ACU 6 4.0hp Ceiling Cassette Inverter****KLM-IS40-AA1M32**

Estimated Pipe Length : 44 ft  
 Estimated Royal Cord Length : 51 ft  
 Initial Charge

P 12,000.00

Includes:

Labor  
 10ft Copper Tube  
 10ft Royal Cord  
 Other Consumables

Additional Charges	Description	Unit	Price Per Unit	Subtotal
Copper Tube	3/8"x 5/8"	34 ft P	400.00 / ft P	13,600.00
Royal Cord	2.mm2 x 4C	41 ft P	100.00 / ft P	4,100.00
Royal Cord (ODU-Breaker)	5.5mm2 x 3C	5 ft P	70.00 / ft P	350.00
Circuit Breaker(NEMA)	40A/ 1Ph	1 pc(s) P	1,000.00 / pc P	1,000.00
Outdoor Bracket(wall w/ledge)	fabricated	1 pc(s) P	6,500.00 / pc P	6,500.00
Indoor Bracket	fabricated	1 pc(s) P	1,500.00 / pc P	1,500.00
Rubber Insulation	2 1/8"x3/4" x 6'	6 pc(s) P	350.00 / pc P	2,100.00
Rubber Insulation	1 1/8"x3/4" x 6'	6 pc(s) P	150.00 / pc P	900.00
Full Thread	3 meters	5 pc(s) P	150.00 / pc P	750.00
Pipe hanger	3 inches	8 pc(s) P	120.00 / pc P	960.00
PVC (Drainline)	1 inch- blue	4 pc(s) P	200.00 / pc P	800.00
Scaffoldings	2sets	1 pc(s) P	1,500.00 / pc P	1,500.00
Drain Hose	White -1/2"	5 ft P	25.00 / ft P	125.00 P

20,585.00

<b>Estimated Charges</b>	<b>P 32,585.00</b>
--------------------------	--------------------

<b>Total Estimated Charges</b>	<b>P 197,575.00</b>
--------------------------------	---------------------

**Validity:** This quotation is valid for a period of fifteen (15) days from the date thereof, subject to our confirmation thereafter.

**Note:**

- 1 Location of indoor and outdoor units were agreed by the customer and Kolin's surveyor.recommendation for approved.
- 2 AC drain line will be tapped to the nearest drain provision provided by the customer's contractor.
- 3 Need for marking and site visit before installation. Onsite fabricated outdoor bracket.
- 4 If units install at the cabinet need 10cm both side and 30cm upper portion.
- 5 ACU2 & ACU3 need to operate at the same time to avoid undercapacity.
- 6 ACU5 & ACU6 need to operate at the same time to avoid undercapacity.
- 7 Working days: Monday to Saturday, 8am- 5pm with parking.Need harness and rope.
- 8 Mechanical Plans, Permits, Electrical permits not included.
- 9 Deflectors, masonry, carpentry, chipping & plastering (finishing & restoration) are not included in the installation.
- 10 Electrical power supply (feeder line) **220v/ 60hz/ 1ph** , is not included in the scope of work of Kolin.
- 11 Final charges will be based on actual installation.

Prepared by:

**Jeffrey Dadios**

Field Surveyor

Customer Conformee:

Signature Over Printed Name

Reviewed by:

**Engr. Kenneth Zamora**

Service Supervisor

Field and Shop Operation

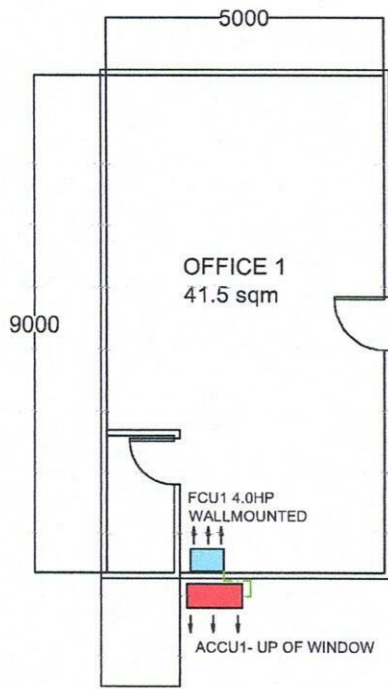

GROUND FLOOR

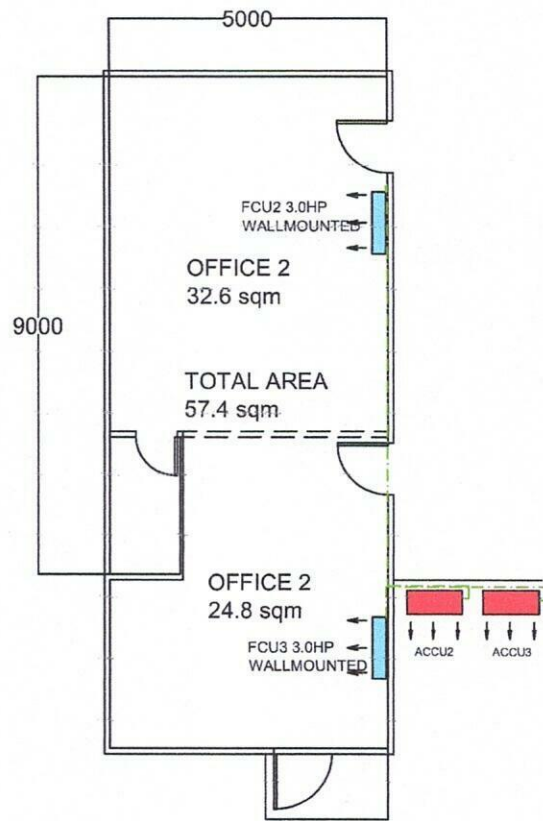

SECOND FLOOR

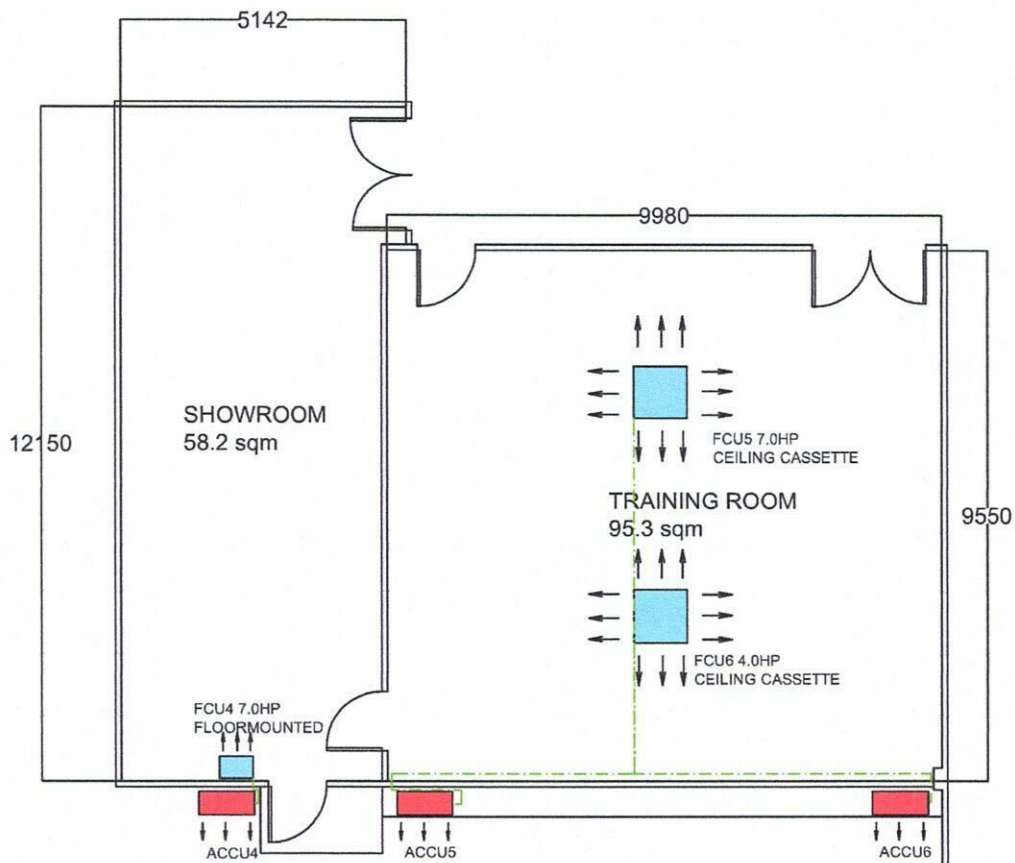

THIRD FLOOR