



April 30, 2025

MR. VICTOR SAY  
13 ROOSEVELT ST. BRGY. WEST, GREENHILLS SAN JUAN CITY  
TEL#: 0917-8955108

Dear Ma'am/Sir,

Kolin Marketing Inc., is extremely honored for your endorsement of Kolin brand and we are please to offer you with a special price/s for the following items.

A. EQUIPMENT & INSTALLATION

**\*\* OPTION 2**

QTY	U/M	MODEL / DESCRIPTION	SRP	DISCOUNTED PRICE		AMOUNT
1	UNIT/S	MODEL: KVM-30VAH1M-O KOLIN VERSAMATCH SERIES AIRCONDITIONER 24,485 kJ/h (3.0HP) OUTDOOR UNIT INVERTER R32	59,995.00	44,396.30	PHP	44,396.30
1	UNIT/S	MODEL: KVM-10IWAH-I KOLIN VERSAMATCH SERIES AIRCONDITIONER INVERTER 9,495 kJ/h (1.0HP) WALL MOUNTED INDOOR UNIT R32	10,995.00	8,136.30	PHP	8,136.30
1	UNIT/S	MODEL: KVM-20IWAH-I KOLIN VERSAMATCH SERIES AIRCONDITIONER INVERTER 18,990 kJ/h (2.0HP) WALL MOUNTED INDOOR UNIT R32	15,995.00	11,836.30	PHP	11,836.30
1	UNIT/S	MODEL: KAG-250WCINV KOLIN WINDOW TYPE QUAD SERIES AIRCONDITIONER 24,120 KJ/h (2.5HP) FULL DC INVERTER W/ WIFI R-32 (WxDxH) 26"x31.5"x17"	48,695.00	34,234.30	PHP	34,234.30
TOTAL UNIT COST					PHP	98,603.20
ESTIMATED COST OF (please see attached)					PHP	40,350.00
TOTAL ESTIMATED COST OF THE PROJECT					PHP	138,953.20

TERMS OF PAYMENT:

FULL PAYMENT OF UNIT AND DELIVERY CHARGE. IF CHECK, SUBJECT FOR 3 DAYS CLEARING.

WARRANTY:

FOR VERSAMATCH: ONE (1) YEAR FREE PARTS AND LABOR, FIVE (5) YEARS WARRANTY ON COMPRESSOR.

FOR WINDOW TYPE: ONE (1) YEAR FREE PARTS AND LABOR, THREE YEARS (3) MAIN PCB, TEN (10) YEARS WARRANTY ON COMPRESSOR.

NOTES: PRICES ARE SUBJECT TO CHANGE WITHOUT PRIOR NOTICE.

PRICES IS VAT INCLUSIVE.

**\*\* Cost of Installation is Package with the Unit(s), this cost cannot avail separately.**

We thank you for giving opportunity to offer our product and services, hoping we receive your purchase order.

If you need assistance, don't hesitate to call the under signed at 0917-807-8607 or email at kmi\_asst@kolinphil.com.ph

**\*\* CURRENTLY NO AVAILABLE STOCKS FOR MODELS KVM-30VAH1M-O & KVM-10IWAH-I.**

Very Truly Yours,

JANELLEN S. LIM  
KMI-ASSISTANT

Noted by:  
MART NATHANIEL R. FLORES  
KMI-SUPERVISOR

Approved By:

MS. EDITHA M. FLORES  
AVP - FINANCE

KMI-QUOTE-04-25-0322  
BOD-26%/4K/1.8K

Conforme:

SIGNATURE OVER PRINTED NAME

April 30, 2025

VICTOR SAY

13 Roosevelt St. Brgy, West Greenhills, San Juan City

0917-8955108

MODEL	QUANTITY
KVM-30VAH1M-O	1
KVM-10IWAH-I	1
KVM-20IWAH-I	1
KAG-250WCINV	1

OPTION 2

**MAIDS ROOM, KITCHEN**

ACCU 1 3.0hp Versamatch Inverter

KVM-30VAH1M-O

Materials Charges	Description	Unit	Price per Unit	Subtotal
Circuit Breaker	30Amps/1Ph	1 pc(s)	P 1000.00 / ft	P 1000.00
Royal Cord (ODU-Breaker)	3.5mm <sup>2</sup> x 3C	5 ft	P 70.00 / ft	P 350.00
Outdoor Bracket(galvanise)	wall	1 unit	P 1650.00 / unit	P 1650.00 P 3,000.00

Estimated Charges for outdoor materials	P 3,000.00
---	------------

**MAIDS ROOM**

Area ≈ 8 sq.m

FCU A 1.0hp Wall Mounted Inverter

KVM-10IWAH-I

Estimated Pipe Length :	30	ft
Estimated Royal Cord Length :	35	ft

Initial Charge

P 8,500.00

Includes:

10ft Copper Tube

10ft Royal Cord

Other Consumables

Additional Charges	Description	Unit	Price per Unit	Subtotal
Coppertube	1/4" x 3/8"	20 ft	P 350.00 / ft	P 7,000.00
Royal Cord	2mm <sup>2</sup> x 4C	25 ft	P 100.00 / ft	P 2,500.00
PVC Pipe (Drain)	3/4- blue	3 pc(s)	P 150.00 / ft	P 450.00 P 9,950.00

Estimated Charges for 1st Unit	P 18,450.00
--------------------------------	-------------

**KITCHEN**

Area ≈ 14 sq.m

FCU B 2.0hp Wall Mounted Inverter

KVM-20IWAH-I

Estimated Pipe Length :	20	ft
Estimated Royal Cord Length :	25	ft

Initial Charge

P 8,500.00

Includes:

10ft Copper Tube

10ft Royal Cord

Other Consumables

Additional Charges	Description	Unit	Price per Unit	Subtotal
Coppertube	1/4" x 1/2"	17 ft	P 350.00 / ft	P 5,950.00
Royal Cord	2mm <sup>2</sup> x 4C	22 ft	P 100.00 / ft	P 2,200.00
PVC Pipe (Drain)	3/4- blue	3 pc(s)	P 150.00 / ft	P 450.00 P 8,600.00

Estimated Charges for 2nd unit	P 17,100.00
--------------------------------	-------------

**BATHROOM**

Area ≈ 31 sq.m

ACU2 2.5hp Windowtype Inverter

KAG-250WCINV

Initial charge	P 1,200.00
Angle Bracket	P 600.00

Estimated charges	P 1,800.00
-------------------	------------

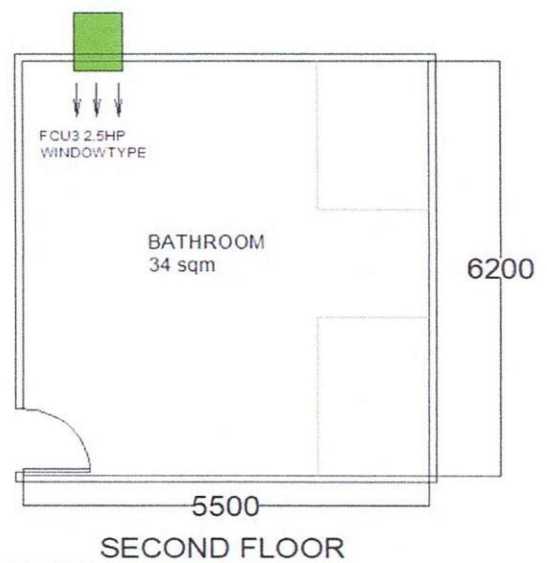
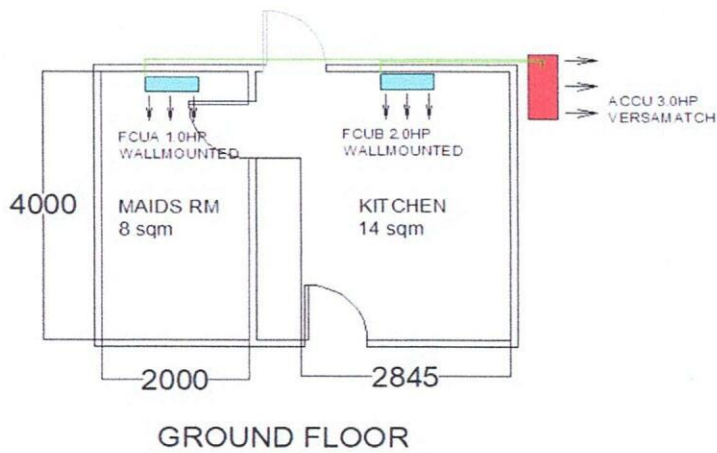

Total Estimated Charges	P 40,350.00
-------------------------	-------------

Validity: This quotation is valid for a period of fifteen (15) days from the date thereof, subject to our confirmation thereafter.

**Note:**

- 1 Location of indoor and outdoor units agree by customer and kolin surveyor.
- 2 AC drain line will be tapped to the nearest drain provision provided by the customer's contractor.
- 3 KAG-250WCINV Dimension: W x D x H, = 660 X 800 x 428 mm. (26 x 31.5 x 17 inches)
- 4 Expose coppertube in the area., customer need to provide power supply at the outdoor breaker.
- 5 Working days: Monday to Saturday, 8am- 5pm.
- 6 Mechanical Plans, Permits, Electrical permits not included.
- 7 Deflectors, masonry, carpentry, chipping & plastering (finishing & restoration) are not included in the installation.
- 8 Electrical power supply (feeder line) is not included in the scope of work of Kolin.
- 9 Final charges will be based on actual installation.

Prepared by:

**Jeffrey Dadios**

Field Surveyor

Customer Conformance:

Signature Over Printed Name

Reviewed by:

**Engr. Kenneth Zamora**

Service Supervisor

Field and Shop Operation