



August 28, 2025

MR. EJ DEE
#46 GREENMEADOWS AVE. BRGY. UGONG NORTE, QUEZON CITY
TEL#: 0917-8210093

Dear Ma'am/Sir,

Kolin Marketing Inc., is extremely honored for your endorsement of Kolin brand and we are please to offer you with a special price/s for the following items.

A. EQUIPMENT & INSTALLATION - **OPTION 2**

QTY	U/M	MODEL / DESCRIPTION	SRP	DISCOUNTED PRICE		AMOUNT
1	UNIT/S	MODEL: KSG-IWF-15WFY-8K1M32 KOLIN WALL MOUNTED PRIMUS GOLD AIRCONDITIONER 12,960 Kj/h (1.5HP) FULL DC INVERTER W/ WIFI R-32	46,595.00	28,412.20	PHP	28,412.20
TOTAL UNIT COST					PHP	28,412.20
ESTIMATED COST OF INSTALLATION (please see attached) w/ dismantling of old unit					PHP	11,500.00
OTHERS: DELIVERY CHARGE					PHP	600.00
TOTAL ESTIMATED COST OF THE PROJECT					PHP	40,512.20

TERMS OF PAYMENT:

FULL PAYMENT OF UNIT AND DELIVERY CHARGE. IF CHECK, SUBJECT FOR 3 DAYS CLEARING.

WARRANTY:

FOR SPLIT TYPE : ONE (1) YEAR FREE PARTS AND LABOR, THREE YEARS (3) MAIN PCB , TEN (10) YEARS WARRANTY ON COMPRESSOR.

NOTES: PRICES ARE SUBJECT TO CHANGE WITHOUT PRIOR NOTICE.

PRICES IS VAT INCLUSIVE.

**** Cost of Installation is Package with the Unit(s), this cost cannot avail separately (cost will be based on actual works).**

***** You may settle first payment for unit/s & delivery. Installation payment can be settled directly to installer after actual works.**

We thank you for giving opportunity to offer our product and services, hoping we receive your purchase order.

If you need assistance, don't hesitate to call the under signed at 0917-807-8607 or email at kmi_asst@kolinphil.com.ph

Very Truly Yours,

JANELLEN S. LIM
KMI-ASSISTANT

Noted by:

MART NATHANIEL R. FLORES
KMI-SUPERVISOR

Approved By:

MS. EDITHA M. FLORES
AVP - FINANCE

KMI-QUOTE-08-25-0637
ECY-24%/7K

Conforme: _____
SIGNATURE OVER PRINTED NAME



MJRC AIRCONDITIONING SERVICES

Customer Name : EJ DEE Date : AUG.26,2025
 Address : #46 GREENMEADOWS AVE. BRGY.UGONG NORTE QUEZON CITY SJR No : HO-00270092
 Establishment Type: Residential ☒ Commercial ☐
 Area Surveyed : KID'S ROOM

Cooling Capacity Computation

Floor Area : 14.4 sqm. note: add 20% per meter in excess of 3 meters in the
 Ceiling Height : mtr. initial cooling capacity computed.

Floor Area :	<u>14.40</u>	x	550 Btu/hr	<u>7200</u> 3tu/h
Ceiling Height (excess of 3 mtrs.) :	<u> </u>	x	20%	<u> </u> Btu/h
Windows Direct Sunlight	<input checked="" type="checkbox"/>	20% Heat Load of Floor Area		<u>1440</u> 3tu/h
Glass Wall Direct Sunlight	<input type="checkbox"/>	50% Heat Load of Floor Area		<u> </u> Btu/h
Total Cooling Capacity				<u>8640</u> 3tu/h
Add : Additional Heal Load				
No. of Person	<u>2</u>	x	300 Btu/hr	<u>600</u> 3tu/h
No. of Ordinary Light (<40w)	<u> </u>	x	200 Btu/hr	<u> </u> Btu/h
No. of Special Light (<40w)	<u> </u>	x	400 Btu/hr	<u> </u> Btu/h
No. of Refrigerator (<6 cu.ft.)	<u> </u>	x	400 Btu/hr	<u> </u> Btu/h
No. of Refrigerator (<6 cu.ft.)	<u> </u>	x	800 Btu/hr	<u> </u> Btu/h
No. of Television	<u> </u>	x	400 Btu/hr	<u> </u> 3tu/h
No. of Cooking Range	<u> </u>	x	1500 Btu/hr	<u> </u> Btu/h
No. of Laptop Computer	<u> </u>	x	250 Btu/hr	<u> </u> Btu/h
No. of Desktop Computer	<u> </u>	x	500 Btu/hr	<u> </u> Btu/h
No. of Printer	<u> </u>	x	500 Btu/hr	<u> </u> Btu/h
No. of Photocopier	<u> </u>	x	1000 Btu/hr	<u> </u> Btu/h
Total Cooling Capacity				<u>9240</u> 3tu/h
Computed Cooling Capacity	<u>KSM-IW15-WCT10M1M32</u>			<u>1.02</u> HP
Recommended Product Model	<u> </u>	Recommended Capacity / Type	<u>WALL MOUNTED 1.5HP</u>	

Note : Compressor warranty will be reduced to yr. If air-conditioner purchased is lower than the recommended cooling capacity or pipe lay-out is beyond the maximum allowable length.

Scope of Agreement

- | | | |
|--|--|--|
| 1. Copper tube lay-out | <input checked="" type="checkbox"/> Expose | <input type="checkbox"/> Embedded |
| 2. Chipping | <input type="checkbox"/> Included | <input checked="" type="checkbox"/> Not Included |
| 3. Fabricated bracket | <input type="checkbox"/> Yes | <input checked="" type="checkbox"/> No |
| 4. Service Ledge | <input type="checkbox"/> Yes | <input checked="" type="checkbox"/> No |
| 5. Dismantling of existing Aircon | <input type="checkbox"/> Included | <input type="checkbox"/> c/o Customer |
| 6. Leak Test of existing Copper tube | <input type="checkbox"/> Yes | <input checked="" type="checkbox"/> No |
| 7. Duct works | <input type="checkbox"/> Yes | <input checked="" type="checkbox"/> No |
| 8. Location of indoor and outdoor units were agreed by the customer and surveyor. | | |
| 9. Plastering, Carpentry and restoration works are to be done by the customer. | | |
| 10. Wiring of electrical supply from main panel to air-conditioning unit are to be done by the customer. | | |
| 11. Processing of mechanical plan, working permit are to be done by the customer. | | |
| 12. Other concern; <u>WITH DISMANTLING OF OLD UNIT /</u> | | |

Plan Lay-out

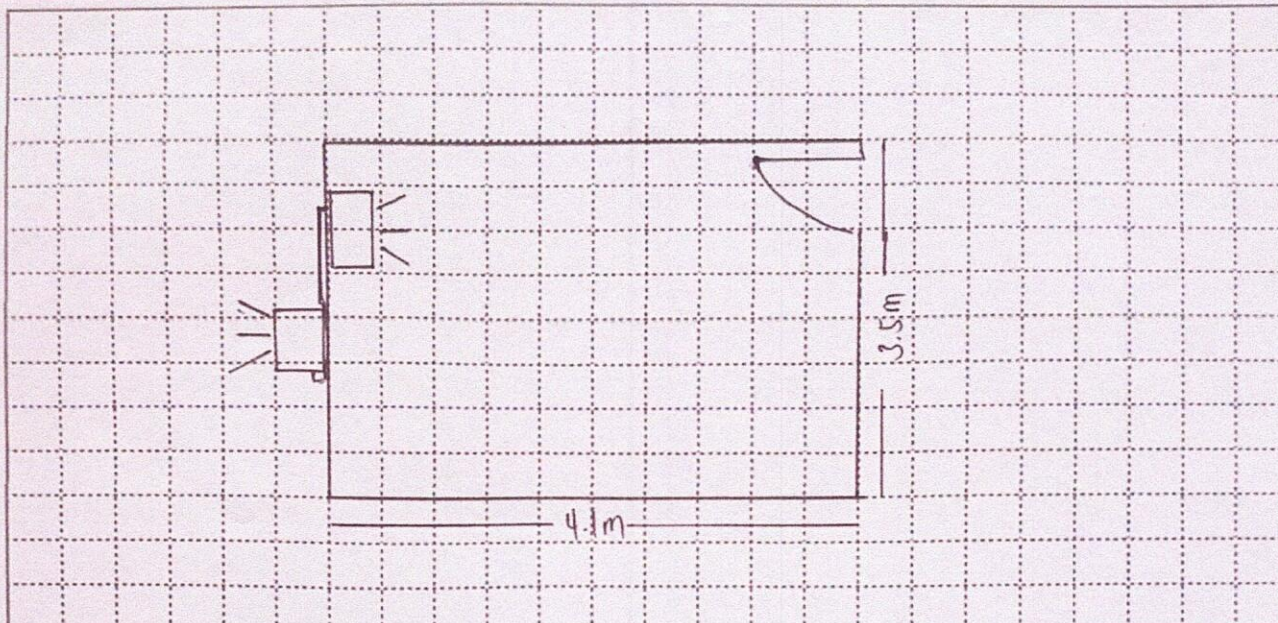

Indoor Unit Location : SAME LOCATION
 Outdoor Unit Location : SAME LOCATION
 Pipe Length : 10FT
 Special Note : W/ DISMANTLE OF OLD UNIT

Instruction: ○ Encircle required specifications (copper tube size, power supply, circuit breaker and ODU bracket)

Installation Cost Estimate

Material Description	Qty.	Unit Cost	Total Cost
Insu. Copper Tube (Excess of 10ft.) 3/8" x 1/4" <u>1/2" x 1/4"</u> 5/8" x 1/4" 5/8" x 3/8" 7/8" x 3/8"		P	P
Communication Wire - Royal Cord (Excess 10ft.) <u>2.0sqmm x 4c</u>	5	100 / FT	₱ 500.00
Power Supply - Royal Cord (Breaker to ODU) 3.5sqmm x 3c 5.5sqmm x 3c 8.0sqmm x 3c			
Circuit Breaker <u>20Amps/1Ph</u> 30Amps/1Ph 40Amps/Ph 60Amps/1Ph 40Amps/3Ph 100Amps/3Ph	1	1000 / FT	₱ 1,000.00
Bracket (ODU) Kolin Wall Kolin Floor Fab. Floor Fab. Wall Fab. Wall w/ ledge			
Angel Bracket (WAC)			
PVC Pipe (Drain) 3/4" x 10' 1" x 10'			
Leaktest Existing Copper Tube (∅ dia ____ x ____, estimated length ____ ft)			
Dismantling Fee (Existing Air-Conditioning unit capacity ____ HP)	1	2,500 / UNIT	₱ 2,500.00
Chipping Works			
Others			
Initial Charge			₱ 7,500.00
TOTAL ESTIMATE			₱ 11,500.00

Note:

1. Final charges will be based on actual installation.
2. Survey fee will be deducted in the installation fee.

Prepared by:

Customer Conforme:

Signature Over Printed Name

Signature Over Printed Name