



August 28, 2025

MR. EJ DEE
#46 GREENMEADOWS AVE. BRGY. UGONG NORTE, QUEZON CITY
TEL#: 0917-8210093

Dear Ma'am/Sir,

Kolin Marketing Inc., is extremely honored for your endorsement of Kolin brand and we are please to offer you with a special price/s for the following items.

A. EQUIPMENT & INSTALLATION

QTY	U/M	MODEL / DESCRIPTION	SRP	DISCOUNTED PRICE		AMOUNT
1	UNIT/S	MODEL: KSM-IW15-WCT10M1M32 KOLIN WALL MOUNTED CERTUS SERIES AIRCONDITIONER 12,660 Kj/h (1.5HP) REGULAR INVERTER W/ WIFI R-32	32,995.00	21,076.20	PHP	21,076.20
TOTAL UNIT COST					PHP	21,076.20
ESTIMATED COST OF INSTALLATION (please see attached) w/ dismantling of old unit					PHP	11,500.00
OTHERS: DELIVERY CHARGE					PHP	600.00
TOTAL ESTIMATED COST OF THE PROJECT					PHP	33,176.20

TERMS OF PAYMENT:

FULL PAYMENT OF UNIT AND DELIVERY CHARGE. IF CHECK, SUBJECT FOR 3 DAYS CLEARING.

WARRANTY:

FOR SPLIT TYPE : ONE (1) YEAR FREE PARTS AND LABOR, THREE YEARS (3) MAIN PCB , TEN (10) YEARS WARRANTY ON COMPRESSOR.

NOTES: PRICES ARE SUBJECT TO CHANGE WITHOUT PRIOR NOTICE.

PRICES IS VAT INCLUSIVE.

**** Cost of Installation is Package with the Unit(s), this cost cannot avail separately (cost will be based on actual works).**

***** You may settle first payment for unit/s & delivery. Installation payment can be settled directly to installer after actual works.**

We thank you for giving opportunity to offer our product and services, hoping we receive your purchase order.

If you need assistance, don't hesitate to call the under signed at 0917-807-8607 or email at kmi_asst@kolinphil.com.ph

Very Truly Yours,

JANELLEN S. LIM
KMI-ASSISTANT

Noted by:

MART NATHANIEL R. FLORES
KMI-SUPERVISOR

Approved By:

MS. EDITHA M. FLORES
AVP - FINANCE

KMI-QUOTE-08-25-0635
ECY-24%/4K

Conforme:

SIGNATURE OVER PRINTED NAME

MJRC AIRCONDITIONING SERVICES

Customer Name : EJ DEE Date : AUG.26,2025
 Address : #46 GREENMEADOWS AVE. BRGY.UGONG NORTE QUEZON CITY SJR No : HO-00270092
 Establishment Type: Residential ☒ Commercial ☐
 Area Surveyed : KID'S ROOM

Cooling Capacity Computation

Floor Area : 14.4 sqm. note: add 20% per meter in excess of 3 meters in the
 Ceiling Height : mtr. initial cooling capacity computed.

Floor Area :	14.40	x	550 Btu/hr	7200	3tu/h
Ceiling Height (excess of 3 mtrs.) :		x	20%		Btu/h
Windows Direct Sunlight		<input checked="" type="checkbox"/>	20% Heat Load of Floor Area	1440	3tu/h
Glass Wall Direct Sunlight		<input type="checkbox"/>	50% Heat Load of Floor Area		Btu/h
Total Cooling Capacity				8640	3tu/h
Add : Additional Heal Load					
No. of Person	2	x	300 Btu/hr	600	3tu/h
No. of Ordinary Light (<40w)		x	200 Btu/hr		Btu/h
No. of Special Light (<40w)		x	400 Btu/hr		Btu/h
No. of Refrigerator (<6 cu.ft.)		x	400 Btu/hr		Btu/h
No. of Refrigerator (<6 cu.ft.)		x	800 Btu/hr		Btu/h
No. of Television		x	400 Btu/hr		3tu/h
No. of Cooking Range		x	1500 Btu/hr		Btu/h
No. of Laptop Computer		x	250 Btu/hr		Btu/h
No. of Desktop Computer		x	500 Btu/hr		Btu/h
No. of Printer		x	500 Btu/hr		Btu/h
No. of Photocopier		x	1000 Btu/hr		Btu/h
Total Cooling Capacity				9240	3tu/h
Computed Cooling Capacity	KSM-IW15-WCT10M1M32			1.02	HP
Recommended Product Model				Recommended Capacity / Type	WALL MOUNTED 1.5HP

Note : Compressor warranty will be reduced to ____ yr. If air-conditioner purchased is lower than the recommended cooling capacity or pipe lay-out is beyond the maximum allowable length.

Scope of Agreement

- | | | |
|--------------------------------------|--|--|
| 1. Copper tube lay-out | <input checked="" type="checkbox"/> Expose | <input type="checkbox"/> Embedded |
| 2. Chipping | <input type="checkbox"/> Included | <input checked="" type="checkbox"/> Not Included |
| 3. Fabricated bracket | <input type="checkbox"/> Yes | <input checked="" type="checkbox"/> No |
| 4. Service Ledge | <input type="checkbox"/> Yes | <input checked="" type="checkbox"/> No |
| 5. Dismantling of existing Aircon | <input type="checkbox"/> Included | <input type="checkbox"/> c/o Customer |
| 6. Leak Test of existing Copper tube | <input type="checkbox"/> Yes | <input checked="" type="checkbox"/> No |
| 7. Duct works | <input type="checkbox"/> Yes | <input checked="" type="checkbox"/> No |
8. Location of indoor and outdoor units were agreed by the customer and surveyor.
 9. Plastering, Carpentry and restoration works are to be done by the customer.
 10. Wiring of electrical supply from main panel to air-conditioning unit are to be done by the customer.
 11. Processing of mechanical plan, working permit are to be done by the customer.
 12. Other concern: WITH DISMANTLING OF OLD UNIT /

Plan Lay-out

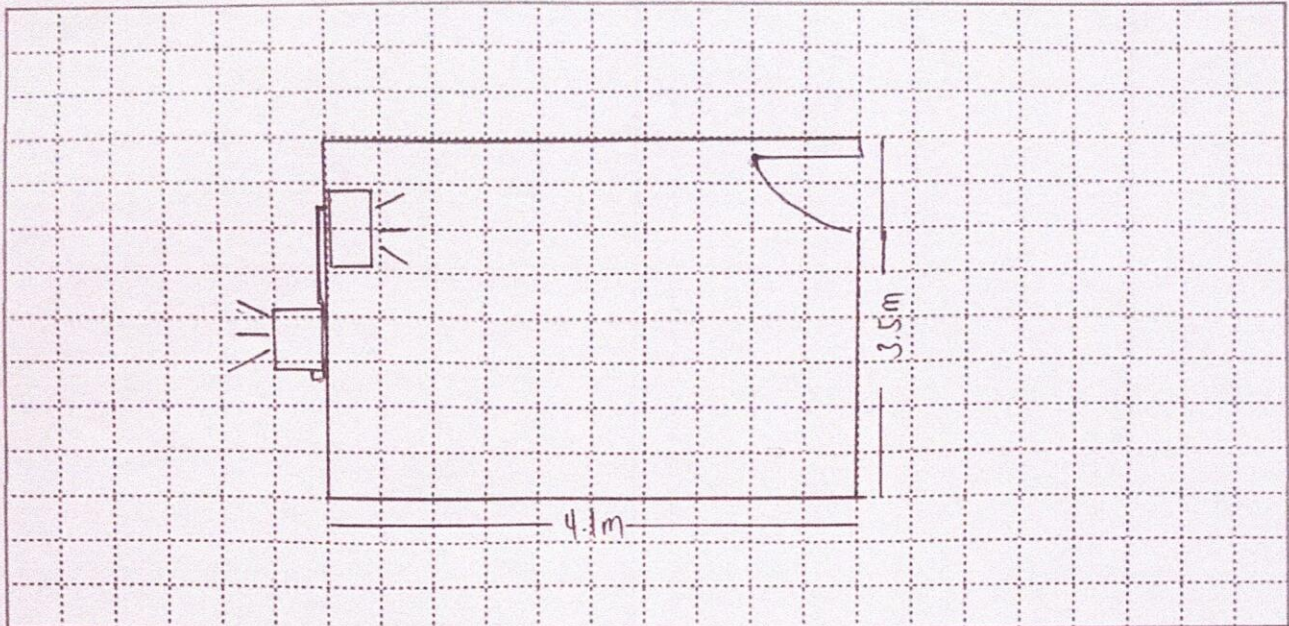

Indoor Unit Location : SAME LOCATION
 Outdoor Unit Location : SAME LOCATION
 Pipe Length : 10FT
 Special Note : W/ DISMANTLE OF OLD UNIT

Instruction: ○ Encircle required specifications (copper tube size, power supply, circuit breaker and ODU bracket)

Installation Cost Estimate

Material Description	Qty.	Unit Cost	Total Cost
Insu. Copper Tube (Excess of 10ft.) 3/8" x 1/4" <u>1/2" x 1/4"</u> 5/8" x 1/4" 5/8" x 3/8" 7/8" x 3/8"		₱	₱
Communication Wire - Royal Cord (Excess 10ft.) <u>2.0sqmm x 4c</u>	5	100 / FT	₱ 500.00
Power Supply - Royal Cord (Breaker to ODU) 3.5sqmm x 3c 5.5sqmm x 3c 8.0sqmm x 3c			
Circuit Breaker <u>20Amps/1Ph</u> 30Amps/1Ph 40Amps/Ph 60Amps/1Ph 40Amps/3Ph 100Amps/3Ph	1	1000 / FT	₱ 1,000.00
Bracket (ODU) Kolin Wall Kolin Floor Fab. Floor Fab. Wall Fab. Wall w/ ledge			
Angel Bracket (WAC)			
PVC Pipe (Drain) 3/4" x 10' 1" x 10'			
Leaktest Existing Copper Tube (Ø dia ____ x ____, estimated length ____ ft)			
Dismantling Fee (Existing Air-Conditioning unit capacity ____ HP)	1	2,500 / unit	₱ 2,500.00
Chipping Works			
Others _____			
Initial Charge			₱ 7,500.00
TOTAL ESTIMATE			₱ 11,500.00

Note:

1. Final charges will be based on actual installation.
2. Survey fee will be deducted in the installation fee.

Prepared by:

Customer Conforme:

Signature Over Printed Name

Signature Over Printed Name