



February 11, 2025

D.I.P DEVELOPMENT INC.
UNIT 4016 AMINA TOWER, ALLEGRA GARDEN PLACE, PASIG BLVD., PASIG CITY
TEL#: 0920-9560805

Dear Ma'am/Sir,

Kolin Marketing Inc., is extremely honored for your endorsement of Kolin brand and we are please to offer you with a special price/s for the following items.

A. EQUIPMENT & INSTALLATION

**** OPTION 1 ****

QTY	U/M	MODEL / DESCRIPTION	SRP	DISCOUNTED PRICE		AMOUNT
1	UNIT/S	MODEL: KVM-20VAH1M-O KOLIN VERSAMATCH SERIES AIRCONDITIONER 18,990 kJ/h (2.0HP) OUTDOOR UNIT INVERTER R32	42,995.00	32,676.20 /	PHP	32,676.20
2	UNIT/S	MODEL: KVM-10IWAH-I KOLIN VERSAMATCH SERIES AIRCONDITIONER INVERTER 9,495 kJ/h (1.0HP) WALL MOUNTED INDOOR UNIT R32	10,995.00	8,356.20 /	PHP	16,712.40 /
1	UNIT/S	MODEL: KSM-IW25-WCT10M1M32 KOLIN WALL MOUNTED CERTUS AIRCONDITIONER 23,210 kJ/h (2.5HP) REGULAR INVERTER W/ WIFI R-32	49,995.00	33,996.20 /	PHP	33,996.20
TOTAL UNIT COST					PHP	83,384.80
ESTIMATED COST OF INSTALLATION (please see attached)					PHP	70,215.00
OTHERS: DELIVERY CHARGE					PHP	600.00
TOTAL ESTIMATED COST OF THE PROJECT					PHP	154,199.80

TERMS OF PAYMENT:

FULL PAYMENT OF UNIT AND DELIVERY CHARGE. IF CHECK, SUBJECT FOR 3 DAYS CLEARING.

WARRANTY:

FOR VERSAMATCH: ONE (1) YEAR FREE PARTS AND LABOR, FIVE (5) YEARS WARRANTY ON COMPRESSOR.

FOR SPLIT TYPE : ONE (1) YEAR FREE PARTS AND LABOR, THREE YEARS (3) MAIN PCB , TEN (10) YEARS WARRANTY ON COMPRESSOR.

NOTES: PRICES ARE SUBJECT TO CHANGE WITHOUT PRIOR NOTICE.

PRICES IS VAT INCLUSIVE.

** Cost of Installation is Package with the Unit(s). this cost cannot avail separately (cost will be based on actual).

We thank you for giving opportunity to offer our product and services, hoping we receive your purchase order.

If you need assistance, don't hesitate to call the under signed at 0917-807-8607 or email at kmi_asst@kolinphil.com.ph

Very Truly Yours,

JANELLEN S. LIM
KMI-ASSISTANT

Noted by:

MART NATHANIEL R. FLORES
KMI-SUPERVISOR

Approved By:
MS. EDITHA M. FLORES
AVP - FINANCE

KMI-QUOTE-02-25-0100
REG-24%/4K

Conforme:

SIGNATURE OVER PRINTED NAME

Kolin Marketing, Inc.
1854 Sta. Rita St., Guadalupe Nuevo, Makati City
Tel.: (632) 8852-6473
Fax: (632) 8852-2170 / (632) 8852-4792
 www.kolinphil.com.ph / kolinphilippines

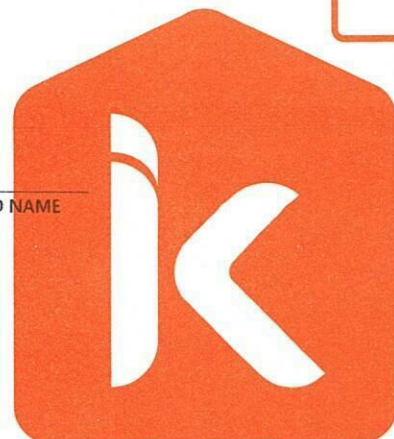

FEBRUARY 08, 2025

D.I.P Development Inc.

Unit 4016 Amina Tower, Allegra Garden Place, Pasig Blvd , Pasig City

0920-9560805

MODEL	QUANTITY
KVM-20VAH1M-O	1
KVM-10IWAH-I	2
KSM-IW25-WCT10M1M32	1

OPTION 1- recommendation

NURSERY/ BEDROOM

ACCU 1 2.0hp Versamatch Inverter KVM-20AH1M-O

Additional Charges	Description	Unit	Price per Unit	Subtotal
Royal Cord (ODU-Breaker)	5.5mm ² x 3C	7 ft	P 70.00 / ft	P 490.00
Circuit Breaker(NEMA)	30A/ 1Ph	1 pc(s)	P 1000.00 / pc	P 1000.00
Outdoor Bracket(fabricated)	floor	1 unit	P 2500.00 / unit	P 2500.00
				P 3,990.00

Estimated Charges P 3,990.00

NURSERY

Area ≈ 4 sq.m

FCU A 1.0hp Wall Mounted Inverter KVM-10IWAH-I

Estimated Pipe Length	:	30	ft	
Estimated Royal Cord Length	:	35	ft	
Labor				P 8,500.00

Includes:

- Labor
- 10ft Copper Tube
- 10ft Royal Cord
- Other Consumables

Additional Charges	Description	Unit	Price per Unit	Subtotal
Coppertube	1/4" x 3/8"	20 ft	P 350.00 / ft	P 7,000.00
Royal Cord	2mm ² x 4C	27 ft	P 100.00 / ft	P 2,700.00
Drain Hose	White -1/2"	5 ft	P 25.00 / ft	P 125.00
				9,825.00

Estimated Charges for 1st Unit P 18,325.00

BEDROOM

Area ≈ 10 sq.m

FCU B 1.0hp Wall Mounted Inverter KVM-10IWAH-I

Estimated Pipe Length	:	37	ft	
Estimated Royal Cord Length	:	42	ft	
Labor				P 8,500.00

Includes:

- Labor
- 10ft Copper Tube
- 10ft Royal Cord
- Other Consumables

Additional Charges	Description	Unit	Price per Unit	Subtotal
Coppertube	1/4" x 3/8"	27 ft	P 350.00 / ft	P 9,450.00
Royal Cord	2mm ² x 4C	34 ft	P 100.00 / ft	P 3,400.00
Drain Hose	White -1/2"	5 ft	P 25.00 / ft	P 125.00
				P 12,975.00

Estimated Charges for 2nd Unit P 21,475.00

LIVING/DINING/KITCHEN Area ≈ 25 sq.m

ACU 2 2.5hp Wallmounted Inverter **KSM-IW25-WCT10M1M32**
 Estimated Pipe Length : 40 ft
 Estimated Royal Cord Length 45 ft
 Initial Charge P 8,500.00

Includes:

Labor
 10ft Copper Tube
 10ft Royal Cord
 Other Consumables

Additional Charges	Description	Unit	Price Per Unit	Subtotal
Copper Tube	1/4"x 1/2"	30 ft	P 350.00 / ft	P 10,500.00
Royal Cord	2.mm2 x 4C	35 ft	P 100.00 / ft	P 3,500.00
Royal Cord (ODU-Breaker)	3.5mm2 x 3C	5 ft	P 60.00 / ft	P 300.00
Circuit Breaker(NEMA)	30A/ 1Ph	1 pc(s)	P 1,000.00 / pc	P 1,000.00
Outdoor Bracket(floor)	fabricated	1 pc(s)	P 2,500.00 / pc	P 2,500.00
Drain Hose	White -1/2"	5 ft	P 25.00 / ft	P 125.00
				P 17,925.00

Estimated Charges **P 26,425.00**

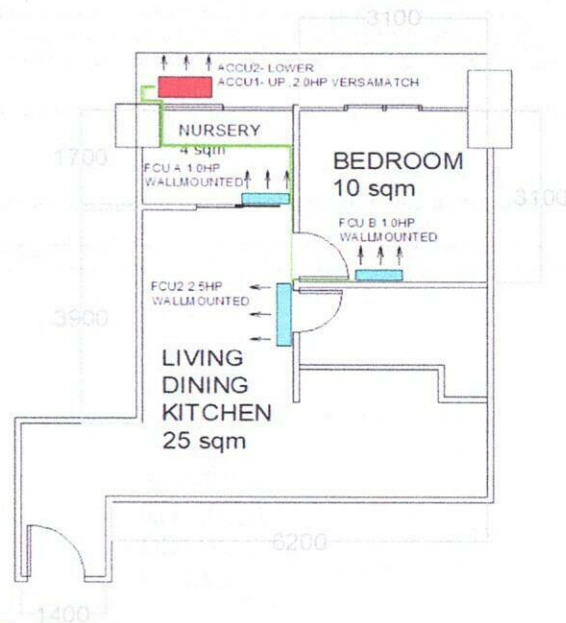

Total Estimated Charges **P 70,215.00**

Validity: This quotation is valid for a period of fifteen (15) days from the date thereof, subject to our confirmation thereafter.

Note:

- 1 Location of indoor and outdoor units agree by customer and kolin surveyor. Unit recommendation for verification of admin.
- 2 AC drain line will be tapped to the nearest drain provision provided by the customer's contractor.
- 3 Outdoor Bracket fabricated at shop bring to site. Floor with second layer for ACCU1.
- 4 Schedule for markings first for pipe layout and use drain clean out to fit the unit.
- 5 Expose coppertube in the area, Customer will cover the coppertube after installation.
- 6 Working days: Monday to Saturday, 8am- 5pm. Without parking, need working permit.
- 7 Mechanical Plans, Permits, Electrical permits not included.
- 8 Deflectors, masonry, carpentry, chipping & plastering (finishing & restoration) are not included in the installation.
- 9 Electrical power supply (feeder line) is not included in the scope of work of Kolin.
- 10 Final charges will be based on actual installation.

Prepared by:

Jeffrey Dadios
 Field Surveyor

Customer Conformance:

Signature Over Printed Name

Reviewed by:

Engr. Kenneth Zamora
 Service Supervisor