



February 11, 2025

D.I.P DEVELOPMENT INC.
UNIT 4016 AMINA TOWER, ALLEGRA GARDEN PLACE, PASIG BLVD., PASIG CITY
TEL#: 0920-9560805

Dear Ma'am/Sir,

Kolin Marketing Inc., is extremely honored for your endorsement of Kolin brand and we are please to offer you with a special price/s for the following items.

A. EQUIPMENT & INSTALLATION

**** OPTION 2 ****

QTY	U/M	MODEL / DESCRIPTION	SRP	DISCOUNTED PRICE		AMOUNT
1	UNIT/S	MODEL: KVM-50VAH1M-O KOLIN VERSAMATCH SERIES AIRCONDITIONER 47,475 kJ/h (5.0HP) OUTDOOR UNIT INVERTER R32	109,995.00	83,596.20 /	PHP	83,596.20
2	UNIT/S	MODEL: KVM-10IWAH-I KOLIN VERSAMATCH SERIES AIRCONDITIONER INVERTER 9,495 kJ/h (1.0HP) WALL MOUNTED INDOOR UNIT R32	10,995.00	8,356.20 /	PHP	16,712.40
1	UNIT/S	MODEL: KVM-25IWAH-I KOLIN VERSAMATCH SERIES AIRCONDITIONER INVERTER 23,210 kJ/h (2.5HP) WALL MOUNTED INDOOR UNIT R32	19,995.00	15,196.20 /	PHP	15,196.20
TOTAL UNIT COST					PHP	115,504.80
ESTIMATED COST OF INSTALLATION (please see attached)					PHP	67,590.00
OTHERS: DELIVERY CHARGE					PHP	600.00
TOTAL ESTIMATED COST OF THE PROJECT					PHP	183,694.80

TERMS OF PAYMENT:

FULL PAYMENT OF UNIT AND DELIVERY CHARGE. IF CHECK, SUBJECT FOR 3 DAYS CLEARING.

WARRANTY:

FOR VERSAMATCH: ONE (1) YEAR FREE PARTS AND LABOR, FIVE (5) YEARS WARRANTY ON COMPRESSOR.

NOTES: PRICES ARE SUBJECT TO CHANGE WITHOUT PRIOR NOTICE.

PRICES IS VAT INCLUSIVE.

** Cost of Installation is Package with the Unit(s), this cost cannot avail separately (cost will be based on actual).

We thank you for giving opportunity to offer our product and services, hoping we receive your purchase order.

If you need assistance, don't hesitate to call the under signed at 0917-807-8607 or email at kmi_asst@kolinphil.com.ph

Very Truly Yours,

JANELLEN S. LIM
KMI-ASSISTANT

Noted by:
MART NATHANIEL R. FLORES
KMI-SUPERVISOR

Approved By:
MS. EDITHA M. FLORES
AVP - FINANCE

KMI-QUOTE-02-25-0101
REG-24%

Conforme: _____
SIGNATURE OVER PRINTED NAME



February 10, 2025

D.I.P Development Inc.

Unit 4016 Amina Tower, Allegra Garden Place, Pasig Blvd , Pasig City

0920-9560805

MODEL	QUANTITY
KVM-50VAH1M-O	1
KVM-10IWAH-I	2
KVM-25IWAH-I	1

OPTION 2- recommendation

NURSERY/ BEDROOM/LIVING

ACCU 5.0hp Versamatch Inverter KVM-50AH1M-O

Additional Charges	Description	Unit	Price per Unit	Subtotal
Royal Cord (ODU-Breaker)	5.5mm ² x 3C	7 ft	P 70.00 / ft	P 490.00
Circuit Breaker(NEMA)	40A/ 1Ph	1 pc(s)	P 1000.00 / pc	P 1000.00
Outdoor Bracket(fabricated)	floor	1 unit	P 2500.00 / unit	P 2500.00
				P 3,990.00

Estimated Charges P 3,990.00

NURSERY

Area ≈ 4 sq.m

FCU A 1.0hp Wall Mounted Inverter KVM-10IWAH-I

Estimated Pipe Length	:	30	ft
Estimated Royal Cord Length	:	35	ft

Labor

P 8,500.00

Includes:

Labor
10ft Copper Tube
10ft Royal Cord
Other Consumables

Additional Charges	Description	Unit	Price per Unit	Subtotal
Coppertube	1/4" x 3/8"	20 ft	P 350.00 / ft	P 7,000.00
Royal Cord	2mm ² x 4C	25 ft	P 100.00 / ft	P 2,500.00
Drain Hose	White -1/2"	5 ft	P 25.00 / ft	P 125.00
				P 9,625.00

Estimated Charges for 1st Pair P 18,125.00

BEDROOM

Area ≈ 10 sq.m

FCU B 1.0hp Wall Mounted Inverter KVM-10IWAH-I

Estimated Pipe Length	:	37	ft
Estimated Royal Cord Length	:	42	ft

Includes:

Labor
10ft Copper Tube
10ft Royal Cord
Other Consumables

P 8,500.00

Additional Charges	Description	Unit	Price per Unit	Subtotal
Coppertube	1/4" x 3/8"	27 ft	P 350.00 / ft	P 9450.00
Royal Cord	2mm ² x 4C	32 ft	P 100.00 / ft	P 3200.00
Drain Hose	White -1/2"	5 ft	P 25.00 / ft	P 125.00
				P 12,775.00

Estimated Charges for 2nd Unit P 21,275.00

LIVING/DINING/KITCHEN

Area ≈ 25 sq.m

FCU C 2.5hp Wall Mounted Inverter KVM-25IWAH-I

Estimated Pipe Length	:	40	ft
Estimated Royal Cord Length	:	47	ft

Includes:

Labor
10ft Copper Tube
10ft Royal Cord
Other Consumables

P 8,500.00

Additional Charges	Description	Unit	Price per Unit	Subtotal
Coppertube	1/4" x 5/8"	30 ft	P 400.00 / ft	P 12,000.00
Royal Cord	2mm ² x 4C	37 ft	P 100.00 / ft	P 3,700.00
Drain Hose	White -1/2"	7 ft	P 25.00 / ft	P 175.00
				P 15,700.00

Estimated Charges for 3rd Unit P 24,200.00

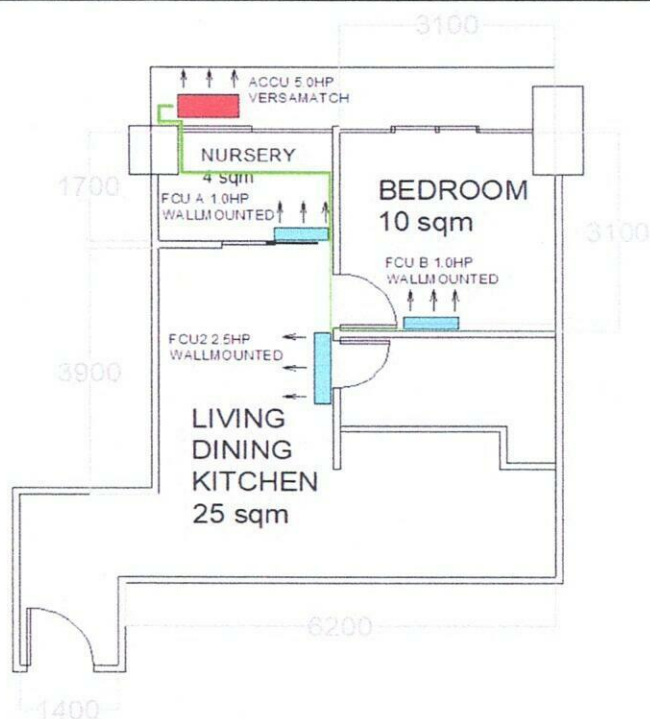

Total Estimated Charges

P 67,590.00

Validity: This quotation is valid for a period of fifteen (15) days from the date thereof, subject to our confirmation thereafter.

Note:

- 1 Location of indoor and outdoor units agree by customer and kolin surveyor. Unit recommendation for verification of admin.
- 2 AC drain line will be tapped to the nearest drain provision provided by the customer's contractor.
- 3 Outdoor Bracket fabricated at shop bring to site. Floor with second layer for ACCU1.
- 4 Schedule for markings first for pipe layout and use drain clean out to fit the unit.
- 5 Expose coppertube in the area, Customer will cover the coppertube after installation.
- 6 Working days: Monday to Saturday, 8am- 5pm. Without parking, need working permit.
- 7 Mechanical Plans, Permits, Electrical permits not included.
- 8 Deflectors, masonry, carpentry, chipping & plastering (finishing & restoration) are not included in the installation.
- 9 Electrical power supply (feeder line) is not included in the scope of work of Kolin.
- 10 **Final charges will be based on actual installation.**

Prepared by:

Jeffrey Dadios
Field Surveyor

Customer Conformance:

Signature Over Printed Name

Reviewed by:

Engr. Kenneth Zamora
Service Supervisor