



February 19, 2025

D.I.P DEVELOPMENT INC.  
UNIT 4016 AMINA TOWER, ALLEGRA GARDEN PLACE, PASIG BLVD., PASIG CITY  
TEL#: 0920-9560805

Dear Ma'am/Sir,

Kolin Marketing Inc., is extremely honored for your endorsement of Kolin brand and we are please to offer you with a special price/s for the following items.

A. EQUIPMENT & INSTALLATION

**\*\* OPTION 1 \*\***

QTY	U/M	MODEL / DESCRIPTION	SRP	DISCOUNTED PRICE		AMOUNT
1	UNIT/S	MODEL: KVM-20VAH1M-O KOLIN VERSAMATCH SERIES AIRCONDITIONER 18,990 kJ/h (2.0HP) OUTDOOR UNIT INVERTER R32	42,995.00	32,676.20	PHP	32,676.20
2	UNIT/S	MODEL: KVM-10IWAH-I KOLIN VERSAMATCH SERIES AIRCONDITIONER INVERTER 9,495 kJ/h (1.0HP) WALL MOUNTED INDOOR UNIT R32	10,995.00	8,356.20	PHP	16,712.40
1	UNIT/S	MODEL: KSM-IW20-WCT10M1M32 KOLIN WALL MOUNTED CERTUS SERIES AIRCONDITIONER 18,990 kJ/h (2.0HP) REGULAR INVERTER R-32	41,995.00	27,916.20	PHP	27,916.20
TOTAL UNIT COST					PHP	77,304.80
ESTIMATED COST OF INSTALLATION (please see attached)					PHP	68,625.00
OTHERS: DELIVERY CHARGE					PHP	600.00
TOTAL ESTIMATED COST OF THE PROJECT					PHP	146,529.80

TERMS OF PAYMENT:

FULL PAYMENT OF UNIT AND DELIVERY CHARGE. IF CHECK, SUBJECT FOR 3 DAYS CLEARING.

WARRANTY:

FOR VERSAMATCH: ONE (1) YEAR FREE PARTS AND LABOR, FIVE (5) YEARS WARRANTY ON COMPRESSOR.

FOR SPLIT TYPE : ONE (1) YEAR FREE PARTS AND LABOR, THREE YEARS (3) MAIN PCB , TEN (10) YEARS WARRANTY ON COMPRESSOR.

NOTES: \*\*\* Need to sign waiver agreement due to under capacity of unit choice.

PRICES ARE SUBJECT TO CHANGE WITHOUT PRIOR NOTICE.

PRICES IS VAT INCLUSIVE.

\*\* Cost of Installation is Package with the Unit(s), this cost cannot avail separately (cost will be based on actual).

We thank you for giving opportunity to offer our product and services, hoping we receive your purchase order.

If you need assistance, don't hesitate to call the under signed at 0917-807-8607 or email at kmi\_asst@kolinphil.com.ph

Very Truly Yours,

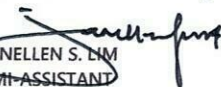
  
JANELLEN S. LIM  
KMI-ASSISTANT

Noted by;  
  
MART NATHANIEL B. FLORES  
KMI-SUPERVISOR

Approved By:  
  
MS. EDITHA M. FLORES  
AVP - FINANCE

KMI-QUOTE-02-25-0100-rev  
REG-24%/4K

Conforme:

SIGNATURE OVER PRINTED NAME



Kolin Marketing, Inc.

1854 Sta. Rita St., Guadalupe Nuevo, Makati City

Tel.: (632) 8852-6473

Fax: (632) 8852-2170 / (632) 8852-4792

 www.kolinphil.com.ph / kolinphilippines

February 19, 2025  
D.I.P Development Inc.  
Unit 4016 Amina Tower, Allegra Garden Place, Pasig Blvd , Pasig City  
0920-9560805

MODEL	QUANTITY
KVM-20VAH1M-O	1
KVM-10IWAH-I	2
KSM-IW20-WCT10M1M32	1

OPTION 1- recommendation

#### NURSERY/ BEDROOM

ACCU 1 2.0hp Versamatch Inverter *KVM-20AH1M-O*

Additional Charges	Description	Unit	Price per Unit	Subtotal
Royal Cord (ODU-Breaker)	3.5mm <sup>2</sup> x 3C	5 ft	P 60.00 / ft	P 300.00
Circuit Breaker(NEMA)	30A/ 1Ph	1 pc(s)	P 1000.00 / pc	P 1000.00
Outdoor Bracket(fabricated)	floor	1 unit	P 2500.00 / unit	P 2500.00
				<b>3,800.00</b>

**Estimated Charges** **P 3,800.00**

#### NURSERY

Area ≈ 4 sq.m

FCU A 1.0hp Wall Mounted Inverter *KVM-10IWAH-I*

Estimated Pipe Length	: 30	ft
Estimated Royal Cord Length	: 35	ft

Labor

P 8,500.00

Includes:

Labor  
10ft Copper Tube  
10ft Royal Cord  
Other Consumables

Additional Charges	Description	Unit	Price per Unit	Subtotal
Coppertube	1/4" x 3/8"	20 ft	P 350.00 / ft	P 7,000.00
Royal Cord	2mm <sup>2</sup> x 4C	25 ft	P 100.00 / ft	P 2,500.00
Drain Hose	White -1/2"	5 ft	P 25.00 / ft	P 125.00
				<b>9,625.00</b>

**Estimated Charges for 1st Unit** **P 18,125.00**

#### BEDROOM

Area ≈ 10 sq.m

FCU B 1.0hp Wall Mounted Inverter *KVM-10IWAH-I*

Estimated Pipe Length	: 37	ft
Estimated Royal Cord Length	: 42	ft

Includes:

Labor  
10ft Copper Tube  
10ft Royal Cord  
Other Consumables

P 8,500.00

Additional Charges	Description	Unit	Price per Unit	Subtotal
Coppertube	1/4" x 3/8"	27 ft	P 350.00 / ft	P 9,450.00
Royal Cord	2mm <sup>2</sup> x 4C	32 ft	P 100.00 / ft	P 3,200.00
Drain Hose	White -1/2"	5 ft	P 25.00 / ft	P 125.00
				<b>12,775.00</b>

**Estimated Charges for 2nd Unit** **P 21,275.00**

**LIVING/DINING/KITCHEN**

Area ≈ 25 sq.m

**ACU 2 2.5hp Wallmounted Inverter****KSM-IW20-WCT10M1M32**

Estimated Pipe Length : 40 ft

Estimated Royal Cord Length : 45 ft

Initial Charge

P 7,500.00

Includes:

Labor

10ft Copper Tube

10ft Royal Cord

Other Consumables

**Additional Charges**

Description	Unit	Price Per Unit	Subtotal
Copper Tube 1/4"x 1/2"	30 ft	P 350.00 / ft	P 10,500.00
Royal Cord 2.mm2 x 4C	35 ft	P 100.00 / ft	P 3,500.00
Royal Cord (ODU-Breaker) 3.5mm2 x 3C	5 ft	P 60.00 / ft	P 300.00
Circuit Breaker(NEMA) 30A/ 1Ph	1 pc(s)	P 1,000.00 / pc	P 1,000.00
Outdoor Bracket(floor) fabricated	1 pc(s)	P 2,500.00 / pc	P 2,500.00
Drain Hose White -1/2"	5 ft	P 25.00 / ft	P 125.00
			<b>P 17,925.00</b>

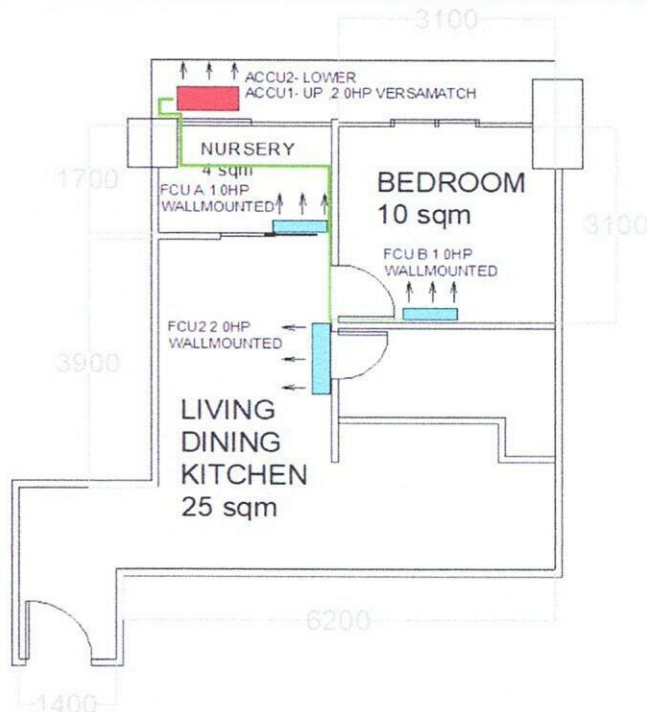
**Estimated Charges****P 25,425.00****Total Estimated Charges****P 68,625.00**

**Validity:** This quotation is valid for a period of fifteen (15) days from the date thereof, subject to our confirmation thereafter.

**Note:**

- 1 Location of indoor and outdoor units agree by customer and kolin surveyor. Unit recommendation for verification of admin.
- 2 AC drain line will be tapped to the nearest drain provision provided by the customer's contractor.
- 3 Outdoor Bracket fabricated at shop bring to site. Floor with second layer for ACCU1.
- 4 Schedule for markings first for pipe layout and use drain clean out to fit the unit.
- 5 Expose coppertube in the area, Customer will cover the coppertube after installation.
- 6 Working days: Monday to Saturday, 8am- 5pm. Without parking, need working permit.
- 7 Mechanical Plans, Permits, Electrical permits not included
- 8 Deflectors, masonry, carpentry, chipping & plastering (finishing & restoration) are not included in the installation.
- 9 Electrical power supply (feeder line) is not included in the scope of work of Kolin.
- 10 Final charges will be based on actual installation.

Prepared by:

**Jeffrey Dadios**

Field Surveyor

Customer Conformance:

Signature Over Printed Name

Reviewed by:

**Engr. Kenneth Zamora**

Service Supervisor



February 19, 2025

D.I.P Development Inc.

Unit 4016 Amina Tower, Allegra Garden Place, Pasig Blvd , Pasig City

Please be informed that the air-conditioner you intend to purchase is under capacity as compared to the following unit that we proposed:

Location	Area	Kolin's Recommendation	Customer's Choice	Remarks
Living / Dining / Kitchen	25 sqm	KSM-IW25-WCT10M1M32	KSM-IW20-WCT10M1M32	Calculated by 2.1 HP, undersize by 0.1 HP

Since the unit of your choice is under capacity, it is probable that you may experience the following;

1. Capacity of the unit to cool the area will take longer or it will not cool the area at all that may lead to your dissatisfaction with the cooling performance of our unit.
2. Power consumption will be higher due to frequent running of compressor for not reaching the desired temperature within the normal parameter.
3. Useful life of compressor will be shortened due to excessive running beyond the normal run cycle.

Considering the above conditions, we regret to inform you that we cannot guarantee the efficient performance of unit. **Also, One (1) year warranty for parts (compressor-10 year).**

For your guidance and information

Prepared by:



Engr. Kenneth Zamora  
Service Supervisor  
Field and Shop Operation

Approved by:



Mr. Alvin de Rivera  
Service Manager

Feb. 19, 2025

Customer Conforme:

Signature Over Printed Name