



February 24, 2025

SEC MOTOSUPPLY (Sct. Borromeo Branch)  
ATTN: MR. REVO YAP  
25 SCOUT BORROMELO ST., BRGY. DILIMAN, QUEZON CITY  
TEL#: 0927-5869890

Dear Ma'am/Sir,

Kolin Marketing Inc., is extremely honored for your endorsement of Kolin brand and we are please to offer you with a special price/s for the following items.

A. EQUIPMENT & INSTALLATION

\*\* OPTION 1

QTY	U/M	MODEL / DESCRIPTION	SRP	DISCOUNTED PRICE		AMOUNT
2	UNIT/S	MODEL: KLM-IS60-AA1M32 KOLIN CEILING CASSETTE AIRCONDITIONER 55,503 Kj/h (5.0TR) DC INVERTER R-32 SINGLE PHASE	154,995.00	117,796.20	PHP	235,592.40
1	UNIT/S	MODEL: KSM-IW25-WCT10M1M32 KOLIN WALL MOUNTED CERTUS AIRCONDITIONER 23,210 Kj/h (2.5HP) REGULAR INVERTER W/ WIFI R-32	49,995.00	33,996.20	PHP	33,996.20
TOTAL UNIT COST					PHP	269,588.60
ESTIMATED COST OF INSTALLATION (please see attached)					PHP	112,450.00
OTHERS: DELIVERY CHARGE					PHP	600.00
TOTAL ESTIMATED COST OF THE PROJECT					PHP	382,638.60

TERMS OF PAYMENT:

FULL PAYMENT OF UNIT AND DELIVERY CHARGE. IF CHECK, SUBJECT FOR 3 DAYS CLEARING.

WARRANTY:

FOR CEILING CASSETTE (Inverter): ONE (1) YEAR FREE PARTS AND LABOR, FIVE (5) YEARS WARRANTY ON COMPRESSOR.  
FOR SPLIT TYPE : ONE (1) YEAR FREE PARTS AND LABOR, THREE YEARS (3) MAIN PCB , TEN (10) YEARS WARRANTY ON COMPRESSOR.

NOTES: PRICES ARE SUBJECT TO CHANGE WITHOUT PRIOR NOTICE.

PRICES IS VAT INCLUSIVE.

\*\* Cost of Installation is Package with the Unit(s), this cost cannot avail separately (cost will be based on actual).

We thank you for giving opportunity to offer our product and services, hoping we receive your purchase order.

If you need assistance, don't hesitate to call the under signed at 0917-807-8607 or email at kmi\_asst@kolinphil.com.ph

Very Truly Yours,

JANELLEN S. LIM  
KMI-ASSISTANT

Noted by:  
  
MART NATHANIEL R. FLORES  
KMI-SUPERVISOR

Approved By:  
  
MS. EDITHA M. FLORES  
AVP - FINANCE

Conforme: \_\_\_\_\_  
SIGNATURE OVER PRINTED NAME

KMI-QUOTE-02-25-0139  
ADR-24%/4K



February 24, 2025

REVO YAP / SEC MOTOSUPPLY Sct. Borromeo Branch  
25 Scout Borromeo St. Brgy, Diliman Quezon City

9275869890

vicmanhattan18@gmail.com

attn: Vicente Valiente

MODEL	QUANTITY
KLM-IS60-AAM32-I	2
KSM-IW25-WCT10M132	1

**OPTION 1**

<b>OFFICE AREA</b>	Area ≈ 22,4 sq.m
--------------------	------------------

<b>ACU 1</b>	<b>2.5Hp Wallmounted Inverter</b>	<b>KSM-IW25-WCT10M132</b>				
	Estimated Pipe Length :	23	ft			
	Estimated Royal Cord Length :	28	ft			
	Initial Charge				P	8,500.00
	Includes:					
	Labor					
	10ft Copper Tube					
	10ft Royal Cord					
	Outdoor Bracket (floor)					
	Other Consumables					
	<b>Additional Charges</b>	<b>Description</b>	<b>Unit</b>	<b>Price Per Unit</b>		<b>Subtotal</b>
	Copper Tube	1/4"x 1/2"	13 ft	P 400.00 / ft	P	5,200.00
	Royal Cord	2.mm2 x 4C	18 ft	P 100.00 / ft	P	1,800.00
	Royal Cord (ODU-Breaker)	3.5mm2 x 3C	5 ft	P 60.00 / ft	P	300.00
	Circuit Breaker(NEMA)	30A/ 1Ph	1 pc(s)	P 1,000.00 / pc	P	1,000.00
	PVC(Drainline)	blue-3/4 inch	1 pc(s)	P 150.00 / pc	P	150.00
					P	8,450.00

<b>Estimated Charges</b>	<b>P 16,950.00</b>
--------------------------	--------------------

<b>SHOWROOM AREA</b>	Area ≈ 126 sq.m
----------------------	-----------------

<b>ACU 2</b>	<b>7.0hp Ceiling Cassette Inverter</b>	<b>KLM-IS60-AAM32-I</b>				
	Estimated Pipe Length :	46	ft			
	Estimated Royal Cord Length :	53	ft			
	Initial Charge				P	15,000.00
	Includes:					
	Labor					
	10ft Copper Tube					
	10ft Royal Cord					
	Indoor Bracket (full thread)					
	Other Consumables					
	<b>Additional Charges</b>	<b>Description</b>	<b>Unit</b>	<b>Price Per Unit</b>		<b>Subtotal</b>
	Copper Tube	3/8"x 5/8"	36 ft	P 400.00 / ft	P	14,400.00
	Royal Cord	2.mm2 x 4C	43 ft	P 100.00 / ft	P	4,300.00
	Royal Cord (ODU-Breaker)	5.5mm2 x 3C	5 ft	P 70.00 / ft	P	350.00
	Circuit Breaker(NEMA)	60A/ 1Ph	1 pc(s)	P 1,000.00 / pc	P	1,000.00
	Rubber Insulation	2 1/8"x3/4" x 6	4 pc(s)	P 350.00 / pc	P	1,400.00
	Rubber Insulation	1 1/8"x3/4" x 6	4 pc(s)	P 150.00 / pc	P	600.00
	Full Thread	3 meters	6 pc(s)	P 150.00 / pc	P	900.00
	Pipe hanger	3 inches	10 pc(s)	P 120.00 / pc	P	1,200.00
	PVC(Drainline)	blue-1 inch	3 pc(s)	P 200.00 / pc	P	600.00
	Indoor Bracket(special)	fabricated	1 pc(s)	P 1,500.00 / pc	P	1,500.00
	Outdoor Bracket(floor)	fabricated	1 pc(s)	P 2,500.00 / pc	P	2,500.00
					P	28,750.00

<b>Estimated Charges</b>	<b>P 43,750.00</b>
--------------------------	--------------------

<b>ACU 3</b>	<b>7.0hp Ceiling Cassette Inverter</b>	<b>KLM-IS60-AAM32-I</b>				
	Estimated Pipe Length :	53	ft			
	Estimated Royal Cord Length :	60	ft			
	Initial Charge				P	15,000.00
	Includes:					
	Labor					
	10ft Copper Tube					
	10ft Royal Cord					
	Other Consumables					
	<b>Additional Charges</b>	<b>Description</b>	<b>Unit</b>	<b>Price Per Unit</b>		<b>Subtotal</b>
	Copper Tube	3/8"x 5/8"	43 ft	P 400.00 / ft	P	17,200.00
	Royal Cord	2.mm2 x 4C	50 ft	P 100.00 / ft	P	5,000.00
	Royal Cord (ODU-Breaker)	5.5mm2 x 3C	5 ft	P 70.00 / ft	P	350.00
	Circuit Breaker(NEMA)	60A/ 1Ph	1 pc(s)	P 1,000.00 / pc	P	1,000.00
	Rubber Insulation	2 1/8"x3/4" x 6	5 pc(s)	P 350.00 / pc	P	1,750.00
	Rubber Insulation	1 1/8"x3/4" x 6	5 pc(s)	P 150.00 / pc	P	750.00
	Full Thread	3 meters	6 pc(s)	P 150.00 / pc	P	900.00
	Pipe hanger	3 inches	10 pc(s)	P 120.00 / pc	P	1,200.00
	Indoor Bracket(special)	fabricated	1 pc(s)	P 1,500.00 / pc	P	1,500.00
	PVC(Drainline)	blue-1 inch	3 pc(s)	P 200.00 / pc	P	600.00
	Outdoor Bracket(wall)	fabricated	1 pc(s)	P 5,000.00 / pc	P	5,000.00
	Scaffoldings	4 sets	1 pc(s)	P 1,500.00 / pc	P	1,500.00
					P	36,750.00

<b>Estimated Charges</b>	<b>P 51,750.00</b>
--------------------------	--------------------

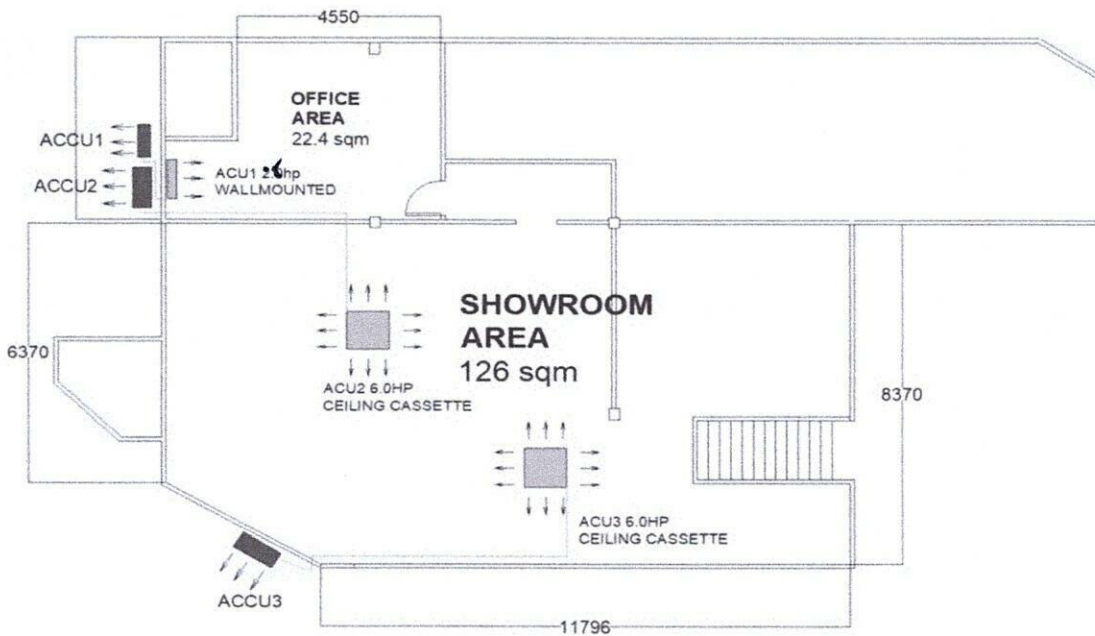

**Total Estimated Charges** P 112,450.00

**Validity:** This quotation is valid for a period of fifteen (15) days from the date thereof, subject to our confirmation thereafter.

**Note:**

- 1 Location of indoor and outdoor units were agreed by the customer and Kolin's surveyor.
- 2 AC drain line will be tapped to the nearest drain provision provided by the customer's contractor.
- 3 Need for marking and site visit before installation. onsite fabricated bracket.
- 4 Coppertube expose going inside the ceiling, customer make a manhole in the ceiling.
- 5 Working days: Monday to Saturday, 8am- 5pm with parking. 6 pax
- 6 Mechanical Plans, Permits, Electrical permits not included.
- 7 Deflectors, masonry, carpentry, chipping & plastering (finishing & restoration) are not included in the installation.
- 8 Electrical power supply (feeder line) **220v/ 60hz/ 1ph** , is not included in the scope of work of Kolin.
- 9 **Final charges will be based on actual installation.**

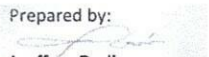
Prepared by:  
  
**Jeffrey Dadios**  
 Field Surveyor

Customer Conformer:  
 \_\_\_\_\_  
 Signature Over Printed Name

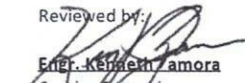
Reviewed by:  
  
**Eric Kenneth Zamora**  
 Service Supervisor  
 Field and Shop Operation