



February 3, 2025

MR. JOHN VINCENT ASUNCION
B2 L57 EVANGELISTA ST. PH3, BRGY. COLINAS VERDES, SAN JOSE DEL MONTE BULACAN
TEL#: 0917-8144602
Email: asuncionjohnvincent@gmail.com

Dear Ma'am/Sir,

Kolin Marketing Inc., is extremely honored for your endorsement of Kolin brand and we are please to offer you with a special price/s for the following items.

A. EQUIPMENT & INSTALLATION

** OPTION 6

QTY	U/M	MODEL / DESCRIPTION	SRP	DISCOUNTED PRICE		AMOUNT
1	UNIT/S	MODEL: KLG-SF40-WBR6H1M32 KOLIN FLOOR MOUNTED AIRCONDITIONER 39,596 Kj/h (3.0TR) NON-INVERTER R-32 SINGLE PHASE	80,495.00	60,286.10	PHP	60,286.10
1	UNIT/S	MODEL: KSM-IW15-WCT10M1M32 KOLIN WALL MOUNTED CERTUS SERIES AIRCONDITIONER 12,660 Kj/h (1.5HP) REGULAR INVERTER R-32	32,995.00	21,736.10	PHP	21,736.10
1	UNIT/S	MODEL: KSM-IW10-WCT10M1M32 KOLIN WALL MOUNTED CERTUS SERIES AIRCONDITIONER 9,800 Kj/h (1.0HP) REGULAR INVERTER R-32	29,995.00	19,396.10	PHP	19,396.10
TOTAL UNIT COST					PHP	101,418.30
ESTIMATED COST OF INSTALLATION (please see attached)					PHP	104,495.00
OTHERS: DELIVERY CHARGE					PHP	1,000.00
TOTAL ESTIMATED COST OF THE PROJECT					PHP	206,913.30

TERMS OF PAYMENT:

FULL PAYMENT OF UNIT AND DELIVERY CHARGE. IF CHECK, SUBJECT FOR 3 DAYS CLEARING.

WARRANTY:

FOR FLOOR MOUNTED: ONE (1) YEAR FREE PARTS AND LABOR, FIVE (5) YEARS WARRANTY ON COMPRESSOR.

FOR SPLIT TYPE : ONE (1) YEAR FREE PARTS AND LABOR, THREE YEARS (3) MAIN PCB , TEN (10) YEARS WARRANTY ON COMPRESSOR.

NOTES: *** Need to sign waiver agreement due to under capacity of unit choice.

PRICES ARE SUBJECT TO CHANGE WITHOUT PRIOR NOTICE.

PRICES IS VAT INCLUSIVE.

** Cost of Installation is Package with the Unit(s), this cost cannot avail separately.

** INSTALLATION C/O ASP (cost will be based on actual)

We thank you for giving opportunity to offer our product and services, hoping we receive your purchase order.

If you need assistance, don't hesitate to call the under signed at 0917-807-8607 or email at kmi_asst@kolinphil.com.ph

Very Truly Yours,

JANELLEN S. LIM
KMI-ASSISTANT

Noted by:

MARTY MANUEL R. FLORES
KMI-SUPERVISOR

Approved By:

MS. EDITHA M. FLORES
AVP - FINANCE

Conforme:

SIGNATURE OVER PRINTED NAME

KMI-QUOTE-01-25-0045-rev
ECY-22%/2.5K/4K

Kolin Marketing, Inc.

1854 Sta. Rita St., Guadalupe Nuevo, Makati City

Tel.: (632) 8852-6473

Fax: (632) 8852-2170 / (632) 8852-4792

www.kolinphil.com.ph / kolinphilippines

January 20, 2025

JOHN VINCENT ASUNCION

B2 L57 Evangelista St.Ph3 Brgy Colinas Verdes, San Jose Del Monte Bulacan

0917-8144602

asuncionjohnvincent@gmail.com

MODEL	Qty
KLK-SF40-WBR6H1M32	1
KSM-IW15-WCT10M1M32	1
KSM-IW10-WCT10M1M32	2

OPTION 2

LIVING/DINNG/KITCHEN	Area	46.2 sqm
-----------------------------	------	----------

ACU 1	4.0 HP Floor Standing Regular	KLK-SF40-WBR6H1M32
	Estimated Pipe Length = 50 ft	
	Estimated Royal Cord Length = 57 ft	
	Initial Charge	₱ 11,000.00

Includes:

Labor

10ft Copper Tube

10ft Royal Cord

Indoor Bracket (Floor)

Consumables

Installation Materials	Description	Qty	Price per qty	Subtotal
Copper Tube	3/8" X 5/8"	40 ft	₱ 400.00/ft	₱ 16,000.00
Royal Cord (comm. wire)	2.mm2 x 4C	47 ft	₱ 100.00/ft	₱ 4,700.00
Royal Cord (ACCU-Breaker)	5.5mm x 3c	7 ft	₱ 70.00/ft	₱ 490.00
Circuit Breaker waterproof	40A / 1Ph	1 pc/s	₱ 1,000.00/pc	₱ 1,000.00
Rubber Insulation	2 1/8" x 3/4" x 6'	4 pc/s	₱ 350.00/pc	₱ 1,400.00
Outdoor bracket	Fabricated wall	1 pc/s	₱ 5,000.00/pc	₱ 5,000.00
PVC blue	3/4" x 10'	1 pc/s	₱ 150.00/pc	₱ 150.00
Drain Hose	White -1/2"	7 ft	₱ 25.00/ft	₱ 175.00
				₱ 28,915.00

Estimated Charges	₱ 39,915.00
--------------------------	-------------

BEDROOM1	Area	11.4 sqm
-----------------	------	----------

ACU 2	1.0 HP Wall Mounted Inverter	KSM-IW10-WCT10M1M32
	Estimated Pipe Length = 50 ft	
	Estimated Royal Cord Length = 57 ft	
	Initial Charge	₱ 7,500.00

Includes:

Labor

10ft Copper Tube

10ft Royal Cord

Outdoor Bracket (Wall)

Consumables

Installation Materials	Description	Qty	Price per qty	Subtotal
Copper Tube	Ø 1/4" x Ø 3/8"	40 ft	₱ 350.00/ft	₱ 14,000.00
Royal Cord (comm. wire)	2.mm2 x 4C	47 ft	₱ 100.00/ft	₱ 4,700.00
Royal Cord (ACCU-Breaker)	3.5mm x 3c	7 ft	₱ 60.00/ft	₱ 420.00
Circuit Breaker waterproof	20A / 1Ph	1 pc/s	₱ 1,000.00/pc	₱ 1,000.00
Rubber Insulation	2 1/8" x 3/4" x 6'	3 pc/s	₱ 350.00/pc	₱ 1,050.00
Full thread	3/8" x 10'	1 pc/s	₱ 150.00/pc	₱ 150.00
Metal Clamp	3"	6 pc/s	₱ 120.00/pc	₱ 720.00
PVC blue	3/4" x 10'	1 pc/s	₱ 150.00/pc	₱ 150.00
				₱ 22,190.00

Estimated Charges	₱ 29,690.00
--------------------------	-------------

ACU 4 1.5 HP Wall Mounted Inverter**KSM-IW15-WCT10M1M32**

Estimated Pipe Length = 50 ft

Estimated Royal Cord Length = 57 ft

Initial Charge**₱ 7,500.00**

Includes:

Labor

10ft Copper Tube

10ft Royal Cord

Outdoor Bracket (Wall)

Consumables

Installation Materials

	Description	Qty	Price per qty	Subtotal	
Copper Tube	1/4" x 1/2"	40 ft	₱ 350.00/ft	₱ 14,000.00	
Royal Cord (comm. wire)	2.mm2 x 4C	47 ft	₱ 100.00/ft	₱ 4,700.00	
Royal Cord (ACCU-Breaker)	3.5mm x 3c	7 ft	₱ 60.00/ft	₱ 420.00	
Circuit Breaker waterproof	20A / 1Ph	1 pc/s	₱ 1,000.00/pc	₱ 1,000.00	
Rubber Insulation	2 1/8" x 3/4" x 6'	5 pc/s	₱ 350.00/pc	₱ 1,750.00	
Full thread	3/8" x 10'	1 pc/s	₱ 150.00/pc	₱ 150.00	
Metal Clamp	3"	6 pc/s	₱ 120.00/pc	₱ 720.00	
PVC blue	3/4" x 10'	1 pc/s	₱ 150.00/pc	₱ 150.00	₱ 22,890.00

Estimated Charges**₱ 30,390.00****Scaffolding**

3 sets

₱ 4,500.00

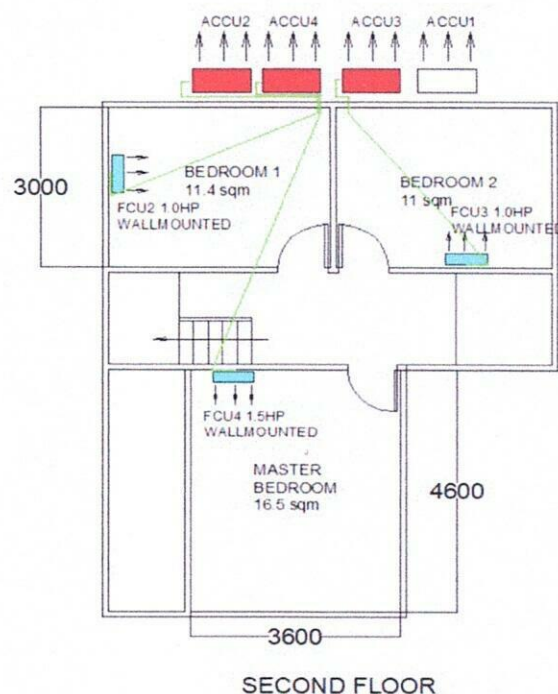
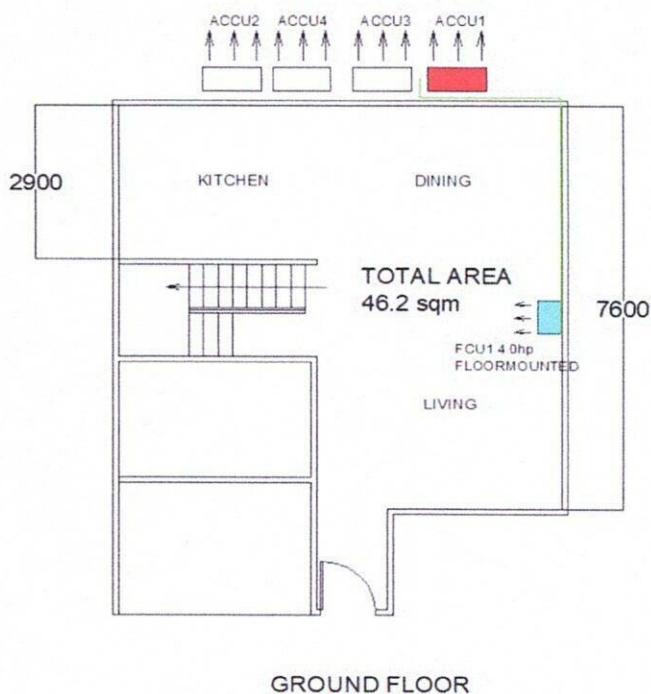

Total Estimated Charges	P 128,445.00
--------------------------------	---------------------

Validity: This quotation is valid for a period of fifteen (15) days from the date thereof, subject to our confirmation thereafter.

Installation notes:

- 1 Location of indoor and outdoor units were agreed by the customer and Kolin's surveyor.
- 2 AC drain line will be tapped to the nearest drain provision provided by the customer's contractor.
- 3 Need for marking and site visit before installation.
- 4 Coppertube Lay out going inside the ceiling, customer contractor will chip the wall and open the ceiling.
- 5 Working days: Monday to Saturday, 8am- 5pm with parking. Need working permit.
- 6 Mechanical Plans, Permits, Electrical permits not included.
- 7 Deflectors, masonry, carpentry, chipping & plastering (finishing & restoration) are not included in the installation.
- 8 Air conditioning drain line and Electrical power supply (feeder line) **220v/ 60hz/ 1ph**, should be provided by customer's contractor.
- 9 **Final charges will be based on actual installation.**

Prepared by:

Jeffrey Dadios
Field Surveyor

Customer Conformer:

Signature Over Printed Name

Reviewed by:

Engr. Kenneth Zamora
Service Supervisor Shop and
Field Operation

JANUARY 18, 2025

JOHN VINCENT ASUNCION

B2 L57 Evangelista St.Ph3 Brgy Colinas Verdes, San Jose Del Monte Bulacan

0917-8144602

asuncionjohnvincent@gmail.com

Please be informed that the air-conditioner you intend to purchase is under capacity as compared to the following unit that we proposed:

Location	Area	Kolin's Recommendation	Customer's Choice	Remarks
LIVING/DINING/ KITCHEN	46.2 sqm	KLM-SF70-4F1M32	KLK-SF40-WBR6H1M32	calculated 4.8hp under by 0.8hp

Since the unit of your choice is under capacity, it is probable that you may experience the following;

1. Capacity of the unit to cool the area will take longer or it will not cool the area at all that may lead to your dissatisfaction with the cooling performance of our unit.
2. Power consumption will be higher due to frequent running of compressor for not reaching the desired temperature within the normal parameter.
3. Useful life of compressor will be shortened due to excessive running beyond the normal run cycle.

Considering the above conditions, we regret to inform you that we cannot guarantee the efficient performance of unit. **Also, One (1) year warranty for parts (compressor-3years).**

For your guidance and information

Prepared by:

Name

Surveyor

Approved by:

Mr. Alvin de Rivera
Service Manager

Jan.20,2025

Noted by:

Engr. Kenneth Zamora
Service Supervisor - Field
and Shop Operation

Customer Conforme:

Signature Over Printed Name