



December 26, 2024

MR. CHITO MARCOS
TEL#: 0917-5180458

Dear Ma'am/Sir,

Kolin Marketing Inc., is extremely honored for your endorsement of Kolin brand and we are please to offer you with a special price/s for the following items.

A. EQUIPMENT & INSTALLATION

QTY	U/M	MODEL / DESCRIPTION	SRP	DISCOUNTED PRICE		AMOUNT
1	UNIT/S	MODEL: KSG-IWF-25WFY-8K1M32 KOLIN WALL MOUNTED PRIMUS GOLD AIRCONDITIONER 25,560 Kj/h (2.5HP) FULL DC INVERTER W/ WIFI R-32	68,995.00	46,816.10	PHP	46,816.10
TOTAL UNIT COST					PHP	46,816.10
ESTIMATED COST OF INSTALLATION w/ dismantling of old unit (please see attached)					PHP	25,045.00
OTHERS: DELIVERY CHARGE					PHP	600.00
TOTAL ESTIMATED COST OF THE PROJECT					PHP	72,461.10

TERMS OF PAYMENT:

FULL PAYMENT OF UNIT AND DELIVERY CHARGE. IF CHECK, SUBJECT FOR 3 DAYS CLEARING.

WARRANTY:

FOR SPLIT TYPE : ONE (1) YEAR FREE PARTS AND LABOR, THREE YEARS (3) MAIN PCB , TEN (10) YEARS WARRANTY ON COMPRESSOR.

NOTES: PRICES ARE SUBJECT TO CHANGE WITHOUT PRIOR NOTICE.

PRICES IS VAT INCLUSIVE.

** Cost of Installation is Package with the Unit(s), this cost cannot avail separately (cost will be based on actual).

We thank you for giving opportunity to offer our product and services, hoping we receive your purchase order.

If you need assistance, don't hesitate to call the under signed at 0917-807-8607 or email at kmi_asst@kolinphil.com.ph

Very Truly Yours,

JANELLEN S. LIM
KMI-ASSISTANT

Noted by:
MART NATHANIEL R. FLORES
KMI-SUPERVISOR

Approved By:
MS. EDITHA M. FLORES
AVP - FINANCE

KMI-QUOTE-01-25-0004
ADR-22%/7K

Conforme: _____
SIGNATURE OVER PRINTED NAME

Kolin Marketing, Inc.
1854 Sta. Rita St., Guadalupe Nuevo, Makati City
Tel.: (632) 8852-6473
Fax: (632) 8852-2170 / (632) 8852-4792
www.kolinphil.com.ph / kolinphilippines

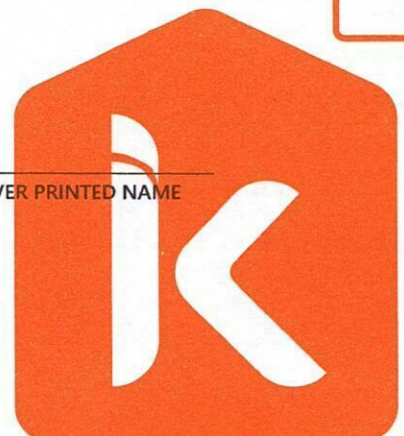

KOLIN Philippines International Inc.
Survey Form

No 003568

Customer Name : CHITO MAXCOO Date : 1-2-25
 Address : 30 HOMER RD. ST. MAXIMILIAN VILLAGE SJR No. : 135726
MAKATI CITY
 Establishment Type : Residential ☒ Area Surveyed : MAXIM BEM/100M
 Commercial ☐ Area Surveyed : _____

Recommended Product Model : K56 TWF-25WTF-8K1M

Cooling Capacity Computation

Floor Area : 20 sqm.
 Ceiling Height : 2.6 mtr.

note: add 20% per meter in excess of 3 meters in the initial cooling capacity computed.

Floor Area :	<u>20</u>	x	550 Btu/h	<u>11,000</u> Btu/h
Ceiling Height (excess of 3 mtrs.) :	_____	x	20%	_____ Btu/h
Window Direct Sunlight	_____	x	20% - 50%	_____ Btu/h
Total Cooling Capacity				<u>11,000</u> Btu/h

Add : Additional Heat Load

No. of Person	<u>2</u>	x	300 Btu/h	<u>600</u> Btu/h
No. of Ordinary Light (<40w)	<u>3</u>	x	200 Btu/h	<u>600</u> Btu/h
No. of Special Light (>40w)	_____	x	400 Btu/h	_____ Btu/h
No. of Refrigerator (< 6 cu.ft.)	<u>1</u>	x	400 Btu/h	<u>400</u> Btu/h
No. of Refrigerator (> 6 cu.ft.)	_____	x	800 Btu/h	_____ Btu/h
No. of Cooking Range	_____	x	1500 Btu/h	_____ Btu/h
No. of Laptop Computer	<u>1</u>	x	150 Btu/h	<u>150</u> Btu/h
No. of Desktop Computer	<u>2</u>	x	400 Btu/h	<u>800</u> Btu/h
No. of Printer	_____	x	500 Btu/h	_____ Btu/h
No. of Photocopier	_____	x	1000 Btu/h	_____ Btu/h
Total Cooling Capacity				<u>2550</u> Btu/h

Recommended Cooling Capacity

16
1350 Btu/h

Note : Compressor warranty will be reduced to ____ yr. if air-conditioner purchased is lower than the recommended cooling capacity or pipe lay-out is beyond the maximum allowable length.

Scope of Work Agreement

- | | | |
|-----------------------------------|--|---|
| 1. Copper tube lay-out | <input type="checkbox"/> Expose | <input type="checkbox"/> Embedded |
| 2. Chipping | <input type="checkbox"/> Included | <input checked="" type="checkbox"/> Not Included |
| 3. Fabricated Bracket | <input type="checkbox"/> Yes <input type="checkbox"/> Shop | <input type="checkbox"/> Site <input type="checkbox"/> No |
| 4. Service Ledge | <input type="checkbox"/> Yes | <input checked="" type="checkbox"/> No |
| 5. Dismantling of existing Aircon | <input checked="" type="checkbox"/> Included | <input type="checkbox"/> Not Included |
| 6. Ducting | <input type="checkbox"/> Yes | <input checked="" type="checkbox"/> No |

Dimension : _____

- Plastering, carpentry and restoration works are to be done by the customer.
- Wiring of electrical supply from main panel to air-conditioning unit are to be done by the customer.
- Processing of mechanical plan, working permit, electrical permit are to be done by the customer.
- Other concern: DISMANTLE AND REPLACE NEW UNIT.

REPLACE COPPER TUBE AND NEED EVACUATION
FOR THE TOWER CURRY TRUNKED TO
OUTSIDE LOCATION. 4 PAX. NEED SMALL
TRUCKS GOING INSIDE THE COILING.
USE EXISTING OUTSIDE BRACKET.

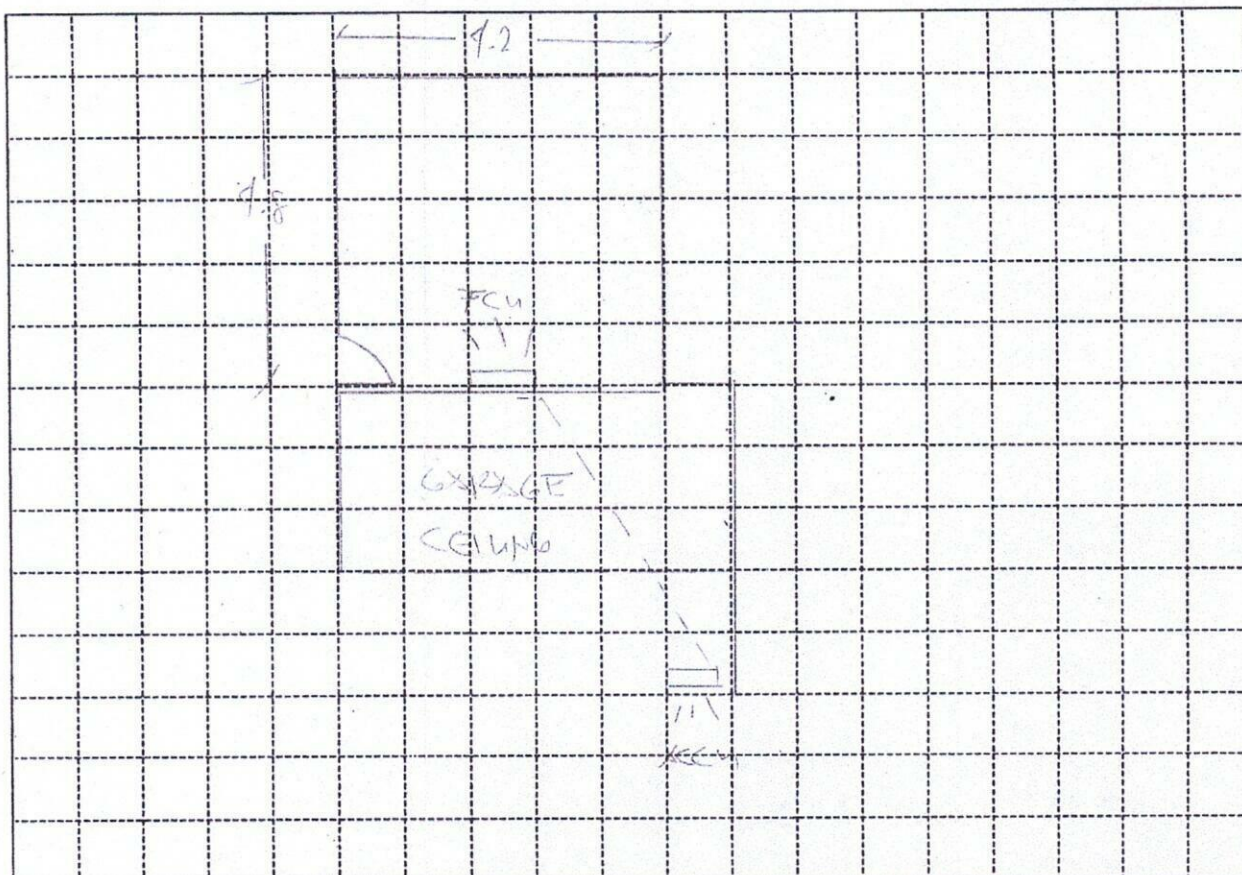

Indoor Unit Location : CENTRE OF AREA SAME LOCATION
 Outdoor Unit Location : ATTACHED GAS FRONTING GAS SAME LOCATION
 Pipe Length : 30 FEET
 Special Note : _____

Installation Cost Estimate			
Material Description	Qty.	Unit Cost	Total Cost
Copper Tube (excess of 10 ft.) 2330, 2430, 2520, 3520, 4620	20 FT	400	8000
Wire (Royal Cord-signal wire) (excess of 10ft.) 2.0mmx4C	27 FT	100	2700
Wire (Royal Cord - Breaker to ODU) 3.5mm / 5.5mm x 3C	7 FT	60	420
Circuit Breaker 20A, 30A, 40A/1ph, 40A/3ph	1	1000	1000
Bracket (ODU) (Imptd. / Fabricated) ; (Floor / Wall)			
Bracket (WAC) Angle Type			
PVC Pipe (drain) 1/2", 3/4"			
PVC Pipe (electrical) 3/4", 1"			
Drain Pump			
Drain Pump Hose WHITE 1/2"	2 FT	25	50
Chipping Works 1 1/2" x 3/4" x 6"	5 mtr.	350	1750
Dismantling Fee (existing air-conditioner) 2 FT			2500
Initial Charge			2500
TOTAL ESTIMATE		P 25,045	

Note :

- Initial Charge includes labor, 10ft. Copper tube, 10ft. Royal cord, Circuit breaker, Outdoor Bracket (SAC), Indoor Bracket (PAC) and Consumable materials.
- Survey fee will be **deducted** in the installation fee.

Prepared by:

JEANETTE D. DOLLO
 Signature Over Printed Name

Customer Conforms:

SENO VIX VIGIL XS PTF CUSTOMER
 Signature Over Printed Name