



January 8, 2025

MR. JASON TAN
UNIT 808 MAPLE AT VERDANT TOWERS, ORTIGAS AVE., ORTIGAS EAST PASIG CITY
TEL#: 0917-5317531
Email: jason.tan@northwingexport.com

Dear Ma'am/Sir,

Kolin Marketing Inc., is extremely honored for your endorsement of Kolin brand and we are please to offer you with a special price/s for the following items.

A. EQUIPMENT & INSTALLATION

QTY	U/M	MODEL / DESCRIPTION	SRP	DISCOUNTED PRICE		AMOUNT
1	UNIT/S	MODEL: KSG-IWF-20WFF-8K1M32 KOLIN WALL MOUNTED PRIMUS GOLD AIRCONDITIONER 19,000 Kj/h (2.0HP) FULL DC INVERTER W/ WIFI R-32	59,595.00	39,484.10	PHP	39,484.10
1	UNIT/S	MODEL: KSG-IWF-15WFF-8K1M32 KOLIN WALL MOUNTED PRIMUS GOLD AIRCONDITIONER 12,960 Kj/h (1.5HP) FULL DC INVERTER W/ WIFI R-32	46,595.00	29,344.10	PHP	29,344.10
TOTAL UNIT COST					PHP	68,828.20
ESTIMATED COST OF INSTALLATION (please see attached)					PHP	46,390.00
OTHERS: DELIVERY CHARGE					PHP	600.00
TOTAL ESTIMATED COST OF THE PROJECT					PHP	115,818.20

TERMS OF PAYMENT:

FULL PAYMENT OF UNIT AND DELIVERY CHARGE. IF CHECK, SUBJECT FOR 3 DAYS CLEARING.

WARRANTY:

FOR SPLIT TYPE : ONE (1) YEAR FREE PARTS AND LABOR, THREE YEARS (3) MAIN PCB , TEN (10) YEARS WARRANTY ON COMPRESSOR.

NOTES: *** Need to sign waiver agreement due to under capacity of unit choice.

PRICES ARE SUBJECT TO CHANGE WITHOUT PRIOR NOTICE.

PRICES IS VAT INCLUSIVE.

**** Cost of Installation is Package with the Unit(s), this cost cannot avail separately (cost will be based on actual).**

We thank you for giving opportunity to offer our product and services, hoping we receive your purchase order.

If you need assistance, don't hesitate to call the under signed at 0917-807-8607 or email at kmi_asst@kolinphil.com.ph

Very Truly Yours,

JANELLEN S. LIM
KMI-ASSISTANT

Noted by:

MART NATHANIEL R. FLORES
KMI-SUPERVISOR

Approved By:

MS. EDITHA M. FLORES
AVP - FINANCE

Conforme:

SIGNATURE OVER PRINTED NAME

KMI-QUOTE-01-25-0016
REG-22%/7K

Kolin Marketing, Inc.
1854 Sta. Rita St., Guadalupe Nuevo, Makati City
Tel.: (632) 8852-6473
Fax: (632) 8852-2170 / (632) 8852-4792
 www.kolinphil.com.ph / kolinphilippines



January 07, 2025

JASON TAN

Unit 808 Maple at Verdant Towers, Ortigas Ave. Ortigas East Pasig City

0917-5317531 - viber

jason.tan@northwingexport.com

MODEL	Qty
KSG-IWF-20Wfy8K1M32	1
KSG-IWF-15Wfy8K1M32	1

LIVING/DINING/ KITCHEN	Area	30 sqm
-------------------------------	------	--------

ACU 1 **2.0 HP Wall Mounted Inverter** *KSG-IWF-20Wfy8K1M32*

Estimated Pipe Length = 40 ft

Estimated Royal Cord Length = 45 ft

Initial Charge ₱ 7,500.00

Includes:

Labor
10ft Copper Tube
10ft Royal Cord
Outdoor Bracket (floor)
Consumables

Installation Materials	Description	Qty	Price per qty	Subtotal
Copper Tube	Ø 1/4" x Ø 1/2"	30 ft	₱ 350.00/ft	₱ 10,500.00
Royal Cord (comm. wire)	2.mm2 x 4C	35 ft	₱ 100.00/ft	₱ 3,500.00
Royal Cord (ACCU-Breaker)	3.5mm x 3c	5 ft	₱ 60.00/ft	₱ 300.00
Metal Clamp	3"	8 pc/s	₱ 120.00/pc	₱ 960.00
PVC blue	3/4" x 10'	3 pc/s	₱ 150.00/pc	₱ 450.00
Rubber Insulation	1 1/8" x 3/8" x 6'	4 pc/s	₱ 150.00/pc	₱ 600.00
				₱ 16,310.00

Estimated Charges	₱ 23,810.00
--------------------------	--------------------

BEDROOM	Area	10.8 sqm
----------------	------	----------

ACU 2 **1.5 HP Wall Mounted Inverter** *KSG-IWF-15Wfy8K1M32*

Estimated Pipe Length = 37 ft

Estimated Royal Cord Length = 42 ft

Initial Charge ₱ 7,500.00

Includes:

Labor
10ft Copper Tube
10ft Royal Cord
Outdoor Bracket (floor)
Consumables

Installation Materials	Description	Qty	Price per qty	Subtotal
Copper Tube	Ø 1/4" x Ø 3/8"	27 ft	₱ 350.00/ft	₱ 9,450.00
Royal Cord (comm. wire)	2.mm2 x 4C	32 ft	₱ 100.00/ft	₱ 3,200.00
Royal Cord (ACCU-Breaker)	3.5mm x 3c	7 ft	₱ 60.00/ft	₱ 420.00
Metal Clamp	3"	8 pc/s	₱ 120.00/pc	₱ 960.00
PVC blue	3/4" x 10'	3 pc/s	₱ 150.00/pc	₱ 450.00
Rubber Insulation	1 1/8" x 3/8" x 6'	4 pc/s	₱ 150.00/pc	₱ 600.00
				₱ 15,080.00

Estimated Charges	₱ 22,580.00
--------------------------	--------------------

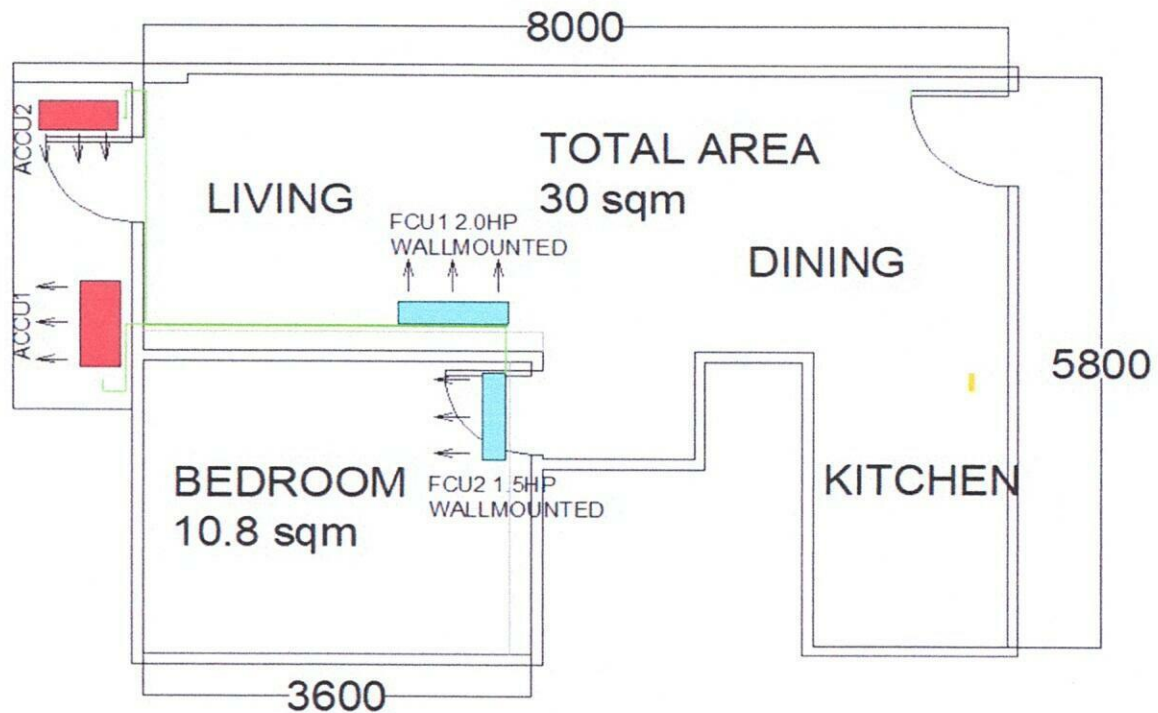

Total Estimated Charges **P 46,390.00**

Validity: This quotation is valid for a period of fifteen (15) days from the date thereof, subject to our confirmation thereafter.

Installation notes:

- 1 Location of indoor and outdoor units were agreed by the customer and Kolin's surveyor.
- 2 AC drain line will be tapped to the nearest drain provision provided by the customer's contractor.
- 3 Coppertube and drainline expose in the area.
- 4 Working days: Monday to Saturday, 8am- 5pm with parking. Need working permit. need to cut the wall for the coppertube and drain lay-out of ACU2.
- 5 Need Waiver agreement due to undercapacity.
- 6 Customer will cover or cladding the coppertube and drainline after installation.
- 7 Mechanical Plans, Permits, Electrical permits not included.
- 8 Deflectors, masonry, carpentry, chipping & plastering (finishing & restoration) are not included in the installation.
- 9 Air conditioning drain line and Electrical power supply (feeder line) **220v/ 60hz/ 1ph**, should be provided by customer's contractor.
- 10 **Final charges will be based on actual installation.**

Prepared by:

Jeffrey Dadios
Jeffrey Dadios
 Field Surveyor

Customer Conformance:

 Signature Over Printed Name

Reviewed by:

Engr. Kenneth Zamora
Engr. Kenneth Zamora
 Service Supervisor Shop and
 Field Operation

January 07, 2025

JASON TAN

Unit 808 Maple at Verdant Towers, Ortigas Ave. Ortigas East Pasig City

0917-5317531 - viber

jason.tan@northwingexport.com

Please be informed that the air-conditioner you intend to purchase is under capacity as compared to the following unit that we proposed:

Location	Area	Kolin's Recommendation	Customer's Choice	Remarks
LIVING/DINING/ KITCHEN	29 sqm	KSG-IWF-25WFY8K1M32	KSG-IWF-15WFY8K1M32	Calculated 2.4hp under by 0.9hp

Since the unit of your choice is under capacity, it is probable that you may experience the following;

1. Capacity of the unit to cool the area will take longer or it will not cool the area at all that may lead to your dissatisfaction with the cooling performance of our unit.
2. Power consumption will be higher due to frequent running of compressor for not reaching the desired temperature within the normal parameter.
3. Useful life of compressor will be shortened due to excessive running beyond the normal run cycle.

Considering the above conditions, we regret to inform you that we cannot guarantee the efficient performance of unit. **Also, One (1) year warranty for parts (compressor-1year).**

For your guidance and information

Prepared by:

Jeffrey T. Dadios
Surveyor

Approved by:

Jan. 8, 2025
Mr. Alvin de Rivera
Service Manager

Noted by:

Engr. Kenneth Zamora
Service Supervisor - Field
and Shop Operation

Customer Conforme:

Signature Over Printed Name